

BAUGHMAN COMPANY, P.A.
 ENGINEERING & SURVEYING
 315 ELLIS WICHITA, KS. 67211
 (316)262-7271 FAX (316)262-0149

LETTER OF TRANSMITTAL

TO Jacky Wang P.E.

DATE	11/1/82	JOB NO.
ATTENTION:		
RE:	DRAINAGE PLAN	
	"REVISED"	

WE ARE SENDING YOU Attached Under separate cover via _____ the following items

- Plans
 Prints
 Shop drawings
 Samples
 Copy of letter
 Specifications
 Change order
 Computer disk

COPIES	DATE	NO.	
1			allison 2nd ADDN.
1			KDOT APPROVAL

THESE ARE TRANSMITTED as checked below:

- For approval
 For your use & information
 As requested
 Approved as submitted
 Approved as noted
 Return for corrections
 For review and comment
 FOR BIDS DUE _____ 19__

REMARKS: _____

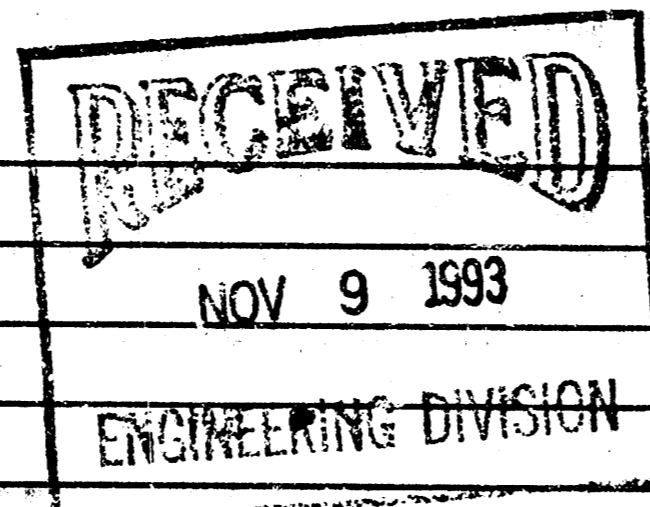

COPY TO _____ SIGNED: [Signature]

KANSAS DEPARTMENT OF TRANSPORTATION

STATE OFFICE BUILDING—TOPEKA, KANSAS 66612

JOHN B. KEMP, Secretary of Transportation JOHN CARLIN, Governor

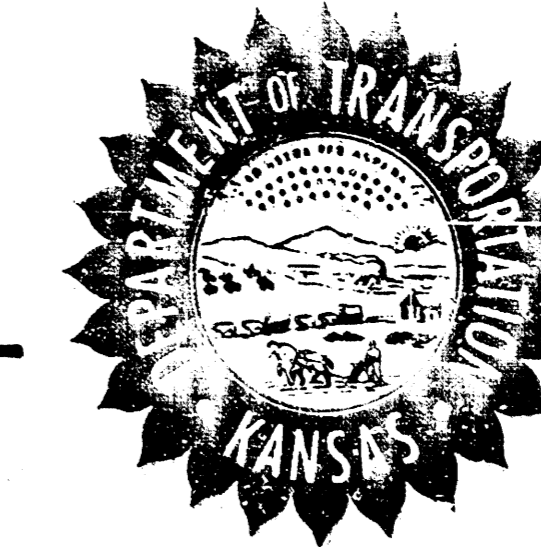

Box 769
 Hutchinson, Kansas
 August 28, 1980

Mr. M. Brent Wooten, P.E.
 Baughman Company, P.A.
 330 Laura
 Wichita, Kansas 67211

Dear Mr. Wooten:

This is in response to your letter of August 22, 1980, with regard to an area of ground south of MacArthur Road and west of I-135 in Wichita, Kansas in which you requested that this property be allowed to drain into the I-135 ditch until this particular tract could be improved.

On August 27, 1980, I reviewed this particular location and can see no reason why you cannot go ahead with your plans as indicated. We want to thank you for giving KDOT the opportunity to review this particular location prior to your improvement.

If we can be of further assistance, please advise.

Sincerely yours,

M. G. SEIBEL, P.E.
 DISTRICT ENGINEER

BY: [Signature]
 MILTON S. FRY, P.E.
 DIST. MAINTENANCE ENGINEER

MSF:s1

PRELIMINARY PLAT
OHLSON SECOND ADDITION
 WICHITA, SEDGWICK COUNTY, KANSAS

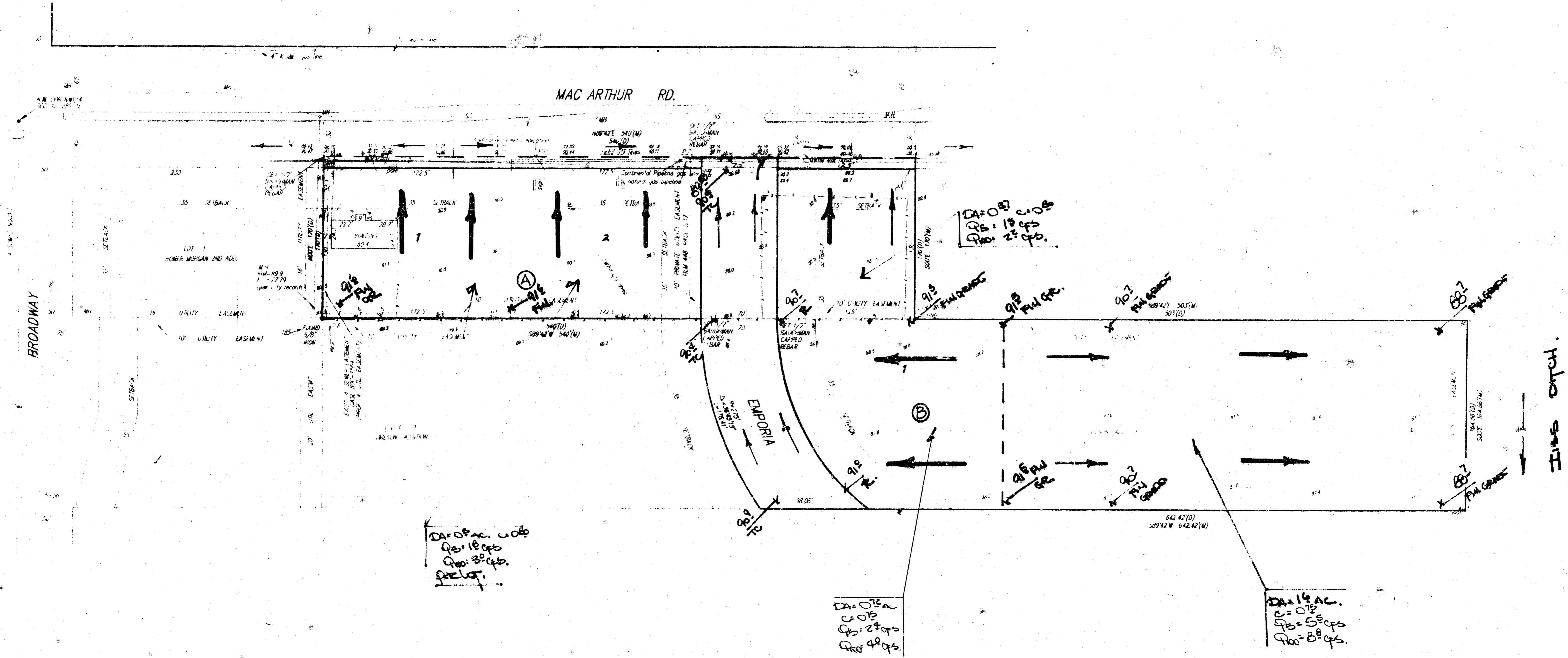

A tract beginning at a point 30 feet south and 280 feet east of the N.W. corner of the NW 1/4 of sec. 16, Twp. 29S, R. 1 E of the 6th P.M. Sedgwick county, Kansas, thence east 540 feet, thence south 140 feet, thence west 543 feet, thence north 140 feet to beginning of lot 2, OHLSON ADDITION

OWNER
 Gladys Scott
 CONTRACT PURCHASER
 Brad & Sara Ohlson

SCALE 1" = 50'
 LAND OWNERS ARE TO FURNISH ALL DATA UNLESS OTHERWISE NOTED ON SHEET
 (M) = MEASURED
 (W) = WITNESSED
 (S) = FOUND 5/8" IRON
 (B) = 1/2" PAUGHMAN BEAR
 (P) = 2" STAINLESS
 (R) = 1/4" IRON FOUND

SEE PLAN SHEET FOR LOCATION OF ALL MARKERS AND BENCH MARKS. ALL DISTANCES ARE IN FEET AND DECIMALS THEREOF. THIS PLAN IS A PRELIMINARY PLAT AND IS NOT TO BE USED FOR ANY OTHER PURPOSE.

DRAINAGE PLAN

BAUGHMAN COMPANY P.A.
 SURVEYING & ENGINEERING
 1122 E. 10TH ST. • WICHITA, KANSAS 67202