

DRAINAGE PLAN

OTTAWAY 2ND ADDITION

WICHITA, SEDGWICK COUNTY, KANSAS

D.A. = 1.1 ac.
 TC = 15 min.
 $I_2 = 3.83$ in/hr
 $I_{10} = 5.22$ in/hr
 $I_{100} = 7.36$ in/hr
 $Q_2 = 3.8$ cfs
 $Q_{10} = 5.2$ cfs
 $Q_{100} = 7.3$ cfs

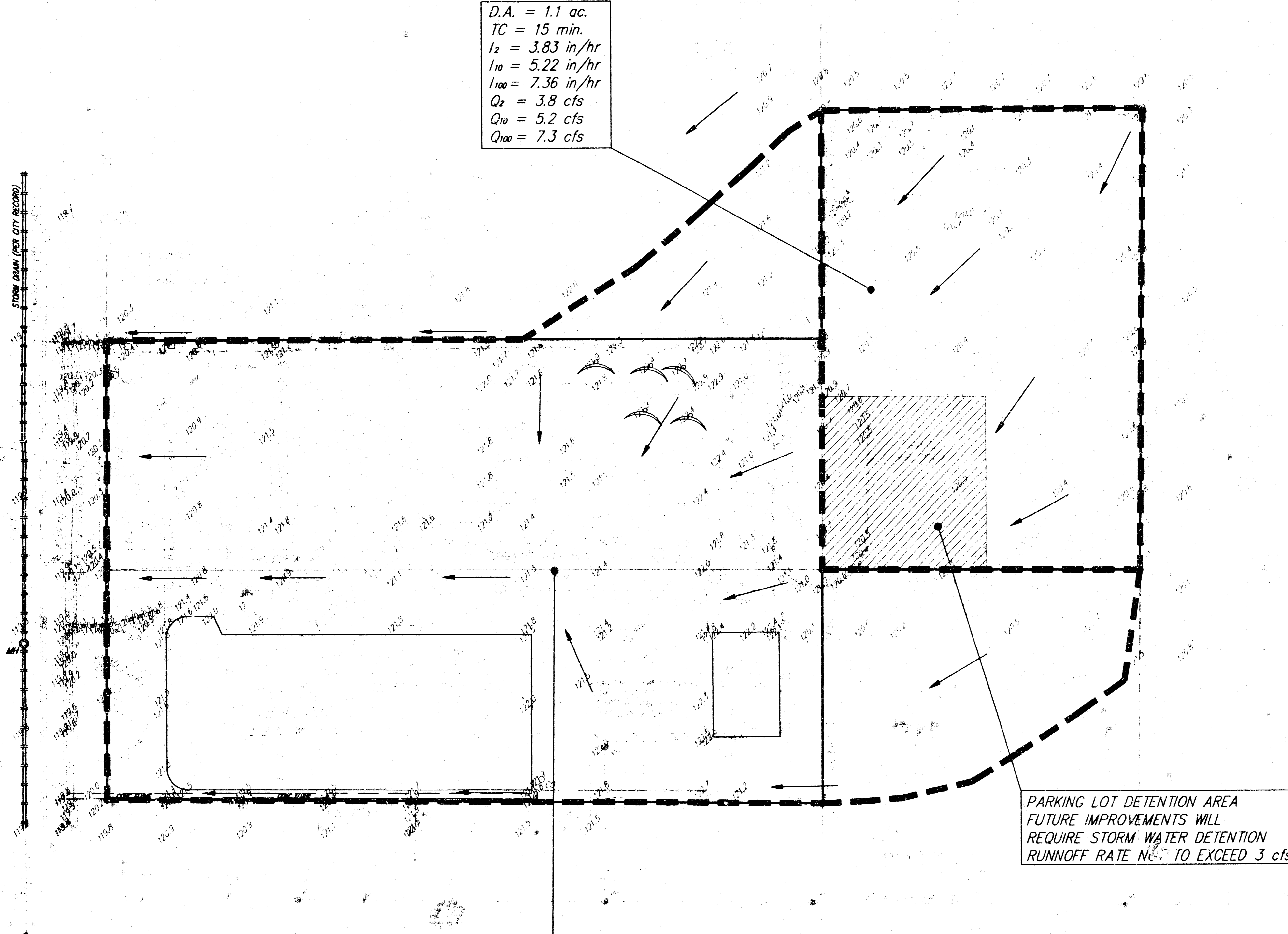

PARKING LOT DETENTION AREA
 FUTURE IMPROVEMENTS WILL
 REQUIRE STORM WATER DETENTION
 RUNOFF RATE NOT TO EXCEED 3 cfs.

LEGAL DESCRIPTION:

LOT 1, OTTAWAY ADDITION, WICHITA, SEDGWICK COUNTY, KANSAS,
 TOGETHER WITH
 THAT PORTION OF LOT 41, KNIGHT ACRES, SEDGWICK COUNTY, KANSAS,
 DESCRIBED AS, COMMENCING AT A POINT EQUIDISTANT BETWEEN THE
 NORTHEAST CORNER OF LOT 1, OTTAWAY ADDITION, AND THE SOUTHEAST
 CORNER OF SAID LOT 1, THENCE EAST PARALLEL WITH THE NORTH LINE
 OF LOT 41, KNIGHT ACRES, TO THE EAST LINE OF SAID LOT 41; THENCE
 NORTH ALONG THE EAST LINE OF SAID LOT 41 TO THE NORTHEAST CORNER
 OF SAID LOT 41; THENCE WEST ALONG THE NORTH LINE OF SAID LOT 41
 TO THE NORTHWEST CORNER OF SAID LOT 41; THENCE SOUTH ALONG
 THE WEST LINE OF LOT 41 TO THE NORTHEAST CORNER OF LOT 1,
 OTTAWAY ADDITION; THENCE SOUTH ALONG THE EAST LINE OF SAID
 LOT 1 TO THE POINT OF BEGINNING.

D.A. = 3.5 ac.
 TC = 15 min.
 $I_2 = 3.83$ in/hr
 $I_{10} = 5.22$ in/hr
 $I_{100} = 7.36$ in/hr
 $Q_2 = 12.1$ cfs
 $Q_{10} = 16.4$ cfs
 $Q_{100} = 23.2$ cfs

BENCH MARK:

CITY OF WICHITA BENCH MARK - DISC
 SOUTHWEST CORNER INTERSECTION,
 34' WEST AND 18' SOUTH OF CENTERLINE BOTH,
 1.5' SOUTH OF BACK OF CURB.
 39.06' NORTHEAST TO NORTH IRON OF 2 IRONS,
 38.68' NORTHEAST TO SOUTH IRON OF 2 IRONS,
 11.3' NORTH NORTHWEST TO TRAFFIC SIGNAL POLE,
 ELEVATION = 118.87' (PER CITY RECORD)

OWNER:

HERBERT & MARTHA OTTAWAY
 3821 W. 11TH STREET
 WICHITA, KANSAS 67203

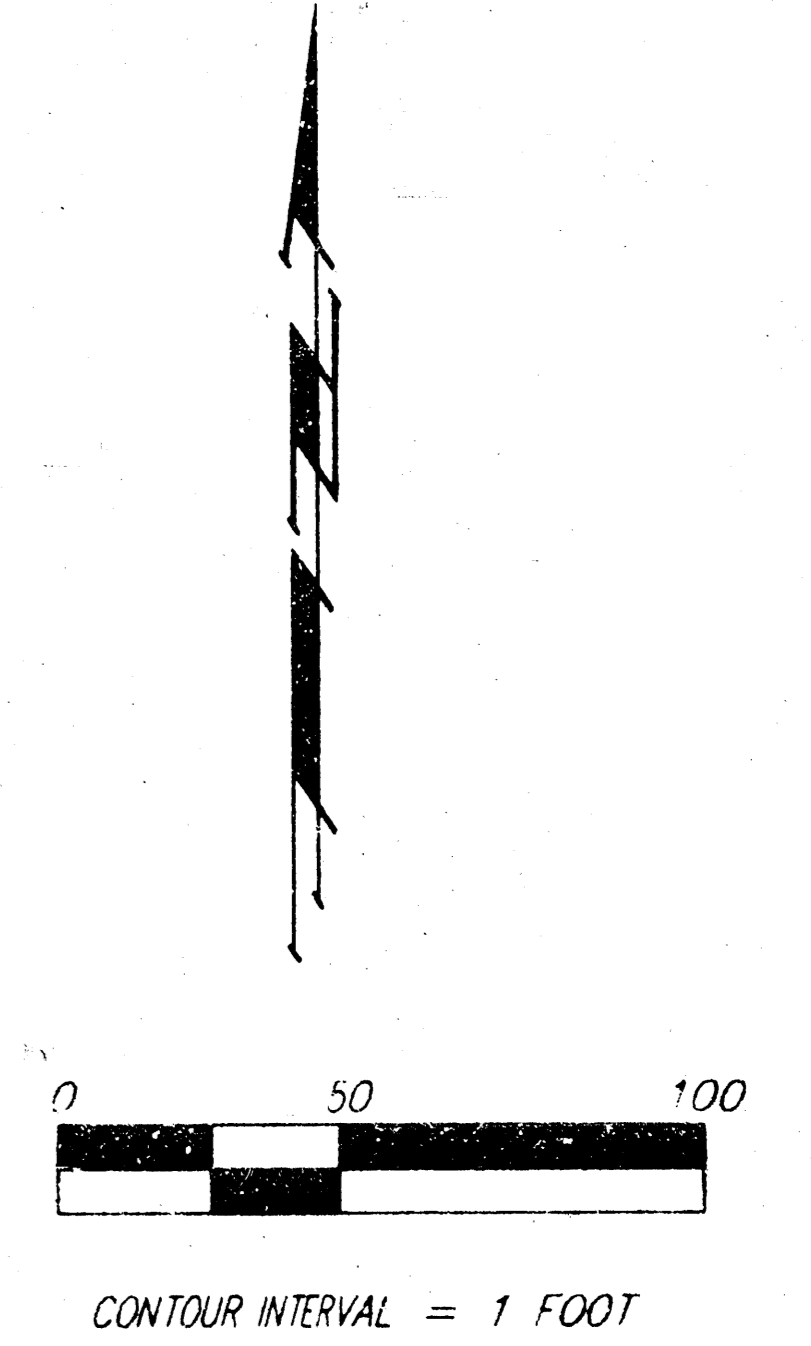

LEGEND:

- = 1/2" IRON PIN (FOUND)
- ∅ = 3/4" IRON PIN (FOUND)
- X = HILT NAIL (SET)
- = THIMBLE (FOUND)
- = #4 REBAR W/ "BAUGHMAN" CAP (SET)

- SM = SANITARY SEWER MANHOLE
- SC = SANITARY SEWER CLEANOUT
- MD = STORM DRAIN MANHOLE
- FH = FIRE HYDRANT
- WM = WATER METER
- YH = YARD HYDRANT
- ICV = IRRIGATION CONTROL VALVE
- PP = POWER POLE
- LP = LIGHT POLE
- TT = TOWER TRANSFORMER
- S = SIGN
- GM = GAS METER
- GP = GUARD POST

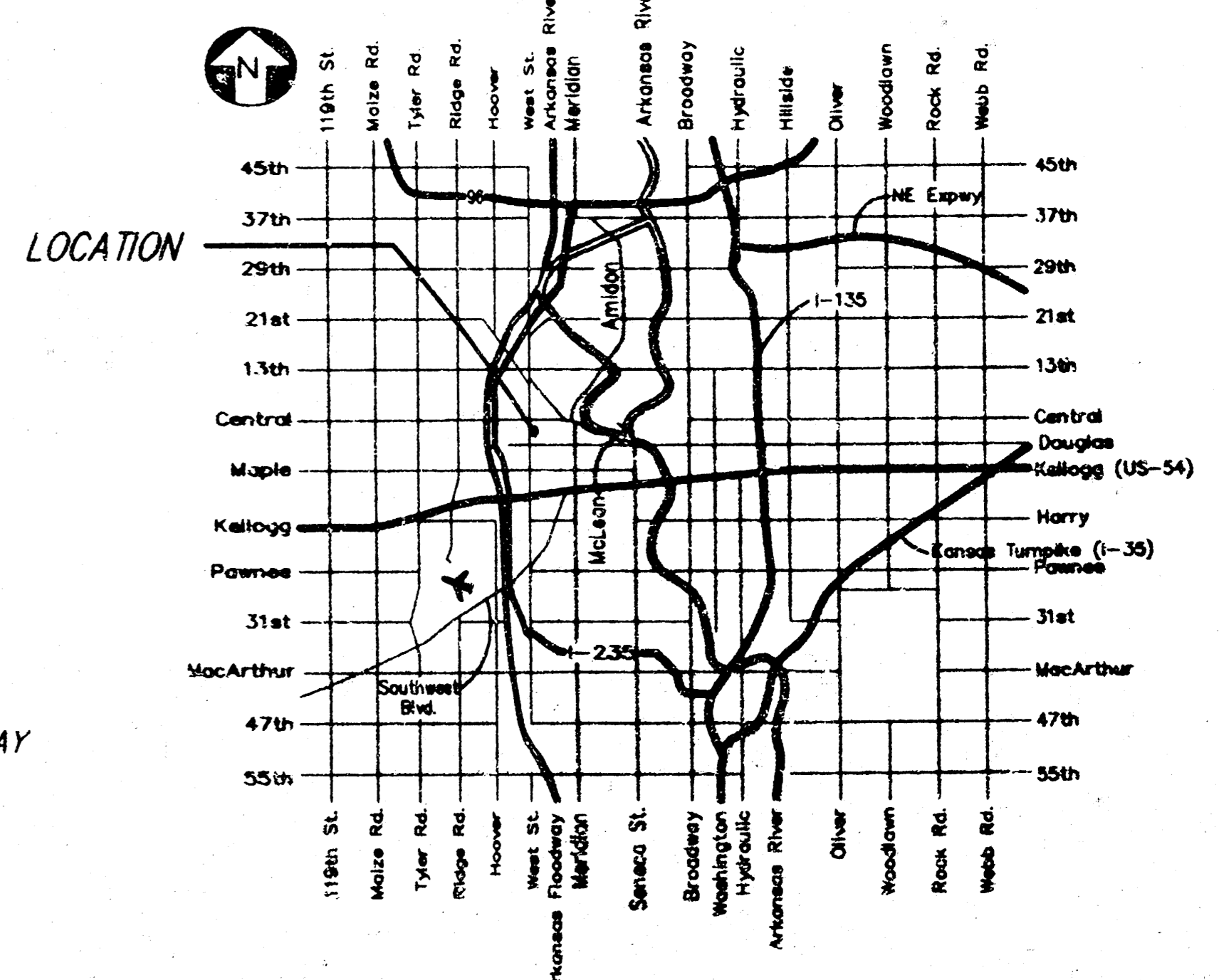

NOTE: The proposed drainage plan provided herein is a generally defined
 plan to follow for design. It is recognized and assumed that upon the
 final design of street and storm sewer improvements within this plat that
 the designer will modify or alter the general drainage plan as necessary
 in order to implement the installation of the improvements to obtain the
 most economical design and construction possible.