

N.H. STA. 27 + 80.5
 GROUND = 141.8
 F.L. = 127.32

UNITS: FEET AND INCHES
 CENTER OF SEC. 41, T27S, R12E
 2794.4'

N.H. STA. 9 + 82.3
 GROUND = 145.1
 F.L. = 121.8

N.H. STA. 7 + 03.2
 GROUND = 141.1
 F.L. 007 = 111.06
 F.L. 101 = 111.21

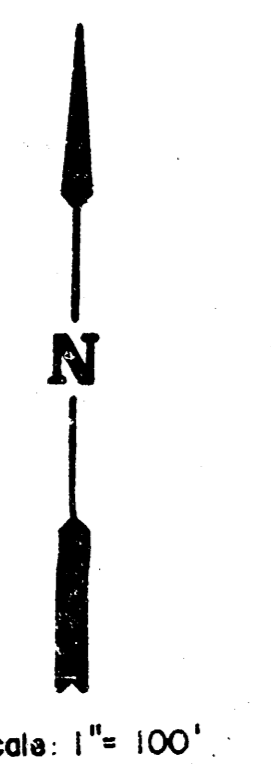

LEGEND
 - - - - - Exst. Water Line
 - - - - - Prop. Water Line
 - - - - - Exst. San. Sew.
 - - - - - Prop. San. Sew.

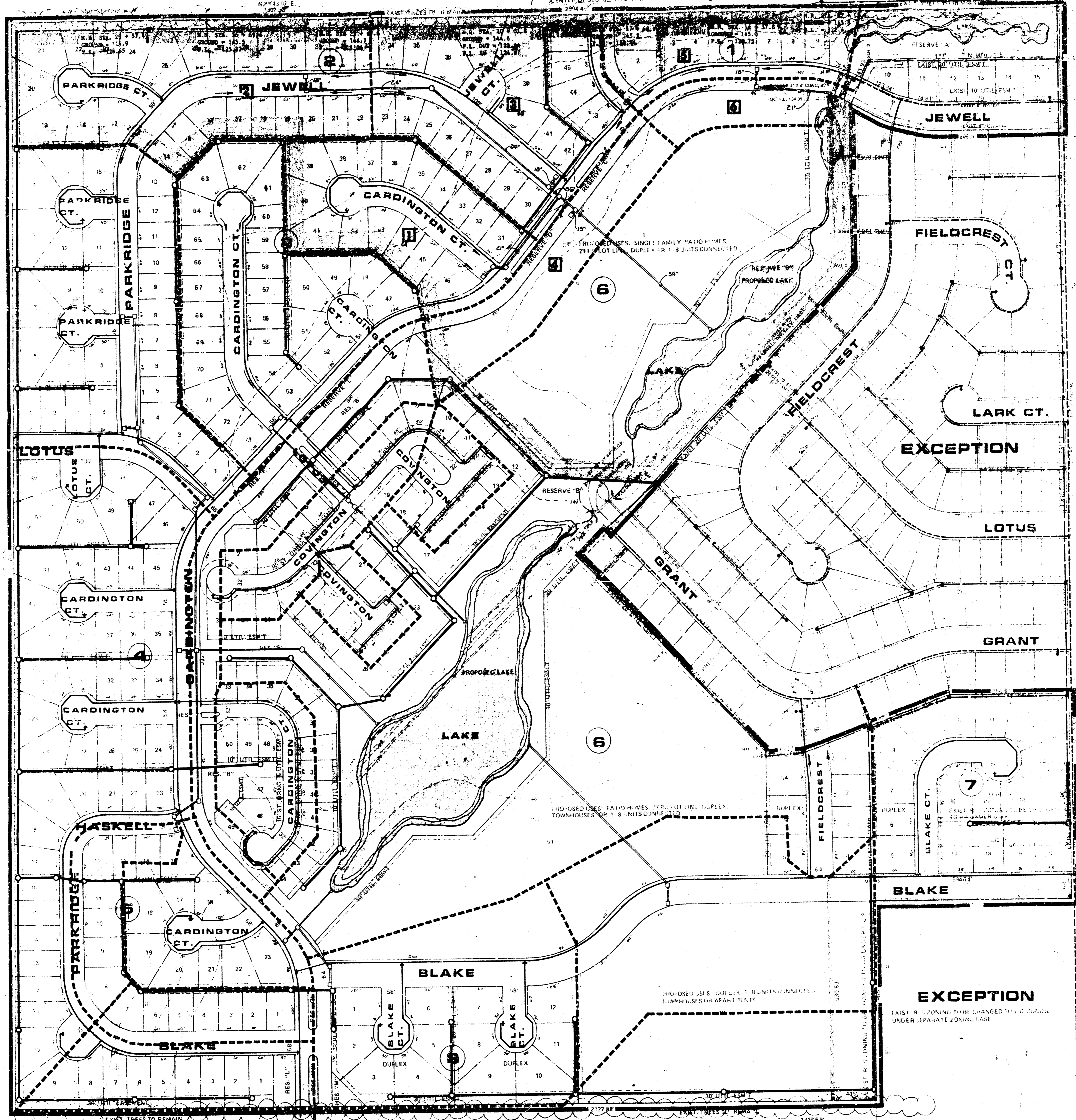

- 1 = 398 Acres
- 2 = 2.38 Acres
- 3 = 0.35 Acres
- 4 = 5.48 Acres
- 5 = 2.59 Acres
- 6 = 1.18 Acres

EX. MANHOLES
 M.H. GRNCEL

NOTES:
 1. ALL UTILITIES SHOWN ARE BASED ON RECORD PLANS AND FIELD SURVEY.
 2. THE LOCATION OF ALL UTILITIES SHALL BE VERIFIED BY FIELD SURVEY PRIOR TO CONSTRUCTION.
 3. THE LOCATION OF ALL UTILITIES SHALL BE VERIFIED BY FIELD SURVEY PRIOR TO CONSTRUCTION.
 4. THE LOCATION OF ALL UTILITIES SHALL BE VERIFIED BY FIELD SURVEY PRIOR TO CONSTRUCTION.
 5. THE LOCATION OF ALL UTILITIES SHALL BE VERIFIED BY FIELD SURVEY PRIOR TO CONSTRUCTION.

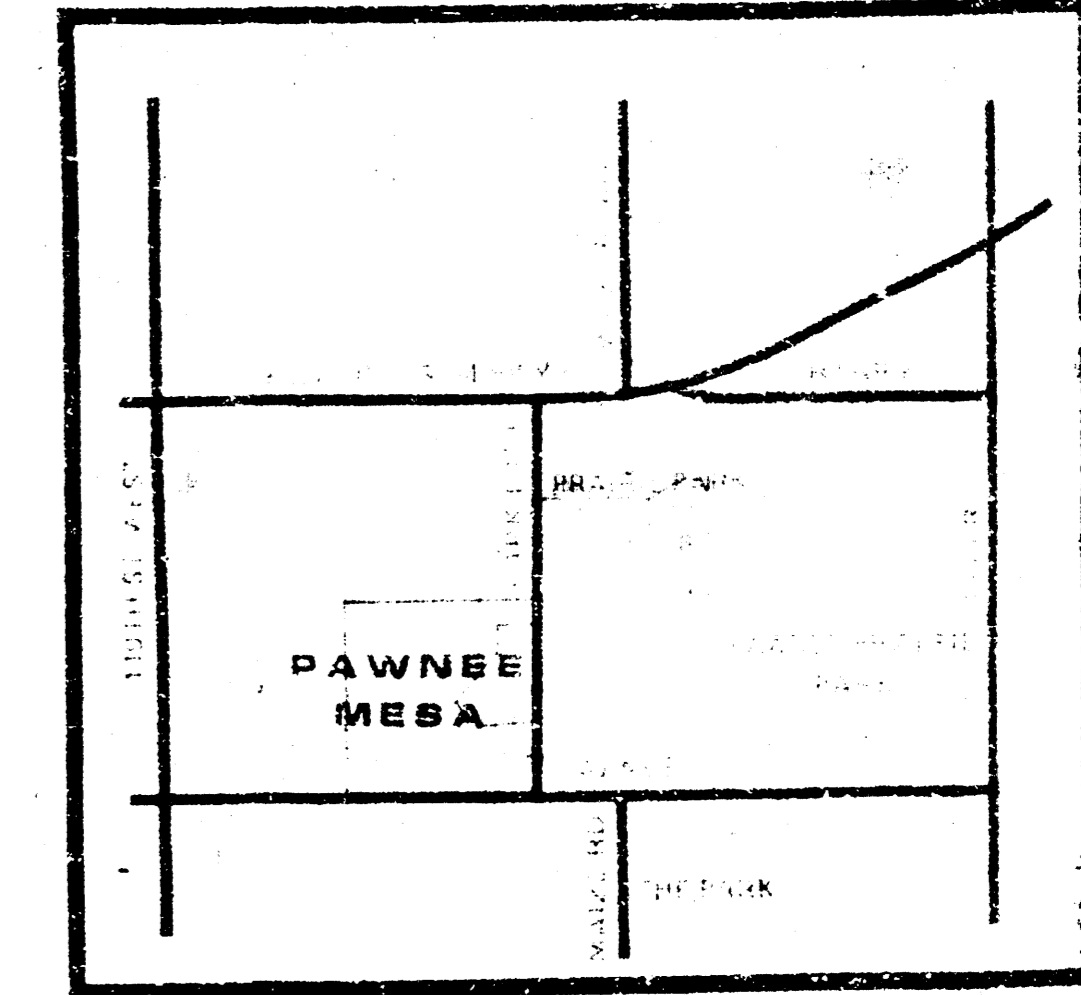

LOCATION MAP

PAWNEE MESA 4TH. ADDITION DRAINAGE CONCEPT & UTILITY LAYOUT

MID-KANSAS ENGINEERING CONSULTANTS PA
 3800 N. ROCK ROAD
 BUILDING 800
 WICHITA, KANSAS 67206
 682-6561

NO.	DESCRIPTION	AMOUNT	DATE	BY	REVISION
1	PAWNEE MESA 4TH. ADDITION DRAINAGE CONCEPT & UTILITY LAYOUT	1.00	01/15/20	JAC	1.00
2	REVISED DRAINAGE CONCEPT & UTILITY LAYOUT	1.00	02/10/20	JAC	2.00
3	REVISED DRAINAGE CONCEPT & UTILITY LAYOUT	1.00	03/05/20	JAC	3.00
4	REVISED DRAINAGE CONCEPT & UTILITY LAYOUT	1.00	04/01/20	JAC	4.00