

REED'S COVE 3RD ADDITION

WICHITA, SEDGWICK COUNTY, KANSAS

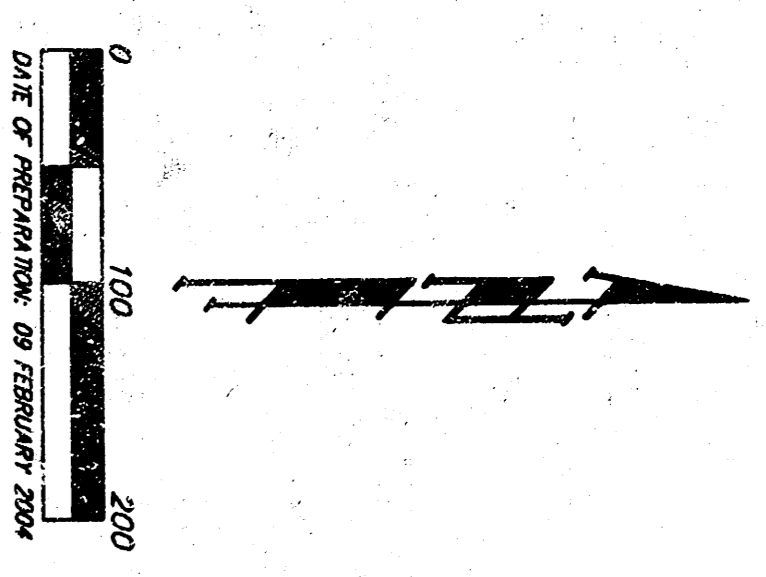

Block	Area	C2	C5	C100	C2	C5	C100
1	0.42	0.48	0.72	5.7	5.0	12.2	
2	1.6	0.42	0.48	0.72	2.6	8.8	
3	1.9	0.42	0.48	0.72	3.1	4.2	10.1
4	0.5	0.42	0.48	0.72	0.8	1.1	2.7
5	0.5	0.42	0.48	0.72	0.8	1.1	2.7
6	1.6	0.42	0.48	0.72	2.8	3.5	8.5
7	0.8	0.42	0.48	0.72	4.5	9.1	4.9
8	1.7	0.42	0.48	0.72	2.7	3.7	8.0
9	1.7	0.42	0.48	0.72	2.7	3.7	8.0
10	1.7	0.42	0.48	0.72	2.7	3.7	8.0
11	2.8	0.42	0.48	0.72	4.7	9.3	13.4
12	0.5	0.42	0.48	0.72	0.8	1.1	2.7
13	0.5	0.42	0.48	0.72	0.8	1.1	2.7
14	1.3	0.42	0.48	0.72	2.1	2.8	6.9
15	0.8	0.42	0.48	0.72	1.3	1.8	4.8
16	0.2	0.42	0.48	0.72	3.9	6.0	12.2
17	2.1	0.42	0.48	0.72	3.9	6.0	12.2
18	3.3	0.42	0.48	0.72	5.3	7.2	17.5

REVISIONS:

1. The date of Revision of Record north side of 21st St. N. Zone = 12123 City Datum

LOT	BLOCK	ELEVATION
6-11	A	170.0
12-18	A	168.0
19-24	A	165.6
25-30	A	165.6

MINIMUM BUILDING PAD ELEVATIONS FOR LOWEST BUILDING TO THE STRUCTURES

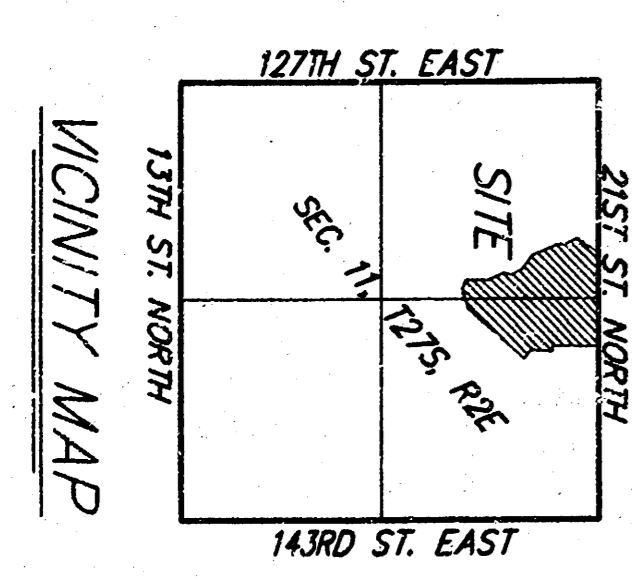
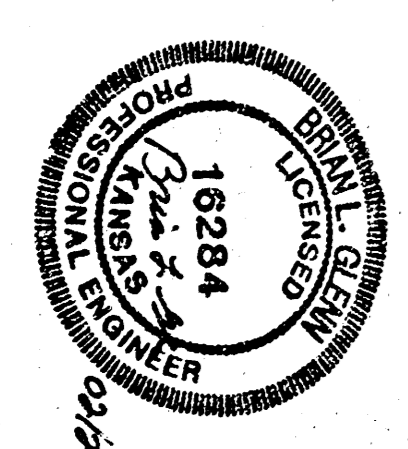

BAUGHMAN COMPANY P. A.
 ENGINEERING, SURVEYING & PLANNING
 318-252-2721 • 318 S. BLUE • WICHITA, KANSAS 67211
 January 2004