

WIND WOOD

| Drainage Area | Area (Acres) | Accum. Area | C ₁ | C ₁₀₀ | T _c | I ₂ (IN/HR) | I ₁₀₀ (IN/HR) | I ₂ (CFS) | Q ₁₀₀ (CFS) | Pipe Size | Pipe Slope | Inlets | |
|---------------|--------------|-------------|----------------|------------------|----------------|------------------------|--------------------------|----------------------|------------------------|-----------|------------|--------|-----------------------------|
| A | 2.66 | - | 0.56 | 0.71 | 29 | 21 | 2.72 | 6.38 | 4.05 | 12.07 | 15"RCP | 0.40% | L _W =5-ft. |
| B | 1.42 | - | 0.56 | 0.71 | 25 | 18 | 2.96 | 6.84 | 2.35 | 6.90 | - | - | L _W =5-ft. |
| Σ A,B | - | 4.08 | 0.56 | 0.71 | 29 | 21 | 2.72 | 6.39 | 6.21 | 18.51 | 18"RCP | 0.35% | - |
| C | 2.53 | - | 0.60 | 0.74 | 30 | 21 | 2.67 | 6.39 | 4.05 | 11.96 | 15"RCP | 0.40% | L _W =5-ft. |
| D | 4.42 | - | 0.52 | 0.68 | 20 | 15 | 3.33 | 7.37 | 7.65 | 22.15 | - | - | - |
| Σ A,B,C,D | - | 11.04 | 0.54 | 0.70 | 28 | 20 | 2.78 | 6.53 | 16.57 | 50.46 | 15"RCP | 0.16% | AREA INLET L=6'-0", W=5'-6" |
| E | 2.17 | - | 0.60 | 0.74 | 29 | 21 | 2.72 | 6.39 | 3.54 | 10.26 | 15"RCP | 0.40% | L _W =5-ft. |
| F | 3.72 | - | 0.52 | 0.68 | 16 | 15 | 3.72 | 7.37 | 7.20 | 18.64 | - | - | - |
| Σ E,F | - | 5.89 | 0.55 | 0.70 | 37 | 27 | 2.35 | 5.69 | 7.51 | 23.46 | 18"RCP | 0.60% | DROP INLET Double 24x24 |
| G | 1.12 | - | 0.60 | 0.74 | 24 | 17 | 3.03 | 7.00 | 2.04 | 5.80 | - | - | L _W =5-ft. |
| Σ E,F,G | - | 7.01 | 0.56 | 0.71 | 29 | 21 | 2.72 | 6.39 | 10.68 | 31.80 | 24"RCP | 0.25% | - |
| H | 2.33 | - | 0.60 | 0.74 | 19 | 15 | 3.42 | 7.37 | 4.78 | 12.71 | 24"RCP | 0.25% | L _W =5-ft. |

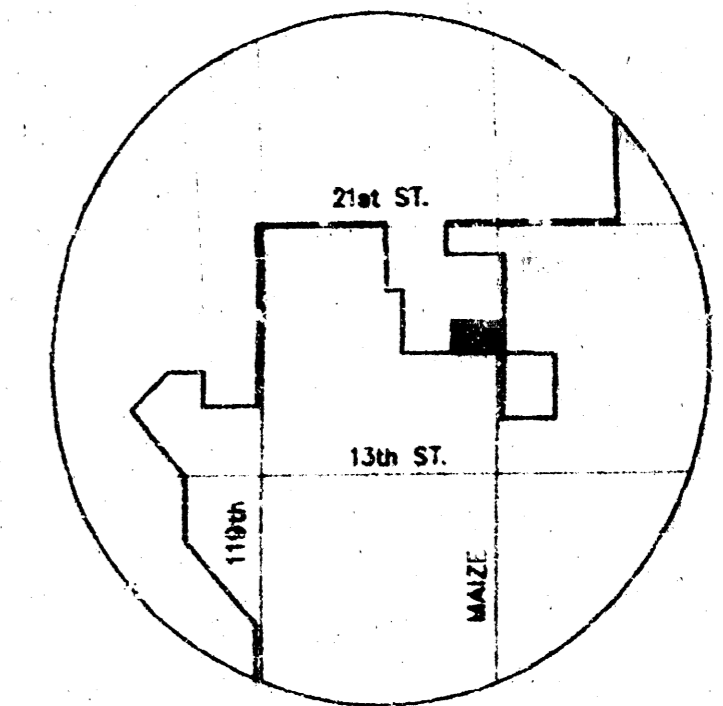

LOCATION MAP



SCALE 1" = 100'

DRAINAGE & UTILITY PLAN
WIND WOOD

OWNER/SUBDIVIDER: CRAMMER GRASS FARMS, INC.
DAVID D. CRAMMER
2801 N. MAIZE ROAD
WICHITA, KANSAS 67205

| | | |
|-------------------------|--------------|-------------|
| | WIND WOOD | |
| | PROJECT NAME | |
| DRAINAGE & UTILITY PLAN | | |
| SHEET TITLE | | |
| DESIGN BY: | KKL | DSS |
| DRAWN BY: | | CHECKED BY: |
| DATE: 12/6/03 | 33060-100 | 1 of 1 |
| 316-684-0600 | | DATE |

TIMBER RIDGE ADDITION

UNPLATTED

STONEGATE ESTATES

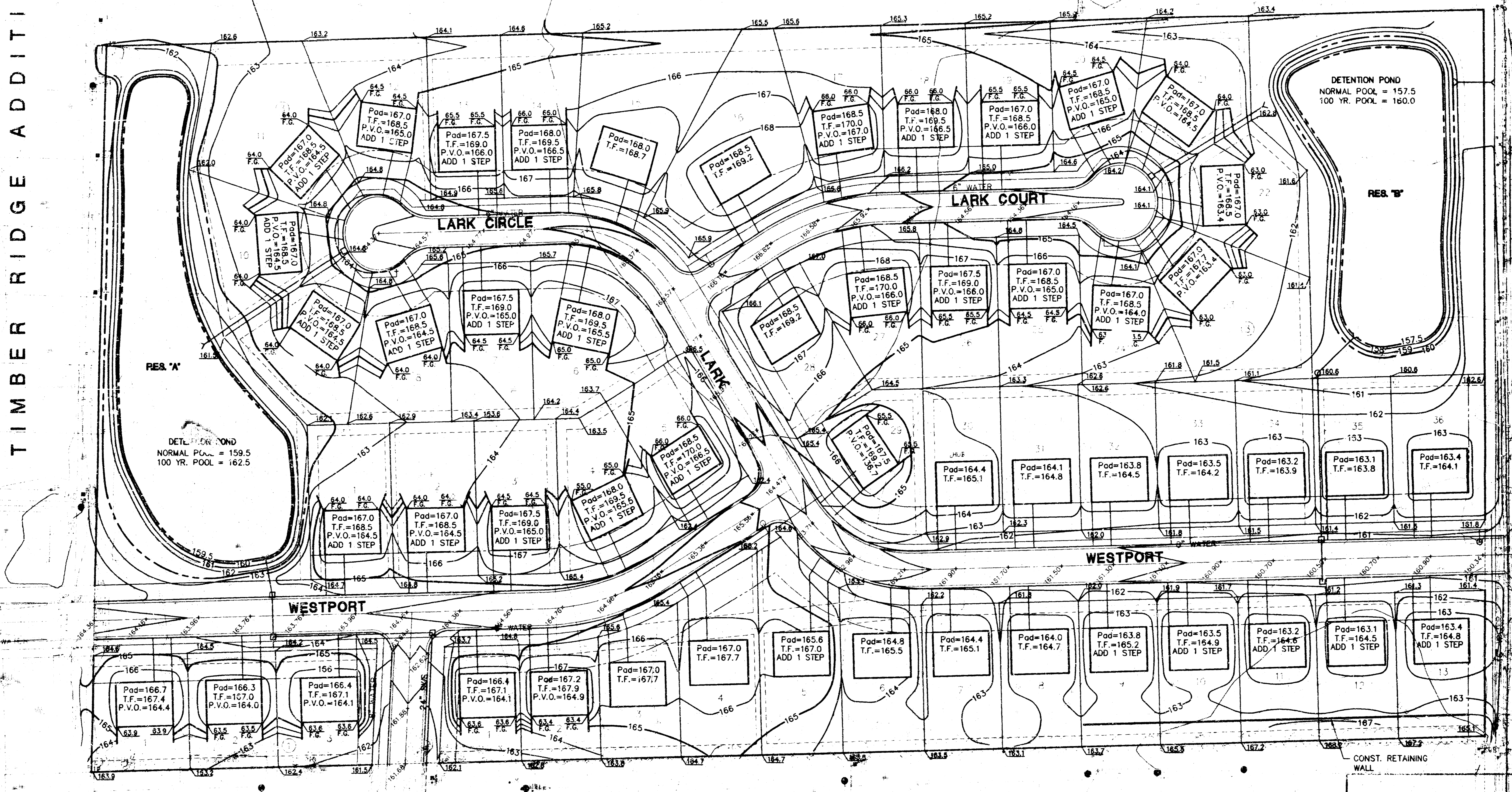

MAIZE ROAD



WEST LINK VILLAGE FOURTEENTH ADDITION

S.E. COR., N.E. 1/4, SEC. 7, T27S, R1W

LEGEND

| | |
|-------------------|-----------------------------------|
| 135.0 | Proposed Elevations |
| 135.0 | Proposed Elevations |
| V.O. | Top of View Wall Elevation |
| T.F. | Top of Foundation |
| Pad | Elevation @ Garage Door Elevation |
| P.V.O. (See Note) | Partial View Wall Elevation |
| 140 | Proposed Contour |
| → | Flow Arrow |

Note: P.V.O.'s may be V.O.'s depending on the number of steps added.
Builders shall drop siding or brick ledges or build a retaining wall to transition between properties.

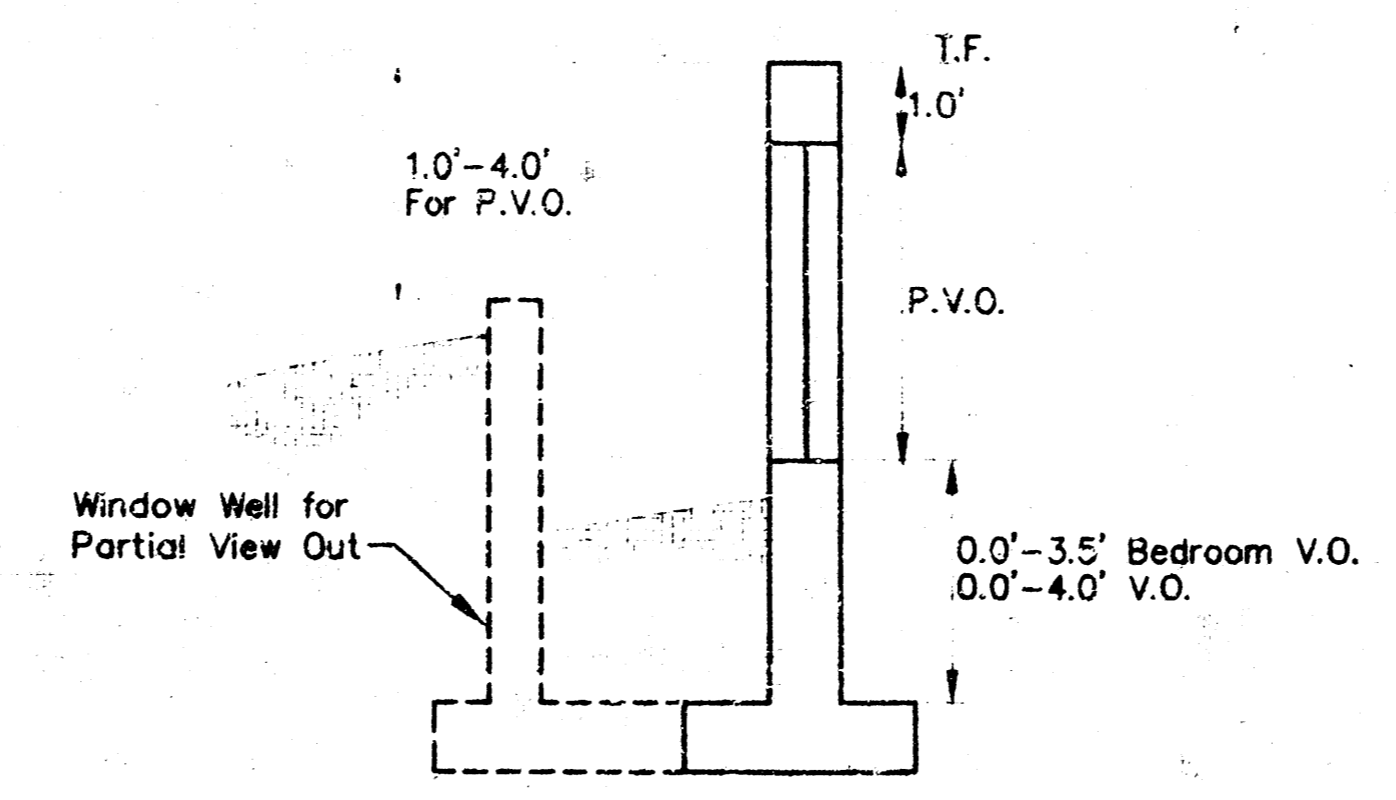

VIEW OUT & PARTIAL VIEW OUT DETAIL

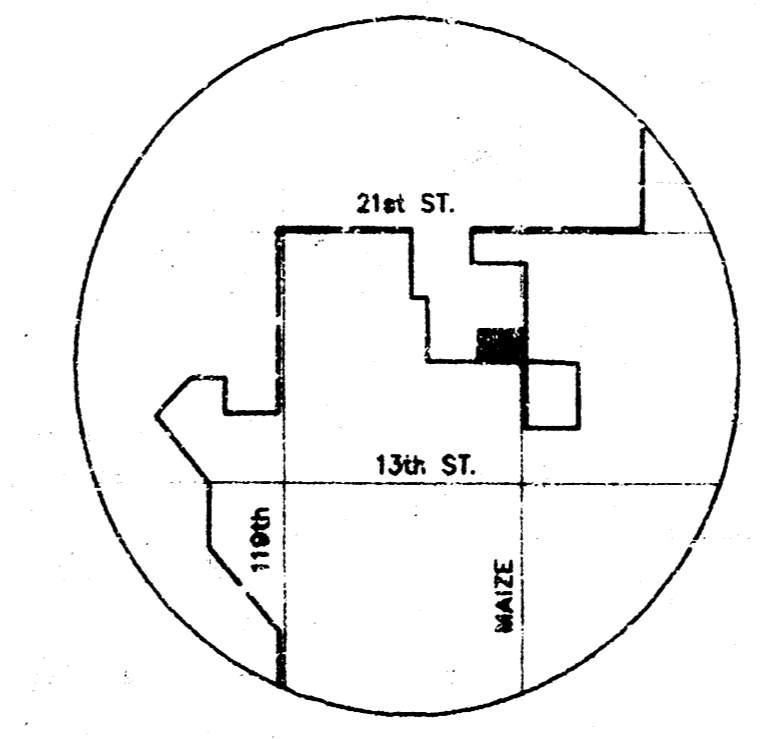

LOCATION MAP

APPROVED
DRAINAGE PLAN

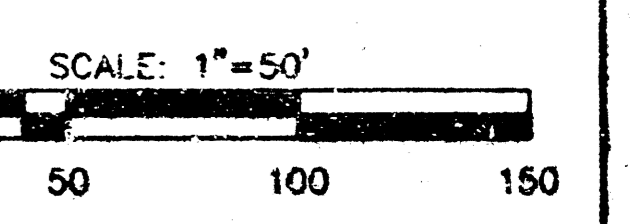

| | | | |
|------------|---------------------------|---------------|--|
| | WIND WOOD ADDITION | | |
| | PROJECT NAME | | |
| | GRADING PLAN | | |
| | SHEET TITLE | | |
| G.J.A. | B.D.M. | G.J.A./D.S.S. | |
| DESIGN BY: | DRAWN BY: | CHECKED BY: | |
| SEPT. 1995 | 19560GRAD | 1 / 1 | |
| DATE | JOB NO. | SHEET/OF | |

MID-KANSAS ENGINEERING CONSULTANTS, INC. 411 N. WEBB ROAD WICHITA, KS. 67206 316-684-9400