

# Drainage Plan

## CITY HALL COMPLEX ADDITION

### Wichita, Sedgwick County, Kansas

$T_c = 10 \text{ min for all areas}$   
 $C_{10} = 0.87 \quad I_{10} = 6.09$   
 $C_{100} = 0.91 \quad I_{100} = 8.54$

SUB-BASIN	DRAINAGE AREA	Q <sub>10</sub>	Q <sub>100</sub>	REMARKS
1A	.10 Ac.	.53	.78	SEE NOTES 1-4
1B	.04 Ac.	.21	.31	SEE NOTES 1-4
1C	.08 Ac.	.42	.62	SEE NOTES 1-4
1D	.13 Ac.	.69	1.01	SEE NOTES 1-4
1E	.74 Ac.	3.92	5.75	SEE NOTES 1-4
1F	.50 Ac.	2.65	3.90	SEE NOTES 1-4
1G	.26 Ac.	1.38	2.02	SEE NOTES 1-4
1H	.27 Ac.	1.43	2.10	SEE NOTES 1-4
2A	1.53 Ac.	8.10	11.90	SEE NOTE 5
3A	.28 Ac.	1.48	2.18	SEE NOTE 5
3B	.27 Ac.	1.43	2.10	SEE NOTE 5
4A	2.00 Ac.	10.6	15.54	SEE NOTE 5
4B	.57 Ac.	3.02	4.43	SEE NOTE 5
4C	.75 Ac.	3.98	5.83	SEE NOTE 5
4D	.30 Ac.	1.59	2.33	SEE NOTE 5
4E	.59 Ac.	3.13	4.58	SEE NOTE 5
4F	.28 Ac.	1.48	2.18	SEE NOTE 5
4G	.16 Ac.	.85	1.24	SEE NOTE 5
4H	.53 Ac.	2.80	4.12	SEE NOTE 5
5A	.41 Ac.	2.17	3.19	SEE NOTE 5
5B	.19 Ac.	1.00	1.48	SEE NOTE 5
5C	.48 Ac.	2.54	3.73	SEE NOTE 5
5D	.49 Ac.	2.60	3.80	SEE NOTE 5
5E	1.24 Ac.	6.57	9.63	SEE NOTE 5
5F	.63 Ac.	3.34	4.90	SEE NOTE 5
6	.50 Ac.	2.65	3.89	SEE NOTE 5

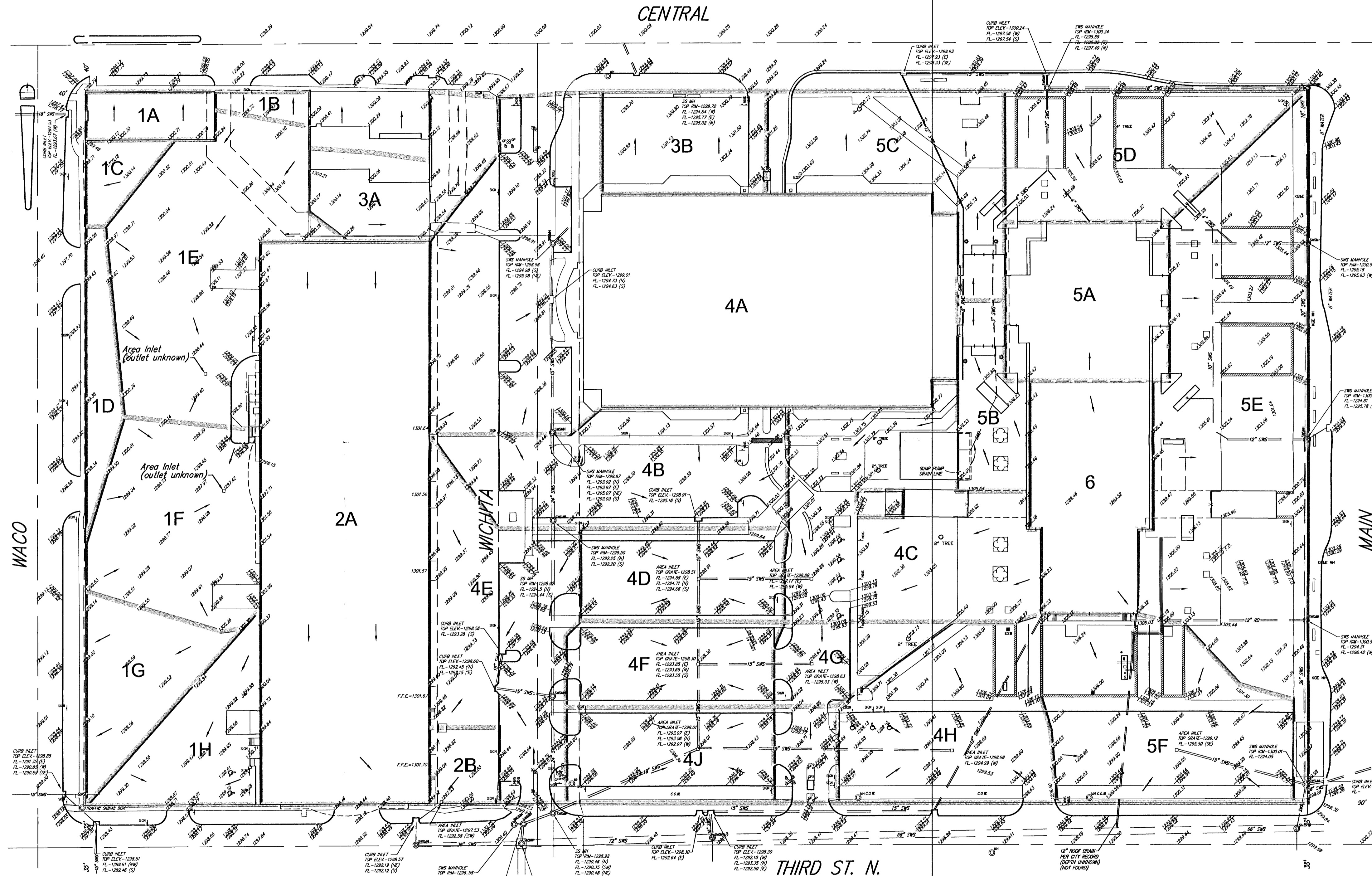

#### NOTES:

- Excess runoff from the 100-year design storm will be detained and/or retained on site by means of parking lot and raingarden detention, rooftop or underground storage, or porous pavement.
- Parking lot detention will be limited to 8" depth, except that every parking space where 8" depth may be exceeded shall have a post-mounted warning sign at the front of the stall, clearly noting: "WARNING - STORMWATER PONDING AREA".
- Excess runoff will be calculated on the basis of the change in impervious area from the existing land use to the proposed land use as indicated on the final site plan.
- Final drainage system design, including runoff and detention calculations, to be designed under Engineering Division contract for low impact drainage.
- Designated sub-basins to remain as existing conditions.



BENCHMARK: SQUARE CUT ON TOP OF CURB AT S.E. CORNER OF CONC. SLAB ON NORTH SIDE OF WHEAT STABLE, SOUTH SIDE OF CENTRAL AVE. ELEVATION = 1300.97 (NGVD29)  
 BENCHMARK: SQUARE CUT ON TOP OF CURB AT THE CENTERLINE OF CENTRAL, 136' EAST OF WACO ELEVATION = 1299.54 (NGVD29)  
 BENCHMARK: SQUARE CUT AT THE S.E. CORNER OF CONCRETE TRAFFIC SIGNAL BASE, N.W. CORNER OF MAIN STREET AND 3RD STREET NORTH ELEVATION = 1299.89 (NGVD29)

GROSS AREA:  
 580,057.3 Sq. Ft.±  
 13.32 Acres±

DATE OF TOPOGRAPHY:  
 MAY 1, 2007

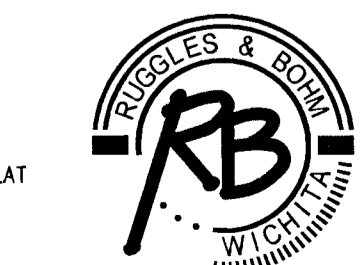
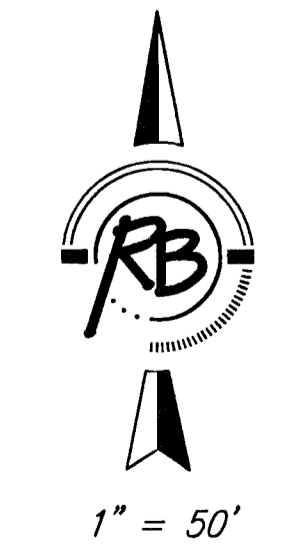
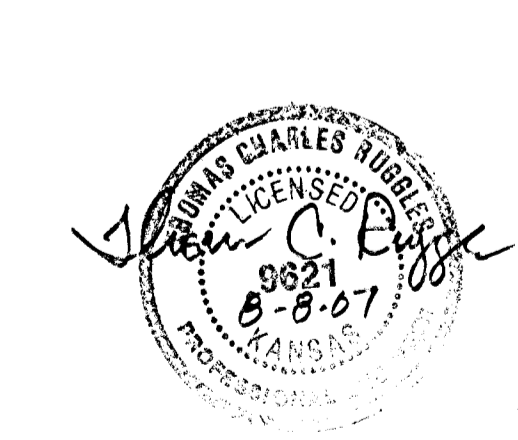

**Ruggles & Bohm, P.A.**  
 Engineering, Surveying, Land Planning  
 924 North Main  
 Wichita, Kansas 67203  
 (316) 264-8008  
 (316) 264-4621 fax  
 E-mail: info@rbkansas.com

DWG FILE: PRELIMINARY PLAT  
 PROJECT NO. 3037P  
 JULY 23, 2007