

**BENCHMARKS**

- BM#1 C.O.W. disc 0.5 miles east of Maize Rd. on 29th St. N. 25' ± N. of centerline of 29th St. Elev.=160.86
- BM#2 RR Spike in South face of South H-pole 6th H-pole West of Tyler Rd. and 1/2 Mile N. of 29th St. N. Elev.=166.37
- BM#3 PK nail (point numbered 201) in asphalt on bike path 60 feet South of 33rd St. N. on East side of Maize Rd. 28 feet NW. of PP. Elev.=163.97
- BM#4 RR spike in NW face of PP N. side of 29th St. N., 6th PP West of C.O.W. Disc (Disc 1/2 mile East of Maize Rd. Elev.=164.55

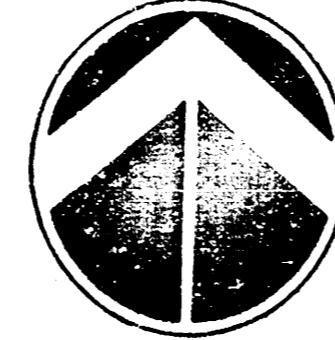

SCALE: 1" = 100'  
100 0 100 200

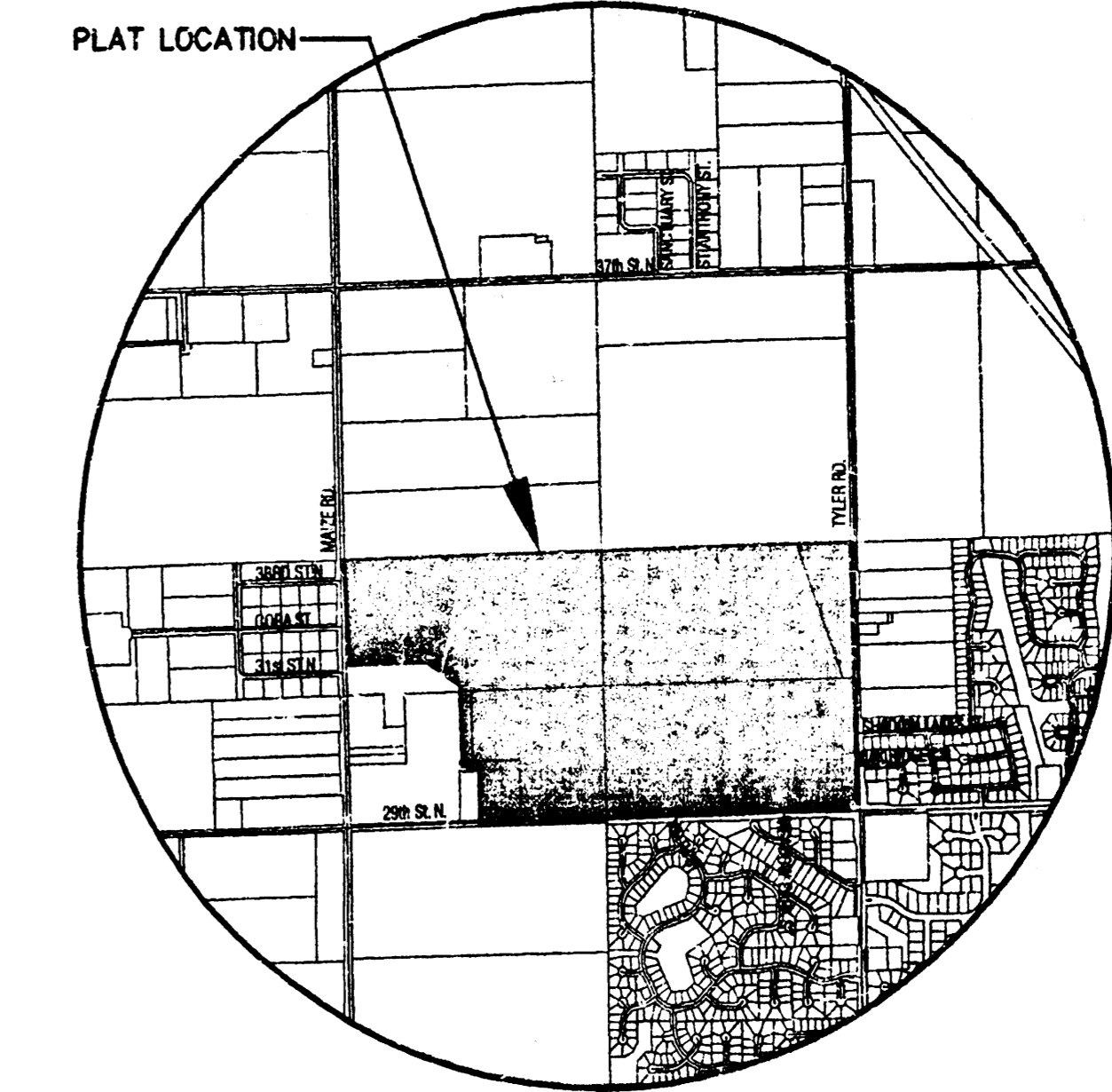

VICINITY MAP

MINIMUM PAD ELEVATIONS (LOWEST OPENINGS)			
LOT	BLOCK	ELEVATION (CITY DATUM)	HYDRAULIC GRADE LINE (CITY)
1	1	N/A	N/A
2	1	N/A	N/A
3	1	N/A	N/A
4	1	N/A	N/A
5	1	165.6	1353.0
6	1	165.4	1352.8
7	1	N/A	N/A
8	1	N/A	N/A
9	1	N/A	N/A
10	1	N/A	N/A
11	1	N/A	N/A
12	1	N/A	N/A
13	1	165.2	1352.6
14	1	165.0	1352.4
15	1	N/A	N/A
16	1	N/A	N/A
17	1	N/A	N/A
18	1	N/A	N/A
19	1	N/A	N/A
20	1	N/A	N/A
21	1	N/A	N/A
22	1	N/A	N/A
23	1	N/A	N/A
24	1	N/A	N/A
25	1	N/A	N/A
26	1	N/A	N/A
27	1	165.0	1353.6
28	1	166.2	1353.6
29	1	166.2	1353.6
30	1	166.2	1353.6
31	1	166.2	1353.6
32	1	166.2	1353.6
33	1	166.2	1353.6
34	1	166.2	1353.6
35	1	166.2	1353.6
36	1	166.2	1353.6
37	1	166.2	1353.6
38	1	166.2	1353.6
39	1	166.2	1353.6
40	1	166.2	1353.6
41	1	166.2	1353.6
42	1	N/A	N/A
43	1	N/A	N/A
44	1	N/A	N/A
45	1	N/A	N/A
1	4	N/A	N/A
2	4	N/A	N/A
3	4	N/A	N/A
4	4	N/A	N/A
5	4	N/A	N/A
6	4	N/A	N/A
7	4	N/A	N/A
8	4	N/A	N/A
9	4	N/A	N/A
10	4	N/A	N/A
11	4	N/A	N/A
12	4	N/A	N/A
13	4	N/A	N/A

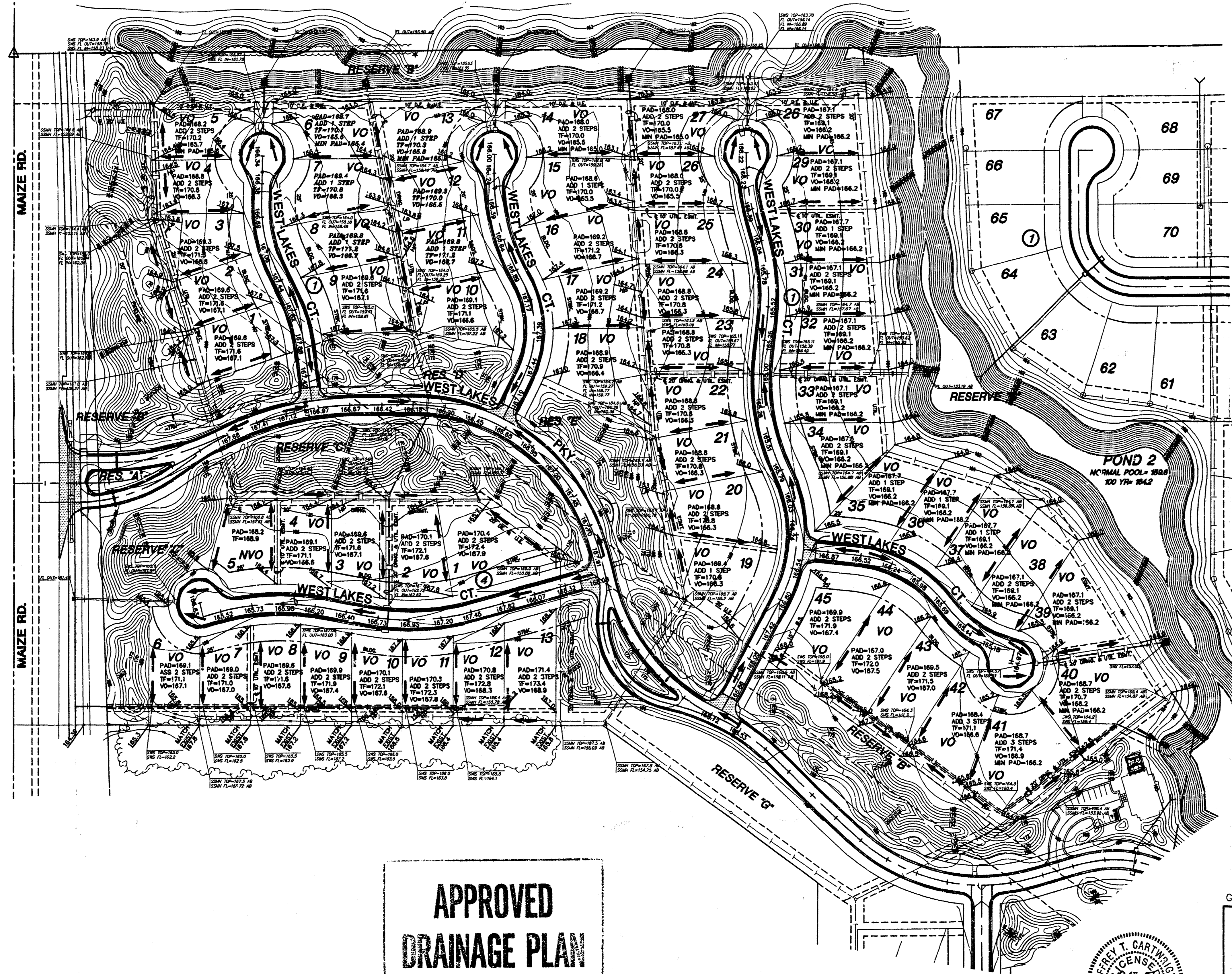

- LEGEND**
- CT - CONIFEROUS TREE & DIAMETER
  - DT - DECIDUOUS TREE & DIAMETER
  - SN - SIGN
  - B - BUSH
  - ET - EDGE OF TREES
  - F - FENCE
  - SMH - SANITARY SEWER MANHOLE
  - GM - GAS METER
  - PO - POLE
  - HLP - HIGH LINE POLE
  - G - GATE
  - W - WALL
  - LP - LIGHT POLE
  - FH - FIRE HYDRANT
  - WV - WATER VALVE
  - WM - WATER METER
  - PP - POWER POLE AND GUY ANCHOR
  - TR - TELEPHONE RISER
  - I - INLET
  - SSP - STORM SEWER PIPE
  - WL - WATER LINE
  - SSL - SANITARY SEWER LINE
  - GL - GAS LINE
  - TL - TELEPHONE LINE
  - UEL - UNDERGROUND ELECTRIC LINE
  - OEL - OVERHEAD ELECTRIC
  - UF - UNDERGROUND FIBER OPTIC CABLE
  - SC - SECTION CORNER
  - PCF - PROPERTY CORNER FOUND
  - B - BENCHMARK
  - WO - WALK OUT
  - VO - VIEW OUT
  - PVO - PARTIAL VIEW OUT
  - PWO - PARTIAL WALK OUT
  - NVO - NO VIEW OUT
  - WO\* - WALKOUT WHICH MAY REQUIRE THICKER FOOTING AND/OR ENGINEERED FILL UNDER FOOTINGS
  - PROP. HOUSE ELEV. - PROP. HOUSE ELEV.
  - EXIST. PLOT PLAN HOUSE ELEV. - EXIST. PLOT PLAN HOUSE ELEV.

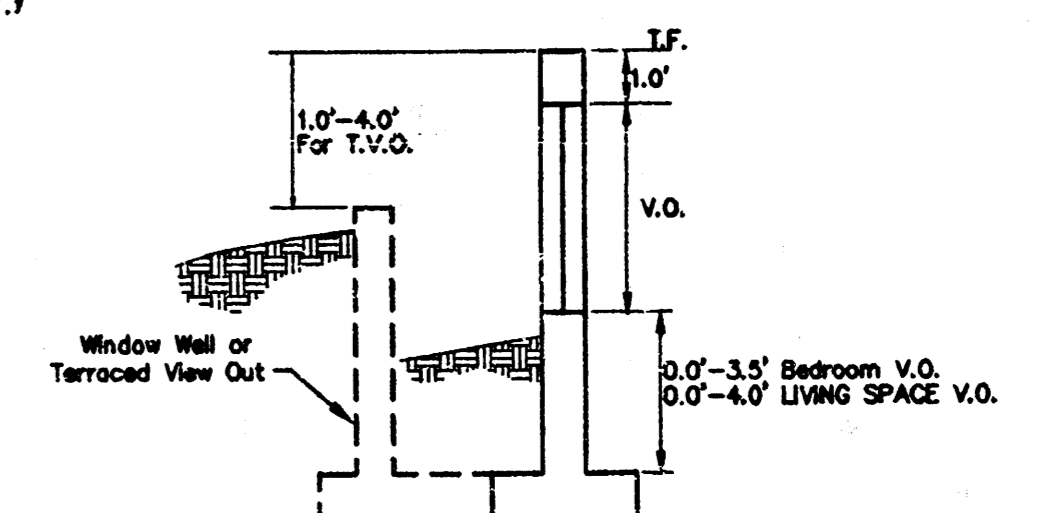

VIEW OUT & TERRACED VIEW OUT DETAIL

**APPROVED  
DRAINAGE PLAN**

**PHASE 2 - LOT GRADING PLAN  
FOX RIDGE ADDITION**

REVISED: SEPTEMBER 2005  
REVISED: AUGUST 2005  
**DATE: NOVEMBER 2004**

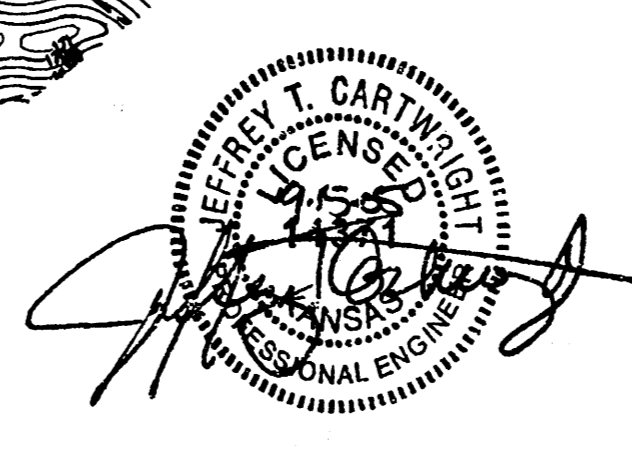

G:\CIVL\99118\DWG\GRAD\Lot Grading Plans\99118\_VO-WO\_MAP-Phase2.dwg

**FOX RIDGE ADDITION (PHASE 2)**  
PROJECT NAME

**PHASE 2 - VIEW-OUT / WALK-OUT MAP**  
SHEET TITLE

**MKEC ENGINEERING CONSULTANTS**  
411 N. WEBB ROAD  
WICHITA, KS. 67206  
316-684-9999

DESIGN BY: **KLA**      DRAWN BY: **SMD/KWS**      CHECKED BY: **GJA**

DATE: **AUGUST 2005**      99118\_VO-WO\_MAP      1 / 1  
JOB NO.      SHEET OF