

# DRAINAGE PLAN

## BAREFOOT BAY ESTATES

### WICHITA, SEDGWICK COUNTY, KANSAS

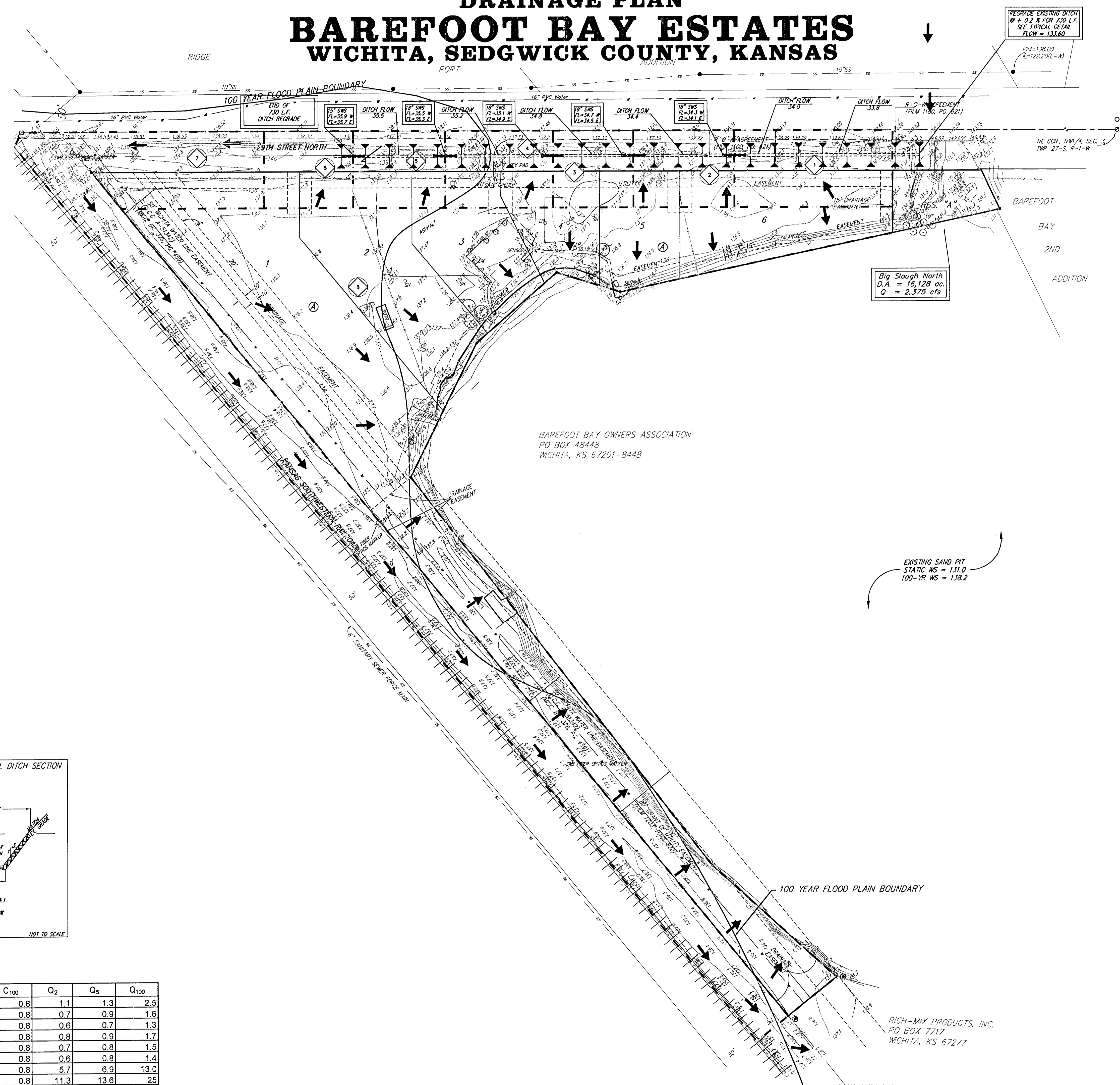

PREGRADE EXISTING DITCH  
 @ + 0.2' FOR 7.50 L.F.  
 SEE TYPICAL DETAIL  
 FLOW = 133.60  
 RM = 138.00  
 E = 122.20(E-W)

Big Slough North  
 D.A. = 16,128 ac.  
 Q = 2,375 cfs

BAREFOOT BAY OWNERS ASSOCIATION  
 PO BOX 48448  
 WICHITA, KS 67201-8448

EXISTING SAND PIT  
 STATIC WS = 131.0  
 100-YR WS = 138.2

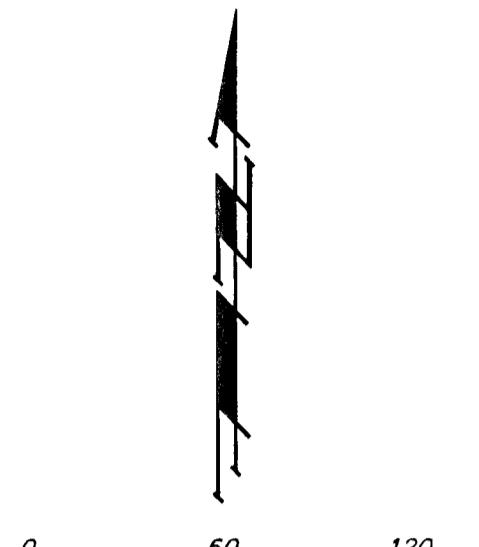

DATE OF PREPARATION = 9 JUNE 2003  
 CONTOUR INTERVAL = 1 FOOT  
 DATE OF TOPOGRAPHY = 28 OCTOBER 2000

- # = #1 REBAR W/ "BAUGHMAN" CAP (FOUND)
- \* = #4 REBAR W/ "BAUGHMAN" CAP (SET)
- ⊙ = #4 REBAR W/ "DOKS" CAP (FOUND)
- = 3/4" REBAR W/ "PEC" CAP (FOUND)
- ⊖ = 3/4" IRON (FOUND)
- = RAILROAD SPOKE (FOUND)

**Drainage Note:**  
 A Portion of Subject Property Is Located in  
 a FEMA Special Flood Hazard Area (Zone  
 A2), per The Below FIRM Panel.  
 (Community/ Panel Number: 200321  
 0125A) Effective Date: June 3, 1986.

MINIMUM BUILDING PAD ELEVATIONS FOR LOWEST OPENING TO THE STRUCTURES		
LOT	BLOCK	ELEVATION CITY DATUM
1-6	A	141.0

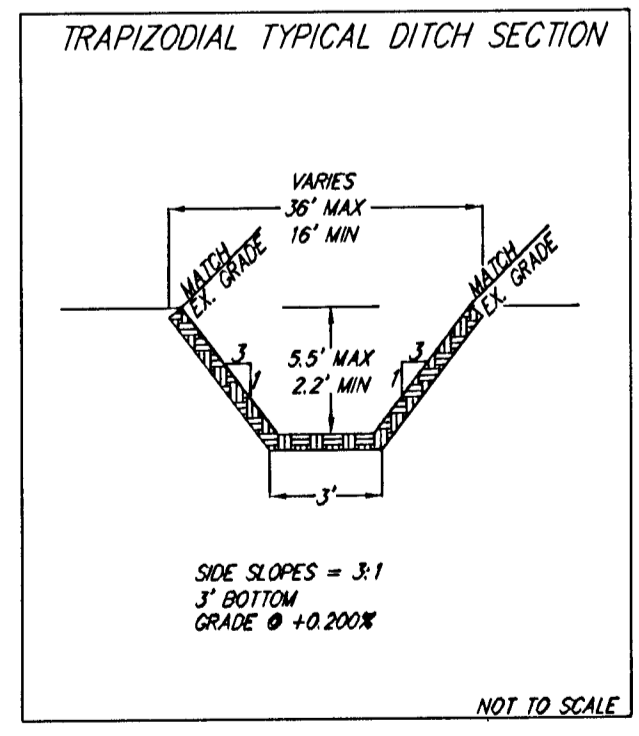

Basin #	Acres	C <sub>2</sub>	C <sub>5</sub>	C <sub>100</sub>	Q <sub>2</sub>	Q <sub>5</sub>	Q <sub>100</sub>
1	0.43	0.68	0.69	0.8	1.1	1.3	2.5
2	0.27	0.68	0.69	0.8	0.7	0.9	1.6
3	0.22	0.68	0.69	0.8	0.6	0.7	1.3
4	0.29	0.68	0.69	0.8	0.8	0.9	1.7
5	0.25	0.68	0.69	0.8	0.7	0.8	1.5
6	0.24	0.68	0.69	0.8	0.6	0.8	1.4
7	2.20	0.68	0.69	0.8	5.7	6.9	13.0
8	4.32	0.68	0.69	0.8	11.3	13.6	25

RICH-MIX PRODUCTS, INC.  
 PO BOX 7717  
 WICHITA, KS 67277