

AERIAL EXHIBIT
 EDGE WATER ADDITION
 WICHITA, SEDGWICK COUNTY, KANSAS

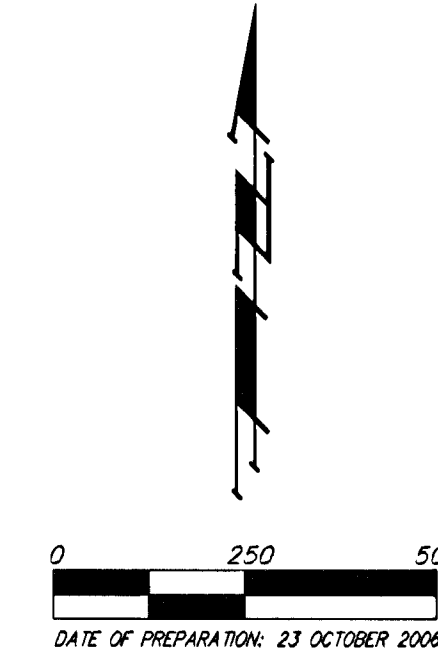

BOUNDARIES:
 HOOPER AND 45TH ST NORTH
 100' BOUNDARY AT CORNER OF INTERSECTION
 15' 0" FT SIDE OF HWY
 25' 0" FT SIDE OF SW CORNER
 25' 0" FT NORTH OF LINE MARKER
 15' 0" FT EAST OF INTERSECTION
 15' 0" FT NORTH OF CENTERLINE
 ELEVATION: 1222.29 (SPOT 93)

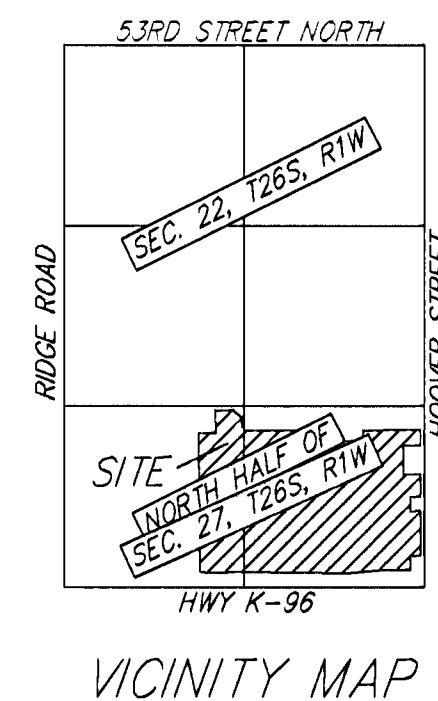

SITE INFORMATION:
TOTAL AREA: 147± ACRES

NOTES: No FEMA Special Flood Hazard Area exists on this property as of January 25, 2007.