

STAFF REPORT
(One-Step Final Plat)

CASE NUMBER: SUB 2005-151 -- MYERS ACRES ADDITION

OWNER/APPLICANT: Jeffrey D. Myers, 4200 S. Gilda, Wichita, KS 67215

SURVEYOR/ENGINEER: Baughman Company, P.A., 315 Ellis, Wichita, KS 67211

LOCATION: South of MacArthur, East of Ridge

SITE SIZE: 6.98 acres

NUMBER OF LOTS

Residential:	1
Office:	
Commercial:	
Industrial:	
Total:	<u>1</u>

MINIMUM LOT AREA: 6.98 acres

CURRENT ZONING: SF-20, Single-Family Residential

PROPOSED ZONING: Same

*Approved
40*

VICINITY MAP

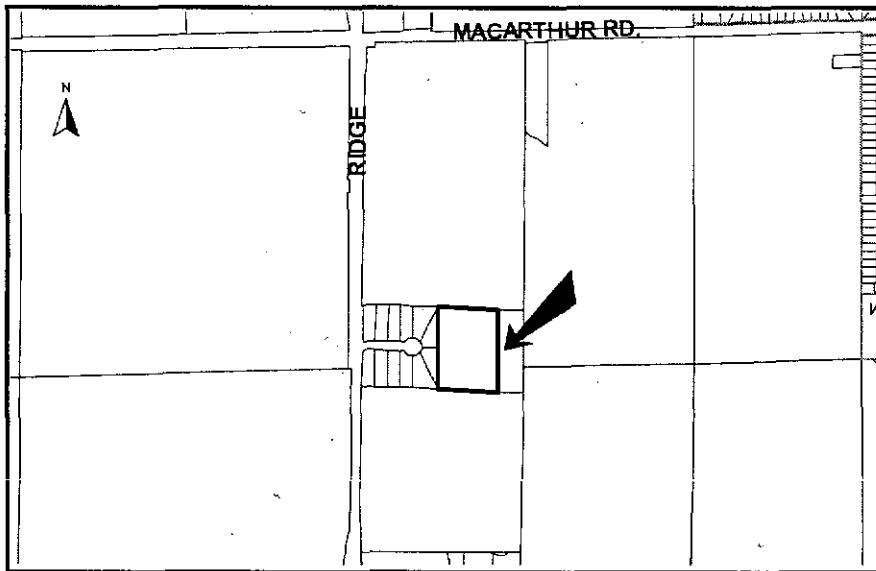

NOTE: This is unplatted property located in the County within three miles of the City of Wichita. It is in an area designated as "2030 Urban growth area" by the Wichita-Sedgwick County Comprehensive Plan.

STAFF COMMENTS:

- A. Since neither sanitary sewer nor municipal water is available to serve this property, the applicant shall contact County Code Enforcement to find out what tests may be necessary and what standards are to be met for approval of on-site sewerage and water wells. A memorandum shall be obtained specifying approval.
- B. In accordance with the Urban Fringe Development Standards, the subdivider shall contact the City of Wichita to determine the financial feasibility of connecting the proposed subdivision to the city water system. If financially feasible, the subdivision shall be connected to Wichita's water system in accordance with City of Wichita standards.
- C. City of Wichita Water and Sewer Department requests a petition for future extension of sanitary sewer and City water services
- D. If improvements are guaranteed by petition, a notarized certificate listing the petitions shall be submitted to the Planning Department for recording.
- E. County Engineering needs to comment on the status of the applicant's drainage plan. *The submitted drainage plan shows a greater area than being platted. The drainage plan is under review.*
- F. The applicant shall file a covenant for perpetual maintenance of the private access road per Sedgwick County Fire Department requirements
- G. An onsite benchmark is needed.
- H. Sedgwick County Fire Department advises that all access drives shall be in accordance with Sedgwick County Service Drive Code.
- I. The applicant shall grant by separate instrument, an off-site temporary cul-de-sac as denoted on the plat.
- J. The plat's text shall reference ownership and maintenance of the proposed reserves. The applicant shall either form a lot owners' association prior to recording the plat or shall submit a covenant stating when the association will be formed, when the reserves will be deeded to the association and who is to own and maintain the reserves prior to the association taking over those responsibilities.
- K. For those reserves being platted for drainage purposes, the required covenant which provides for ownership and maintenance of the reserves shall grant, to the appropriate governing body, the authority to maintain the drainage reserves in the event the owner(s) fail to do so. The covenant shall provide for the cost of such maintenance to be charged back to the owner(s) by the governing body.
- L. The pipeline easement needs to be located.

- M. The applicant shall submit a copy of the instrument, which establishes the pipeline easements on the property, which verifies that the easements shown are sufficient and that utilities may be located adjacent to and within the easements. Any relocation, lowering or encasement of the pipeline, required by this development, will not be at the expense of the County.
- N. Owner will need permission from pipeline company for driveway crossing.
- O. The Applicant is reminded that a platting binder is required with the final plat. Approval of this plat will be subject to submittal of this binder and any relevant conditions found by such a review.
- P. The applicant shall install or guarantee the installation of all utilities and facilities that are applicable and described in Article 8 of the MAPC Subdivision Regulations. (Water service and fire hydrants required by Article 8 for fire protection shall be as per the direction and approval of the Chief of the Fire Department.)
- Q. The applicant's engineer is advised that the Register of Deeds is requiring the name(s) of the notary public, who acknowledges the signatures on this plat, to be printed beneath the notary's signature.
- R. To receive mail delivery without delay, and to avoid unnecessary expense, the applicant is advised of the necessity to meet with the U.S. Postal Service Growth Management Coordinator (Phone: 316-946-4556) prior to development of the plat so that the type of delivery, and the tentative mailbox locations can be determined.
- S. The applicant is advised that various State and Federal requirements (specifically but not limited to the Army Corps of Engineers, Kanopolis Project Office, Rt. 1, Box 317, Valley Center, KS 67147) for the control of soil and wind erosion and the protection of wetlands may impact how this site can be developed. It is the applicant's responsibility to contact all appropriate agencies to determine any such requirements.
- T. The owner of the subdivision should note that any construction that results in earthwork activities that will disturb one (1) acre or more of ground cover requires a Federal/State NPDES Storm Water Discharge Permit from the Kansas Department of Health and Environment in Topeka. Also, for projects located within the City of Wichita, erosion and sediment control devices must be used on ALL projects. For projects outside of the City of Wichita, but within the Wichita Metropolitan area, the owner should contact the appropriate governmental jurisdiction concerning erosion and sediment control device requirements.
- U. Perimeter closure computations shall be submitted with the final plat tracing.
- V. Recording of the plat within 30 days after approval by the City Council and/or County Commission.
- W. The representatives from the utility companies should be prepared to comment on the need for any additional utility easements to be platted on this property.
- X. A compact disc (CD), which will be used by the City and County GIS Departments, detailing the final plat in digital format in AutoCAD. If a disc is not provided, please send via e-mail to Cheryl Holloway (E-Mail address: cholloway@wichita.gov). Please include the name of the plat on the disc.