

STAFF REPORT
(Preliminary Plat)

CASE NUMBER: SUB 2007-36 -- THE WATERFRONT RESIDENTIAL ADDITION

OWNER/APPLICANT: Waterfront Residential Company, LLC, Attn: Rob Ramseyer, 8100 E. 22nd St. Bldg. #1000, Wichita, KS 67226

SURVEYOR/AGENT: MKEC Engineering Consultants, Inc., Attn: Greg Allison, 411 N. Webb Rd., Wichita, KS 67206

LOCATION: North side of 13th St. North, West of Greenwich Road

SITE SIZE: 59.61 acres

NUMBER OF LOTS

Residential:	74
Office:	
Commercial:	
Industrial:	
Total:	<u>74</u>

MINIMUM LOT AREA: 10,400 square feet

CURRENT ZONING: LI, Limited Industrial

PROPOSED ZONING: SF-5, Single-Family Residential

VICINITY MAP

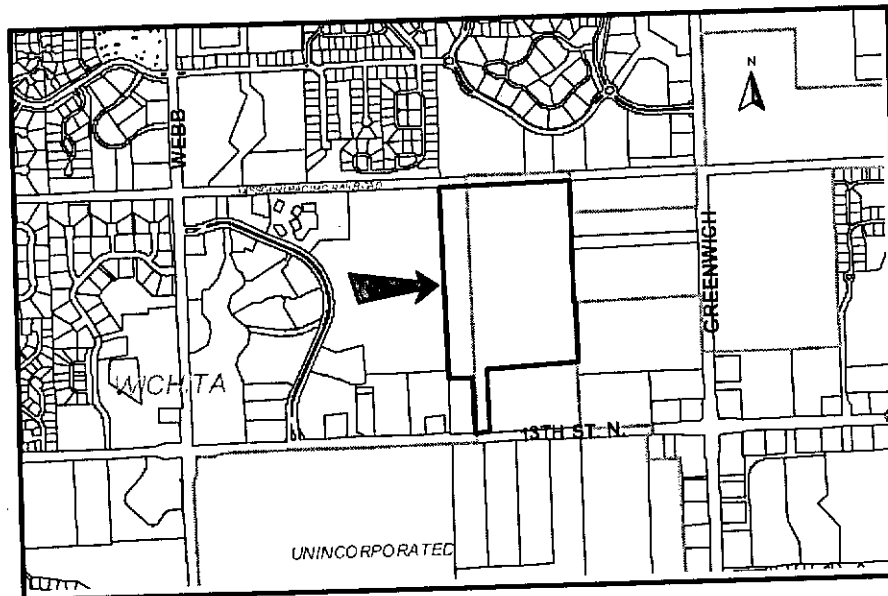

SUB 2007-36 -- Preliminary Plat of THE WATERFRONT RESIDENTIAL ADDITION
April 26, 2007 - Page 2

NOTE: A zone change request (ZON 2007-15) from LI, Limited Industrial to SF-5, Single-Family Residential has been requested. This site (with the exception of the west 280 feet) is located in the County adjoining Wichita's city limits and annexation is required.

STAFF COMMENTS:

- A. Prior to this plat being scheduled for City Council review, annexation of the property will need to be completed.
- B. This plat will be subject to approval of the associated zone change and any related conditions of such a change.
- C. The applicant shall guarantee the extension of City water and sanitary sewer to serve the lots being platted.
- D. If improvements are guaranteed by petition, a notarized certificate listing the petitions shall be submitted to the Planning Department for recording.
- E. **City Engineering** needs to comment on the status of the applicant's drainage concept.
- F. **City Engineering** does not recommend the connection of the private street (Reserve L) to a public street right-of-way extending from 13th Street.
- G. A covenant shall be submitted regarding the private street (Reserve L), which sets forth ownership and maintenance responsibilities.
- H. In accordance with the Subdivision Regulation the private streets shall be constructed to the public street standards. As private improvements, such guarantee shall not be provided through the use of a petition.
- I. The reserves being platted as private streets shall be labeled as private streets and shown appropriate street names as requested by **GIS**.
- J. In accordance with the code requirements of the International Fire Code, **City Fire Department** has required a second access for emergency vehicles due to the number of proposed lots for this residential addition.
- K. In accordance with the KS Wetland Mapping Conventions under the Memorandum of Understanding between the USDA-NRCS; USEPA; USACE; and USF&WS, this site has been identified as one with potential wetland hydrology. The US Army Corps of Engineers (USACE) should be contacted (316-322-8247) to have a wetland determination completed.
- L. The final plat tracing shall state in the plat's text the purposes of the proposed reserves as well as the ownership and maintenance responsibilities.
- M. Provisions shall be made for ownership and maintenance of the proposed reserves. The applicant shall either form a lot owners' association prior to recording the plat or shall submit a covenant stating when the association will be formed, when the reserves will be deeded to the association and who is to own and maintain the reserves prior to the association taking over those responsibilities.
- N. For those reserves being platted for drainage purposes, the required covenant that provides for ownership and maintenance of the reserves, shall grant to the appropriate governing body the authority to maintain the drainage reserves in the event the owner(s) fail to do so. The covenant shall provide for the cost of such maintenance to be charged back to the owner(s) by the governing body.

SUB 2007-36 -- Preliminary Plat of THE WATERFRONT RESIDENTIAL ADDITION
April 26, 2007 - Page 3

- O. Since this plat proposes the platting of narrow 32-foot street right-of-way, the plat shall include adjacent "15-foot drainage and utility easements".
- P. Since this plat proposes the platting of narrow street right-of-way with adjacent "15-foot street drainage and utility easements", a restrictive covenant shall be submitted which calls out restrictions for lot-owner use of these easements. Retaining walls and change of grade shall be prohibited within these easements as well as fences, earth berms and mass plantings
- Q. The applicant shall submit a covenant that provides four (4) off-street parking spaces per dwelling unit on each lot that abuts a 32-foot or 58-foot street. The covenant shall inventory the affected lots by lot and block number and shall state that the covenant runs with the land and is binding on future owners and assigns.
- R. On the final plat, the MAPC signature block needs to reference "Darrell A. Downing, Chair"
- S. On the final plat, the City Council certification needs to reference Carl Brewer, Mayor.
- T. The Applicant has platted a 15-foot building setback along the 32-foot street which represents an adjustment of the standard of 20 feet. The Subdivision Regulations permit the setback provisions to be modified by the plat upon the approval of the Planning Commission.
- U. The applicant has indicated that he is in the process of having a blanket pipeline easement confined. A recorded copy of the release/confinement of the easement shall be submitted.
- V. **City Fire Department** needs to comment on the need for a second point of access for fire control.
- W. The Applicant is reminded that a platting binder is required with the final plat. Approval of this plat will be subject to submittal of this binder and any relevant conditions found by such a review.
- X. For any lots with existing tree rows that may be impacted by the installation of utilities, it is recommended that 30-foot utility easements be platted in order to allow for the installation of the utilities without damage to such tree rows.
- Y. The platting text shall include language that a drainage plan has been developed for the plat and that all drainage easements, rights-of-way, or reserves shall remain at established grades or as modified with the approval of the applicable City or County Engineer, and unobstructed to allow for the conveyance of stormwater.
- Z. The applicant shall install or guarantee the installation of all utilities and facilities that are applicable and described in Article 8 of the MAPC Subdivision Regulations. (Water service and fire hydrants required by Article 8 for fire protection shall be as per the direction and approval of the Chief of the Fire Department.)
- AA. The applicant's engineer is advised that the Register of Deeds is requiring the name(s) of the notary public, who acknowledges the signatures on this plat, to be printed beneath the notary's signature.
- BB. To receive mail delivery without delay, and to avoid unnecessary expense, the applicant is advised of the necessity to meet with the U.S. Postal Service Growth Management Coordinator (Phone: 316-946-4556) prior to development of the plat so that the type of delivery, and the tentative mailbox locations can be determined.
- CC. The applicant is advised that various State and Federal requirements (specifically but not limited to the Army Corps of Engineers, Kanopolis Project Office, Rt. 1, Box 317, Valley Center, KS 67147) for the control of soil and wind erosion and the protection of wetlands may impact how this site can be developed. It is the applicant's responsibility to contact all appropriate agencies to determine any such requirements.

SUB 2007-36 -- Preliminary Plat of THE WATERFRONT RESIDENTIAL ADDITION
April 26, 2007 - Page 4

- DD. The owner of the subdivision should note that any construction that results in earthwork activities that will disturb one (1) acre or more of ground cover requires a Federal/State NPDES Storm Water Discharge Permit from the Kansas Department of Health and Environment in Topeka. Also, for projects located within the City of Wichita, erosion and sediment control devices must be used on ALL projects. For projects outside of the City of Wichita, but within the Wichita Metropolitan area, the owner should contact the appropriate governmental jurisdiction concerning erosion and sediment control device requirements.
- EE. Perimeter closure computations shall be submitted with the final plat tracing.
- FF. The representatives from the utility companies should be prepared to comment on the need for any additional utility easements to be platted on this property.
- GG. A compact disc (CD), which will be used by the City and County GIS Departments, detailing the final plat in digital format in AutoCAD. If a disc is not provided, please send via e-mail to Cheryl Holloway (E-Mail address: cholloway@wichita.gov). Please include the name of the plat on the disc.

STAFF REPORT

(Final Plat, Preliminary Plat Approved 4/26/07)

CASE NUMBER: SUB 2007-36 – THE WATERFRONT RESIDENTIAL ADDITION

OWNER/APPLICANT: Waterfront Residential Company, LLC, Attn: Rob Ramseyer, 8100 E. 22nd St. Bldg. #1000, Wichita, KS 67226

SURVEYOR/AGENT: MKEC Engineering Consultants, Inc., Attn: Greg Allison, 411 N. Webb Rd., Wichita, KS 67206

LOCATION: North side of 13th St. North, West of Greenwich Road

SITE SIZE: 59.61 acres

NUMBER OF LOTS

Residential:	74
Office:	
Commercial:	
Industrial:	
Total:	<u>74</u>

MINIMUM LOT AREA: 10,400 square feet

CURRENT ZONING: LI, Limited Industrial

PROPOSED ZONING: SF-5, Single-Family Residential

VICINITY MAP

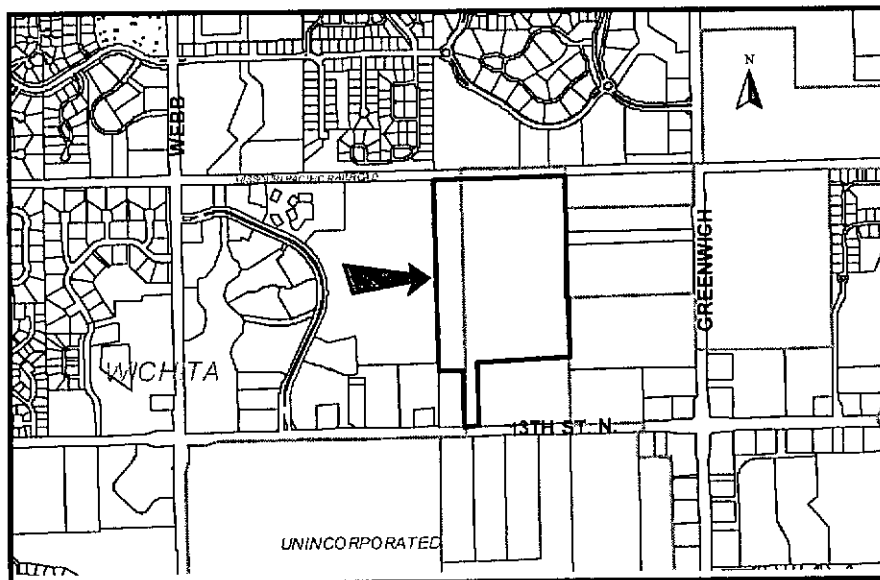

NOTE: A zone change (ZON 2007-15) from LI, Limited Industrial to SF-5, Single-Family Residential has been approved. This site (with the exception of the west 280 feet) is located in the County adjoining Wichita's city limits and annexation is required.

STAFF COMMENTS:

- A. Prior to this plat being scheduled for City Council review, annexation of the property will need to be completed.
- B. This plat will be subject to approval of the associated zone change and any related conditions of such a change. Prior to this plat being scheduled for City Council, the zone change will need to be approved by City Council.
- C. The applicant shall guarantee the extension of City water and sanitary sewer to serve the lots being platted.
- D. If improvements are guaranteed by petition, a notarized certificate listing the petitions shall be submitted to the Planning Department for recording.
- E. City Engineering needs to comment on the applicant's drainage plan.
- F. On the final plat tracing, the private street (Reserve L) will encompass the turnaround. Use of the turnaround for public access shall be referenced in the plat's text.
- G. A covenant shall be submitted regarding the private street (Reserve L), which sets forth ownership and maintenance responsibilities.
- H. In accordance with the Subdivision Regulation the private streets shall be constructed to the public street standards. As private improvements, such guarantee shall not be provided through the use of a petition.
- I. Santenay shall be replaced by a new name since it is too similar to the existing street "Santa Fe". The reference to Garden Gate Street in the plat's text shall be deleted.
- J. As requested by City Fire Department in accordance with the code requirements of the International Fire Code, the applicant has provided second access for emergency vehicles extending to the east due to the number of proposed lots for this residential addition.
- K. In accordance with the KS Wetland Mapping Conventions under the Memorandum of Understanding between the USDA-NRCS; USEPA; USACE; and USF&WS, this site has been identified as one with potential wetland hydrology. The US Army Corps of Engineers (USACE) should be contacted (316-322-8247) to have a wetland determination completed.
- L. Provisions shall be made for ownership and maintenance of the proposed reserves. The applicant shall either form a lot owners' association prior to recording the plat or shall submit a covenant stating when the association will be formed, when the reserves will be deeded to the association and who is to own and maintain the reserves prior to the association taking over those responsibilities.
- M. For those reserves being platted for drainage purposes, the required covenant that provides for ownership and maintenance of the reserves, shall grant to the appropriate governing body the authority to maintain the drainage reserves in the event the owner(s) fail to do so. The covenant shall provide for the cost of such maintenance to be charged back to the owner(s) by the governing body.
- N. Since reserves abut portions of public streets, the plat's text should include the language "owners of the reserves shall bear the cost of any repair or replacement of improvements within said reserves resulting from street construction, repair, or maintenance."
- O. One of two "Reserve M's needs relabeled.
- P. Since this plat proposes the platting of narrow street right-of-way with adjacent "15-foot street drainage and utility easements", a restrictive covenant shall be submitted which calls out restrictions for lot-owner use of these easements. Retaining walls and change of grade shall be prohibited within these easements as well as fences, earth berms and mass plantings.

SUB 2007-36 – Final Plat of THE WATERFRONT RESIDENTIAL ADDITION
June 14, 2007 - Page 3

- Q. The applicant shall submit a covenant that provides four (4) off-street parking spaces per dwelling unit on each lot that abuts a 32-foot or 58-foot street. The covenant shall inventory the affected lots by lot and block number and shall state that the covenant runs with the land and is binding on future owners and assigns.
- R. The applicant has indicated that he is in the process of having a blanket pipeline easement confined. A recorded copy of the release/confinement of the easement shall be submitted.
- S. The Applicant is reminded that a platting binder is required with the final plat. Approval of this plat will be subject to submittal of this binder and any relevant conditions found by such a review.
- T. For any lots with existing tree rows that may be impacted by the installation of utilities, it is recommended that 30-foot utility easements be platted in order to allow for the installation of the utilities without damage to such tree rows.
- U. The platting text shall include language that a drainage plan has been developed for the plat and that all drainage easements, rights-of-way, or reserves shall remain at established grades or as modified with the approval of the applicable City or County Engineer, and unobstructed to allow for the conveyance of stormwater.
- V. The applicant shall install or guarantee the installation of all utilities and facilities that are applicable and described in Article 8 of the MAPC Subdivision Regulations. (Water service and fire hydrants required by Article 8 for fire protection shall be as per the direction and approval of the Chief of the Fire Department.)
- W. The applicant's engineer is advised that the Register of Deeds is requiring the name(s) of the notary public, who acknowledges the signatures on this plat, to be printed beneath the notary's signature.
- X. To receive mail delivery without delay, and to avoid unnecessary expense, the applicant is advised of the necessity to meet with the U.S. Postal Service Growth Management Coordinator (Phone: 316-946-4556) prior to development of the plat so that the type of delivery, and the tentative mailbox locations can be determined.
- Y. The applicant is advised that various State and Federal requirements (specifically but not limited to the Army Corps of Engineers, Kanopolis Project Office, Rt. 1, Box 317, Valley Center, KS 67147) for the control of soil and wind erosion and the protection of wetlands may impact how this site can be developed. It is the applicant's responsibility to contact all appropriate agencies to determine any such requirements.
- Z. The owner of the subdivision should note that any construction that results in earthwork activities that will disturb one (1) acre or more of ground cover requires a Federal/State NPDES Storm Water Discharge Permit from the Kansas Department of Health and Environment in Topeka. Also, for projects located within the City of Wichita, erosion and sediment control devices must be used on ALL projects. For projects outside of the City of Wichita, but within the Wichita Metropolitan area, the owner should contact the appropriate governmental jurisdiction concerning erosion and sediment control device requirements.
- AA. Perimeter closure computations shall be submitted with the final plat tracing.
- BB. The representatives from the utility companies should be prepared to comment on the need for any additional utility easements to be platted on this property.
- CC. A compact disc (CD), which will be used by the City and County GIS Departments, detailing the final plat in digital format in AutoCAD. If a disc is not provided, please send via e-mail to Cheryl Holloway (E-Mail address: cholloway@wichita.gov). Please include the name of the plat on the disc.

STAFF REPORT

(Revised One-Step Final Plat, Final Plat Approved 6/14/07, Preliminary Plat Approved 4/26/07)

CASE NUMBER: SUB 2007-36 – THE WATERFRONT RESIDENTIAL ADDITION

OWNER/APPLICANT: Waterfront Residential Company, LLC, Attn: Rob Ramseyer, 8100 E. 22nd St. Bldg, #1000, Wichita, KS 67226

SURVEYOR/AGENT: MKEC Engineering Consultants, Inc., Attn: Greg Allison, 411 N. Webb Rd., Wichita, KS 67206

LOCATION: North side of 13th St. North, West of Greenwich Road

SITE SIZE: 59.61 acres

NUMBER OF LOTS

Residential:	73
Office:	
Commercial:	
Industrial:	
Total:	<u>73</u>

MINIMUM LOT AREA: 11,576 square feet

CURRENT ZONING: LI, Limited Industrial

PROPOSED ZONING: SF-5, Single-Family Residential

VICINITY MAP

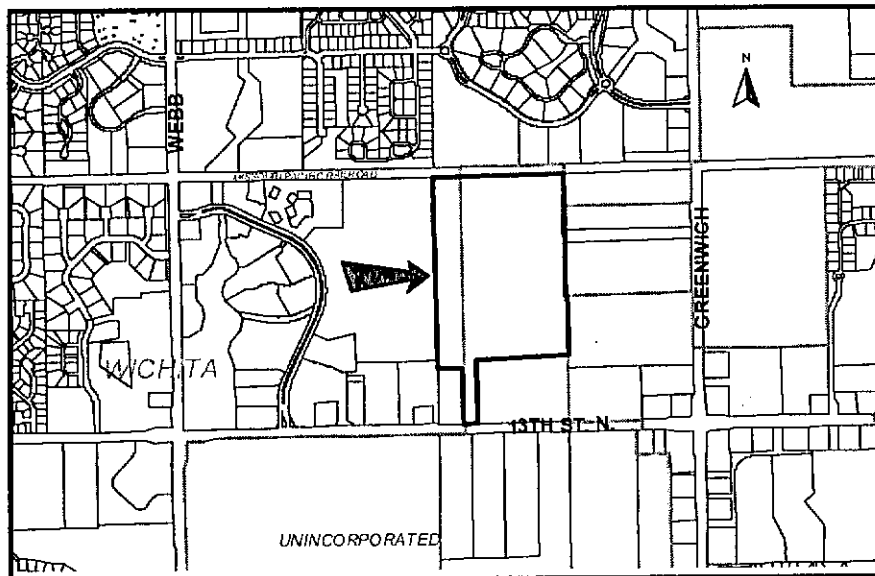

SUB 2007-36 – Revised One-Step Final Plat of THE WATERFRONT RESIDENTIAL ADDITION
August 23, 2007 - Page 2

NOTE: A zone change (ZON 2007-15) from LI, Limited Industrial to SF-5, Single-Family Residential has been approved. This site (with the exception of the west 280 feet) is located in the County adjoining Wichita's city limits and annexation is required.

This revised one-step final plat includes a revised street layout and one fewer lot.

STAFF COMMENTS:

- A. Prior to this plat being scheduled for City Council review, annexation of the property will need to be completed.
- B. The applicant shall guarantee the extension of City water and sanitary sewer to serve the lots being platted.
- C. If improvements are guaranteed by petition, a notarized certificate listing the petitions shall be submitted to the Planning Department for recording.
- D. City Engineering has approved the applicant's drainage plan. Off-site drainage agreements are needed.
- E. The private street (Reserve L) should be delineated from the public right-of-way by a solid bold line. Use of the turnaround located in Reserve L for public access shall be referenced in the plat's text.
- F. A covenant shall be submitted regarding the private street (Reserve L), which sets forth ownership and maintenance responsibilities.
- G. In accordance with the Subdivision Regulations the private streets shall be constructed to the public street standards. As private improvements, such guarantee shall not be provided through the use of a petition.
- H. County Surveying has advised that curve data is needed for Reserve E and for Lot 60, Block 1.
- I. As requested by City Fire Department in accordance with the code requirements of the International Fire Code, the applicant has provided second access for emergency vehicles extending to the east due to the number of proposed lots for this residential addition.
- J. In accordance with the KS Wetland Mapping Conventions under the Memorandum of Understanding between the USDA-NRCS; USEPA; USACE; and USF&WS, this site has been identified as one with potential wetland hydrology. The US Army Corps of Engineers (USACE) should be contacted (316-322-8247) to have a wetland determination completed.
- K. Provisions shall be made for ownership and maintenance of the proposed reserves. The applicant shall either form a lot owners' association prior to recording the plat or shall submit a covenant stating when the association will be formed, when the reserves will be deeded to the association and who is to own and maintain the reserves prior to the association taking over those responsibilities.
- L. For those reserves being platted for drainage purposes, the required covenant that provides for ownership and maintenance of the reserves, shall grant to the appropriate governing body the authority to maintain the drainage reserves in the event the owner(s) fail to do so. The covenant shall provide for the cost of such maintenance to be charged back to the owner(s) by the governing body.
- M. Since reserves abut portions of public streets, the plat's text should include the language "owners of the reserves shall bear the cost of any repair or replacement of improvements within said reserves resulting from street construction, repair, or maintenance."
- N. Since this plat proposes the platting of narrow street right-of-way with adjacent "15-foot street drainage and utility easements", a restrictive covenant shall be submitted which calls out restrictions for lot-owner use of these easements. Retaining walls and change of grade shall be prohibited within these easements as well as fences, earth berms and mass plantings
- O. The applicant shall submit a covenant that provides four (4) off-street parking spaces per dwelling unit on each lot that abuts a 32-foot or 58-foot street. The covenant shall inventory the affected lots by lot and block number and shall state that the covenant runs with the land and is binding on future owners and assigns.
- P. The applicant has indicated that he is in the process of having a blanket pipeline easement confined. A recorded copy of the release/confinement of the easement shall be submitted.

SUB 2007-36 – Revised One-Step Final Plat of THE WATERFRONT RESIDENTIAL ADDITION
August 23, 2007 - Page 3

- Q. For the pipeline easement on the property, the final plat shall include in the labeling of the easement the name of the company benefiting from the easement agreement.
- R. The Applicant is reminded that a platting binder is required with the final plat. Approval of this plat will be subject to submittal of this binder and any relevant conditions found by such a review.
- S. GIS has requested that Summerfield Ct be relabeled as Summerfield Cir. The street north of Lots 39-41, Block 1 needs to be labeled as Crestwood.
- T. For any lots with existing tree rows that may be impacted by the installation of utilities, it is recommended that 30-foot utility easements be platted in order to allow for the installation of the utilities without damage to such tree rows.
- U. The platlor's text shall include language that a drainage plan has been developed for the plat and that all drainage easements, rights-of-way, or reserves shall remain at established grades or as modified with the approval of the applicable City or County Engineer, and unobstructed to allow for the conveyance of stormwater.
- V. The applicant shall install or guarantee the installation of all utilities and facilities that are applicable and described in Article 8 of the MAPC Subdivision Regulations. (Water service and fire hydrants required by Article 8 for fire protection shall be as per the direction and approval of the Chief of the Fire Department.)
- W. The applicant's engineer is advised that the Register of Deeds is requiring the name(s) of the notary public, who acknowledges the signatures on this plat, to be printed beneath the notary's signature.
- X. To receive mail delivery without delay, and to avoid unnecessary expense, the applicant is advised of the necessity to meet with the U.S. Postal Service Growth Management Coordinator (Phone: 316-946-4556) prior to development of the plat so that the type of delivery, and the tentative mailbox locations can be determined.
- Y. The applicant is advised that various State and Federal requirements (specifically but not limited to the Army Corps of Engineers, Kanopolis Project Office, Rt. 1, Box 317, Valley Center, KS 67147) for the control of soil and wind erosion and the protection of wetlands may impact how this site can be developed. It is the applicant's responsibility to contact all appropriate agencies to determine any such requirements.
- Z. The owner of the subdivision should note that any construction that results in earthwork activities that will disturb one (1) acre or more of ground cover requires a Federal/State NPDES Storm Water Discharge Permit from the Kansas Department of Health and Environment in Topeka. Also, for projects located within the City of Wichita, erosion and sediment control devices must be used on ALL projects. For projects outside of the City of Wichita, but within the Wichita Metropolitan area, the owner should contact the appropriate governmental jurisdiction concerning erosion and sediment control device requirements.
- AA. Perimeter closure computations shall be submitted with the final plat tracing.
- BB. A compact disc (CD), which will be used by the City and County GIS Departments, detailing the final plat in digital format in AutoCAD. If a disc is not provided, please send via e-mail to Cheryl Holloway (E-Mail address: cholloway@wichita.gov). Please include the name of the plat on the disc.

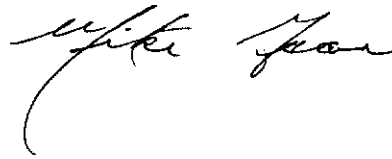

The Waterfront Residential Addition

Parcel Closure
Project: J:\CIVIL\06266\
COGO Revisions:
Date: ~~Tuesday, July 03, 2007~~; V2 - Tuesday, August 28, 2007
Client Contact: Rob Ramseyer
rob@ritchieassociates.com
(316) 684-7300

Parcel name: SE. 1/4 Sec. 9, T27S, R2E, 6TH P.M. - p1SEC 1

Line Course: N 01-00-39.2 W Length: 2661.494	North: 1694428.727	East: 1683649.660
Line Course: N 88-54-54.4 E Length: 2653.794	North: 1697089.807	East: 1683602.705
Line Course: S 00-48-07.4 E Length: 2660.650	North: 1697140.053	East: 1686256.024
Line Course: S 88-53-46.3 W Length: 2644.098	North: 1694479.664	East: 1686293.267
	North: 1694428.728	East: 1683649.660

Perimeter: 10620.035 Area: 7,048,985 sq.ft. 161.82 acres

Mapcheck Closure - (Uses listed courses and chords)
Error Closure: 0.001 Course: N 16-04-15.3 W
North: 0.0012 East: -0.0004
Precision 1: 10,620,036.000

Parcel name: FINAL Plat Boundary pre street dedication - p1FPB 1

Line Course: N 01-00-39.2 W Length: 615.001	North: 1694433.395	East: 1683891.926
Line Course: S 88-53-46.8 W Length: 242.310	North: 1695048.300	East: 1683881.076
Line Course: N 01-00-39.2 W Length: 1946.492	North: 1695043.633	East: 1683638.811
Line Course: N 88-54-54.5 E Length: 1326.834	North: 1696989.822	East: 1683604.470
Line Course: S 00-54-24.4 E Length: 1230.467	North: 1697014.943	East: 1684931.066
Line Course: N 88-54-23.3 E Length: 15.000	North: 1695784.630	East: 1684950.539
Line Course: S 00-54-24.4 E Length: 625.593	North: 1695784.917	East: 1684965.536
Line Course: S 88-53-46.3 W Length: 946.151	North: 1695159.402	East: 1684975.437
Line Course: S 01-00-39.2 E Length: 705.001	North: 1695141.175	East: 1684029.461
Line Course: S 88-53-46.3 W Length: 150.000	North: 1694436.284	East: 1684041.899
	North: 1694433.395	East: 1683891.927

Perimeter: 7802.849 Area: 2,596,775 sq.ft. 59.61 acres

Mapcheck Closure - (Uses listed courses and chords)

Error Closure: 0.001 Course: S 75-54-54.1 E
 North: -0.0003 East: 0.0010
 Precision 1: 7,802,849.000

Parcel name: FINAL Plat Boundary post street dedication - p1FPB 2

Line Course: N 01-00-39.2 W Length: 555.001	North: 1694493.386 East: 1683890.867
Line Course: S 88-53-46.8 W Length: 242.310	North: 1695048.300 East: 1683881.076
Line Course: N 01-00-39.2 W Length: 1946.492	North: 1695043.633 East: 1683638.811
Line Course: N 88-54-54.5 E Length: 1326.834	North: 1696989.822 East: 1683604.470
Line Course: S 00-54-24.4 E Length: 1230.467	North: 1697014.943 East: 1684931.066
Line Course: N 88-54-23.3 E Length: 15.000	North: 1695784.630 East: 1684950.539
Line Course: S 00-54-24.4 E Length: 625.593	North: 1695784.917 East: 1684965.536
Line Course: N 88-54-23.3 E Length: 15.000	North: 1695159.402 East: 1684975.437
Line Course: S 00-54-24.4 E Length: 625.593	North: 1695141.176 East: 1684029.461
Line Course: S 88-53-46.3 W Length: 946.151	North: 1695141.176 East: 1684029.461
Line Course: S 01-00-39.2 E Length: 645.001	North: 1694496.275 East: 1684040.840
Line Course: S 88-53-46.3 W Length: 150.000	North: 1694493.385 East: 1683890.868

Perimeter: 7682.849 Area: 2,587,775 sq.ft. 59.40 acres

Mapcheck Closure - (Uses listed courses and chords)

Error Closure: 0.001 Course: S 75-54-54.2 E
 North: -0.0003 East: 0.0010
 Precision 1: 7,682,849.000

Parcel name: VERANDA (p1St 1)

Line Course: S 41-56-15.0 W Length: 23.776	North: 1695757.273 East: 1683929.230
	North: 1695739.586 East: 1683913.340
Curve Length: 219.855 Radius: 250.000	
Delta: 50-23-13.3 Tangent: 117.607	
Chord: 212.838 Course: S 16-44-38.3 W	
Course In: S 48-03-45.0 E Course Out: S 81-33-01.7 W	
RP North: 1695572.507 East: 1684099.309	
End North: 1695535.772 East: 1683852.023	
Curve Length: 112.746 Radius: 340.000	
Delta: 18-59-58.6 Tangent: 56.895	
Chord: 112.230 Course: S 17-56-57.6 E	
Course In: N 81-33-01.7 E Course Out: S 62-33-03.1 W	

RP North: 1695585.731 East: 1684188.332
 End North: 1695429.005 East: 1683886.609
 Curve Length: 149.602 Radius: 600.000
 Delta: 14-17-09.5 Tangent: 75.191
 Chord: 149.215 Course: S 20-18-22.1 E
 Course In: S 62-33-03.1 W Course Out: N 76-50-12.6 E
 RP North: 1695152.428 East: 1683354.157
 End North: 1695289.063 East: 1683938.392
 Curve Length: 127.258 Radius: 600.000
 Delta: 12-09-08.2 Tangent: 63.869
 Chord: 127.020 Course: S 07-05-13.3 E
 Course In: S 76-50-12.6 W Course Out: N 88-59-20.8 E
 RP North: 1695152.428 East: 1683354.157
 End North: 1695163.014 East: 1683954.063
 Line Course: S 01-00-39.2 E Length: 222.129

North: 1694940.919 East: 1683957.982
 North: 1694735.450 East: 1683961.608
 North: 1694434.839 East: 1683966.912
 North: 1695757.272 East: 1683929.230

Line Course: S 01-00-39.2 E Length: 205.501
 Line Course: S 01-00-39.2 E Length: 300.658
 Line Course: N 01-37-55.8 W Length: 1322.970

Perimeter: 2684.494 Area: 21,386 sq.ft. 0.49 acres

Mapcheck Closure - (Uses listed courses and chords)

Error Closure: 0.001 Course: S 08-44-14.7 E
 North: -0.0006 East: 0.0001
 Precision: 1: 2,676,337.000

Parcel name: GENOVA (p1 St 2)

Line Course: N 76-50-12.6 E Length: 148.582 North: 1695289.063 East: 1683938.392
 North: 1695322.899 East: 1684083.070
 Curve Length: 158.793 Radius: 400.000
 Delta: 22-44-43.7 Tangent: 80.456
 Chord: 157.753 Course: N 88-12-34.4 E
 Course In: S 13-09-47.4 E Course Out: N 09-34-56.3 E
 RP North: 1694933.408 East: 1684174.160
 End North: 1695327.827 East: 1684240.746
 Curve Length: 156.592 Radius: 200.000
 Delta: 44-51-37.1 Tangent: 82.557
 Chord: 152.623 Course: N 77-09-07.7 E
 Course In: N 09-34-56.3 E Course Out: S 35-16-40.8 E
 RP North: 1695525.037 East: 1684274.039
 End North: 1695361.765 East: 1684389.548
 Curve Length: 79.817 Radius: 200.000
 Delta: 22-51-57.2 Tangent: 40.447
 Chord: 79.288 Course: N 43-17-20.6 E
 Course In: N 35-16-40.8 W Course Out: S 58-08-38.0 E
 RP North: 1695525.037 East: 1684274.039
 End North: 1695419.479 East: 1684443.914

Line Course: N 31-51-22.0 E Length: 114.743

North: 1695516.939 East: 1684504.474

Curve Length: 168.858 Radius: 125.000
 Delta: 77-23-56.3 Tangent: 100.142
 Chord: 156.309 Course: N 70-33-20.1 E
 Course In: S 58-08-38.0 E Course Out: N 19-15-18.3 E
 RP North: 1695450.966 East: 1684610.646
 End North: 1695568.973 East: 1684651.868
 Curve Length: 152.487 Radius: 300.000
 Delta: 29-07-22.0 Tangent: 77.928
 Chord: 150.850 Course: S 85-18-22.7 E
 Course In: N 19-15-18.3 E Course Out: S 09-52-03.7 E
 RP North: 1695852.191 East: 1684750.800
 End North: 1695556.629 East: 1684802.212
 Curve Length: 171.710 Radius: 100.000
 Delta: 98-22-56.5 Tangent: 115.815
 Chord: 151.379 Course: S 50-40-35.4 E
 Course In: S 09-52-03.7 E Course Out: N 88-30-52.8 E
 RP North: 1695458.109 East: 1684819.349
 End North: 1695460.701 East: 1684919.316
 Line Course: S 01-29-07.2 E Length: 15.286

North: 1695445.420 East: 1684919.712

Curve Length: 206.415 Radius: 115.000
 Delta: 102-50-27.1 Tangent: 144.163
 Chord: 179.801 Course: S 49-56-06.4 W
 Course In: S 88-30-52.8 W Course Out: S 11-21-19.9 W
 RP North: 1695442.439 East: 1684804.751
 End North: 1695329.690 East: 1684782.107
 Curve Length: 283.619 Radius: 600.000
 Delta: 27-05-00.9 Tangent: 144.510
 Chord: 280.985 Course: S 87-48-49.5 W
 Course In: S 11-21-19.9 W Course Out: N 15-43-41.0 W
 RP North: 1694741.435 East: 1684663.970
 End North: 1695318.971 East: 1684501.327
 Curve Length: 122.959 Radius: 100.000
 Delta: 70-27-00.2 Tangent: 70.608
 Chord: 115.358 Course: N 70-30-10.9 W
 Course In: N 15-43-41.0 W Course Out: S 54-43-19.2 W
 RP North: 1695415.227 East: 1684474.220
 End North: 1695357.473 East: 1684392.584
 Line Course: N 35-16-40.8 W Length: 5.258

North: 1695361.765 East: 1684389.547

Line Course: S 80-50-44.4 W Length: 456.975

North: 1695289.063 East: 1683938.392

Perimeter: 2242.093 Area: 100,164 sq.ft. 2.29 acres

Mapcheck Closure - (Uses listed courses and chords)

Error Closure: 0.000 Course: N 72-34-19.8 E
 North: 0.0001 East: 0.0004
 Precision 1: 2,165,190,000.000

Parcel name: MOSAIC AND GENOVA (p1St 3)

North: 1695361.765 East: 1684389.547
 Curve Length: 79.817 Radius: 200.000
 Delta: 22-51-57.2 Tangent: 40.447
 Chord: 79.288 Course: N 43-17-20.6 E
 Course In: N 35-16-40.8 W Course Out: S 58-08-38.0 E
 RP North: 1695525.037 East: 1684274.038
 End North: 1695419.479 East: 1684443.913
 Line Course: N 31-51-22.0 E Length: 114.743

North: 1695516.939 East: 1684504.473
 Curve Length: 168.858 Radius: 125.000
 Delta: 77-23-56.3 Tangent: 100.142
 Chord: 156.309 Course: N 70-33-20.1 E
 Course In: S 58-08-38.0 E Course Out: N 19-15-18.3 E
 RP North: 1695450.965 East: 1684610.645
 End North: 1695568.973 East: 1684651.867

Curve Length: 152.487 Radius: 300.000
 Delta: 29-07-22.0 Tangent: 77.928
 Chord: 150.850 Course: S 85-18-22.7 E
 Course In: N 19-15-18.3 E Course Out: S 09-52-03.7 E
 RP North: 1695852.191 East: 1684750.799
 End North: 1695556.629 East: 1684802.211

Curve Length: 171.710 Radius: 100.000
 Delta: 98-22-56.5 Tangent: 115.815
 Chord: 151.379 Course: S 50-40-35.4 E
 Course In: S 09-52-03.7 E Course Out: N 88-30-52.8 E
 RP North: 1695458.108 East: 1684819.348
 End North: 1695460.700 East: 1684919.315
 Line Course: S 01-29-07.2 E Length: 15.286

North: 1695445.420 East: 1684919.711
 Curve Length: 206.415 Radius: 115.000
 Delta: 102-50-27.1 Tangent: 144.163
 Chord: 179.801 Course: S 49-56-06.4 W
 Course In: S 88-30-52.8 W Course Out: S 11-21-19.9 W
 RP North: 1695442.439 East: 1684804.750
 End North: 1695329.690 East: 1684782.106

Curve Length: 283.619 Radius: 600.000
 Delta: 27-05-00.9 Tangent: 144.510
 Chord: 280.985 Course: S 87-48-49.5 W
 Course In: S 11-21-19.9 W Course Out: N 15-43-41.0 W
 RP North: 1694741.435 East: 1684663.969
 End North: 1695318.971 East: 1684501.326

Curve Length: 122.959 Radius: 100.000
 Delta: 70-27-00.2 Tangent: 70.608
 Chord: 115.358 Course: N 70-30-10.9 W
 Course In: N 15-43-41.0 W Course Out: S 54-43-19.2 W
 RP North: 1695415.227 East: 1684474.219
 End North: 1695357.472 East: 1684392.583
 Line Course: N 35-16-40.8 W Length: 5.258

North: 1695361.765 East: 1684389.546

Perimeter: 1321.151 Area: 100,824 sq.ft. 2.31 acres

Mapcheck Closure - (Uses listed courses and chords)

Error Closure: 0.001 Course: S 83-10-33.5 W
 North: -0.0001 East: -0.0009
 Precision 1: 1,249,257.000

Parcel name: CRESTWOOD AND VERANDA (p1St 4)

North: 1695862.313 East: 1683867.734

Curve Length: 123.679 Radius: 200.000
 Delta: 35-25-52.9 Tangent: 63.888
 Chord: 121.717 Course: S 30-20-48.6 E
 Course In: N 77-22-07.9 E Course Out: S 41-56-15.0 W
 RP North: 1695906.048 East: 1684062.894
 End North: 1695757.273 East: 1683929.230

Curve Length: 167.651 Radius: 200.000
 Delta: 48-01-42.4 Tangent: 89.105
 Chord: 162.785 Course: S 72-04-36.2 E
 Course In: N 41-56-15.0 E Course Out: S 06-05-27.4 E
 RP North: 1695906.048 East: 1684062.894
 End North: 1695707.177 East: 1684084.115

Curve Length: 219.926 Radius: 290.000
 Delta: 43-27-04.1 Tangent: 115.555
 Chord: 214.694 Course: N 62-11-00.5 E
 Course In: N 06-05-27.4 W Course Out: S 49-32-31.5 E
 RP North: 1695995.540 East: 1684053.344
 End North: 1695807.362 East: 1684274.000

Curve Length: 79.529 Radius: 290.000
 Delta: 15-42-45.4 Tangent: 40.015
 Chord: 79.280 Course: N 32-36-05.8 E
 Course In: N 49-32-31.5 W Course Out: S 65-15-16.9 E
 RP North: 1695995.540 East: 1684053.344
 End North: 1695874.151 East: 1684316.716

Curve Length: 220.171 Radius: 600.000
 Delta: 21-01-29.2 Tangent: 111.338
 Chord: 218.938 Course: N 14-13-58.5 E
 Course In: N 65-15-16.9 W Course Out: S 86-16-46.1 E
 RP North: 1696125.302 East: 1683771.809
 End North: 1696086.368 East: 1684370.545

Line Course: N 03-43-13.9 E Length: 36.792

North: 1696123.083 East: 1684372.932

Curve Length: 91.310 Radius: 180.000
 Delta: 29-03-53.3 Tangent: 46.660
 Chord: 90.334 Course: N 10-48-42.7 W
 Course In: N 86-16-46.1 W Course Out: N 64-39-20.6 E
 RP North: 1696134.763 East: 1684193.312
 End North: 1696211.813 East: 1684355.987

Curve Length: 161.029 Radius: 180.000
 Delta: 51-15-25.9 Tangent: 86.352
 Chord: 155.713 Course: N 50-58-22.3 W
 Course In: S 64-39-20.6 W Course Out: N 13-23-54.7 E
 RP North: 1696134.763 East: 1684193.312
 End North: 1696309.864 East: 1684235.022

Line Course: N 76-36-05.3 W Length: 43.319

North: 1696319.902 East: 1684192.882

Line Course: N 76-36-05.3 W Length: 57.120

North: 1696333.138 East: 1684137.317

Curve Length: 332.009 Radius: 220.000
 Delta: 86-28-00.5 Tangent: 206.835
 Chord: 301.388 Course: S 60-09-54.5 W
 Course In: S 13-23-54.7 W Course Out: N 73-04-05.8 W
 RP North: 1696119.126 East: 1684086.337
 End North: 1696183.197 East: 1683875.874
 Curve Length: 309.582 Radius: 600.000
 Delta: 29-33-46.3 Tangent: 158.319
 Chord: 306.159 Course: S 02-09-01.0 W
 Course In: S 73-04-05.8 E Course Out: S 77-22-07.9 W
 RP North: 1696008.458 East: 1684449.865
 End North: 1695877.253 East: 1683864.386
 Line Course: S 12-37-52.1 E Length: 15.309

North: 1695862.315 East: 1683867.734

Perimeter: 1857.424 Area: 266,851 sq.ft. 6.12 acres

Mapcheck Closure - (Uses listed courses and chords)

Error Closure: 0.002 Course: N 12-48-24.3 W
 North: 0.0021 East: -0.0005
 Precision 1: 901,774.000

Parcel name: CRESTWOOD CT. (p1St 5)

Line Course: S 49-32-31.5 E Length: 47.050

North: 1695807.362 East: 1684274.000

North: 1695776.831 East: 1684309.800

Curve Length: 168.892 Radius: 150.000
 Delta: 64-30-42.5 Tangent: 94.665
 Chord: 160.110 Course: S 81-47-52.8 E
 Course In: N 40-27-28.5 E Course Out: S 24-03-14.0 E
 RP North: 1695890.964 East: 1684407.133
 End North: 1695753.990 East: 1684468.272
 Curve Length: 217.346 Radius: 400.000
 Delta: 31-07-57.2 Tangent: 111.428
 Chord: 214.682 Course: N 81-30-44.6 E
 Course In: S 24-03-14.0 E Course Out: N 07-04-43.2 E
 RP North: 1695388.725 East: 1684631.311
 End North: 1695785.676 East: 1684680.603
 Line Course: S 82-55-16.8 E Length: 128.210

North: 1695769.876 East: 1684807.836

Line Course: N 07-04-43.2 E Length: 21.000

North: 1695790.716 East: 1684810.424

Line Course: N 88-13-21.6 W Length: 536.682

North: 1695807.361 East: 1684274.000

Perimeter: 1119.179 Area: 14,937 sq.ft. 0.34 acres

Mapcheck Closure - (Uses listed courses and chords)

Error Closure: 0.001 Course: S 67-34-10.8 W
 North: -0.0002 East: -0.0006

Precision 1: 1,107,734.000

Parcel name: CRESTWOOD CT. (p1St 6)

Line Course: N 64-39-20.6 E Length: 17.385 North: 1696211.811 East: 1684355.987
 North: 1696219.253 East: 1684371.699

Curve Length: 313.683 Radius: 500.000
 Delta: 35-56-43.6 Tangent: 162.197
 Chord: 308.564 Course: N 82-37-42.4 E
 Course In: S 25-20-39.4 E Course Out: N 10-36-04.2 E
 RP North: 1695767.377 East: 1684585.727
 End North: 1696258.843 East: 1684677.712

Line Course: S 79-23-55.8 E Length: 30.914 North: 1696253.156 East: 1684708.099

Line Course: S 83-18-11.1 W Length: 354.531 North: 1696211.811 East: 1684355.987

Perimeter: 716.514 Area: 7,501 sq.ft. 0.17 acres

Mapcheck Closure - (Uses listed courses and chords)

Error Closure: 0.000 Course: S 46-55-54.4 W
 North: -0.0002 East: -0.0002
 Precision 1: 711,394,000.000

Parcel name: VERANDA AND SUMMERFIELD CIR. p1St 7

Line Course: N 21-49-20.1 W Length: 20.940 North: 1696746.195 East: 1684686.921
 North: 1696765.635 East: 1684679.137

Line Course: S 69-19-13.2 W Length: 5.983 North: 1696763.522 East: 1684673.540

Curve Length: 228.501 Radius: 300.000
 Delta: 43-38-26.0 Tangent: 120.115
 Chord: 223.018 Course: N 88-51-33.8 W
 Course In: N 20-40-46.8 W Course Out: S 22-57-39.2 W
 RP North: 1697044.193 East: 1684567.597
 End North: 1696767.961 East: 1684450.566

Curve Length: 200.855 Radius: 150.000
 Delta: 76-43-15.0 Tangent: 118.720
 Chord: 186.182 Course: S 74-36-01.7 W
 Course In: S 22-57-39.2 W Course Out: N 53-45-35.8 W
 RP North: 1696629.846 East: 1684392.050
 End North: 1696718.521 East: 1684271.068

Curve Length: 100.970 Radius: 150.000
 Delta: 38-34-04.1 Tangent: 52.482
 Chord: 99.075 Course: S 16-57-22.1 W
 Course In: S 53-45-35.8 E Course Out: S 87-40-20.1 W
 RP North: 1696629.846 East: 1684392.050
 End North: 1696623.753 East: 1684242.174

Curve Length: 164.685 Radius: 600.000
 Delta: 15-43-34.6 Tangent: 82.864
 Chord: 164.169 Course: S 05-32-07.4 W

Course In: S 87-40-20.1 W Course Out: S 76-36-05.3 E
RP North: 1696599.384 East: 1683642.669
End North: 1696460.350 East: 1684226.338
Line Course: S 13-23-54.7 W Length: 144.380

Line Course: N 49-12-35.4 E Length: 652.536
North: 1696319.899 East: 1684192.882
North: 1696746.195 East: 1684686.922

Perimeter: 1518.851 Area: 92,832 sq.ft. 2.13 acres

Mapcheck Closure - (Uses listed courses and chords)

Error Closure: 0.001 Course: S 63-16-40.2 E
North: -0.0003 East: 0.0006
Precision 1: 1,496,283.000

Parcel name: SUMMERFIELD CIR. (p1St 8)

Line Course: N 53-45-35.8 W Length: 14.974
North: 1696718.521 East: 1684271.068
North: 1696727.374 East: 1684258.991

Curve Length: 230.791 Radius: 250.000
Delta: 52-53-36.3 Tangent: 124.355
Chord: 222.683 Course: N 80-12-24.0 W
Course In: S 36-14-24.2 W Course Out: N 16-39-12.1 W
RP North: 1696525.737 East: 1684111.198
End North: 1696765.251 East: 1684039.553

Curve Length: 117.487 Radius: 300.000
Delta: 22-26-18.3 Tangent: 59.506
Chord: 116.738 Course: S 84-33-57.0 W
Course In: N 16-39-12.1 W Course Out: S 05-47-06.2 W
RP North: 1697052.668 East: 1683953.578
End North: 1696754.195 East: 1683923.339

Line Course: N 84-12-53.8 W Length: 165.320
Line Course: S 05-47-06.2 W Length: 21.000
Line Course: S 86-30-05.1 E Length: 515.283
North: 1696770.859 East: 1683758.861
North: 1696749.966 East: 1683756.744
North: 1696718.522 East: 1684271.067

Perimeter: 1064.855 Area: 13,659 sq.ft. 0.31 acres

Mapcheck Closure - (Uses listed courses and chords)

Error Closure: 0.001 Course: N 72-46-51.0 W
North: 0.0002 East: -0.0007
Precision 1: 1,055,998.000

Parcel name: Reserve "A"

Line Course: N 88-53-46.8 E Length: 242.310
Line Course: S 01-00-39.2 E Length: 284.221
North: 1695043.633 East: 1683638.810
North: 1695048.300 East: 1683881.075
North: 1694764.123 East: 1683886.090

Line Course: N 88-59-20.8 E Length: 27.000

North: 1694764.600 East: 1683913.085

Curve Length: 22.777 Radius: 14.500
 Delta: 90-00-00.0 Tangent: 14.500
 Chord: 20.506 Course: N 43-59-20.8 E
 Course In: N 01-00-39.2 W Course Out: N 88-59-20.8 E
 RP North: 1694779.097 East: 1683912.830
 End North: 1694779.353 East: 1683927.327
 Line Course: N 01-00-39.2 W Length: 70.425

North: 1694849.767 East: 1683926.085

Curve Length: 47.539 Radius: 155.000
 Delta: 17-34-22.6 Tangent: 23.958
 Chord: 47.353 Course: N 07-46-32.1 E
 Course In: N 88-59-20.8 E Course Out: N 73-26-16.6 W
 RP North: 1694852.502 East: 1684081.061
 End North: 1694896.685 East: 1683932.491

Curve Length: 44.472 Radius: 145.000
 Delta: 17-34-22.6 Tangent: 22.412
 Chord: 44.298 Course: N 07-46-32.1 E
 Course In: N 73-26-16.6 W Course Out: N 88-59-20.8 E
 RP North: 1694938.017 East: 1683793.507
 End North: 1694940.575 East: 1683938.485

Curve Length: 28.090 Radius: 29.500
 Delta: 54-33-28.0 Tangent: 15.212
 Chord: 27.041 Course: N 28-17-23.2 W
 Course In: S 88-59-20.8 W Course Out: N 34-25-52.8 E
 RP North: 1694940.055 East: 1683908.989
 End North: 1694964.387 East: 1683925.669

Curve Length: 108.219 Radius: 55.000
 Delta: 112-44-11.0 Tangent: 82.682
 Chord: 91.588 Course: N 00-47-58.3 E
 Course In: N 34-25-52.8 E Course Out: N 32-49-56.2 W
 RP North: 1695009.751 East: 1683956.767
 End North: 1695055.966 East: 1683926.947

Line Course: N 01-00-39.2 W Length: 106.553

North: 1695162.502 East: 1683925.067

Curve Length: 172.063 Radius: 571.000
 Delta: 17-15-55.0 Tangent: 86.688
 Chord: 171.413 Course: N 09-38-36.7 W
 Course In: S 88-59-20.8 W Course Out: N 71-43-25.8 E
 RP North: 1695152.428 East: 1683354.156
 End North: 1695331.493 East: 1683896.352

Line Course: S 88-59-20.8 W Length: 262.581

North: 1695326.860 East: 1683633.812

Line Course: S 01-00-39.2 E Length: 283.271

North: 1695043.633 East: 1683638.810

Perimeter: 1699.522 Area: 91,456 sq.ft. 2.09 acres

Mapcheck Closure - (Uses listed courses and chords)

Error Closure: 0.001 Course: N 23-33-44.6 W
 North: 0.0007 East: -0.0003
 Precision 1: 1,678,560.000

Parcel name: Reserve "B"

Line Course: S 01-00-39.2 E Length: 374.465 North: 1695141.176 East: 1684029.460

Line Course: S 88-59-20.8 W Length: 27.000 North: 1694766.769 East: 1684036.067

Curve Length: 22.777 Radius: 14.500 North: 1694766.293 East: 1684009.071
Delta: 90-00-00.0 Tangent: 14.500
Chord: 20.506 Course: N 46-00-39.2 W
Course In: N 01-00-39.2 W Course Out: S 88-59-20.8 W
RP North: 1694780.790 East: 1684008.815
End North: 1694780.534 East: 1683994.317

Line Course: N 01-00-39.2 W Length: 70.425 North: 1694850.949 East: 1683993.075

Curve Length: 47.539 Radius: 155.000
Delta: 17-34-22.6 Tangent: 23.958
Chord: 47.353 Course: N 09-47-50.5 W
Course In: S 88-59-20.8 W Course Out: N 71-24-58.2 E
RP North: 1694848.214 East: 1683838.099
End North: 1694897.611 East: 1683985.017

Curve Length: 44.472 Radius: 145.000
Delta: 17-34-22.6 Tangent: 22.412
Chord: 44.298 Course: N 09-47-50.5 W
Course In: N 71-24-58.2 E Course Out: S 88-59-20.8 W
RP North: 1694943.821 East: 1684122.457
End North: 1694941.263 East: 1683977.479

Curve Length: 28.090 Radius: 29.500
Delta: 54-33-28.0 Tangent: 15.212
Chord: 27.041 Course: N 26-16-04.8 E
Course In: N 88-59-20.8 E Course Out: N 36-27-11.2 W
RP North: 1694941.783 East: 1684006.975
End North: 1694965.511 East: 1683989.447

Curve Length: 108.219 Radius: 55.000
Delta: 112-44-11.1 Tangent: 82.682
Chord: 91.588 Course: N 02-49-16.8 W
Course In: N 36-27-11.2 W Course Out: N 30-48-37.7 E
RP North: 1695009.750 East: 1683956.768
End North: 1695056.988 East: 1683984.939

Line Course: N 01-00-39.2 W Length: 106.553 North: 1695163.525 East: 1683983.059

Curve Length: 104.619 Radius: 629.000
Delta: 9-31-47.2 Tangent: 52.430
Chord: 104.498 Course: N 05-46-32.8 W
Course In: S 88-59-20.8 W Course Out: N 79-27-33.6 E
RP North: 1695152.428 East: 1683354.157
End North: 1695267.492 East: 1683972.543

Line Course: N 68-20-12.6 E Length: 43.232 North: 1695283.451 East: 1684012.721

Line Course: S 06-42-36.4 E Length: 143.257 North: 1695141.176 East: 1684029.460

Perimeter: 1120.648 Area: 21,110 sq.ft. 0.48 acres

Mapcheck Closure - (Uses listed courses and chords)

Error Closure: 0.000 Course: N 79-07-56.0 W
 North: 0.0000 East: -0.0001
 Precision 1: 1,100,216,000.000

Parcel name: Reserve "C"

North: 1695307.424 East: 1684001.700
 Curve Length: 9.957 Radius: 3.500
 Delta: 163-00-00.0 Tangent: 23.419
 Chord: 6.923 Course: S 13-09-47.4 E
 Course In: S 04-39-47.4 E Course Out: S 21-39-47.4 E
 RP North: 1695303.935 East: 1684001.985
 End North: 1695300.682 East: 1684003.277
 Line Course: S 68-20-12.6 W Length: 29.691

North: 1695289.722 East: 1683975.683
 Curve Length: 11.174 Radius: 6.500
 Delta: 98-30-00.0 Tangent: 7.544
 Chord: 9.848 Course: N 62-24-47.4 W
 Course In: N 21-39-47.4 W Course Out: S 76-50-12.6 W
 RP North: 1695295.763 East: 1683973.283
 End North: 1695294.283 East: 1683966.954
 Line Course: N 13-09-47.4 W Length: 2.843

North: 1695297.051 East: 1683966.307
 Curve Length: 11.174 Radius: 6.500
 Delta: 98-30-00.0 Tangent: 7.544
 Chord: 9.848 Course: N 36-05-12.6 E
 Course In: N 76-50-12.6 E Course Out: N 04-39-47.4 W
 RP North: 1695298.531 East: 1683972.636
 End North: 1695305.009 East: 1683972.107
 Line Course: N 85-20-12.6 E Length: 29.691

North: 1695307.423 East: 1684001.700

Perimeter: 94.532 Area: 447 sq.ft. 0.01 acres

Mapcheck Closure - (Uses listed courses and chords)

Error Closure: 0.000 Course: S 13-09-47.4 E
 North: -0.0005 East: 0.0001
 Precision 1: 88,844,000.000

Parcel name: Reserve "D"

North: 1695442.372 East: 1683912.344
 Curve Length: 128.043 Radius: 629.000
 Delta: 11-39-48.4 Tangent: 64.243
 Chord: 127.822 Course: S 21-37-02.7 E
 Course In: S 62-33-03.1 W Course Out: N 74-12-51.5 E
 RP North: 1695152.428 East: 1683354.157
 End North: 1695323.540 East: 1683959.435
 Line Course: N 85-20-12.6 E Length: 43.232

North: 1695327.055 East: 1684002.523

Line Course: N 24-57-01.8 W Length: 134.107

Line Course: S 79-25-29.4 W Length: 34.189

North: 1695448.646 East: 1683945.952

North: 1695442.372 East: 1683912.344

Perimeter: 339.571 Area: 4,586 sq.ft. 0.10 acres

Mapcheck Closure - (Uses listed courses and chords)

Error Closure: 0.000 Course: S 16-33-32.1 E

North: -0.0003 East: 0.0001

Precision 1: 339,350,000.000

Parcel name: Reserve "E"

Line Course: N 58-08-38.0 W Length: 118.814

North: 1695348.326 East: 1684558.421

North: 1695411.035 East: 1684457.503

Curve Length: 48.768 Radius: 216.000
 Delta: 12-56-09.7 Tangent: 24.488
 Chord: 48.664 Course: S 38-19-26.9 W
 Course In: N 58-08-38.0 W Course Out: S 45-12-28.3 E
 RP North: 1695525.037 East: 1684274.038
 End North: 1695372.857 East: 1684427.326
 Curve Length: 34.442 Radius: 19.000
 Delta: 103-51-43.5 Tangent: 24.259
 Chord: 29.916 Course: S 07-08-20.0 E
 Course In: S 45-12-28.3 E Course Out: S 30-55-48.2 W
 RP North: 1695359.471 East: 1684440.810
 End North: 1695343.173 East: 1684431.044
 Curve Length: 68.404 Radius: 84.000
 Delta: 46-39-29.2 Tangent: 36.227
 Chord: 66.530 Course: S 82-23-56.4 E
 Course In: N 30-55-48.2 E Course Out: S 15-43-41.0 E
 RP North: 1695415.228 East: 1684474.219
 End North: 1695334.373 East: 1684496.990
 Curve Length: 63.024 Radius: 616.000
 Delta: 5-51-43.4 Tangent: 31.540
 Chord: 62.997 Course: N 77-12-10.7 E
 Course In: S 15-43-41.0 E Course Out: N 09-51-57.6 W
 RP North: 1694741.436 East: 1684663.970
 End North: 1695348.326 East: 1684558.422

Perimeter: 333.452 Area: 5,883 sq.ft. 0.13 acres

Mapcheck Closure - (Uses listed courses and chords)

Error Closure: 0.001 Course: N 58-24-44.9 E

North: 0.0004 East: 0.0006

Precision 1: 326,921.000

Parcel name: Reserve "F"

Line Course: S 89-58-54.4 W Length: 28.853

North: 1695392.428 East: 1684640.236

North: 1695392.419 East: 1684611.383

Line Course: S 50-13-16.7 W Length: 68.915

North: 1695348.326 East: 1684558.421

Curve Length: 228.157 Radius: 616.000
 Delta: 21-13-17.5 Tangent: 115.401
 Chord: 226.856 Course: S 89-15-18.9 E
 Course In: S 09-51-57.6 E Course Out: N 11-21-19.9 E
 RP North: 1694741.436 East: 1684663.969
 End North: 1695345.377 East: 1684785.257

Curve Length: 57.936 Radius: 99.000
 Delta: 33-31-47.7 Tangent: 29.824
 Chord: 57.112 Course: N 84-35-26.1 E
 Course In: N 11-21-19.9 E Course Out: S 22-10-27.8 E
 RP North: 1695442.439 East: 1684804.750
 End North: 1695350.761 East: 1684842.115

Line Course: N 45-06-38.0 W Length: 59.112

North: 1695392.479 East: 1684800.236

Line Course: S 89-58-54.4 W Length: 80.000

North: 1695392.453 East: 1684720.236

Line Course: S 89-58-54.4 W Length: 80.000

North: 1695392.428 East: 1684640.236

Perimeter: 602.973 Area: 9,390 sq.ft. 0.21 acres

Mapcheck Closure - (Uses listed courses and chords)

Error Closure: 0.000 Course: S 31-54-54.9 W

North: -0.0004 East: -0.0002

Precision: 1: 600,848,000.000

Parcel name: Reserve "G"

North: 1695384.246 East: 1684922.115

Curve Length: 63.696 Radius: 131.000
 Delta: 27-51-32.3 Tangent: 32.491
 Chord: 63.071 Course: N 12-26-39.0 E
 Course In: N 63-37-34.9 W Course Out: N 88-30-52.8 E
 RP North: 1695442.439 East: 1684804.750
 End North: 1695445.835 East: 1684935.706

Line Course: N 01-29-07.2 W Length: 15.286

North: 1695461.116 East: 1684935.310

Curve Length: 54.902 Radius: 116.000
 Delta: 27-07-03.5 Tangent: 27.975
 Chord: 54.391 Course: N 15-02-38.9 W
 Course In: S 88-30-52.8 W Course Out: N 61-23-49.3 E
 RP North: 1695458.109 East: 1684819.349
 End North: 1695513.643 East: 1684921.192

Line Course: N 61-23-49.3 E Length: 54.924

North: 1695539.937 East: 1684969.413

Line Course: S 00-54-24.4 E Length: 180.582

North: 1695359.378 East: 1684972.271

Line Course: N 63-37-34.9 W Length: 55.982

North: 1695384.246 East: 1684922.116

Perimeter: 425.372 Area: 6,339 sq.ft. 0.14 acres

Mapcheck Closure - (Uses listed courses and chords)

Error Closure: 0.001 Course: N 69-58-03.3 E
 North: 0.0002 East: 0.0005
 Precision 1: 424,236.000

Parcel name: Reserve "H"

Line Course: N 70-37-02.7 E Length: 131.148	North: 1695694.985 East: 1684466.744
Line Course: S 87-46-07.0 E Length: 88.228	North: 1695738.509 East: 1684590.459
Line Course: S 87-46-07.0 E Length: 80.120	North: 1695735.074 East: 1684678.620
Line Course: S 87-46-07.0 E Length: 80.120	North: 1695731.955 East: 1684758.679
Line Course: S 87-46-07.0 E Length: 127.861	North: 1695728.835 East: 1684838.739
Line Course: N 00-54-24.4 W Length: 61.068	North: 1695723.857 East: 1684966.503
Line Course: S 88-54-23.3 W Length: 15.000	North: 1695784.917 East: 1684965.536
Line Course: N 87-30-47.0 W Length: 90.246	North: 1695784.631 East: 1684950.539
Curve Length: 82.547 Radius: 50.000	North: 1695788.547 East: 1684860.378
Delta: 94-35-30.2 Tangent: 54.177	
Chord: 73.487 Course: S 49-46-58.1 W	
Course In: N 87-30-47.0 W Course Out: S 07-04-43.2 W	
RP North: 1695790.716 East: 1684810.425	
End North: 1695741.097 East: 1684804.263	
Line Course: N 82-55-16.8 W Length: 128.210	
	North: 1695756.897 East: 1684677.030
Curve Length: 201.589 Radius: 371.000	
Delta: 31-07-57.2 Tangent: 103.350	
Chord: 199.118 Course: S 81-30-44.6 W	
Course In: S 07-04-43.2 W Course Out: N 24-03-14.0 W	
RP North: 1695388.725 East: 1684631.311	
End North: 1695727.508 East: 1684480.093	
Curve Length: 28.578 Radius: 179.000	
Delta: 9-08-51.5 Tangent: 14.320	
Chord: 28.548 Course: S 70-31-11.8 W	
Course In: N 24-03-14.0 W Course Out: S 14-54-22.5 E	
RP North: 1695890.964 East: 1684407.134	
End North: 1695717.988 East: 1684453.179	
Line Course: S 30-31-42.5 E Length: 26.705	
	North: 1695694.985 East: 1684466.745

Perimeter: 1141.419 Area: 15,024 sq.ft. 0.34 acres

Mapcheck Closure - (Uses listed courses and chords)

Error Closure: 0.001 Course: N 84-16-52.1 E
 North: 0.0001 East: 0.0005

Precision 1: 1,129,859.000

Parcel name: Reserve "J"

Line Course: N 81-18-54.3 E Length: 214.487 North: 1695947.115 East: 1683882.170
 Line Course: S 53-46-21.2 E Length: 218.326 North: 1695979.502 East: 1684094.198
 Curve Length: 228.415 Radius: 261.000 North: 1695850.473 East: 1684270.316
 Delta: 50-08-33.4 Tangent: 122.102
 Chord: 221.195 Course: S 58-50-15.9 W
 Course In: N 56-14-00.8 W Course Out: S 06-05-27.4 E
 RP North: 1695995.539 East: 1684053.344
 End North: 1695736.013 East: 1684081.039
 Curve Length: 249.087 Radius: 171.000
 Delta: 83-27-35.3 Tangent: 152.516
 Chord: 227.642 Course: N 54-21-39.8 W
 Course In: N 06-05-27.4 W Course Out: S 77-22-07.9 W
 RP North: 1695906.048 East: 1684062.894
 End North: 1695868.654 East: 1683896.033
 Line Course: N 12-37-52.1 W Length: 15.309 North: 1695883.593 East: 1683892.685
 Curve Length: 64.420 Radius: 571.000
 Delta: 6-27-50.7 Tangent: 32.244
 Chord: 64.386 Course: N 09-23-56.8 W
 Course In: N 77-22-07.9 E Course Out: S 83-49-58.6 W
 RP North: 1696008.455 East: 1684449.866
 End North: 1695947.114 East: 1683882.170
 Perimeter: 990.044 Area: 64,729 sq.ft. 1.48 acres

Mapcheck Closure - (Uses listed courses and chords)

Error Closure: 0.000 Course: S 61-13-19.8 E
 North: -0.0001 East: 0.0001
 Precision 1: 961,345,000.000

Parcel name: Reserve "K"

Line Course: S 88-59-20.8 W Length: 99.213 North: 1696759.956 East: 1683707.753
 Line Course: N 01-00-39.2 W Length: 20.000 North: 1696758.205 East: 1683608.556
 Line Course: N 88-59-20.8 E Length: 108.675 North: 1696778.202 East: 1683608.203
 Curve Length: 22.310 Radius: 50.000 North: 1696780.119 East: 1683716.861
 Delta: 25-33-54.7 Tangent: 11.344
 Chord: 22.125 Course: S 24-18-26.9 W
 Course In: S 52-54-35.8 E Course Out: N 78-28-30.5 W
 RP North: 1696749.966 East: 1683756.746
 End North: 1696759.956 East: 1683707.754

Perimeter: 250.197 Area: 2,060 sq.ft. 0.04 acres

Mapcheck Closure - (Uses listed courses and chords)

Error Closure: 0.000 Course: N 54-28-19.1 E
 North: 0.0002 East: 0.0003
 Precision 1: 250,013,000.000

Parcel name: Reserve "M"

Curve Length: 44.890	Radius: 131.000	North: 1694894.400	East: 1683960.687
Delta: 19-38-01.1	Tangent: 22.667		
Chord: 44.671	Course: S 10-49-39.8 E		
Course In: S 69-21-19.7 W	Course Out: N 88-59-20.8 E		
RP North: 1694848.214	East: 1683838.099		
End North: 1694850.525	East: 1683969.079		
Line Course: S 01-00-39.2 E	Length: 46.149		
Curve Length: 17.453	Radius: 40.000	North: 1694804.383	East: 1683969.893
Delta: 25-00-00.0	Tangent: 8.868		
Chord: 17.315	Course: S 11-29-20.8 W		
Course In: S 88-59-20.8 W	Course Out: S 66-00-39.2 E		
RP North: 1694803.677	East: 1683929.899		
End North: 1694787.415	East: 1683966.444		
Line Course: S 23-59-20.8 W	Length: 5.033		
Curve Length: 9.076	Radius: 4.000	North: 1694782.817	East: 1683964.398
Delta: 130-00-00.0	Tangent: 8.578		
Chord: 7.250	Course: S 88-59-20.8 W		
Course In: N 66-00-39.2 W	Course Out: S 63-59-20.8 W		
RP North: 1694784.443	East: 1683960.743		
End North: 1694782.689	East: 1683957.149		
Line Course: N 26-00-39.2 W	Length: 5.033		
Curve Length: 17.453	Radius: 40.000	North: 1694787.212	East: 1683954.942
Delta: 25-00-00.0	Tangent: 8.868		
Chord: 17.315	Course: N 13-30-39.2 W		
Course In: N 63-59-20.8 E	Course Out: S 88-59-20.8 W		
RP North: 1694804.754	East: 1683990.890		
End North: 1694804.048	East: 1683950.896		
Line Course: N 01-00-39.2 W	Length: 46.149		
Curve Length: 44.890	Radius: 131.000	North: 1694850.189	East: 1683950.082
Delta: 19-38-01.0	Tangent: 22.667		
Chord: 44.671	Course: N 08-48-21.3 E		
Course In: N 88-59-20.8 E	Course Out: N 71-22-38.2 W		
RP North: 1694852.501	East: 1684081.062		
End North: 1694894.334	East: 1683956.921		
Curve Length: 4.912	Radius: 2.000		
Delta: 140-43-57.9	Tangent: 5.606		
Chord: 3.767	Course: N 88-59-20.8 E		
Course In: S 71-22-38.2 E	Course Out: N 69-21-19.7 E		
RP North: 1694893.695	East: 1683958.816		

End North: 1694894.400 East: 1683960.687

Perimeter: 241.038 Area: 1,830 sq.ft. 0.04 acres

Mapcheck Closure - (Uses listed courses and chords)

Error Closure: 0.000 Course: N 88-19-49.7 E

North: 0.0000 East: 0.0003

Precision 1: 237,353,000.000

Parcel name: Reserve "N"

North: 1694688.213 East: 1683966.067

Curve Length: 9.076 Radius: 4.000
 Delta: 130-00-00.0 Tangent: 8.578
 Chord: 7.250 Course: S 88-59-20.8 W
 Course In: S 63-59-20.8 W Course Out: N 66-00-39.2 W
 RP North: 1694686.458 East: 1683962.472
 End North: 1694688.085 East: 1683958.818
 Line Course: S 23-59-20.8 W Length: 5.033

North: 1694683.486 East: 1683956.772

Curve Length: 17.453 Radius: 40.000
 Delta: 25-00-00.0 Tangent: 8.868
 Chord: 17.315 Course: S 11-29-20.8 W
 Course In: S 66-00-39.2 E Course Out: S 88-59-20.8 W
 RP North: 1694667.224 East: 1683993.317
 End North: 1694666.518 East: 1683953.323
 Line Course: S 01-00-39.2 E Length: 146.495

North: 1694520.046 East: 1683955.908

Curve Length: 29.845 Radius: 9.500
 Delta: 179-59-56.1 Tangent: 986612.088
 Chord: 19.000 Course: N 88-59-20.8 E
 Course In: N 88-59-18.8 E Course Out: N 88-59-22.7 E
 RP North: 1694520.214 East: 1683965.406
 End North: 1694520.381 East: 1683974.905
 Line Course: N 01-00-39.2 W Length: 146.495

North: 1694666.854 East: 1683972.320

Curve Length: 17.453 Radius: 40.000
 Delta: 25-00-00.0 Tangent: 8.868
 Chord: 17.315 Course: N 13-30-39.2 W
 Course In: S 88-59-20.8 W Course Out: N 63-59-20.8 E
 RP North: 1694666.148 East: 1683932.326
 End North: 1694683.689 East: 1683968.275
 Line Course: N 26-00-39.2 W Length: 5.033

North: 1694688.213 East: 1683966.068

Perimeter: 376.883 Area: 3,259 sq.ft. 0.07 acres

Mapcheck Closure - (Uses listed courses and chords)

Error Closure: 0.001 Course: N 88-59-20.8 E

North: 0.0000 East: 0.0006

Precision 1: 363,936.000

Parcel name: Reserve "O"

Line Course: N 01-00-39.2 W Length: 210.779 North: 1694493.386 East: 1683890.867

Line Course: N 88-59-20.8 E Length: 12.000 North: 1694704.132 East: 1683887.149

Curve Length: 46.338 Radius: 29.500 North: 1694704.344 East: 1683899.147

Delta: 90-00-00.0 Tangent: 29.500

Chord: 41.719 Course: S 46-00-39.2 E

Course In: S 01-00-39.2 E Course Out: N 88-59-20.8 E

RP North: 1694674.848 East: 1683899.667

End North: 1694675.369 East: 1683929.162

Line Course: S 01-00-39.2 E Length: 73.422 North: 1694601.958 East: 1683930.458

Curve Length: 35.112 Radius: 194.500

Delta: 10-20-35.4 Tangent: 17.604

Chord: 35.064 Course: S 04-09-38.5 W

Course In: S 88-59-20.8 W Course Out: S 80-40-03.8 E

RP North: 1694598.527 East: 1683735.988

End North: 1694566.987 East: 1683927.914

Curve Length: 37.097 Radius: 205.500

Delta: 10-20-35.4 Tangent: 18.599

Chord: 37.047 Course: S 04-09-38.5 W

Course In: S 80-40-03.8 E Course Out: S 88-59-20.8 W

RP North: 1694533.663 East: 1684130.694

End North: 1694530.037 East: 1683925.226

Line Course: S 01-00-39.2 E Length: 35.983 North: 1694494.060 East: 1683925.861

Line Course: S 88-53-46.3 W Length: 35.000 North: 1694493.386 East: 1683890.867

Perimeter: 485.732 Area: 8,089 sq.ft. 0.18 acres

Mapcheck Closure - (Uses listed courses and chords)
Error Closure: 0.000 Course: S 89-03-41.4 W

North: -0.0000 East: -0.0002

Precision 1: 481,014,000.000

Parcel name: Reserve "P"

Line Course: N 88-53-46.3 E Length: 41.500 North: 1694495.476 East: 1683999.347

Line Course: N 01-00-39.2 W Length: 210.536 North: 1694496.275 East: 1684040.840

Line Course: S 88-59-20.8 W Length: 12.000 North: 1694706.778 East: 1684037.125

Curve Length: 46.338 Radius: 29.500 North: 1694706.567 East: 1684025.127

Delta: 90-00-00.0 Tangent: 29.500

Chord: 41.719 Course: S 43-59-20.8 W

Course In: S 01-00-39.2 E Course Out: S 88-59-20.8 W

RP North: 1694677.071 East: 1684025.648

End North: 1694676.551 East: 1683996.152

Line Course: S 01-00-39.2 E Length: 181.103

North: 1694495.476 East: 1683999.347

Perimeter: 491.478 Area: 8,551 sq.ft. 0.19 acres

Mapcheck Closure - (Uses listed courses and chords)

Error Closure: 0.001 Course: N 16-04-33.1 E

North: 0.0005 East: 0.0001

Precision 1: 486,858.000

Parcel name: Block 1, Lot 1

Line Course: N 01-00-39.2 W Length: 145.000

North: 1695326.859 East: 1683633.813

North: 1695471.837 East: 1683631.254

Line Course: N 88-59-20.8 E Length: 204.973

North: 1695475.453 East: 1683836.196

Curve Length: 64.790

Radius: 369.000

Delta: 10-03-36.8

Tangent: 32.479

Chord: 64.707

Course: S 22-25-08.5 E

Course In: N 72-36-39.9 E Course Out: S 62-33-03.1 W

RP North: 1695585.731 East: 1684188.332

End North: 1695415.637 East: 1683860.873

Curve Length: 91.416

Radius: 571.000

Delta: 9-10-22.7

Tangent: 45.806

Chord: 91.319

Course: S 22-51-45.5 E

Course In: S 62-33-03.1 W Course Out: N 71-43-25.8 E

RP North: 1695152.428 East: 1683354.156

End North: 1695331.492 East: 1683896.353

Line Course: S 88-59-20.8 W Length: 262.581

North: 1695326.859 East: 1683633.813

Perimeter: 768.761 Area: 33,924 sq.ft. 0.77 acres

Mapcheck Closure - (Uses listed courses and chords)

Error Closure: 0.000 Course: S 36-26-18.2 E

North: -0.0002 East: 0.0002

Precision 1: 768,580,000.000

Parcel name: Block 1, Lot 2

Line Course: N 88-59-20.8 E Length: 195.761

North: 1695616.814 East: 1683628.696

North: 1695620.268 East: 1683824.427

Curve Length: 89.143

Radius: 279.000

Delta: 18-18-23.1

Tangent: 44.954

Chord: 88.764

Course: S 00-42-13.2 W

Course In: S 80-08-35.2 E Course Out: S 81-33-01.7 W

RP North: 1695572.506 East: 1684099.308

End North: 1695531.511 East: 1683823.337

Curve Length: 57.572

Radius: 369.000

Delta: 8-56-21.8

Tangent: 28.845

Chord: 57.514

Course: S 12-55-09.2 E

Course In: N 81-33-01.7 E Course Out: S 72-36-39.9 W
 RP North: 1695585.731 East: 1684188.331
 End North: 1695475.452 East: 1683836.196
 Line Course: S 88-59-20.8 W Length: 204.973

Line Course: N 01-00-39.2 W Length: 145.000 North: 1695471.836 East: 1683631.254
 North: 1695616.814 East: 1683628.696

Perimeter: 692.449 Area: 28,198 sq.ft. 0.64 acres

Mapcheck Closure - (Uses listed courses and chords)

Error Closure: 0.001 Course: S 01-27-50.4 W
 North: -0.0005 East: -0.0000
 Precision 1: 692,012.000

Parcel name: Block 1, Lot 3

Line Course: S 01-00-39.2 E Length: 135.000 North: 1695751.793 East: 1683626.315
 Line Course: N 88-59-20.8 E Length: 195.761 North: 1695616.814 East: 1683628.696
 North: 1695620.268 East: 1683824.427

Curve Length: 152.833 Radius: 279.000
 Delta: 31-23-09.2 Tangent: 78.386
 Chord: 150.929 Course: N 25-32-59.4 E
 Course In: S 80-08-35.2 E Course Out: N 48-45-26.0 W
 RP North: 1695572.506 East: 1684099.308
 End North: 1695756.438 East: 1683889.522
 Line Course: S 88-59-20.8 W Length: 263.249

North: 1695751.793 East: 1683626.314

Perimeter: 746.843 Area: 29,932 sq.ft. 0.68 acres

Mapcheck Closure - (Uses listed courses and chords)

Error Closure: 0.001 Course: N 82-47-55.8 W
 North: 0.0001 East: -0.0007
 Precision 1: 744,939.000

Parcel name: Block 1, Lot 4

Curve Length: 112.555 Radius: 229.000 North: 1695756.438 East: 1683889.522
 Delta: 28-09-40.3 Tangent: 57.438
 Chord: 111.425 Course: N 26-42-42.3 W
 Course In: N 49-12-27.6 E Course Out: S 77-22-07.9 W
 RP North: 1695906.048 East: 1684062.894
 End North: 1695855.971 East: 1683839.436
 Line Course: N 12-37-52.1 W Length: 15.309

North: 1695870.910 East: 1683836.089

Curve Length: 19.951 Radius: 629.000
 Delta: 1-49-02.4 Tangent: 9.976
 Chord: 19.950 Course: N 11-43-20.9 W
 Course In: N 77-22-07.9 E Course Out: S 79-11-10.3 W

RP North: 1696008.455 East: 1684449.866
 End North: 1695890.444 East: 1683832.035
 Line Course: S 88-59-20.8 W Length: 208.135

North: 1695886.772 East: 1683623.933

Line Course: S 01-00-39.2 E Length: 135.000

North: 1695751.793 East: 1683626.315

Line Course: N 88-59-20.8 E Length: 263.249

North: 1695756.437 East: 1683889.523

Perimeter: 754.199 Area: 30,807 sq.ft. 0.70 acres

Mapcheck Closure - (Uses listed courses and chords)

Error Closure: 0.001 Course: S 34-57-37.1 E

North: -0.0006 East: 0.0004

Precision 1: 753,068.000

Parcel name: Block 1, Lot 5

Line Course: N 88-59-20.8 E Length: 199.570

North: 1696021.751 East: 1683621.551

Curve Length: 135.533 Radius: 629.000

Delta: 12-20-44.8 Tangent: 68.030

Chord: 135.271 Course: S 04-38-27.3 E

Course In: S 88-28-04.9 E Course Out: S 79-11-10.3 W

RP North: 1696008.456 East: 1684449.865

End North: 1695890.445 East: 1683832.035

Line Course: S 88-59-20.8 W Length: 208.135

North: 1695886.773 East: 1683623.932

Line Course: N 01-00-39.2 W Length: 135.000

North: 1696021.752 East: 1683621.550

Perimeter: 678.239 Area: 27,191 sq.ft. 0.62 acres

Mapcheck Closure - (Uses listed courses and chords)

Error Closure: 0.001 Course: N 53-13-50.4 W

North: 0.0004 East: -0.0005

Precision 1: 677,976.000

Parcel name: Block 1, Lot 6

Line Course: N 01-00-39.2 W Length: 176.278

North: 1696021.751 East: 1683621.551

Line Course: S 77-09-26.6 E Length: 223.757

North: 1696198.002 East: 1683618.441

Curve Length: 124.170 Radius: 629.000

Delta: 11-18-38.3 Tangent: 62.287

Chord: 123.968 Course: S 07-11-14.3 W

Course In: S 77-09-26.6 E Course Out: N 88-28-04.9 W

RP North: 1696008.456 East: 1684449.866

End North: 1696025.272 East: 1683821.091

Line Course: S 88-59-20.8 W Length: 199.570

North: 1696148.266 East: 1683836.601

North: 1696021.752 East: 1683621.552

Perimeter: 723.774 Area: 31,138 sq.ft. 0.71 acres

Mapcheck Closure - (Uses listed courses and chords)

Error Closure: 0.001 Course: N 52-05-54.1 E

North: 0.0005 East: 0.0006

Precision 1: 723,573.000

Parcel name: Block 1, Lot 7

Line Course: N 77-09-26.6 W Length: 223.757 North: 1696148.266 East: 1683836.600
 Line Course: N 01-00-39.2 W Length: 220.570 North: 1696198.001 East: 1683618.441
 Line Course: S 57-35-57.7 E Length: 309.777 North: 1696418.537 East: 1683614.549
 North: 1696252.547 East: 1683876.101

Curve Length: 67.226 Radius: 249.000
 Delta: 15-28-08.1 Tangent: 33.819
 Chord: 67.022 Course: S 24-39-58.2 W
 Course In: S 57-35-57.7 E Course Out: N 73-04-05.8 W
 RP North: 1696119.124 East: 1684086.337
 End North: 1696191.641 East: 1683848.131
 Curve Length: 44.891 Radius: 629.000
 Delta: 14-05-20.8 Tangent: 22.455
 Chord: 44.881 Course: S 14-53-13.8 W
 Course In: S 73-04-05.8 E Course Out: N 77-09-26.6 W
 RP North: 1696008.456 East: 1684449.865
 End North: 1696148.266 East: 1683836.600

Perimeter: 866.221 Area: 40,506 sq.ft. 0.92 acres

Mapcheck Closure - (Uses listed courses and chords)

Error Closure: 0.000 Course: N 70-05-10.6 W

North: 0.0002 East: -0.0004

Precision 1: 866,007,000.000

Parcel name: Block 1, Lot 8

Line Course: N 33-22-18.4 W Length: 213.078 North: 1696327.069 East: 1683949.370
 Line Course: S 78-02-40.4 W Length: 51.162 North: 1696505.014 East: 1683832.163
 Line Course: S 65-38-13.2 W Length: 183.941 North: 1696494.416 East: 1683782.110
 Line Course: S 57-35-57.7 E Length: 309.777 North: 1696418.537 East: 1683614.549
 North: 1696252.547 East: 1683876.101
 Curve Length: 105.290 Radius: 249.000
 Delta: 24-13-39.3 Tangent: 53.444
 Chord: 104.507 Course: N 44-30-52.0 E
 Course In: S 57-35-57.7 E Course Out: N 33-22-18.4 W

RP North: 1696119.124 East: 1684086.337
 End North: 1696327.069 East: 1683949.370

Perimeter: 863.248 Area: 40,879 sq.ft. 0.93 acres

Mapcheck Closure - (Uses listed courses and chords)

Error Closure: 0.001 Course: N 88-35-06.5 W
 North: 0.0000 East: -0.0008
 Precision 1: 862,465.000

Parcel name: Block 1, Lot 9

Line Course: S 78-02-40.4 W Length: 86.339 North: 1696522.899 East: 1683916.629
 Line Course: S 33-22-18.4 E Length: 213.078 North: 1696505.014 East: 1683832.163
 Curve Length: 105.290 Radius: 249.000 North: 1696327.068 East: 1683949.370
 Delta: 24-13-39.4 Tangent: 53.444
 Chord: 104.507 Course: N 68-44-31.3 E
 Course In: S 33-22-18.4 E Course Out: N 09-08-39.0 W
 RP North: 1696119.124 East: 1684086.338
 End North: 1696364.959 East: 1684046.767
 Line Course: N 09-08-39.0 W Length: 181.690
 Line Course: S 78-02-40.4 W Length: 103.509 North: 1696544.340 East: 1684017.892
 North: 1696522.898 East: 1683916.629
 Perimeter: 689.906 Area: 27,725 sq.ft. 0.63 acres

Mapcheck Closure - (Uses listed courses and chords)

Error Closure: 0.001 Course: S 17-49-37.8 W
 North: -0.0008 East: -0.0003
 Precision 1: 689,123.000

Parcel name: Block 1, Lot 10

Line Course: S 87-32-30.9 E Length: 160.027 North: 1696551.382 East: 1684051.147
 North: 1696544.519 East: 1684211.027
 Curve Length: 78.578 Radius: 571.000
 Delta: 7-53-05.0 Tangent: 39.351
 Chord: 78.516 Course: S 09-27-22.2 W
 Course In: N 84-29-10.3 W Course Out: S 76-36-05.3 E
 RP North: 1696599.384 East: 1683642.669
 End North: 1696467.070 East: 1684198.127
 Line Course: S 13-23-54.7 W Length: 115.380 North: 1696354.831 East: 1684171.391
 Line Course: N 76-36-05.3 W Length: 28.120 North: 1696361.347 East: 1684144.037
 Curve Length: 97.968 Radius: 249.000
 Delta: 22-32-33.7 Tangent: 49.626
 Chord: 97.337 Course: N 87-52-22.2 W

Course In: S 13-23-54.7 W Course Out: N 09-08-39.0 W
 RP North: 1696119.124 East: 1684086.338
 End North: 1696364.959 East: 1684046.767
 Line Course: N 09-08-39.0 W Length: 181.690

North: 1696544.340 East: 1684017.893

Line Course: N 78-02-40.4 E Length: 33.992

North: 1696551.382 East: 1684051.147

Perimeter: 695.755 Area: 29,824 sq.ft. 0.68 acres

Mapcheck Closure - (Uses listed courses and chords)

Error Closure: 0.001 Course: S 04-05-53.2 E
 North: -0.0005 East: 0.0000
 Precision 1: 695,062.000

Parcel name: Block 1, Lot 11

Line Course: N 87-32-30.9 W Length: 160.027

North: 1696544.519 East: 1684211.027

Line Course: N 01-00-39.2 W Length: 186.114

North: 1696551.382 East: 1684051.147

Curve Length: 192.403 Radius: 221.000
 Delta: 49-52-54.5 Tangent: 102.777
 Chord: 186.384 Course: S 81-42-44.8 E
 Course In: S 16-39-12.1 E Course Out: N 33-13-42.4 E

North: 1696737.468 East: 1684047.864

RP North: 1696525.737 East: 1684111.198
 End North: 1696710.602 East: 1684232.301

Curve Length: 91.053 Radius: 179.000
 Delta: 29-08-42.4 Tangent: 46.534
 Chord: 90.075 Course: S 12-14-41.3 W

Course In: S 63-10-57.5 E Course Out: S 87-40-20.1 W
 RP North: 1696629.846 East: 1684392.050
 End North: 1696622.576 East: 1684213.197

Curve Length: 78.148 Radius: 571.000
 Delta: 7-50-29.6 Tangent: 39.135
 Chord: 78.087 Course: S 01-35-34.9 W

Course In: S 87-40-20.1 W Course Out: S 84-29-10.3 E
 RP North: 1696599.384 East: 1683642.668
 End North: 1696544.519 East: 1684211.026

Perimeter: 707.744 Area: 32,124 sq.ft. 0.73 acres

Mapcheck Closure - (Uses listed courses and chords)

Error Closure: 0.000 Course: N 78-32-19.4 W
 North: 0.0001 East: -0.0004
 Precision 1: 700,687,000.000

Parcel name: Block 1, Lot 12

Line Course: N 78-02-40.4 E Length: 33.992

North: 1696544.341 East: 1684017.893

North: 1696551.382 East: 1684051.147

Line Course: N 01-00-39.2 W Length: 186.114
 North: 1696737.468 East: 1684047.864

Curve Length: 128.844 Radius: 329.000
 Delta: 22-26-18.3 Tangent: 65.258
 Chord: 128.023 Course: S 84-33-57.0 W
 Course In: N 16-39-12.1 W Course Out: S 05-47-06.2 W
 RP North: 1697052.668 East: 1683953.579
 End North: 1696725.343 East: 1683920.416

Line Course: N 84-12-53.8 W Length: 7.411
 North: 1696726.090 East: 1683913.043

Line Course: S 01-00-39.2 E Length: 203.223
 North: 1696522.899 East: 1683916.628

Line Course: N 78-02-40.4 E Length: 103.509
 North: 1696544.341 East: 1684017.892

Perimeter: 663.092 Area: 25,650 sq.ft. 0.58 acres

Mapcheck Closure - (Uses listed courses and chords)

Error Closure: 0.001 Course: N 79-37-17.5 W
 North: 0.0001 East: -0.0006
 Precision 1: 662,272.000

Parcel name: Block 1, Lot 13

Line Course: S 01-00-39.2 E Length: 210.514
 North: 1696704.897 East: 1683778.397

Line Course: N 78-02-40.4 E Length: 51.162
 North: 1696494.416 East: 1683782.111

Line Course: N 78-02-40.4 E Length: 86.339
 North: 1696505.014 East: 1683832.163

Line Course: N 01-00-39.2 W Length: 203.223
 North: 1696522.899 East: 1683916.629

Line Course: N 84-12-53.8 W Length: 108.553
 North: 1696726.090 East: 1683913.044

Curve Length: 43.065 Radius: 50.000
 Delta: 49-20-54.2 Tangent: 22.970
 Chord: 41.746 Course: S 39-39-58.1 W
 Course In: N 75-00-29.0 W Course Out: S 25-39-34.8 E
 RP North: 1696749.966 East: 1683756.745
 End North: 1696704.897 East: 1683778.396

Perimeter: 702.855 Area: 29,680 sq.ft. 0.68 acres

Mapcheck Closure - (Uses listed courses and chords)

Error Closure: 0.000 Course: N 12-17-02.7 W
 North: 0.0003 East: -0.0001
 Precision 1: 701,537,000.000

Parcel name: Block 1, Lot 14

Curve Length: 110.989 Radius: 50.000
 North: 1696704.897 East: 1683778.397

Delta: 127-11-04.3 Tangent: 100.690
 Chord: 89.565 Course: N 52-04-02.6 W
 Course In: N 25-39-34.8 W Course Out: N 78-28-30.5 W
 RP North: 1696749.966 East: 1683756.745
 End North: 1696759.956 East: 1683707.754
 Line Course: S 88-59-20.8 W Length: 99.213

Line Course: S 01-00-39.2 E Length: 339.721 North: 1696758.205 East: 1683608.556
 Line Course: N 65-38-13.2 E Length: 183.941 North: 1696418.537 East: 1683614.549
 Line Course: N 01-00-39.2 W Length: 210.514 North: 1696494.416 East: 1683782.111
 North: 1696704.897 East: 1683778.397

Perimeter: 944.378 Area: 47,473 sq.ft. 1.08 acres

Mapcheck Closure - (Uses listed courses and chords)

Error Closure: 0.000 Course: N 45-16-30.0 E
 North: 0.0001 East: 0.0001
 Precision 1: 922,954,000.000

Parcel name: Block 1, Lot 15

Curve Length: 51.221 Radius: 50.000 North: 1696799.711 East: 1683761.785
 Delta: 58-41-42.0 Tangent: 28.113
 Chord: 49.011 Course: S 66-26-15.2 W
 Course In: S 05-47-06.2 W Course Out: N 52-54-35.8 W
 RP North: 1696749.966 East: 1683756.745
 End North: 1696780.119 East: 1683716.860
 Line Course: S 88-59-20.8 W Length: 108.675
 Line Course: N 01-00-39.2 W Length: 211.653 North: 1696778.202 East: 1683608.202
 Line Course: N 88-54-54.5 E Length: 145.220 North: 1696989.822 East: 1683604.468
 Line Course: S 03-35-48.1 E Length: 193.241 North: 1696992.572 East: 1683749.662
 North: 1696799.711 East: 1683761.785

Perimeter: 710.008 Area: 31,117 sq.ft. 0.71 acres

Mapcheck Closure - (Uses listed courses and chords)

Error Closure: 0.000 Course: S 59-10-07.6 W
 North: -0.0002 East: -0.0003
 Precision 1: 707,800,000.000

Parcel name: Block 1, Lot 16

Line Course: S 84-12-53.8 E Length: 132.482 North: 1696799.711 East: 1683761.785
 Line Course: N 01-05-05.6 W Length: 208.902 North: 1696786.358 East: 1683893.592
 North: 1696995.222 East: 1683889.637

Line Course: S 88-54-54.5 W Length: 140.000

North: 1696992.571 East: 1683749.662

Line Course: S 03-35-48.1 E Length: 193.241

North: 1696799.711 East: 1683761.785

Perimeter: 674.625 Area: 27,252 sq.ft. 0.62 acres

Mapcheck Closure - (Uses listed courses and chords)

Error Closure: 0.000 Course: S 54-49-28.6 W

North: -0.0002 East: -0.0004

Precision 1: 674,625,000.000

Parcel name: Block 1, Lot 17

Line Course: S 01-05-05.6 E Length: 208.902

North: 1696995.222 East: 1683889.637

North: 1696786.357 East: 1683893.593

Line Course: S 84-12-53.8 E Length: 32.837

North: 1696783.048 East: 1683926.263

Curve Length: 106.130 Radius: 271.000
Delta: 22-26-18.3 Tangent: 53.754
Chord: 105.453 Course: N 84-33-57.0 E
Course In: N 05-47-06.2 E Course Out: S 16-39-12.1 E
RP North: 1697052.667 East: 1683953.578
End North: 1696793.034 East: 1684031.242

Line Course: N 01-51-15.8 W Length: 204.851

North: 1696997.778 East: 1684024.613

Line Course: S 88-54-54.5 W Length: 135.000

North: 1696995.222 East: 1683889.637

Perimeter: 687.720 Area: 28,916 sq.ft. 0.66 acres

Mapcheck Closure - (Uses listed courses and chords)

Error Closure: 0.001 Course: S 81-39-54.7 W

North: -0.0001 East: -0.0006

Precision 1: 687,043.000

Parcel name: Block 1, Lot 18

Line Course: S 01-05-05.6 E Length: 200.558

North: 1697000.334 East: 1684159.589

North: 1696799.812 East: 1684163.386

Curve Length: 133.590 Radius: 279.000
Delta: 27-26-03.4 Tangent: 68.101
Chord: 132.318 Course: S 87-03-49.6 W
Course In: S 10-46-51.3 W Course Out: N 16-39-12.1 W
RP North: 1696525.736 East: 1684111.198
End North: 1696793.034 East: 1684031.242

Line Course: N 01-51-15.8 W Length: 204.851

North: 1696997.778 East: 1684024.613

Line Course: N 88-54-54.5 E Length: 135.000

North: 1697000.334 East: 1684159.589

Perimeter: 673.999 Area: 26,383 sq.ft. 0.60 acres

Mapcheck Closure - (Uses listed courses and chords)

Error Closure: 0.000 Course: S 13-30-32.9 W
 North: -0.0002 East: -0.0001
 Precision 1: 672,727,000.000

Parcel name: Block 1, Lot 19

Line Course: N 01-05-05.6 W Length: 220.330 North: 1696782.599 East: 1684298.737
 Line Course: S 88-54-54.5 W Length: 135.000 North: 1697002.890 East: 1684294.565
 Line Course: S 01-05-05.6 E Length: 200.558 North: 1697000.334 East: 1684159.589
 North: 1696799.812 East: 1684163.386

Curve Length: 112.268 Radius: 279.000
 Delta: 23-03-19.5 Tangent: 56.904
 Chord: 111.512 Course: S 67-41-28.9 E
 Course In: S 10-46-51.3 W Course Out: N 33-50-10.8 E
 RP North: 1696525.736 East: 1684111.198
 End North: 1696757.482 East: 1684266.552
 Curve Length: 40.914 Radius: 179.000
 Delta: 13-05-46.2 Tangent: 20.547
 Chord: 40.825 Course: N 52-01-55.8 E
 Course In: S 44-30-57.3 E Course Out: N 31-25-11.1 W
 RP North: 1696629.845 East: 1684392.050
 End North: 1696782.599 East: 1684298.737

Perimeter: 709.070 Area: 29,935 sq.ft. 0.68 acres

Mapcheck Closure - (Uses listed courses and chords)

Error Closure: 0.001 Course: S 07-26-53.7 E
 North: -0.0007 East: 0.0001
 Precision 1: 708,225.000

Parcel name: Block 1, Lot 20

Curve Length: 150.250 Radius: 179.000 North: 1696801.320 East: 1684443.408
 Delta: 48-05-35.5 Tangent: 79.870
 Chord: 145.878 Course: S 82-37-36.7 W
 Course In: S 16-40-24.4 W Course Out: N 31-25-11.1 W
 RP North: 1696629.846 East: 1684392.050
 End North: 1696782.599 East: 1684298.736
 Line Course: N 01-05-05.6 W Length: 220.330 North: 1697002.890 East: 1684294.565
 Line Course: N 88-54-54.5 E Length: 145.000 North: 1697005.635 East: 1684439.539
 Line Course: S 01-05-05.6 E Length: 204.352 North: 1696801.320 East: 1684443.408

Perimeter: 719.932 Area: 29,265 sq.ft. 0.67 acres

Mapcheck Closure - (Uses listed courses and chords)

Error Closure: 0.000 Course: S 62-35-29.4 W
 North: -0.0002 East: -0.0003
 Precision 1: 715,560,000.000

Parcel name: Block 1, Lot 21

Line Course: N 88-54-54.5 E Length: 135.000 North: 1697005.635 East: 1684439.539
 Line Course: S 01-05-05.6 E Length: 234.802 North: 1697008.191 East: 1684574.515
 Curve Length: 119.969 Radius: 271.000 North: 1696773.431 East: 1684578.960
 Delta: 25-21-51.3 Tangent: 60.984
 Chord: 118.992 Course: N 79-43-16.4 W
 Course In: N 02-24-12.1 W Course Out: S 22-57-39.2 W
 RP North: 1697044.193 East: 1684567.596
 End North: 1696794.664 East: 1684461.878
 Curve Length: 19.643 Radius: 179.000
 Delta: 6-17-14.8 Tangent: 9.831
 Chord: 19.633 Course: N 70-10-58.2 W
 Course In: S 22-57-39.2 W Course Out: N 16-40-24.4 E
 RP North: 1696629.846 East: 1684392.050
 End North: 1696801.320 East: 1684443.408
 Line Course: N 01-05-05.6 W Length: 204.352 North: 1697005.635 East: 1684439.539
 Perimeter: 713.766 Area: 30,358 sq.ft. 0.69 acres

Mapcheck Closure - (Uses listed courses and chords)

Error Closure: 0.000 Course: N 73-05-11.9 W
 North: 0.0001 East: -0.0003
 Precision 1: 712,779,000.000

Parcel name: Block 1, Lot 22

Line Course: N 88-54-54.5 E Length: 180.000 North: 1697008.191 East: 1684574.515
 Line Course: S 14-16-54.9 W Length: 223.868 North: 1697011.599 East: 1684754.482
 Curve Length: 31.507 Radius: 50.000 North: 1696794.650 East: 1684699.256
 Delta: 36-06-15.0 Tangent: 16.296
 Chord: 30.988 Course: S 86-13-47.4 W
 Course In: S 14-16-54.9 W Course Out: N 21-49-20.1 W
 RP North: 1696746.196 East: 1684686.921
 End North: 1696792.613 East: 1684668.335
 Curve Length: 91.848 Radius: 271.000
 Delta: 19-25-08.0 Tangent: 46.369
 Chord: 91.409 Course: S 77-53-13.9 W
 Course In: N 21-49-20.1 W Course Out: S 02-24-12.1 E
 RP North: 1697044.193 East: 1684567.596

End North: 1696773.432 East: 1684578.961
 Line Course: N 01-05-05.6 W Length: 234.802

North: 1697008.192 East: 1684574.515

Perimeter: 762.025 Area: 33,575 sq.ft. 0.77 acres

Mapcheck Closure - (Uses listed courses and chords)

Error Closure: 0.001 Course: N 63-52-26.0 E
 North: 0.0002 East: 0.0005
 Precision 1: 761,067.000

Parcel name: Block 1, Lot 23

Curve Length: 65.285 Radius: 50.000 North: 1696746.987 East: 1684736.915
 Delta: 74-48-40.7 Tangent: 38.236
 Chord: 60.745 Course: N 38-18-44.7 W
 Course In: S 89-05-35.6 W Course Out: N 14-16-54.9 E
 RP North: 1696746.195 East: 1684686.921
 End North: 1696794.650 East: 1684699.256
 Line Course: N 14-16-54.9 E Length: 223.868

Line Course: N 88-54-54.5 E Length: 176.614 North: 1697011.599 East: 1684754.483

Line Course: S 00-54-24.4 E Length: 264.851 North: 1697014.943 East: 1684931.065

Line Course: S 89-05-35.6 W Length: 198.367 North: 1696750.125 East: 1684935.256

Perimeter: 928.985 Area: 54,577 sq.ft. 1.25 acres North: 1696746.986 East: 1684736.914

Mapcheck Closure - (Uses listed courses and chords)

Error Closure: 0.001 Course: S 24-15-50.8 W
 North: -0.0011 East: -0.0005
 Precision 1: 924,445.000

Parcel name: Block 1, Lot 24

Line Course: N 89-05-35.6 E Length: 198.367 North: 1696746.987 East: 1684736.915

Line Course: S 00-54-24.4 E Length: 250.603 North: 1696750.126 East: 1684935.257

Line Course: S 89-05-35.6 W Length: 187.596 North: 1696499.554 East: 1684939.223

Line Course: N 14-32-16.1 W Length: 207.866 North: 1696496.585 East: 1684751.650

Curve Length: 66.645 Radius: 50.000 North: 1696697.796 East: 1684699.472
 Delta: 76-22-08.3 Tangent: 39.324
 Chord: 61.820 Course: N 37-16-39.7 E
 Course In: N 14-32-16.1 W Course Out: N 89-05-35.6 E
 RP North: 1696746.195 East: 1684686.921
 End North: 1696746.987 East: 1684736.915

Perimeter: 911.076 Area: 52,960 sq.ft. 1.21 acres

Mapcheck Closure - (Uses listed courses and chords)

Error Closure: 0.000 Course: N 64-13-44.2 E
 North: 0.0002 East: 0.0004
 Precision 1: 906,252,000.000

Parcel name: Block 1, Lot 25

Line Course: N 89-05-35.6 E Length: 27.404	North: 1696496.152 East: 1684724.249
Line Course: N 14-32-16.1 W Length: 207.866	North: 1696496.585 East: 1684751.650
Curve Length: 67.972 Radius: 50.000	North: 1696697.796 East: 1684699.472
Delta: 77-53-26.1 Tangent: 40.410	
Chord: 62.858 Course: N 65-35-33.1 W	
Course In: N 14-32-16.1 W Course Out: S 63-21-10.0 W	
RP North: 1696746.195 East: 1684686.921	
End North: 1696723.770 East: 1684642.231	
Curve Length: 74.720 Radius: 329.000	
Delta: 13-00-45.0 Tangent: 37.521	
Chord: 74.559 Course: S 83-23-39.2 W	
Course In: N 13-06-43.3 W Course Out: S 00-05-58.3 E	
RP North: 1697044.193 East: 1684567.596	
End North: 1696715.193 East: 1684568.167	
Line Course: S 00-54-24.4 E Length: 221.484	North: 1696493.737 East: 1684571.672
Line Course: N 89-05-35.6 E Length: 152.596	North: 1696496.152 East: 1684724.249
Perimeter: 752.043 Area: 33,314 sq.ft. 0.76 acres	

Mapcheck Closure - (Uses listed courses and chords)

Error Closure: 0.000 Course: N 16-16-23.3 W
 North: 0.0003 East: -0.0001
 Precision 1: 746,767,000.000

Parcel name: Block 1, Lot 26

Line Course: S 00-54-24.4 E Length: 221.484	North: 1696715.194 East: 1684568.168
Line Course: S 89-05-35.6 W Length: 16.008	North: 1696493.737 East: 1684571.673
Line Course: N 81-34-35.8 W Length: 126.494	North: 1696493.484 East: 1684555.667
Line Course: N 02-10-37.9 E Length: 229.412	North: 1696512.014 East: 1684430.537
Curve Length: 132.416 Radius: 329.000	North: 1696741.260 East: 1684439.253
Delta: 23-03-37.5 Tangent: 67.117	
Chord: 131.524 Course: S 78-34-09.5 E	

Course In: N 22-57-39.2 E Course Out: S 00-05-58.3 E
 RP North: 1697044.194 East: 1684567.597
 End North: 1696715.194 East: 1684568.168

Perimeter: 725.815 Area: 30,066 sq.ft. 0.69 acres

Mapcheck Closure - (Uses listed courses and chords)

Error Closure: 0.001 Course: N 20-22-03.8 E
 North: 0.0007 East: 0.0003
 Precision 1: 724,922.000

Parcel name: Block 1, Lot 27

Line Course: N 81-34-35.8 W Length: 163.836 North: 1696512.013 East: 1684430.537

North: 1696536.013 East: 1684268.468

Curve Length: 89.033 Radius: 629.000
 Delta: 8-06-36.2 Tangent: 44.591
 Chord: 88.959 Course: N 01-43-38.2 E
 Course In: N 84-13-03.7 W Course Out: N 87-40-20.1 E
 RP North: 1696599.384 East: 1683642.669
 End North: 1696624.932 East: 1684271.150

Curve Length: 243.472 Radius: 121.000
 Delta: 115-17-19.1 Tangent: 190.992
 Chord: 204.428 Course: N 55-18-59.7 E
 Course In: N 87-40-20.1 E Course Out: N 22-57-39.2 E
 RP North: 1696629.846 East: 1684392.050
 End North: 1696741.260 East: 1684439.253

Line Course: S 02-10-37.9 W Length: 229.412

North: 1696512.013 East: 1684430.537

Perimeter: 725.753 Area: 34,016 sq.ft. 0.78 acres

Mapcheck Closure - (Uses listed courses and chords)

Error Closure: 0.000 Course: N 84-33-03.4 E
 North: 0.0000 East: 0.0003
 Precision 1: 686,635,000.000

Parcel name: Block 1, Lot 28

Line Course: N 81-34-35.8 W Length: 163.836 North: 1696512.013 East: 1684430.537

North: 1696536.013 East: 1684268.468

Curve Length: 83.612 Radius: 629.000
 Delta: 7-36-58.4 Tangent: 41.868
 Chord: 83.550 Course: S 09-35-25.5 W
 Course In: N 84-13-03.7 W Course Out: S 76-36-05.3 E
 RP North: 1696599.384 East: 1683642.669
 End North: 1696453.631 East: 1684254.549

Line Course: S 13-23-54.7 W Length: 115.380

North: 1696341.391 East: 1684227.812

Line Course: S 76-36-05.3 E Length: 14.319

North: 1696338.073 East: 1684241.742

Curve Length: 157.967 Radius: 209.000
 Delta: 43-18-19.7 Tangent: 82.972
 Chord: 154.234 Course: S 54-56-55.4 E
 Course In: S 13-23-54.7 W Course Out: N 56-42-14.4 E
 RP North: 1696134.762 East: 1684193.312
 End North: 1696249.495 East: 1684368.004
 Line Course: N 13-23-54.7 E Length: 269.864

North: 1696512.014 East: 1684430.537

Perimeter: 804.978 Area: 35,201 sq.ft. 0.80 acres

Mapcheck Closure - (Uses listed courses and chords)

Error Closure: 0.001 Course: N 18-29-05.5 E
 North: 0.0007 East: 0.0002
 Precision 1: 801,183.000

Parcel name: Block 1, Lot 29

Curve Length: 202.505 Radius: 529.000
 Delta: 21-55-59.5 Tangent: 102.507
 Chord: 201.271 Course: N 76-39-45.8 E
 Course In: S 24-18-14.0 E Course Out: N 02-22-14.5 W
 RP North: 1695767.377 East: 1684585.727
 End North: 1696295.925 East: 1684563.846

North: 1696249.495 East: 1684368.003

Line Course: N 02-22-14.5 W Length: 197.728

North: 1696493.483 East: 1684555.667

Line Course: N 81-34-35.8 W Length: 126.494

North: 1696512.013 East: 1684430.537

Line Course: S 13-23-54.7 W Length: 269.864

North: 1696249.494 East: 1684368.004

Perimeter: 796.591 Area: 35,240 sq.ft. 0.80 acres

Mapcheck Closure - (Uses listed courses and chords)

Error Closure: 0.001 Course: S 38-48-30.9 E
 North: -0.0006 East: 0.0004
 Precision 1: 795,357.000

Parcel name: Block 1, Lot 30

Line Course: N 02-22-14.5 W Length: 197.728

North: 1696295.924 East: 1684563.845

Line Course: N 89-05-35.6 E Length: 16.008

North: 1696493.483 East: 1684555.666

Line Course: N 89-05-35.6 E Length: 152.596

North: 1696493.737 East: 1684571.672

Line Course: S 03-48-08.8 W Length: 193.532

North: 1696496.152 East: 1684724.249

North: 1696303.046 East: 1684711.415

Curve Length: 41.784 Radius: 50.000
 Delta: 47-52-49.8 Tangent: 22.199
 Chord: 40.578 Course: S 69-51-43.9 W

Course In: S 03-48-08.8 W Course Out: N 44-04-41.0 W
 RP North: 1696253.156 East: 1684708.099
 End North: 1696289.075 East: 1684673.318
 Curve Length: 109.884 Radius: 529.000
 Delta: 11-54-05.2 Tangent: 55.140
 Chord: 109.686 Course: N 86-25-11.9 W
 Course In: S 09-31-50.7 W Course Out: N 02-22-14.5 W
 RP North: 1695767.377 East: 1684585.727
 End North: 1696295.924 East: 1684563.846

Perimeter: 711.531 Area: 31,435 sq.ft. 0.72 acres

Mapcheck Closure - (Uses listed courses and chords)

Error Closure: 0.000 Course: S 85-26-15.7 E
 North: -0.0000 East: 0.0003
 Precision 1: 710,128,000.000

Parcel name: Block 1, Lot 31

Line Course: S 89-05-35.6 W Length: 184.994	North: 1696256.875 East: 1684943.064
Curve Length: 74.430 Radius: 50.000	North: 1696253.947 East: 1684758.093
Delta: 85-17-26.8 Tangent: 46.051	
Chord: 67.746 Course: N 43-33-07.8 W	
Course In: S 89-05-35.6 W Course Out: N 03-48-08.8 E	
RP North: 1696253.156 East: 1684708.099	
End North: 1696303.046 East: 1684711.415	
Line Course: N 03-48-08.8 E Length: 193.532	North: 1696496.152 East: 1684724.249
Line Course: N 89-05-35.6 E Length: 27.404	North: 1696496.585 East: 1684751.650
Line Course: N 89-05-35.6 E Length: 187.596	North: 1696499.554 East: 1684939.222
Line Course: S 00-54-24.4 E Length: 242.710	North: 1696256.875 East: 1684943.063

Perimeter: 910.666 Area: 52,748 sq.ft. 1.21 acres

Mapcheck Closure - (Uses listed courses and chords)

Error Closure: 0.000 Course: S 83-16-23.5 W
 North: -0.0000 East: -0.0004
 Precision 1: 903,982,000.000

Parcel name: Block 1, Lot 32

Line Course: N 87-04-27.4 E Length: 21.463	North: 1696038.788 East: 1684746.614
Line Course: N 87-04-27.4 E Length: 178.537	North: 1696039.883 East: 1684768.049
Line Course: N 00-54-24.4 W Length: 207.905	North: 1696048.996 East: 1684946.354
	North: 1696256.875 East: 1684943.064

Line Course: S 89-05-35.6 W Length: 184.994

North: 1696253.947 East: 1684758.093

Curve Length: 70.443 Radius: 50.000
 Delta: 80-43-16.3 Tangent: 42.494
 Chord: 64.760 Course: S 39-27-13.8 W
 Course In: S 89-05-35.6 W Course Out: S 10-11-08.1 E
 RP North: 1696253.156 East: 1684708.099
 End North: 1696203.944 East: 1684716.941
 Line Course: S 10-11-08.1 E Length: 167.801

North: 1696038.787 East: 1684746.614

Perimeter: 831.142 Area: 44,272 sq.ft. 1.01 acres

Mapcheck Closure - (Uses listed courses and chords)

Error Closure: 0.001 Course: S 43-18-08.6 W
 North: -0.0005 East: -0.0005
 Precision 1: 825,460.000

Parcel name: Block 1, Lot 33

North: 1696203.944 East: 1684716.941

Curve Length: 65.619 Radius: 50.000
 Delta: 75-11-39.3 Tangent: 38.501
 Chord: 61.011 Course: N 62-35-18.4 W
 Course In: N 10-11-08.1 W Course Out: S 65-00-31.2 W
 RP North: 1696253.156 East: 1684708.099
 End North: 1696232.032 East: 1684662.780
 Curve Length: 102.350 Radius: 471.000
 Delta: 12-27-02.3 Tangent: 51.378
 Chord: 102.149 Course: N 86-48-34.8 W
 Course In: S 09-24-56.3 W Course Out: N 03-02-06.0 W
 RP North: 1695767.377 East: 1684585.727
 End North: 1696237.717 East: 1684560.790

Line Course: S 03-02-06.0 E Length: 208.155

North: 1696029.854 East: 1684571.811

Line Course: N 87-04-27.4 E Length: 61.495

North: 1696032.993 East: 1684633.225

Line Course: N 87-04-27.4 E Length: 113.537

North: 1696038.788 East: 1684746.614

Line Course: N 10-11-08.1 W Length: 167.801

North: 1696203.944 East: 1684716.941

Perimeter: 718.957 Area: 31,646 sq.ft. 0.72 acres

Mapcheck Closure - (Uses listed courses and chords)

Error Closure: 0.000 Course: N 20-59-20.8 W
 North: 0.0004 East: -0.0001
 Precision 1: 714,148,000.000

Parcel name: Block 1, Lot 34

North: 1696020.666 East: 1684392.045

Curve Length: 64.279 Radius: 629.000

Delta: 5-51-18.7 Tangent: 32.167
 Chord: 64.251 Course: N 06-38-53.3 E
 Course In: N 80-25-27.4 W Course Out: S 86-16-46.1 E
 RP North: 1696125.301 East: 1683771.809
 End North: 1696084.485 East: 1684399.484
 Line Course: N 03-43-13.9 E Length: 36.792

North: 1696121.200 East: 1684401.871

Curve Length: 76.828 Radius: 209.000
 Delta: 21-03-43.0 Tangent: 38.853
 Chord: 76.397 Course: N 06-48-37.6 W
 Course In: N 86-16-46.1 W Course Out: N 72-39-30.9 E
 RP North: 1696134.762 East: 1684193.312
 End North: 1696197.058 East: 1684392.812

Curve Length: 173.814 Radius: 471.000
 Delta: 21-08-38.1 Tangent: 87.907
 Chord: 172.829 Course: N 76-23-35.0 E
 Course In: S 24-10-44.1 E Course Out: N 03-02-06.0 W
 RP North: 1695767.378 East: 1684585.727
 End North: 1696237.717 East: 1684560.790

Line Course: S 03-02-06.0 E Length: 208.155

North: 1696029.854 East: 1684571.811

Line Course: S 87-04-27.4 W Length: 73.505

North: 1696026.103 East: 1684498.402

Line Course: S 87-04-27.4 W Length: 106.495

North: 1696020.667 East: 1684392.045

Perimeter: 739.867 Area: 33,352 sq.ft. 0.76 acres

Mapcheck Closure - (Uses listed courses and chords)

Error Closure: 0.001 Course: N 04-44-49.0 E
 North: 0.0006 East: 0.0001
 Precision 1: 738,424.000

Parcel name: Block 1, Lot 35

North: 1696020.666 East: 1684392.045

Curve Length: 166.534 Radius: 629.000
 Delta: 15-10-10.5 Tangent: 83.757
 Chord: 166.047 Course: S 17-09-37.8 W
 Course In: N 80-25-27.4 W Course Out: S 65-15-16.9 E
 RP North: 1696125.301 East: 1683771.809
 End North: 1695862.011 East: 1684343.053

Curve Length: 58.441 Radius: 319.000
 Delta: 10-29-48.1 Tangent: 29.303
 Chord: 58.360 Course: S 29-59-37.1 W
 Course In: N 65-15-16.9 W Course Out: S 54-45-28.8 E
 RP North: 1695995.540 East: 1684053.345
 End North: 1695811.467 East: 1684313.879

Line Course: S 49-32-31.5 E Length: 19.371

North: 1695798.897 East: 1684328.618

Curve Length: 136.239 Radius: 121.000
 Delta: 64-30-42.5 Tangent: 76.363
 Chord: 129.156 Course: S 81-47-52.8 E

Course In: N 40-27-28.5 E Course Out: S 24-03-14.0 E
 RP North: 1695890.964 East: 1684407.134
 End North: 1695780.471 East: 1684456.453
 Curve Length: 57.059 Radius: 429.000
 Delta: 7-37-14.2 Tangent: 28.572
 Chord: 57.017 Course: N 69-45-23.1 E
 Course In: S 24-03-14.0 E Course Out: N 16-25-59.8 W
 RP North: 1695388.725 East: 1684631.311
 End North: 1695800.200 East: 1684509.948
 Line Course: N 02-55-32.6 W Length: 226.197

North: 1696026.102 East: 1684498.402

Line Course: S 87-04-27.4 W Length: 106.495

North: 1696020.666 East: 1684392.046

Perimeter: 770.335 Area: 35,756 sq.ft. 0.82 acres

Mapcheck Closure - (Uses listed courses and chords)

Error Closure: 0.001 Course: N 78-24-03.3 E
 North: 0.0002 East: 0.0010
 Precision 1: 762,643.000

Parcel name: Block 1, Lot 36

Line Course: S 02-55-32.6 E Length: 215.744
 Curve Length: 135.973 Radius: 429.000
 Delta: 18-09-36.1 Tangent: 68.561
 Chord: 135.404 Course: S 82-38-48.2 W
 Course In: S 01-43-36.3 W Course Out: N 16-25-59.8 W
 RP North: 1695388.725 East: 1684631.311
 End North: 1695800.200 East: 1684509.947
 Line Course: N 02-55-32.6 W Length: 226.197

North: 1696032.993 East: 1684633.226

North: 1695817.530 East: 1684644.238

North: 1696026.102 East: 1684498.402

Line Course: N 87-04-27.4 E Length: 73.505

North: 1696029.854 East: 1684571.811

Line Course: N 87-04-27.4 E Length: 61.495

North: 1696032.993 East: 1684633.226

Perimeter: 712.913 Area: 29,345 sq.ft. 0.67 acres

Mapcheck Closure - (Uses listed courses and chords)

Error Closure: 0.000 Course: N 80-30-12.5 E
 North: 0.0000 East: 0.0001
 Precision 1: 712,345,000.000

Parcel name: Block 1, Lot 37

Curve Length: 40.072 Radius: 429.000
 Delta: 5-21-06.9 Tangent: 20.051
 Chord: 40.058 Course: S 85-35-50.3 E
 Course In: S 01-43-36.3 W Course Out: N 07-04-43.2 E

North: 1695817.530 East: 1684644.238

RP North: 1695388.725 East: 1684631.311
 End North: 1695814.455 East: 1684684.177
 Line Course: S 82-55-16.8 E Length: 78.854

North: 1695804.738 East: 1684762.430

Curve Length: 30.096 Radius: 50.000
 Delta: 34-29-15.6 Tangent: 15.520
 Chord: 29.644 Course: N 33-31-45.9 E
 Course In: S 73-42-51.9 E Course Out: N 39-13-36.3 W
 RP North: 1695790.716 East: 1684810.424
 End North: 1695829.449 East: 1684778.805
 Line Course: N 02-55-32.6 W Length: 210.709

North: 1696039.883 East: 1684768.050

Line Course: S 87-04-27.4 W Length: 21.463

North: 1696038.788 East: 1684746.615

Line Course: S 87-04-27.4 W Length: 113.537

North: 1696032.993 East: 1684633.226

Line Course: S 02-55-32.6 E Length: 215.744

North: 1695817.530 East: 1684644.238

Perimeter: 710.476 Area: 30,219 sq.ft. 0.69 acres

Mapcheck Closure - (Uses listed courses and chords)

Error Closure: 0.000 Course: S 12-59-36.6 E
 North: -0.0001 East: 0.0000
 Precision 1: 710,009,000.000

Parcel name: Block 1, Lot 38

North: 1695829.449 East: 1684778.805

Curve Length: 114.942 Radius: 50.000
 Delta: 131-42-49.3 Tangent: 111.551
 Chord: 91.253 Course: S 63-22-11.7 E
 Course In: S 39-13-36.3 E Course Out: S 87-30-47.0 E
 RP North: 1695790.716 East: 1684810.424
 End North: 1695788.547 East: 1684860.377
 Line Course: S 87-30-47.0 E Length: 90.246

North: 1695784.631 East: 1684950.538

Line Course: N 00-54-24.4 W Length: 264.398

North: 1696048.995 East: 1684946.354

Line Course: S 87-04-27.4 W Length: 178.537

North: 1696039.883 East: 1684768.050

Line Course: S 02-55-32.6 E Length: 210.709

North: 1695829.448 East: 1684778.805

Perimeter: 858.832 Area: 41,159 sq.ft. 0.94 acres

Mapcheck Closure - (Uses listed courses and chords)

Error Closure: 0.000 Course: S 17-51-33.2 E
 North: -0.0003 East: 0.0001
 Precision 1: 835,143,000.000

Parcel name: Block 1, Lot 39

Line Course: N 79-25-29.4 E Length: 24.930 North: 1695506.395 East: 1684255.269
 Line Course: N 79-25-29.4 E Length: 25.169 North: 1695510.970 East: 1684279.775
 Line Course: N 42-07-23.3 E Length: 35.911 North: 1695515.589 East: 1684304.517
 Line Course: N 42-07-23.3 E Length: 79.980 North: 1695542.225 East: 1684328.603
 Line Course: N 42-07-23.3 E Length: 125.978 North: 1695601.546 East: 1684382.248
 Line Course: N 30-31-42.5 W Length: 26.705 North: 1695694.985 East: 1684466.745
 North: 1695717.988 East: 1684453.179

Curve Length: 172.965 Radius: 179.000
 Delta: 55-21-51.0 Tangent: 93.906
 Chord: 166.314 Course: N 77-13-27.0 W
 Course In: N 14-54-22.5 W Course Out: S 40-27-28.5 W
 RP North: 1695890.964 East: 1684407.134
 End North: 1695754.766 East: 1684290.983
 Line Course: N 49-32-31.5 W Length: 19.371

North: 1695767.336 East: 1684276.244

Curve Length: 121.902 Radius: 319.000
 Delta: 21-53-41.4 Tangent: 61.704
 Chord: 121.161 Course: S 56-37-16.4 W
 Course In: N 44-19-34.3 W Course Out: S 22-25-52.9 E
 RP North: 1695995.540 East: 1684053.345
 End North: 1695700.676 East: 1684175.068
 Line Course: S 22-25-52.9 E Length: 210.184

North: 1695506.395 East: 1684255.269

Perimeter: 843.094 Area: 39,969 sq.ft. 0.91 acres

Mapcheck Closure - (Uses listed courses and chords)

Error Closure: 0.001 Course: N 50-16-27.7 E
 North: 0.0006 East: 0.0007
 Precision 1: 835,703.000

Parcel name: Block 1, Lot 40

Line Course: N 79-25-29.4 E Length: 5.657 North: 1695468.370 East: 1684051.596
 Line Course: N 79-25-29.4 E Length: 80.000 North: 1695469.408 East: 1684057.157
 Line Course: N 79-25-29.4 E Length: 80.000 North: 1695484.090 East: 1684135.798
 Line Course: N 79-25-29.4 E Length: 41.535 North: 1695498.772 East: 1684214.439
 Line Course: N 22-25-52.9 W Length: 210.184 North: 1695506.395 East: 1684255.269
 North: 1695700.676 East: 1684175.067
 Curve Length: 90.977 Radius: 319.000
 Delta: 16-20-25.5 Tangent: 45.799
 Chord: 90.669 Course: S 75-44-19.8 W

Course In: N 22-25-52.9 W Course Out: S 06-05-27.4 E
 RP North: 1695995.539 East: 1684053.344
 End North: 1695678.340 East: 1684087.192
 Curve Length: 30.254 Radius: 229.000
 Delta: 7-34-10.8 Tangent: 15.149
 Chord: 30.233 Course: S 87-41-38.0 W
 Course In: N 06-05-27.4 W Course Out: S 01-28-43.4 W
 RP North: 1695906.047 East: 1684062.894
 End North: 1695677.124 East: 1684056.984
 Line Course: S 01-28-43.4 W Length: 208.824

North: 1695468.369 East: 1684051.595

Perimeter: 747.432 Area: 33,081 sq.ft. 0.75 acres

Mapcheck Closure - (Uses listed courses and chords)

Error Closure: 0.001 Course: S 41-44-24.1 W
 North: -0.0007 East: -0.0006
 Precision 1: 747,102.000

Parcel name: Block 1, Lot 41

Line Course: N 01-28-43.4 E Length: 208.824 North: 1695468.370 East: 1684051.596

Curve Length: 132.602 Radius: 229.000 North: 1695677.124 East: 1684056.985
 Delta: 33-10-37.0 Tangent: 68.218
 Chord: 130.757 Course: N 71-55-58.1 W

Course In: N 01-28-43.4 E Course Out: S 34-39-20.4 W
 RP North: 1695906.048 East: 1684062.894
 End North: 1695717.676 East: 1683932.675

Curve Length: 190.975 Radius: 221.000
 Delta: 49-30-41.4 Tangent: 101.909
 Chord: 185.088 Course: S 16-18-22.4 W
 Course In: S 48-56-16.9 E Course Out: S 81-33-01.7 W
 RP North: 1695572.507 East: 1684099.309
 End North: 1695540.033 East: 1683880.707

Curve Length: 103.129 Radius: 311.000
 Delta: 18-59-58.6 Tangent: 52.042
 Chord: 102.657 Course: S 17-56-57.6 E
 Course In: N 81-33-01.7 E Course Out: S 62-33-03.1 W
 RP North: 1695585.731 East: 1684188.332
 End North: 1695442.373 East: 1683912.344

Line Course: N 79-25-29.4 E Length: 34.189

North: 1695448.647 East: 1683945.952

Line Course: N 79-25-29.4 E Length: 107.469

North: 1695468.371 East: 1684051.596

Perimeter: 777.187 Area: 39,323 sq.ft. 0.90 acres

Mapcheck Closure - (Uses listed courses and chords)

Error Closure: 0.001 Course: N 02-49-23.0 E
 North: 0.0008 East: 0.0000
 Precision 1: 768,984.000

Parcel name: Block 1, Lot 42

Line Course: S 76-50-12.6 W Length: 34.726	North: 1695338.478 East: 1684079.426
Line Course: S 85-20-12.6 W Length: 43.232	North: 1695330.570 East: 1684045.612
Line Course: N 24-57-01.8 W Length: 134.107	North: 1695327.055 East: 1684002.523
Line Course: N 79-25-29.4 E Length: 107.469	North: 1695448.647 East: 1683945.952
Line Course: N 79-25-29.4 E Length: 5.657	North: 1695468.370 East: 1684051.596
Line Course: S 09-39-09.7 E Length: 132.810	North: 1695469.408 East: 1684057.157
	North: 1695338.478 East: 1684079.426

Perimeter: 458.001 Area: 12,620 sq.ft. 0.28 acres

Mapcheck Closure - (Uses listed courses and chords)

Error Closure: 0.000 Course: N 01-18-04.8 E
 North: 0.0003 East: 0.0000
 Precision 1: 458,001,000.000

Parcel name: Block 1, Lot 43

Curve Length: 82.392 Radius: 416.000	North: 1695338.478 East: 1684079.426
Delta: 11-20-52.3 Tangent: 41.331	
Chord: 82.257 Course: N 82-30-38.8 E	
Course In: S 13-09-47.4 E Course Out: N 01-48-55.1 W	
RP North: 1694933.408 East: 1684174.159	
End North: 1695349.199 East: 1684160.981	
Line Course: N 10-34-30.6 W Length: 137.221	North: 1695484.090 East: 1684135.798
Line Course: S 79-25-29.4 W Length: 80.000	North: 1695469.408 East: 1684057.156
Line Course: S 09-39-09.7 E Length: 132.810	North: 1695338.478 East: 1684079.425

Perimeter: 432.424 Area: 10,835 sq.ft. 0.24 acres

Mapcheck Closure - (Uses listed courses and chords)

Error Closure: 0.000 Course: S 79-36-38.9 W
 North: -0.0001 East: -0.0004
 Precision 1: 432,288,000.000

Parcel name: Block 1, Lot 44

Curve Length: 82.753 Radius: 416.000	North: 1695349.199 East: 1684160.982
Delta: 11-23-51.4 Tangent: 41.513	
Chord: 82.617 Course: S 86-06-59.4 E	

Course In: S 01-48-55.1 E Course Out: N 09-34-56.3 E
 RP North: 1694933.408 East: 1684174.160
 End North: 1695343.604 East: 1684243.409
 Line Course: N 10-34-30.6 W Length: 157.849

Line Course: S 79-25-29.4 W Length: 80.000 North: 1695498.772 East: 1684214.440
 Line Course: S 10-34-30.6 E Length: 137.221 North: 1695484.090 East: 1684135.798
 North: 1695349.200 East: 1684160.982

Perimeter: 457.824 Area: 11,689 sq.ft. 0.26 acres

Mapcheck Closure - (Uses listed courses and chords)

Error Closure: 0.000 Course: N 69-28-57.7 E
 North: 0.0001 East: 0.0003
 Precision 1: 457,687,000.000

Parcel name: Block 1, Lot 45

Line Course: N 10-34-30.6 W Length: 157.849 North: 1695343.604 East: 1684243.409
 Line Course: N 79-25-29.4 E Length: 41.535 North: 1695498.772 East: 1684214.439
 Line Course: N 79-25-29.4 E Length: 24.930 North: 1695506.395 East: 1684255.269
 Line Course: S 22-11-21.2 E Length: 168.808 North: 1695510.970 East: 1684279.775
 Curve Length: 102.031 Radius: 184.000 North: 1695354.664 East: 1684343.528
 Delta: 31-46-17.5 Tangent: 52.364
 Chord: 100.729 Course: S 83-41-47.5 W
 Course In: N 22-11-21.2 W Course Out: S 09-34-56.3 W
 RP North: 1695525.037 East: 1684274.038
 End North: 1695343.604 East: 1684243.408

Perimeter: 495.154 Area: 13,896 sq.ft. 0.31 acres

Mapcheck Closure - (Uses listed courses and chords)

Error Closure: 0.000 Course: N 38-32-49.0 W
 North: 0.0001 East: -0.0001
 Precision 1: 493,851,000.000

Parcel name: Block 1, Lot 46

Line Course: S 45-24-51.5 E Length: 150.423 North: 1695542.225 East: 1684328.603
 Line Course: S 31-51-22.0 W Length: 10.252 North: 1695436.631 East: 1684435.734
 Curve Length: 115.465 Radius: 184.000 North: 1695427.924 East: 1684430.323
 Delta: 35-57-16.8 Tangent: 59.705
 Chord: 113.580 Course: S 49-50-00.4 W
 Course In: N 58-08-38.0 W Course Out: S 22-11-21.2 E

RP North: 1695525.037 East: 1684274.038
 End North: 1695354.663 East: 1684343.529
 Line Course: N 22-11-21.2 W Length: 168.808

Line Course: N 79-25-29.4 E Length: 25.169

Line Course: N 42-07-23.3 E Length: 35.911

North: 1695510.970 East: 1684279.775

North: 1695515.589 East: 1684304.517

North: 1695542.224 East: 1684328.603

Perimeter: 506.028 Area: 14,660 sq.ft. 0.33 acres

Mapcheck Closure - (Uses listed courses and chords)

Error Closure: 0.001 Course: S 48-11-18.4 E

North: -0.0006 East: 0.0007

Precision 1: 504,143.000

Parcel name: Block 1, Lot 47

Line Course: S 45-24-51.5 E Length: 150.423

Line Course: N 31-51-22.0 E Length: 104.491

Line Course: N 54-57-59.3 W Length: 132.674

Line Course: S 42-07-23.3 W Length: 79.980

Perimeter: 467.569 Area: 12,930 sq.ft. 0.29 acres

Mapcheck Closure - (Uses listed courses and chords)

Error Closure: 0.000 Course: S 32-59-32.4 E

North: -0.0004 East: 0.0002

Precision 1: 467,568,000.000

Parcel name: Block 1, Lot 48

Line Course: N 54-57-59.3 W Length: 132.674

Line Course: N 42-07-23.3 E Length: 125.978

Line Course: S 30-31-42.5 E Length: 142.289

Curve Length: 67.959

Radius: 141.000

Delta: 27-36-55.5

Tangent: 34.653

Chord: 67.303

Course: S 45-39-49.7 W

Course In: S 30-31-42.5 E Course Out: N 58-08-38.0 W

RP North: 1695450.966 East: 1684610.646

End North: 1695525.385 East: 1684490.884

Perimeter: 468.900 Area: 12,759 sq.ft. 0.29 acres

North: 1695542.225 East: 1684328.603

North: 1695436.631 East: 1684435.734

North: 1695525.384 East: 1684490.883

North: 1695601.546 East: 1684382.248

North: 1695542.224 East: 1684328.603

North: 1695525.384 East: 1684490.883

North: 1695601.546 East: 1684382.248

North: 1695694.985 East: 1684466.744

North: 1695572.421 East: 1684539.023

Mapcheck Closure - (Uses listed courses and chords)

Error Closure: 0.001 Course: N 51-50-16.9 E
 North: 0.0005 East: 0.0006
 Precision 1: 468,244.000

Parcel name: Block 1, Lot 49

Line Course: S 30-31-42.5 E Length: 142.289 North: 1695694.985 East: 1684466.744
 North: 1695572.420 East: 1684539.022
 Curve Length: 65.245 Radius: 141.000
 Delta: 26-30-45.6 Tangent: 33.218
 Chord: 64.665 Course: N 72-43-40.3 E
 Course In: S 30-31-42.5 E Course Out: N 04-00-56.9 W
 RP North: 1695450.966 East: 1684610.645
 End North: 1695591.620 East: 1684600.771
 Line Course: N 04-00-56.9 W Length: 147.251
 North: 1695738.509 East: 1684590.459
 Line Course: S 70-37-02.7 W Length: 131.148
 North: 1695694.985 East: 1684466.744
 Perimeter: 485.933 Area: 13,626 sq.ft. 0.31 acres

Mapcheck Closure - (Uses listed courses and chords)

Error Closure: 0.000 Course: N 72-55-57.3 W
 North: 0.0001 East: -0.0002
 Precision 1: 485,353,000.000

Parcel name: Block 1, Lot 50

Line Course: S 00-54-24.4 E Length: 158.223 North: 1695735.074 East: 1684678.619
 North: 1695576.871 East: 1684681.123
 Curve Length: 25.048 Radius: 284.000
 Delta: 5-03-11.7 Tangent: 12.532
 Chord: 25.039 Course: N 73-16-17.6 W
 Course In: N 14-12-06.6 E Course Out: S 19-15-18.3 W
 RP North: 1695852.191 East: 1684750.799
 End North: 1695584.078 East: 1684657.144
 Curve Length: 57.268 Radius: 141.000
 Delta: 23-16-15.2 Tangent: 29.034
 Chord: 56.875 Course: N 82-22-49.3 W
 Course In: S 19-15-18.3 W Course Out: N 04-00-56.9 W
 RP North: 1695450.966 East: 1684610.646
 End North: 1695591.619 East: 1684600.771
 Line Course: N 04-00-56.9 W Length: 147.251
 North: 1695738.509 East: 1684590.459
 Line Course: S 87-46-07.0 E Length: 88.228
 North: 1695735.074 East: 1684678.620
 Perimeter: 476.016 Area: 12,576 sq.ft. 0.28 acres

Mapcheck Closure - (Uses listed courses and chords)

Error Closure: 0.001 Course: S 62-09-32.1 E
 North: -0.0004 East: 0.0007
 Precision 1: 475,616.000

Parcel name: Block 1, Lot 51

North: 1695568.385 East: 1684761.268
 Curve Length: 80.865 Radius: 284.000
 Delta: 16-18-51.2 Tangent: 40.708
 Chord: 80.592 Course: N 83-57-19.0 W
 Course In: N 02-06-44.6 W Course Out: S 14-12-06.6 W
 RP North: 1695852.192 East: 1684750.800
 End North: 1695576.871 East: 1684681.124
 Line Course: N 00-54-24.4 W Length: 158.223
 North: 1695735.074 East: 1684678.620
 Line Course: S 87-46-07.0 E Length: 80.120
 North: 1695731.955 East: 1684758.679
 Line Course: S 00-54-24.4 E Length: 163.590
 North: 1695568.385 East: 1684761.268
 Perimeter: 482.798 Area: 13,027 sq.ft. 0.29 acres

Mapcheck Closure - (Uses listed courses and chords)

Error Closure: 0.001 Course: N 17-02-38.3 E
 North: 0.0009 East: 0.0003
 Precision 1: 482,525.000

Parcel name: Block 1, Lot 52

North: 1695572.029 East: 1684841.220
 Curve Length: 41.981 Radius: 116.000
 Delta: 20-44-07.8 Tangent: 21.223
 Chord: 41.752 Course: N 89-29-59.8 W
 Course In: S 10-52-04.1 W Course Out: N 09-52-03.7 W
 RP North: 1695458.109 East: 1684819.349
 End North: 1695572.393 East: 1684799.470
 Curve Length: 38.441 Radius: 284.000
 Delta: 7-45-19.1 Tangent: 19.250
 Chord: 38.412 Course: S 84-00-35.8 W
 Course In: N 09-52-03.7 W Course Out: S 02-06-44.6 E
 RP North: 1695852.192 East: 1684750.800
 End North: 1695568.384 East: 1684761.267
 Line Course: N 00-54-24.4 W Length: 163.590
 North: 1695731.954 East: 1684758.678
 Line Course: S 87-46-07.0 E Length: 80.120
 North: 1695728.835 East: 1684838.738
 Line Course: S 00-54-24.4 E Length: 156.826
 North: 1695572.028 East: 1684841.220
 Perimeter: 480.958 Area: 12,689 sq.ft. 0.29 acres

Mapcheck Closure - (Uses listed courses and chords)

Error Closure: 0.001 Course: S 45-47-58.2 W

North: -0.0005 East: -0.0005
Precision 1: 480,700.000

Parcel name: Block 1, Lot 53

Line Course: S 87-46-07.0 E Length: 127.861	North: 1695728.835 East: 1684838.738
Line Course: S 00-54-24.4 E Length: 183.943	North: 1695723.857 East: 1684966.502
Line Course: S 61-23-49.3 W Length: 54.924	North: 1695539.937 East: 1684969.413
Curve Length: 102.301 Radius: 116.000	North: 1695513.643 East: 1684921.192
Delta: 50-31-45.2 Tangent: 54.745	
Chord: 99.017 Course: N 53-52-03.3 W	
Course In: S 61-23-49.3 W Course Out: N 10-52-04.1 E	
RP North: 1695458.109 East: 1684819.349	
End North: 1695572.028 East: 1684841.221	
Line Course: N 00-54-24.4 W Length: 156.826	North: 1695728.835 East: 1684838.739

Perimeter: 625.854 Area: 23,472 sq.ft. 0.53 acres

Mapcheck Closure - (Uses listed courses and chords)

Error Closure: 0.001 Course: S 54-05-58.3 E
North: -0.0004 East: 0.0005
Precision 1: 622,571.000

Parcel name: Block 1, Lot 54

Line Course: S 00-54-24.4 E Length: 200.000	North: 1695359.377 East: 1684972.271
Line Course: S 88-53-46.3 W Length: 124.609	North: 1695159.402 East: 1684975.436
Line Course: N 01-06-13.7 W Length: 161.720	North: 1695157.002 East: 1684850.850
Curve Length: 101.679 Radius: 131.000	North: 1695318.692 East: 1684847.735
Delta: 44-28-17.4 Tangent: 53.555	
Chord: 99.146 Course: N 48-36-33.8 E	
Course In: N 19-09-17.5 W Course Out: S 63-37-34.9 E	
RP North: 1695442.439 East: 1684804.750	
End North: 1695384.246 East: 1684922.116	
Line Course: S 63-37-34.9 E Length: 55.982	North: 1695359.378 East: 1684972.271

Perimeter: 643.990 Area: 24,512 sq.ft. 0.56 acres

Mapcheck Closure - (Uses listed courses and chords)

Error Closure: 0.000 Course: N 44-49-11.6 E
North: 0.0003 East: 0.0003
Precision 1: 641,457,000.000

Parcel name: Block 1, Lot 55

Line Course: N 01-06-13.7 W Length: 161.720 North: 1695157.002 East: 1684850.850
 North: 1695318.692 East: 1684847.734
 Curve Length: 69.758 Radius: 131.000
 Delta: 30-30-37.4 Tangent: 35.727
 Chord: 68.937 Course: S 86-06-01.2 W
 Course In: N 19-09-17.5 W Course Out: S 11-21-19.9 W
 RP North: 1695442.439 East: 1684804.750
 End North: 1695314.004 East: 1684778.957
 Curve Length: 11.390 Radius: 584.000
 Delta: 1-07-02.9 Tangent: 5.695
 Chord: 11.390 Course: N 79-12-11.5 W
 Course In: S 11-21-19.9 W Course Out: N 10-14-17.0 E
 RP North: 1694741.436 East: 1684663.969
 End North: 1695316.137 East: 1684767.769
 Line Course: S 01-06-13.7 E Length: 160.706
 North: 1695155.461 East: 1684770.864
 Line Course: N 88-53-46.3 E Length: 80.000
 North: 1695157.002 East: 1684850.850
 Perimeter: 483.575 Area: 12,584 sq.ft. 0.28 acres

Mapcheck Closure - (Uses listed courses and chords)

Error Closure: 0.000 Course: N 34-41-42.1 W
 North: 0.0002 East: -0.0001
 Precision 1: 482,753,000.000

Parcel name: Block 1, Lot 56

Line Course: N 01-06-13.7 W Length: 171.070 North: 1695153.920 East: 1684690.879
 North: 1695324.958 East: 1684687.584
 Curve Length: 80.733 Radius: 584.000
 Delta: 7-55-14.2 Tangent: 40.431
 Chord: 80.669 Course: S 83-43-20.1 E
 Course In: S 02-19-02.8 W Course Out: N 10-14-17.0 E
 RP North: 1694741.436 East: 1684663.969
 End North: 1695316.137 East: 1684767.769
 Line Course: S 01-06-13.7 E Length: 160.706
 North: 1695155.461 East: 1684770.865
 Line Course: S 88-53-46.3 W Length: 80.000
 North: 1695153.920 East: 1684690.880
 Perimeter: 492.509 Area: 13,346 sq.ft. 0.30 acres

Mapcheck Closure - (Uses listed courses and chords)

Error Closure: 0.000 Course: S 83-48-37.3 E
 North: -0.0001 East: 0.0005
 Precision 1: 492,445,000.000

Parcel name: Block 1, Lot 57

Course In: S 13-58-50.7 E Course Out: N 15-43-41.0 W
 RP North: 1694741.436 East: 1684663.969
 End North: 1695303.570 East: 1684505.664
 Curve Length: 68.761 Radius: 116.000
 Delta: 33-57-47.0 Tangent: 35.424
 Chord: 67.759 Course: N 88-44-47.5 W
 Course In: N 15-43-41.0 W Course Out: S 18-14-06.0 W
 RP North: 1695415.227 East: 1684474.219
 End North: 1695305.053 East: 1684437.921
 Line Course: S 01-06-13.7 E Length: 155.978

North: 1695149.104 East: 1684440.926

Line Course: N 88-53-46.3 E Length: 85.000

North: 1695150.741 East: 1684525.910

Perimeter: 484.973 Area: 12,923 sq.ft. 0.29 acres

Mapcheck Closure - (Uses listed courses and chords)

Error Closure: 0.000 Course: S 57-24-19.0 W
 North: -0.0002 East: -0.0002
 Precision: 1: 483,970,000.000

Parcel name: Block 1, Lot 60

Line Course: N 01-06-13.7 W Length: 178.286
 Curve Length: 17.640 Radius: 216.000
 Delta: 4-40-45.3 Tangent: 8.825
 Chord: 17.636 Course: N 64-55-40.9 E
 Course In: N 22-43-56.5 W Course Out: S 27-24-41.8 E
 RP North: 1695525.037 East: 1684274.038
 End North: 1695333.289 East: 1684373.480
 Curve Length: 23.334 Radius: 19.000
 Delta: 70-21-59.4 Tangent: 13.395
 Chord: 21.895 Course: S 82-13-42.1 E
 Course In: S 27-24-41.8 E Course Out: N 42-57-17.6 E
 RP North: 1695316.422 East: 1684382.228
 End North: 1695330.328 East: 1684395.174
 Curve Length: 50.047 Radius: 116.000
 Delta: 24-43-11.6 Tangent: 25.419
 Chord: 49.660 Course: S 59-24-18.2 E
 Course In: N 42-57-17.6 E Course Out: S 18-14-06.0 W
 RP North: 1695415.227 East: 1684474.219
 End North: 1695305.053 East: 1684437.921
 Line Course: S 01-06-13.7 E Length: 155.978

North: 1695147.563 East: 1684360.941

North: 1695325.815 East: 1684357.506

North: 1695149.104 East: 1684440.926

Line Course: S 88-53-46.3 W Length: 80.000

North: 1695147.563 East: 1684360.941

Perimeter: 505.286 Area: 14,008 sq.ft. 0.32 acres

Mapcheck Closure - (Uses listed courses and chords)

Error Closure: 0.000 Course: N 20-19-27.1 W

North: 0.0001 East: -0.0001
 Precision 1: 503,455,000.000

Parcel name: Block 1, Lot 61

Line Course: N 01-06-13.7 W Length: 178.286 North: 1695147.563 East: 1684360.941
 North: 1695325.815 East: 1684357.506
 Curve Length: 81.923 Radius: 216.000
 Delta: 21-43-50.5 Tangent: 41.460
 Chord: 81.433 Course: S 78-07-58.8 W
 Course In: N 22-43-56.5 W Course Out: S 01-00-06.0 E
 RP North: 1695525.037 East: 1684274.038
 End North: 1695309.070 East: 1684277.814
 Line Course: S 01-06-13.7 E Length: 163.079
 North: 1695146.021 East: 1684280.955
 Line Course: N 88-53-46.3 E Length: 80.000
 North: 1695147.562 East: 1684360.940
 Perimeter: 503.287 Area: 13,443 sq.ft. 0.30 acres

Mapcheck Closure - (Uses listed courses and chords)

Error Closure: 0.001 Course: S 29-59-57.7 W
 North: -0.0006 East: -0.0004
 Precision 1: 502,798.000

Parcel name: Block 1, Lot 62

Line Course: S 88-53-46.3 W Length: 80.000 North: 1695146.021 East: 1684280.955
 North: 1695144.480 East: 1684200.970
 Line Course: N 01-06-13.7 W Length: 172.241
 North: 1695316.689 East: 1684197.652
 Curve Length: 40.714 Radius: 384.000
 Delta: 6-04-29.3 Tangent: 20.376
 Chord: 40.695 Course: S 83-27-18.4 E
 Course In: S 03-30-27.0 W Course Out: N 09-34-56.3 E
 RP North: 1694933.409 East: 1684174.159
 End North: 1695312.051 East: 1684238.082
 Curve Length: 39.901 Radius: 216.000
 Delta: 10-35-02.3 Tangent: 20.007
 Chord: 39.844 Course: S 85-42-34.9 E
 Course In: N 09-34-56.3 E Course Out: S 01-00-06.0 E
 RP North: 1695525.037 East: 1684274.038
 End North: 1695309.070 East: 1684277.814
 Line Course: S 01-06-13.7 E Length: 163.079
 North: 1695146.021 East: 1684280.956
 Perimeter: 495.933 Area: 13,371 sq.ft. 0.30 acres

Mapcheck Closure - (Uses listed courses and chords)

Error Closure: 0.000 Course: S 87-44-20.7 E
 North: -0.0000 East: 0.0005

Precision 1: 495,859,000.000

Parcel name: Block 1, Lot 63

Curve Length: 80.168 Radius: 384.000 North: 1695316.689 East: 1684197.652
 Delta: 11-57-42.3 Tangent: 40.230
 Chord: 80.023 Course: S 87-31-35.9 W
 Course In: S 03-30-27.0 W Course Out: N 08-27-15.3 W
 RP North: 1694933.408 East: 1684174.159
 End North: 1695313.236 East: 1684117.704
 Line Course: S 01-06-13.7 E Length: 170.328
 North: 1695142.939 East: 1684120.985
 Line Course: N 88-53-46.3 E Length: 80.000
 North: 1695144.480 East: 1684200.970
 Line Course: N 01-06-13.7 W Length: 172.241
 North: 1695316.689 East: 1684197.652

Perimeter: 502.737 Area: 13,814 sq.ft. 0.31 acres

Mapcheck Closure - (Uses listed courses and chords)

Error Closure: 0.000 Course: N 21-42-34.6 W
 North: 0.0004 East: -0.0001
 Precision 1: 502,592,000.000

Parcel name: Block 1, Lot 64

Curve Length: 31.559 Radius: 384.000 North: 1695313.236 East: 1684117.704
 Delta: 4-42-32.1 Tangent: 15.789
 Chord: 31.551 Course: S 79-11-28.6 W
 Course In: S 08-27-15.3 E Course Out: N 13-09-47.4 W
 RP North: 1694933.408 East: 1684174.159
 End North: 1695307.319 East: 1684086.713
 Line Course: S 76-50-12.6 W Length: 34.726
 North: 1695299.411 East: 1684052.899
 Line Course: S 68-20-12.6 W Length: 43.232
 North: 1695283.452 East: 1684012.721
 Line Course: S 06-42-36.4 E Length: 143.257
 North: 1695141.176 East: 1684029.460
 Line Course: N 88-53-46.3 E Length: 91.542
 North: 1695142.939 East: 1684120.985
 Line Course: N 01-06-13.7 W Length: 170.328
 North: 1695313.236 East: 1684117.703

Perimeter: 514.645 Area: 15,782 sq.ft. 0.36 acres

Mapcheck Closure - (Uses listed courses and chords)

Error Closure: 0.001 Course: N 58-09-16.3 W
 North: 0.0003 East: -0.0005
 Precision 1: 514,636.000

Parcel name: Block 2, Lot 1

Line Course: N 81-18-54.3 E Length: 214.487 North: 1695947.115 East: 1683882.170
 Line Course: N 13-23-54.7 E Length: 125.000 North: 1695979.502 East: 1684094.198
 Line Course: N 76-36-05.3 W Length: 231.540 North: 1696101.100 East: 1684123.163
 Curve Length: 209.407 Radius: 571.000 North: 1696154.753 East: 1683897.925
 Delta: 21-00-45.0 Tangent: 105.893
 Chord: 208.236 Course: S 04-20-21.1 W
 Course In: S 75-09-16.4 E Course Out: S 83-49-58.6 W
 RP North: 1696008.456 East: 1684449.865
 End North: 1695947.114 East: 1683882.170

Perimeter: 780.435 Area: 37,559 sq.ft. 0.86 acres

Mapcheck Closure - (Uses listed courses and chords)

Error Closure: 0.001 Course: S 21-20-15.5 W
 North: -0.0006 East: -0.0002
 Precision 1: 779,263.000

Parcel name: Block 2, Lot 2

Curve Length: 20.791 Radius: 571.000 North: 1696154.753 East: 1683897.925
 Delta: 2-05-10.6 Tangent: 10.397
 Chord: 20.790 Course: N 15-53-18.9 E
 Course In: S 75-09-16.4 E Course Out: N 73-04-05.8 W
 RP North: 1696008.456 East: 1684449.866
 End North: 1696174.749 East: 1683903.617
 Curve Length: 288.244 Radius: 191.000
 Delta: 86-28-00.5 Tangent: 179.571
 Chord: 261.659 Course: N 60-09-54.5 E
 Course In: S 73-04-05.8 E Course Out: N 13-23-54.7 E
 RP North: 1696119.124 East: 1684086.338
 End North: 1696304.925 East: 1684130.596
 Line Course: S 76-36-05.3 E Length: 40.000 North: 1696295.656 East: 1684169.508
 Line Course: S 13-23-54.7 W Length: 200.000 North: 1696101.099 East: 1684123.163
 Line Course: N 76-36-05.3 W Length: 231.540 North: 1696154.753 East: 1683897.925

Perimeter: 780.576 Area: 38,375 sq.ft. 0.88 acres

Mapcheck Closure - (Uses listed courses and chords)

Error Closure: 0.001 Course: S 10-22-05.0 W
 North: -0.0006 East: -0.0001
 Precision 1: 753,989.000

Parcel name: Block 2, Lot 3

North: 1696049.968 East: 1684337.818

Curve Length: 38.475 Radius: 571.000
 Delta: 3-51-38.6 Tangent: 19.245
 Chord: 38.468 Course: N 05-39-03.2 E
 Course In: N 82-25-07.5 W Course Out: S 86-16-46.1 E
 RP North: 1696125.301 East: 1683771.809
 End North: 1696088.249 East: 1684341.606
 Line Course: N 03-43-13.9 E Length: 36.792

North: 1696124.963 East: 1684343.993

Curve Length: 211.684 Radius: 151.000
 Delta: 80-19-19.2 Tangent: 127.429
 Chord: 194.771 Course: N 36-26-25.7 W
 Course In: N 86-16-46.1 W Course Out: N 13-23-54.7 E
 RP North: 1696134.762 East: 1684193.312
 End North: 1696281.652 East: 1684228.302
 Line Course: N 76-36-05.3 W Length: 60.439

North: 1696295.657 East: 1684169.508

Line Course: S 13-23-54.7 W Length: 200.000

North: 1696101.100 East: 1684123.163

Line Course: S 76-36-05.3 E Length: 220.661

North: 1696049.968 East: 1684337.818

Perimeter: 768.051 Area: 37,707 sq.ft. 0.86 acres

Mapcheck Closure - (Uses listed courses and chords)

Error Closure: 0.000 Course: N 33-23-54.6 E
 North: 0.0003 East: 0.0002
 Precision 1: 751,131,000.000

Parcel name: Block 2, Lot 4

Line Course: N 76-36-05.3 W Length: 220.661 North: 1696049.968 East: 1684337.818

Line Course: S 13-23-54.7 W Length: 125.000 North: 1696101.100 East: 1684123.163

Line Course: S 53-46-21.2 E Length: 218.326 North: 1695979.502 East: 1684094.198

Line Course: S 53-46-21.2 E Length: 218.326 North: 1695850.473 East: 1684270.316

Curve Length: 41.094 Radius: 261.000
 Delta: 9-01-16.1 Tangent: 20.590
 Chord: 41.052 Course: N 29-15-21.1 E
 Course In: N 56-14-00.8 W Course Out: S 65-15-16.9 E
 RP North: 1695995.539 East: 1684053.344
 End North: 1695886.289 East: 1684290.379

Curve Length: 171.054 Radius: 571.000
 Delta: 17-09-50.6 Tangent: 86.172
 Chord: 170.415 Course: N 16-09-47.8 E
 Course In: N 65-15-16.9 W Course Out: S 82-25-07.5 E
 RP North: 1696125.301 East: 1683771.810
 End North: 1696049.968 East: 1684337.818

Perimeter: 776.134 Area: 37,255 sq.ft. 0.85 acres

Mapcheck Closure - (Uses listed courses and chords)

Error Closure: 0.000 Course: N 67-20-57.7 E
 North: 0.0001 East: 0.0002
 Precision 1: 775,454,000.000

Parcel name: Block 3, Lot 1

Line Course: N 58-08-38.0 W Length: 118.814	North: 1695348.326 East: 1684558.421
Line Course: N 31-51-22.0 E Length: 114.743	North: 1695411.035 East: 1684457.503
Line Course: S 38-47-52.1 E Length: 148.937	North: 1695508.494 East: 1684518.063
Line Course: S 50-13-16.7 W Length: 68.915	North: 1695392.419 East: 1684611.383
	North: 1695348.325 East: 1684558.421

Perimeter: 451.409 Area: 11,947 sq.ft. 0.27 acres

Mapcheck Closure - (Uses listed courses and chords)

Error Closure: 0.001 Course: S 30-37-06.6 W
 North: -0.0007 East: -0.0004
 Precision 1: 451,409.000

Parcel name: Block 3, Lot 2

Line Course: N 00-01-05.6 W Length: 163.459	North: 1695392.428 East: 1684640.236
Curve Length: 140.526 Radius: 109.000	North: 1695555.887 East: 1684640.184
Delta: 73-52-03.3 Tangent: 81.940	
Chord: 130.994 Course: S 68-47-23.6 W	
Course In: S 15-43-25.3 W Course Out: N 58-08-38.0 W	
RP North: 1695450.966 East: 1684610.645	
End North: 1695508.495 East: 1684518.064	
Line Course: S 38-47-52.1 E Length: 148.937	North: 1695392.419 East: 1684611.384
Line Course: N 89-58-54.4 E Length: 28.853	North: 1695392.428 East: 1684640.237

Perimeter: 481.775 Area: 13,609 sq.ft. 0.31 acres

Mapcheck Closure - (Uses listed courses and chords)

Error Closure: 0.001 Course: N 77-15-29.3 E
 North: 0.0001 East: 0.0006
 Precision 1: 472,243.000

Parcel name: Block 3, Lot 3

Line Course: S 00-01-05.6 E Length: 145.224	North: 1695537.678 East: 1684720.190
Line Course: S 89-58-54.4 W Length: 80.000	North: 1695392.454 East: 1684720.236

Line Course: N 00-01-05.6 W Length: 163.459 North: 1695392.428 East: 1684640.236
 North: 1695555.887 East: 1684640.184

Curve Length: 6.718 Radius: 109.000
 Delta: 3-31-53.0 Tangent: 3.360
 Chord: 6.717 Course: S 72-30-38.2 E
 Course In: S 15-43-25.3 W Course Out: N 19-15-18.3 E
 RP North: 1695450.966 East: 1684610.645
 End North: 1695553.868 East: 1684646.591

Curve Length: 75.539 Radius: 316.000
 Delta: 13-41-47.0 Tangent: 37.950
 Chord: 75.359 Course: S 77-35-35.2 E
 Course In: N 19-15-18.3 E Course Out: S 05-33-31.3 W
 RP North: 1695852.191 East: 1684750.799
 End North: 1695537.677 East: 1684720.190

Perimeter: 470.940 Area: 12,211 sq.ft. 0.28 acres

Mapcheck Closure - (Uses listed courses and chords)

Error Closure: 0.000 Course: S 47-33-38.5 W
 North: -0.0002 East: -0.0002
 Precision 1: 470,759,000.000

Parcel name: Block 3, Lot 4

Curve Length: 80.251 Radius: 316.000 North: 1695540.075 East: 1684800.189
 Delta: 14-33-02.6 Tangent: 40.342
 Chord: 80.035 Course: S 88-17-00.0 W
 Course In: N 08-59-31.3 W Course Out: S 05-33-31.3 W
 RP North: 1695852.192 East: 1684750.799
 End North: 1695537.678 East: 1684720.190

Line Course: S 00-01-05.6 E Length: 145.224
 North: 1695392.454 East: 1684720.236

Line Course: N 89-58-54.4 E Length: 80.000
 North: 1695392.479 East: 1684800.236

Line Course: N 00-01-05.6 W Length: 147.596
 North: 1695540.075 East: 1684800.189

Perimeter: 453.070 Area: 11,576 sq.ft. 0.26 acres

Mapcheck Closure - (Uses listed courses and chords)

Error Closure: 0.000 Course: S 44-22-04.8 E
 North: -0.0002 East: 0.0002
 Precision 1: 452,855,000.000

Parcel name: Block 3, Lot 5

Line Course: N 00-01-05.6 W Length: 147.596 North: 1695392.479 East: 1684800.236
 North: 1695540.075 East: 1684800.189

Curve Length: 4.830 Radius: 316.000
 Delta: 0-52-32.4 Tangent: 2.415

Chord: 4.830 Course: N 80-34-12.5 E
 Course In: N 08-59-31.3 W Course Out: S 09-52-03.7 E
 RP North: 1695852.192 East: 1684750.799
 End North: 1695540.867 East: 1684804.954
 Curve Length: 144.236 Radius: 84.000
 Delta: 98-22-56.5 Tangent: 97.285
 Chord: 127.158 Course: S 50-40-35.4 E
 Course In: S 09-52-03.7 E Course Out: N 88-30-52.8 E
 RP North: 1695458.109 East: 1684819.349
 End North: 1695460.287 East: 1684903.321
 Line Course: S 01-29-07.2 E Length: 15.286

North: 1695445.006 East: 1684903.717

Curve Length: 119.761 Radius: 99.000
 Delta: 69-18-39.4 Tangent: 68.437
 Chord: 112.591 Course: S 33-10-12.5 W
 Course In: S 88-30-52.8 W Course Out: S 22-10-27.8 E
 RP North: 1695442.440 East: 1684804.750
 End North: 1695350.762 East: 1684842.116
 Line Course: N 45-06-38.0 W Length: 59.112

North: 1695392.479 East: 1684800.237

Perimeter: 490.821 Area: 15,810 sq.ft. 0.36 acres

Mapcheck Closure - (Uses listed courses and chords)

Error Closure: 0.000 Course: N 56-45-04.3 E
 North: 0.0002 East: 0.0003
 Precision 1: 466,573,000.000

Error Closure: 0.0000
 North: 0.0000 East: 0.0000
 Precision 1: 466,573,000.000