

STAFF REPORT
(Preliminary Plat)

CASE NUMBER: SUB 2007-16 -- RIVER WOOD ADDITION

OWNER/APPLICANT: JRD, LLC, P.O. Box 75337, Wichita, KS 67275

SURVEYOR/AGENT: Baughman Company, P.A., Attn: Phil Meyer, 315 Ellis, Wichita, KS 67211

LOCATION: North of 63rd St. South, West side of Clifton

SITE SIZE: 65 acres

NUMBER OF LOTS

Residential:	129
Office:	
Commercial:	
Industrial:	
Total:	<u>129</u>

MINIMUM LOT AREA: 10,800 square feet

CURRENT ZONING: SF-20, Single-Family Residential

PROPOSED ZONING: SF-5, Single-Family Residential

VICINITY MAP

REVISED

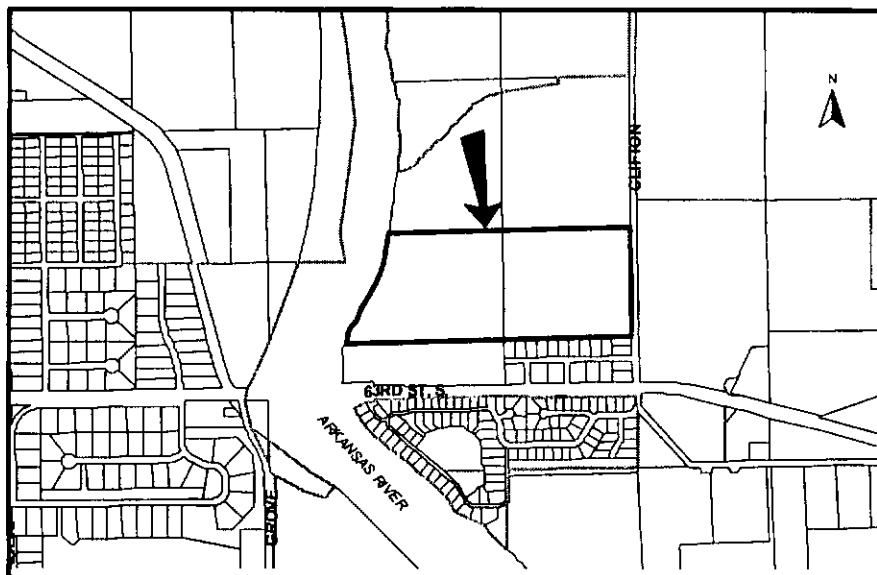

SUB 2007-16 -- Preliminary Plat of RIVER WOOD ADDITION
March 8, 2007 - Page 2

NOTE: This site is located in the County adjoining Wichita's city limits and annexation is required. The site is currently zoned SF-20, Single-Family Residential and will be converted to SF-5, Single-Family Residential upon annexation.

STAFF COMMENTS:

- A. Prior to this plat being scheduled for City Council review, annexation of the property will need to be completed. Upon annexation, the property will be zoned SF-5, Single-Family Residential and allow for the lot sizes being platted.
- B. The applicant shall guarantee the extension of City water and sanitary sewer to serve the lots being platted. Fees in lieu of assessment for the sewer main should be included in the sewer lateral petition.
- C. If improvements are guaranteed by petition, a notarized certificate listing the petitions shall be submitted to the Planning Department for recording.
- D. City/County Engineering needs to comment on the status of the applicant's drainage concept. County Engineering requests a drainage plan with a flood study. County Engineering recommends the drainage easement on Lots 1 through 16, Block C be incorporated into Reserve D.
- E. The plat's text shall include the language that the owners of the reserves shall bear the cost of any repair or replacement of improvements within the Reserves and resulting from street construction, repair, or maintenance.
- F. The plat proposes complete access control along the Clifton street frontage except for one street opening. As per Traffic Engineering, the access controls are approved.
- G. The Applicant shall guarantee the paving of the proposed streets. The guarantee shall also provide for sidewalks on at least one side of all through, non cul-de-sac streets.
- H. City Fire Department has requested a second point of access.
- I. In accordance with the KS Wetland Mapping Conventions under the Memorandum of Understanding between the USDA-NRCS; USEPA; USACE; and USF&WS, this site has been identified as one with potential wetland hydrology. The US Army Corps of Engineers (USACE) should be contacted (316-322-8247) to have a wetland determination completed.
- J. Since Reserve D includes a swimming pool, a site plan shall be submitted with the final plat, for review and approval by the Planning Director. The site plan shall include the information indicated in the Subdivision Regulations. The design for the pool must be submitted to Environmental Services for review prior to issuing a building permit for the pool.
- K. Provisions shall be made for ownership and maintenance of the proposed reserves. The applicant shall either form a lot owners' association prior to recording the plat or shall submit a covenant stating when the association will be formed, when the reserves will be deeded to the association and who is to own and maintain the reserves prior to the association taking over those responsibilities.

- L. For those reserves being platted for drainage purposes, the required covenant that provides for ownership and maintenance of the reserves, shall grant to the appropriate governing body the authority to maintain the drainage reserves in the event the owner(s) fail to do so. The covenant shall provide for the cost of such maintenance to be charged back to the owner(s) by the governing body.
- M. The applicant shall submit a covenant which provides for four (4) off-street parking spaces per dwelling unit on each lot which abuts a 58-foot street. The covenant shall inventory the affected lots by lot and block number and shall state that the covenant runs with the land and is binding on future owners and assigns.
- N. The site is located within the Maximum Mission Area of the Air Installation Compatible Use Zone (AICUZ) study to identify noise impact areas around McConnell Air Force Base. The applicant shall submit an avigational easement covering all of the subject plat and a restrictive covenant assuring that adequate construction methods will be used to minimize the effects of noise pollution in the habitable structures constructed on subject property.
- O. On the final plat, the MAPC signature block needs to reference the new Chair.
- P. Approval of this plat will require a waiver of the lot depth to width ratio of the Subdivision Regulations for various Lots in Block A and C. The Subdivision Regulations state that the maximum depth of all residential lots shall not exceed 2.5 times the width.
- Q. GIS has requested new street names.
- R. The Applicant is reminded that a platting binder is required with the final plat. Approval of this plat will be subject to submittal of this binder and any relevant conditions found by such a review.
- S. For any lots with existing tree rows that may be impacted by the installation of utilities, it is recommended that 30-foot utility easements be platted in order to allow for the installation of the utilities without damage to such tree rows.
- T. The platator's text shall include language that a drainage plan has been developed for the plat and that all drainage easements, rights-of-way, or reserves shall remain at established grades or as modified with the approval of the applicable City or County Engineer, and unobstructed to allow for the conveyance of stormwater.
- U. The applicant shall install or guarantee the installation of all utilities and facilities that are applicable and described in Article 8 of the MAPC Subdivision Regulations. (Water service and fire hydrants required by Article 8 for fire protection shall be as per the direction and approval of the Chief of the Fire Department.)
- V. The applicant's engineer is advised that the Register of Deeds is requiring the name(s) of the notary public, who acknowledges the signatures on this plat, to be printed beneath the notary's signature.
- W. To receive mail delivery without delay, and to avoid unnecessary expense, the applicant is advised of the necessity to meet with the U.S. Postal Service Growth Management Coordinator (Phone: 316-946-4556) prior to development of the plat so that the type of delivery, and the tentative mailbox locations can be determined.

- X. The applicant is advised that various State and Federal requirements (specifically but not limited to the Army Corps of Engineers, Kanopolis Project Office, Rt. 1, Box 317, Valley Center, KS 67147) for the control of soil and wind erosion and the protection of wetlands may impact how this site can be developed. It is the applicant's responsibility to contact all appropriate agencies to determine any such requirements.
- Y. The owner of the subdivision should note that any construction that results in earthwork activities that will disturb one (1) acre or more of ground cover requires a Federal/State NPDES Storm Water Discharge Permit from the Kansas Department of Health and Environment in Topeka. Also, for projects located within the City of Wichita, erosion and sediment control devices must be used on ALL projects. For projects outside of the City of Wichita, but within the Wichita Metropolitan area, the owner should contact the appropriate governmental jurisdiction concerning erosion and sediment control device requirements.
- Z. Perimeter closure computations shall be submitted with the final plat tracing.
- AA. The representatives from the utility companies should be prepared to comment on the need for any additional utility easements to be platted on this property.
- BB. A compact disc (CD), which will be used by the City and County GIS Departments, detailing the final plat in digital format in AutoCAD. If a disc is not provided, please send via e-mail to Cheryl Holloway (E-Mail address: cholloway@wichita.gov). Please include the name of the plat on the disc.

STAFF REPORT
(Final Plat, Preliminary Plat Approved 3/8/07)

CASE NUMBER: SUB 2007-16 -- RIVER WOOD ADDITION

OWNER/APPLICANT: JRD, LLC, P.O. Box 75337, Wichita, KS 67275

SURVEYOR/AGENT: Baughman Company, P.A., Attn: Phil Meyer, 315 Ellis, Wichita, KS 67211

LOCATION: North of 63rd St. South, West side of Clifton

SITE SIZE: 65 acres

NUMBER OF LOTS

Residential:	129
Office:	
Commercial:	
Industrial:	
Total:	129

MINIMUM LOT AREA: 10,800 square feet

CURRENT ZONING: SF-20, Single-Family Residential

PROPOSED ZONING: SF-5, Single-Family Residential

VICINITY MAP



DEFERRED INDEFINITELY