

**Amendment to Final Drainage Plan  
Fawn Grove at Sunset Lakes Addition  
February 11, 2004**

During the months of January and February 2004, a drainage study was conducted by PEC, Inc. on the tributary of Spring Creek passing through the plat of Fawn Grove at Sunset Lakes. This study was part of a basin study being performed by PEC in the area, the purpose of which was to identify areas within the basin that are a hindrance to storm water sewer flow.

The study concluded with the idea of bypassing 100-year storm water runoff (in excess of the capacity of the existing 2-10'x5' RCBC under the Kansas Turnpike) via a new 3-8'x3' RCBC to be someday routed along Gilbert Street, east to Greenwich Road, then under Greenwich Road heading south, and ultimately either draining into the south KTA ditch, then east in the ditch until such flow would cross under the Fawn Grove RCBC, or continue south along Greenwich Road and pass into the Fawn Grove Pond through a drainage easement.

On February 10, 2004, it was decided to utilize a 3-10x5' RCBC under Fawn Grove, west of Greenwich. This RCBC can pass the 100-year storm event from the entire drainage basin from the north. Future Greenwich Road Improvements will address the need for the bypass RCBC from Gilbert and the KTA box to a point of outfall in the Fawn Grove pond system.

The drainage plan and lot-grading plan have been revised to reflect these changes (dated 2-11-2004), and are included with this amendment.

# DRAINAGE PLAN FAWN GROVE AT SUNSET LAKES WICHITA, KANSAS



Scale: 1" = 100'

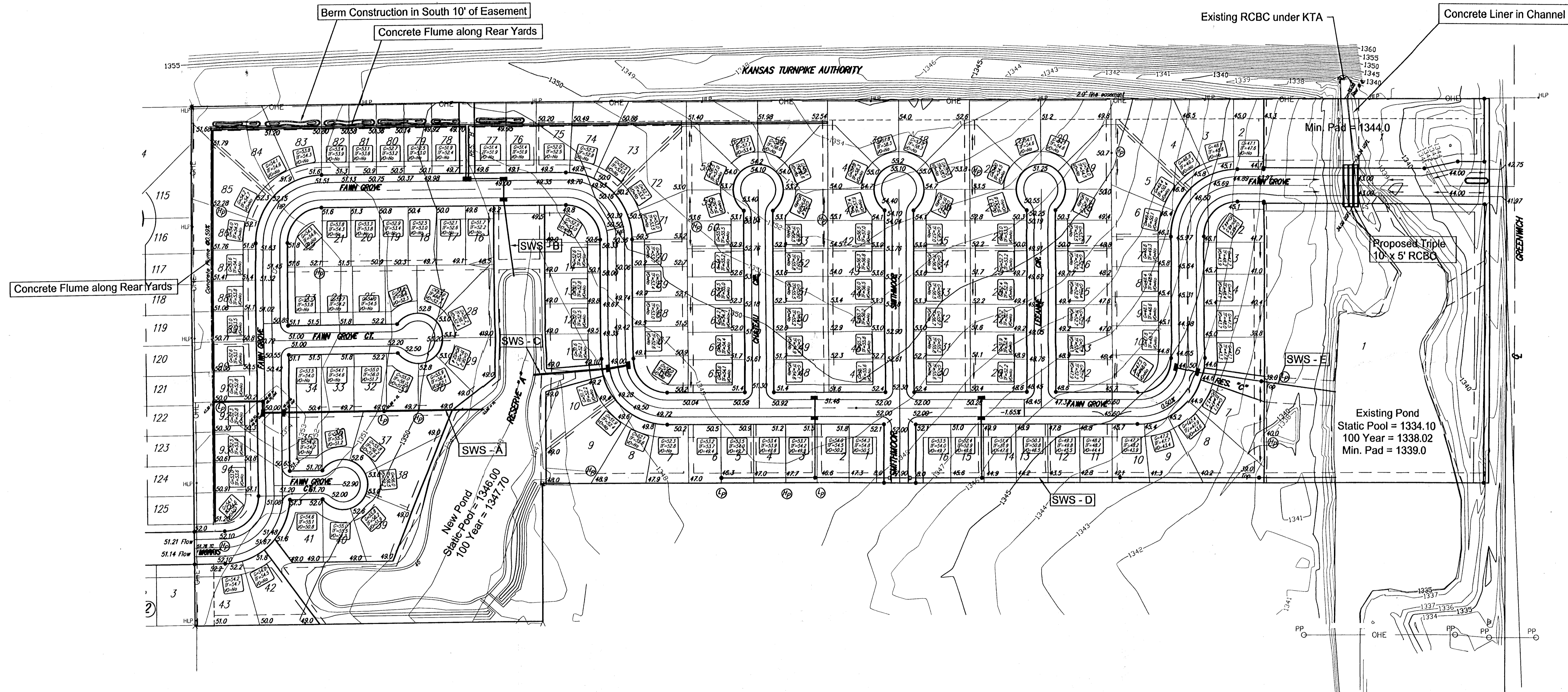

<b>DRAINAGE PLAN FAWN GROVE AT SUNSET LAKES WICHITA, KANSAS</b>			
	<b>Ruggles &amp; Bohm, P.A.</b> Engineering, Surveying, Land Planning		DESIGN CMB DRAWN CMB REVIEW CMB
	924 North Main Wichita, Kansas 67203 www.rbkansas.com		(316) 264-8008 (316) 264-4621 fax E-mail: info@rbkansas.com
DRAWING FILE	PROJECT NUMBER	DATE	SHEET 1 OF 1
base/site grading plan	2422P	02/10/04	

# LOT GRADING PLAN FAWN GROVE AT SUNSET LAKES WICHITA, KANSAS



Scale: 1" = 100'

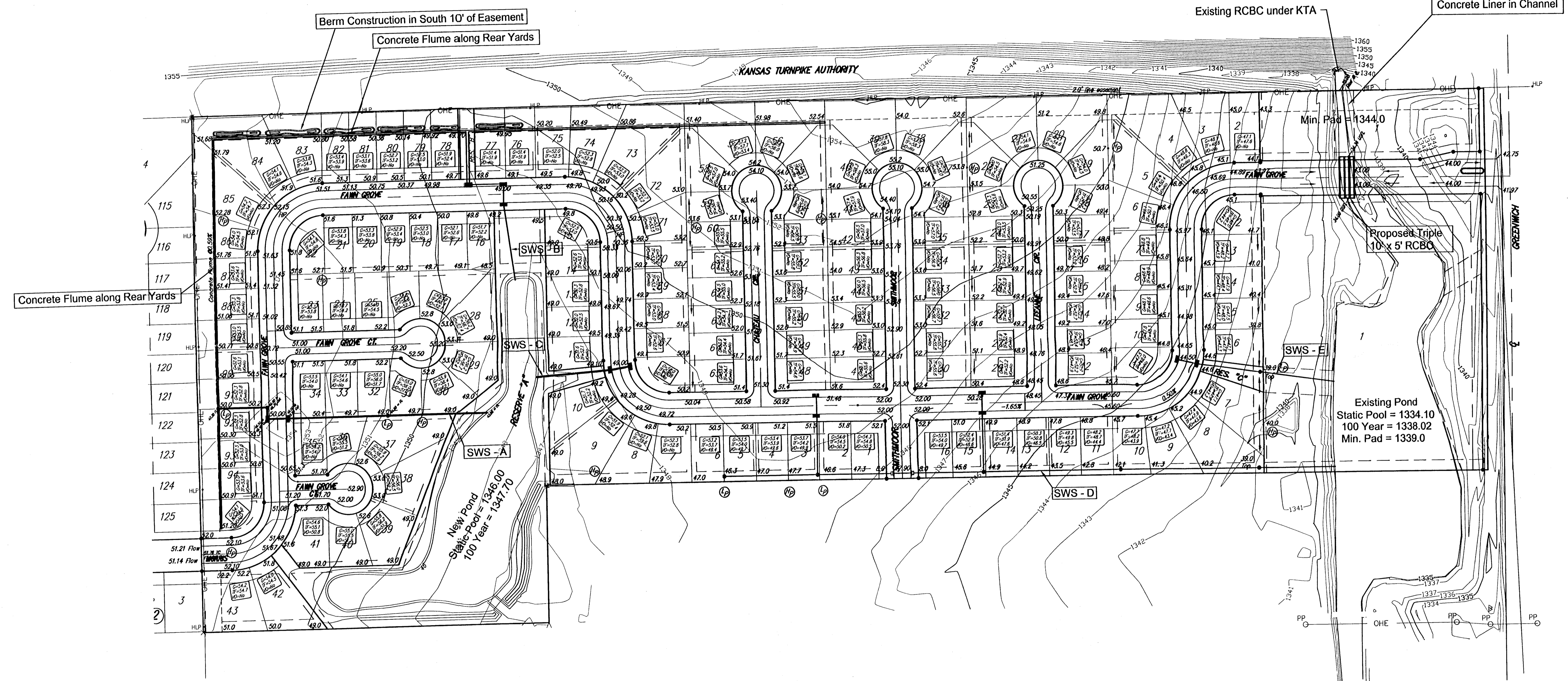

## LOT GRADING PLAN FAWN GROVE AT SUNSET LAKES WICHITA, KANSAS



**Ruggles & Bohm, P.A.**  
Engineering, Surveying, Land Planning  
924 North Main  
Wichita, Kansas 67203  
www.rbkansas.com

(316) 264-8008  
(316) 264-4621 fax  
E-mail: info@rbkansas.com

DRAWING FILE  
base/site grading plan

PROJECT NUMBER  
2422P

DATE  
02/11/04

DESIGN	CMB	SHEET 1 OF 1
DRAWN	CMB	
REVIEW		
UTILITY		