

STAFF REPORT
(One-Step Final Plat)

CASE NUMBER: SUB 2008-51 – FONTANA 4TH ADDITION

OWNER/APPLICANT: Socora Homes, Inc., 727 N. Waco, Suite 400, Wichita, KS 67203

SURVEYOR/AGENT: PEC, Attn: Rob Hartman, 303 S. Topeka, Wichita, KS 67202

LOCATION: North of 29th St. North, East side of 119th St. West (District V)

SITE SIZE: 69.5 acres

NUMBER OF LOTS

Residential:	131
Office:	
Commercial:	
Industrial:	
Total:	131

MINIMUM LOT AREA: 10,000 square feet

CURRENT ZONING: SF-5, Single-Family Residential

PROPOSED ZONING: Same

VICINITY MAP

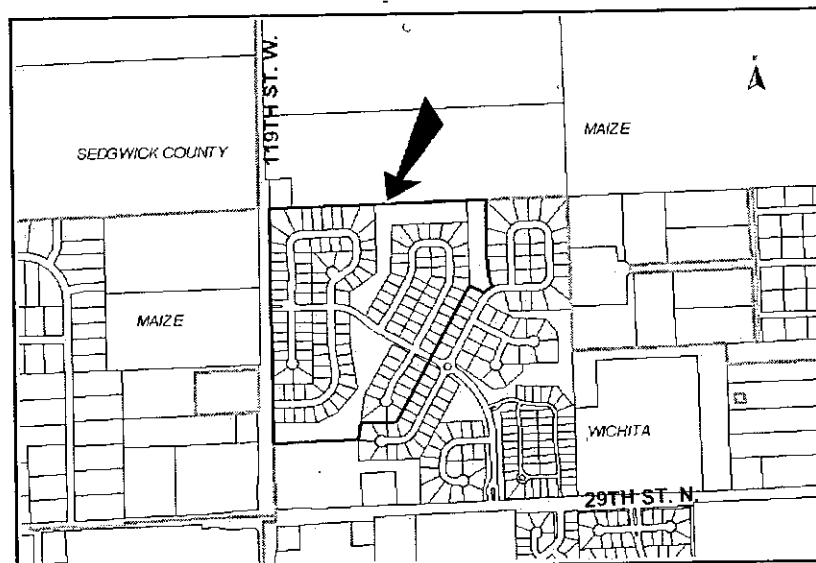

NOTE: This is a replat of portions of the Fontana and Fontana 2nd Additions. Reserve A has been expanded and a revised street layout is proposed for Block 1 west of Reserve A.

STAFF COMMENTS:

- A. City of Wichita Water Utilities Department requests the applicant extends water and sewer (mains and laterals) to serve all lots being platted.
- B. If improvements are guaranteed by petition(s), a notarized certificate listing the petition(s) shall be submitted to the Planning Department for recording.
- C. City Engineering needs to comment on the status of the applicant's drainage plan.
- D. The plat proposes two street openings along 119th St. West. The access controls need to be referenced in the plat's text.
- E. The Applicant shall guarantee the paving of the proposed streets. The guarantee shall also provide for sidewalks on at least one side of all through, non cul-de-sac streets.
- F. If any of the intended recreational uses for the reserves includes a swimming pool, "neighborhood swimming pool" shall be specified in the plat's text and a site plan shall be submitted with the final plat, for review and approval by the Planning Director. The site plan shall include the information indicated in the Subdivision Regulations. If there is a swimming pool to be built, the design for the pool must be submitted to Environmental Services for review prior to issuing a building permit for the pool.
- G. Provisions shall be made for ownership and maintenance of the proposed reserves. The applicant shall either form a lot owners' association prior to recording the plat or shall submit a covenant stating when the association will be formed, when the reserves will be deeded to the association and who is to own and maintain the reserves prior to the association taking over those responsibilities.
- H. For those reserves being platted for drainage purposes, the required covenant that provides for ownership and maintenance of the reserves, shall grant to the appropriate governing body the authority to maintain the drainage reserves in the event the owner(s) fail to do so. The covenant shall provide for the cost of such maintenance to be charged back to the owner(s) by the governing body.
- I. The applicant shall submit a covenant that provides four (4) off-street parking spaces per lot that abuts a 58-foot street. The covenant shall inventory the affected lots by lot and block number and shall state that the covenant runs with the land and is binding on future owners and assigns.
- J. County Surveying requests section corner monument descriptions.
- K. GIS has requested "West Lakes" be replaced with "Westlakes". "Chambers Circle" should be "Chambers Cir".
- L. The Applicant is reminded that a platting binder is required with the final plat. Approval of this plat will be subject to submittal of this binder and any relevant conditions found by such a review.
- M. The plat's text shall include language that a drainage plan has been developed for the plat and that all drainage easements, rights-of-way, or reserves shall remain at established grades or as modified with the approval of the applicable City or County Engineer, and unobstructed to allow for the conveyance of stormwater.
- N. The applicant shall install or guarantee the installation of all utilities and facilities that are applicable and described in Article 8 of the MAPC Subdivision Regulations. (Water service and fire hydrants required by Article 8 for fire protection shall be as per the direction and approval of the Chief of the Fire Department.)
- O. The Register of Deeds requires all names to be printed beneath the signatures on the plat and any associated documents.
- P. To receive mail delivery without delay, and to avoid unnecessary expense, the applicant is advised of the necessity to meet with the United States Postal Service Growth Management Coordinator (Phone: 316-946-4556) prior to development of the plat so that the type of delivery, and the tentative mailbox locations can be determined.

SUB 2008-51 – One-Step Final Plat of FONTANA 4TH ADDITION
July 17, 2008 - Page 3

- Q. The applicant is advised that various State and Federal requirements (specifically but not limited to the Army Corps of Engineers, Kanopolis Project Office, Rt. 1, Box 317, Valley Center, KS 67147) for the control of soil and wind erosion and the protection of wetlands may impact how this site can be developed. It is the applicant's responsibility to contact all appropriate agencies to determine any such requirements.
- R. The owner of the subdivision should note that any construction that results in earthwork activities that will disturb one (1) acre or more of ground cover requires a Federal/State National Pollutant Discharge Elimination System Storm Water Discharge Permit from the Kansas Department of Health and Environment in Topeka. Also, for projects located within the City of Wichita, erosion and sediment control devices must be used on ALL projects. For projects outside of the City of Wichita, but within the Wichita Metropolitan area, the owner should contact the appropriate governmental jurisdiction concerning erosion and sediment control device requirements.
- S. Perimeter closure computations shall be submitted with the final plat tracing.
- T. The representatives from the utility companies should be prepared to comment on the need for any additional utility easements to be platted on this property.
- U. A compact disc (CD), which will be used by the City and County GIS Departments, detailing the final plat in digital format in AutoCAD. If a disc is not provided, please send via e-mail to Cheryl Holloway (E-Mail address: cholloway@wichita.gov). Please include the name of the plat on the disc.

