

**DRAINAGE PLAN OF
"REDDI ADDITION"**
WICHITA, SEDGWICK COUNTY, KANSAS
IN THE NW 1/4 OF SECTION 22, T27S, R2E OF THE 6TH P.M.

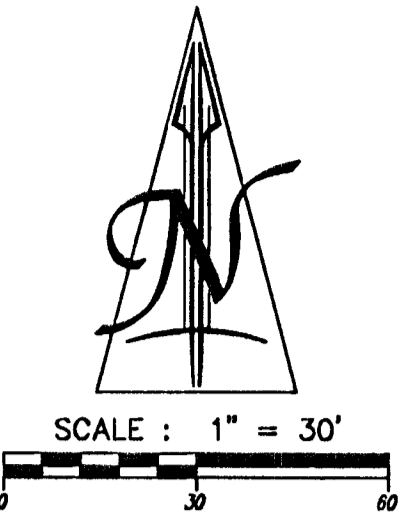

DRAINAGE DATA
Area=0.1 acres
SCS Soil Type D
Irwin Silty Clay Loam
C = 0.87
Tc = 15 min.
S = 4.62"/hr.
Q 5 = 0.4cfs

DRAINAGE DATA
Area=1.8 acres
SCS Soil Type D
Irwin Silty Clay Loam
C = 0.54
Tc = 15 min.
S = 4.62"/hr.
Q 5 = 4.5 cfs

DRAINAGE DATA
Area=0.2 acres
SCS Soil Type D
Irwin Silty Clay Loam
C = 0.90
Tc = 15 min.
S = 4.62"/hr.
Q 5 = 0.8 cfs

- LEGEND:**
- ▲ = Section Corner Found
 - = PK in Fence Post Found
 - = Iron Pipe Found
 - = #5 Rebar Found
 - ◇ = Street Sign
 - ⊕ = Fire Hydrant
 - ⊗ = Water Valve
 - (C) = Calculated
 - (M) = Measured
- Bearing Basis Assumed
Contour Interval = One Foot
File #2001041
Date of Topography : March 22, 2001
Date of Preparation : April 9, 2001
◁ = Proposed Drainage Flow Direction

BENCH MARK:
600 Step in North Brace Post, Near Southwest Corner of Lot 9, "Glider's Gardens" Elevation 180.68 City Datum

EXISTING ZONING:
"SF-6" For Subject Property and Surrounding Properties (Single Family)

OWNER/SUBDIVIDER:
Plaza Central Office Park, Inc.
6100 E. Central Ave., Suite 215
Wichita, Kansas 67208-4237
(316) 285-2555

There are no buildings on subject property.

SURVEY DISCLAIMER:
TOPOGRAPHIC SURVEY AND CONTOUR MAP USED IN PREPARING PLANS WAS PROVIDED BY TERRA TECH LAND SURVEYING, 22200 W. 63rd ST., VIOLA, KS (316)794-2883. ENGINEER DOES NOT GUARANTEE SURVEY ELEVATIONS FOR ACCURACY. CONTRACTOR SHALL VERIFY ELEVATIONS AND NOTIFY ENGINEER OF ANY DISCREPANCIES.

DRAINAGE PLAN PREPARED BY:
CERTIFIED ENGINEERING DESIGN, P.A.
810 WEST DOUGLAS, SUITE C SHEET 1
WICHITA, KANSAS 67203 TOTAL 1
PH: (316) 262-8808
FAX: (316) 262-1669

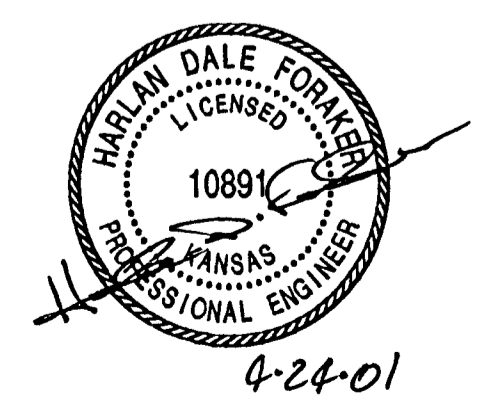

FLOOD ZONE MAP

Sec. 22, T27S, R2E

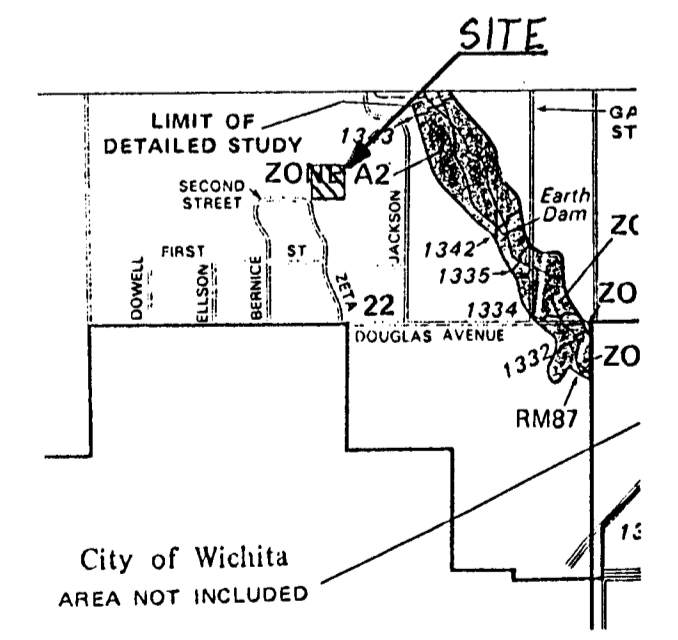

SCALE : 1" = 2,000'

FLOOD ZONE:
Subject property is in Zone C, as shown of Federal Emergency Management Agency (FEMA) Flood Insurance Rate Map (FIRM) for Sedgwick County, Kansas, Community Panel Number 200321 0225 A, effective June 3, 1986.

**LEGAL DESCRIPTION FOR
"REDDI ADDITION"**

The South 330 feet of the East 10 acres of the North Half of the Northeast Quarter of Section 22, Township 27 South, Range 2 East of the Sixth Principal Meridian, Sedgwick County, Kansas.

**VICINITY MAP OF
"REDDI ADDITION"**

Sec. 22, T27S, R2E

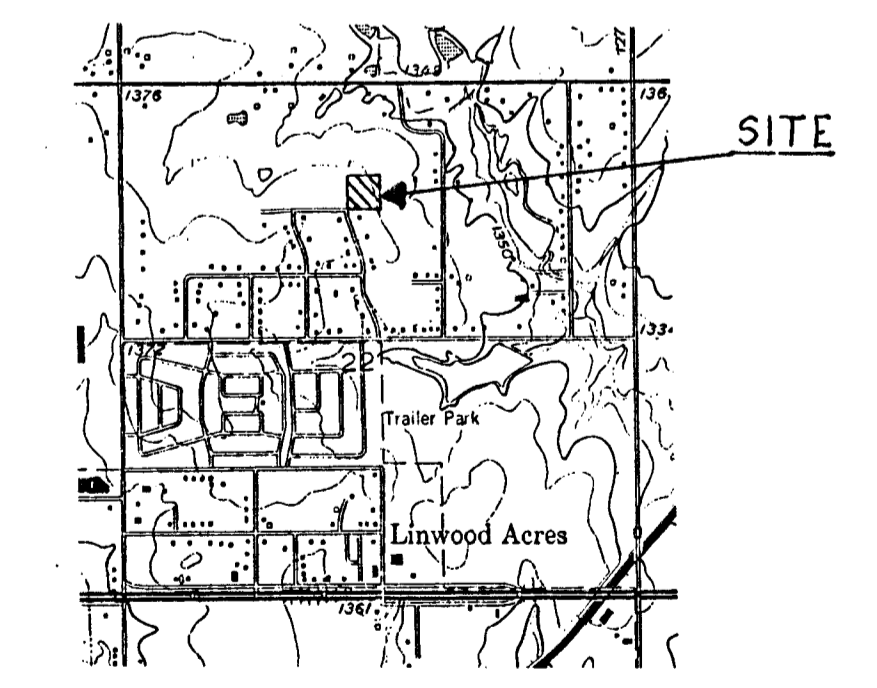

ANDOVER QUADRANGLE
7.5 Minute Series

SCALE : 1" = 2,000'

TERRA TECH
LAND SURVEYING / INC.
22200 W. 63rd St. S.
Viola, Kansas 67149
(316) 794-2883 794-3273
Fax: (316) 794-3274