

NE. Cor. SW. ¼, Sec. 2,
T27S, R2E, 6th P.M.
Fnd. ¾" Solid Bar over stone

UNPLATTED
YOUNG BROTHERS FARM L.C.
2726 N. 127th St. E.
WICHITA, KS 67226
N88°34'53" 2595.30'

UNPLATTED
YOUNG BROTHERS FARM L.C.
2850 N. 127th St. E.
WICHITA, KS 67226

NOTES

- ZONING: Existing Single Family "SF-20"
Proposed Single Family "SF-5"
- RESERVES platted for:
 - "A," "B," "D," monuments, landscaping, irrigation, and open space.
 - "E," "F," "K," "L," "M"
 - "A," & "B" - drainage in designated locations
 - "C," "J," lakes, floodway, and drainage in designated locations, club house, pool, playground, sidewalks, landscaping, irrigation, berms, monuments, and open space.
 - "H" - drainage, sidewalks, landscaping, irrigation, berms, monuments, and open space.
 - Reserve "N" & "O" - private streets, drainage, utilities, monuments and open space.
- Lot minimum pad elevations as indicated on the DRAINAGE PLAN, provided at the time of FINAL PLATTING.

BENCHMARK

- BM#1 60" in SOUTH LEG OF "H" POLE
HIGH LINE STRUCTURE, 75' NORTH &
80' EAST OF C 127TH STREET & CENTERLINE
BURLINGTON NORTHERN RAILROAD.
ELEV. = 1365.37'
- BM#2 Top of iron at SW. Cor. SW. ¼, Sec. 2, T27S,
R2E, (127th St. E. & 21st St. N.).
ELEV. = 198.01 (CITY DATUM)
1385.41 NGVD

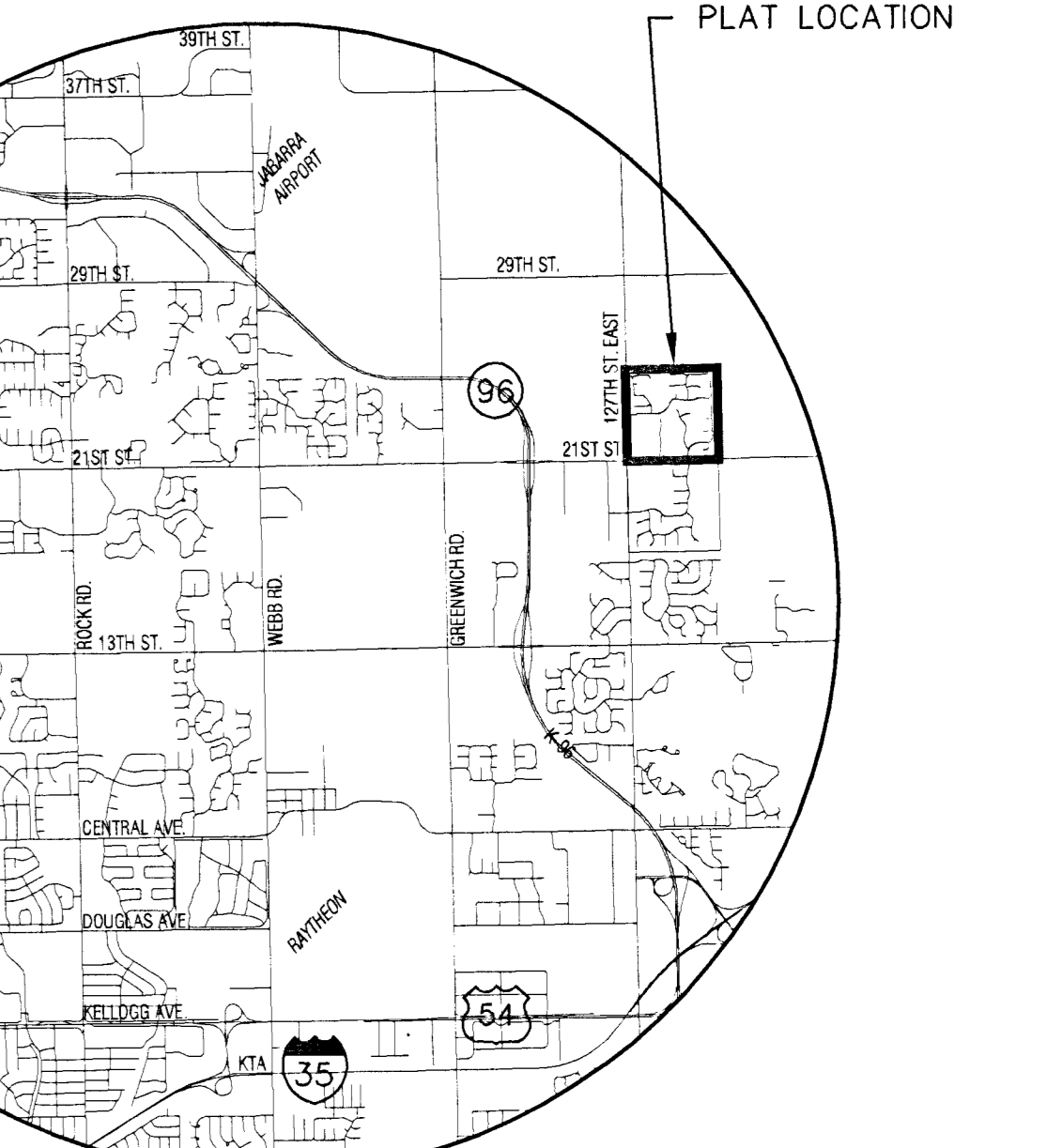

VICINITY MAP

UNPLATTED
ARTHUR A. KRUG TRUST &
PHILLIS J. KRUG REVOCABLE TRUST
7007 LARKSPUR LN
MIDDLETOWN, OH 45044

MINIMUM PAD ELEVATIONS (LOWEST OPENINGS)				MINIMUM PAD ELEVATIONS (LOWEST OPENINGS)			
LOT	BLOCK	ELEVATION (CITY DATUM)	ELEVATION (USGS)	LOT	BLOCK	ELEVATION (CITY DATUM)	ELEVATION (USGS)
8	2			8	6		
9	2			9	6		
10	2			10	6		
11	2			11	6		
12	2			12	6		
21	2			13	6		
22	2			14	6		
23	2			15	6		
24	2			16	6		
25	2			17	6		
26	2			26	6		
27	2			27	6		
28	2			28	6		
38	2			29	6		
39	2			30	6		
40	2			32	6		
53	2			36	6		
54	2			37	6		
30	5			41	6		
31	5			42	6		
32	5			43	6		
1	6			44	6		
2	6			45	6		
3	6			46	6		
4	6			47	6		
5	6			48	6		
6	6			49	6		
7	6			50	6		

LEGEND

- CTH - CONFERIOUS TREE & DIAMETER
- DN - DECIDUOUS TREE & DIAMETER
- S - SIGN
- B - BUSH
- ET - EDGE OF TREES
- F - FENCE
- SMH - SANITARY SEWER MANHOLE
- GM - GAS METER
- POLE - POLE
- DATE - DATE
- W - WALL
- LP - LIGHT POLE
- FH - FIRE HYDRANT
- WV - WATER VALVE
- WM - WATER METER
- PP - POWER POLE AND GUY ANCHOR
- TR - TELEPHONE RISER
- INLET - INLET
- SSP - STORM SEWER PIPE
- WL - WATER LINE
- SSL - SANITARY SEWER LINE
- GL - GAS LINE
- UL - UNDERGROUND ELECTRIC LINE
- OT - OVERHEAD TELEPHONE
- OE - OVERHEAD ELECTRIC
- UF - UNDERGROUND FIBER OPTIC CABLE
- HP - HIGH PRESSURE GAS PIPELINE
- SC - SECTION CORNER
- PCF - PROPERTY CORNER FOUND
- BM - BENCHMARK

SE. Cor. SW. ¼, Sec. 2,
T27S, R2E, 6th P.M.
Fnd. ¾" Pipe

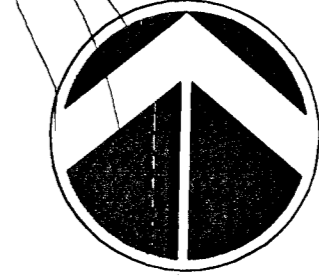

SCALE: 1" = 100'

**PRELIMINARY PLAT
HAWTHORNE ADDITION**

OWNERS/DEVELOPER: Twenty-First Growth, L.L.C. 816 Terradyne Andover KS 67002

DATE: JUNE, 2002

