

# DRAINAGE CONCEPT

## BAY COUNTRY 2ND ADDITION

### WICHITA, SEDGWICK COUNTY, KANSAS

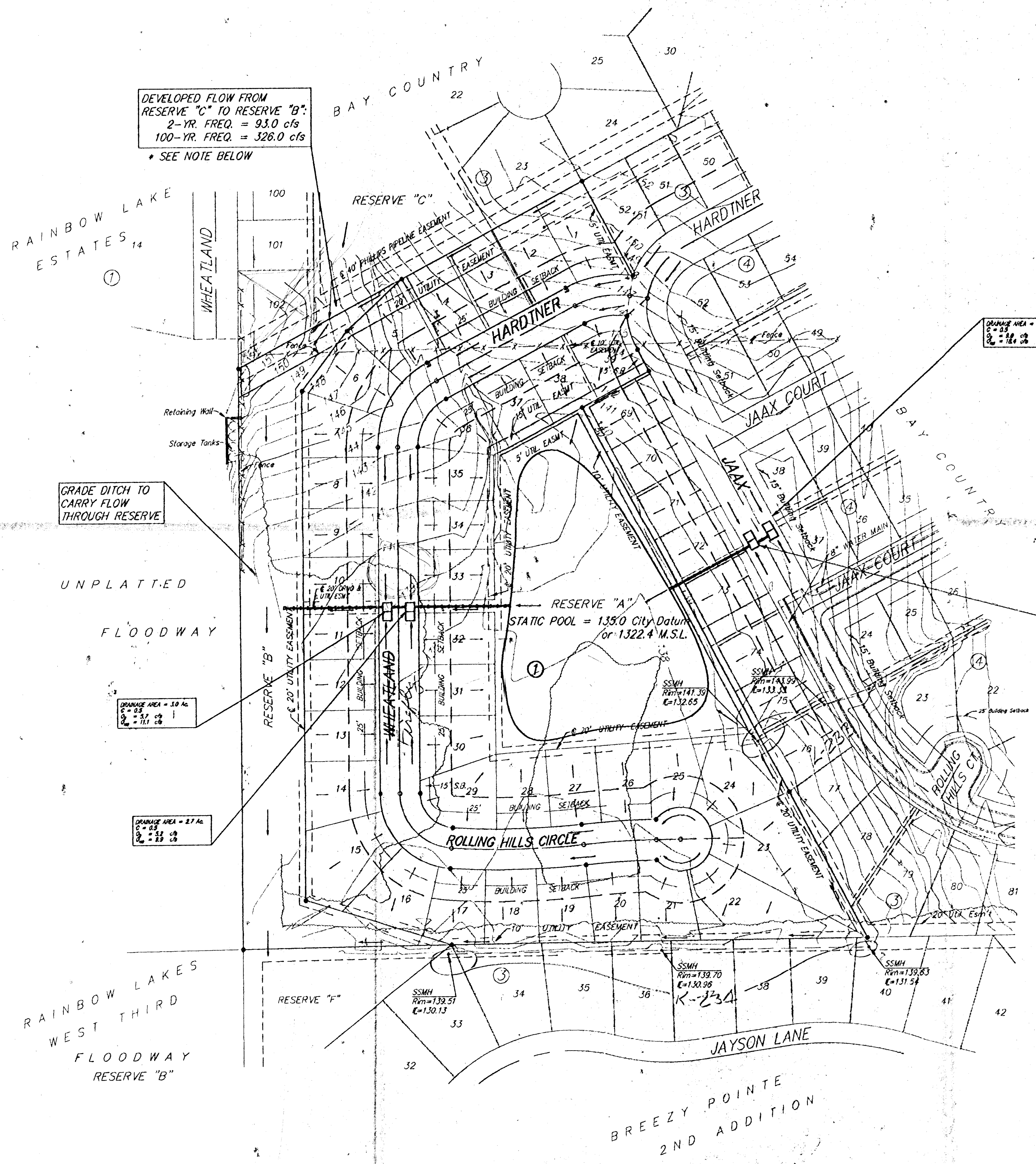

DEVELOPED FLOW FROM RESERVE "C" TO RESERVE "B":  
 2-YR. FREQ. = 93.0 cfs  
 100-YR. FREQ. = 326.0 cfs  
 \* SEE NOTE BELOW

**MINIMUM PAD ELEVATIONS**

Lot	Block	Elevation (NGVD)
11-39	1	1326.0



Scale: 1" =  
 1' = Contour intervals

OWNER:  
 RAY JACOBY  
 418 S. FORESTVIEW CT.  
 WICHITA, KANSAS 67235  
 PH. # 316-721-5844

**LEGAL DESCRIPTION:**  
 A REPLAT OF LOTS 53, 54, 55, 56, 57, 58, 59, 60, 61, 62, 63, 64, 65, 66, 67, & 68, BLOCK 3, TOGETHER WITH ALL OF RESERVE "C" EXCEPT THAT PART LYING BETWEEN LOTS 73 & 74, IN SAID BLOCK 3, AND TOGETHER WITH THAT PART OF RESERVE "D" LYING BETWEEN SAID LOTS 56 & 57, IN SAID BLOCK 3, AND TOGETHER WITH HARDTNER CIRCLE, ALL IN BAY COUNTRY, AN ADDITION TO WICHITA, SEDGWICK COUNTY, KANSAS.

**BENCHMARK:**  
 119TH ST. WEST & CENTRAL, CITY OF WICHITA DISC. 40' E. & 46' S. OF C BOTH; 58.82' S.E. OF S&G. COR. IRON; 21.7' W. OF FACE OF WALK N/S; 13.6' N. OF WALK E/W.  
 ELEV. = 156.93 CITY DATUM

- NOTES:**
- DRAINAGE FROM RESERVE "C" TO RESERVE "B" WAS CALCULATED USING THE FOLLOWING DATA:  
 SCS CURVE NUMBER = 80  
 SCS-TR55 COMPUTER MODEL  
 TIME OF CONC. = 1.61 HRS.  
 TYPE II, 24-HR STORM  
 DRAINAGE BASIN AREA = 138 AC.
  - ALL OTHER PEAK FLOW RATES WERE DETERMINED USING THE "RATIONAL" METHOD.

SCANNED