

DRAINAGE CONCEPT KRUG NORTH ADDITION WICHITA, SEDGWICK COUNTY, KANSAS

Off-site Drainage
D. A. = 11.8 acres
Q2 = 11.8 cfs
Q2 = 16.2 cfs
Q2 = 26.2 cfs

Off-site Drainage
D. A. = 4.4 acres
Q2 = 3.1 cfs
Q2 = 6.0 cfs
Q2 = 9.7 cfs

Off-site Drainage
D. A. = 16.2 acres
Q2 = 18.8 cfs
Q2 = 22.1 cfs
Q2 = 33.7 cfs

Off-site Drainage
D. A. = 15.8 acres
Q2 = 18.2 cfs
Q2 = 21.6 cfs
Q2 = 34.9 cfs

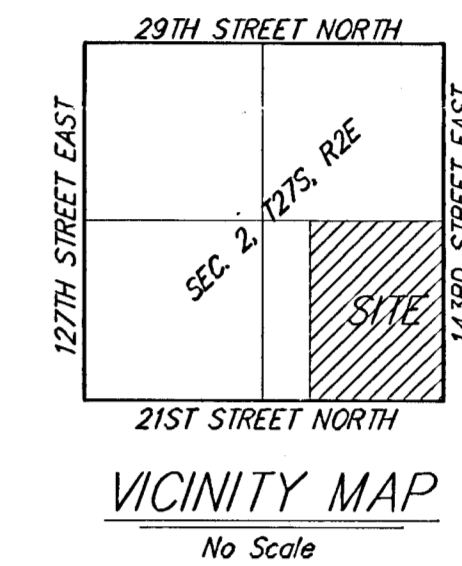
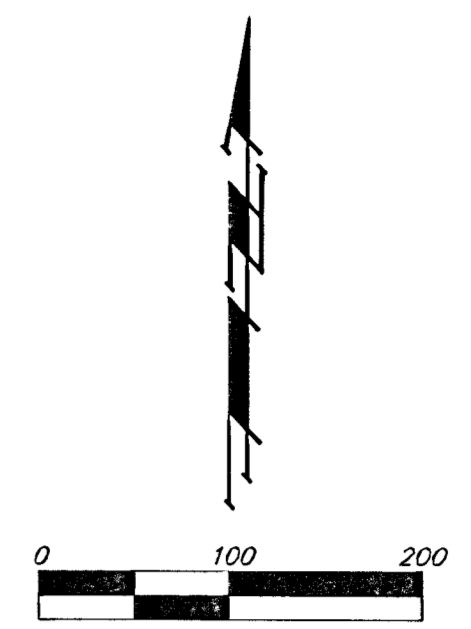

LEGEND

- Basin Detritector
- Basin Identifier
- General Flow Direction
- Catch Basin
- Drop Inlet
- Storm Water Sewer
- Culvert

KRUG NORTH ADDITION - STORMWATER FLOWS

BASIN #	BASIN AREA (acres)	Time of Concentration (min)	RUNOFF COEFFICIENTS			PEAK FLOWRATE		
			2-yr C	5-yr C	100-yr C	2-yr cfs	5-yr cfs	100-yr cfs
1	3.3	15	0.50	0.54	0.76	6.4	8.2	18.6
2	3.7	15	0.50	0.54	0.76	10.9	14.1	32.0
3	2.5	15	0.50	0.54	0.76	4.8	6.1	13.9
4	2.3	15	0.50	0.54	0.76	4.3	5.6	12.6
5	2.4	15	0.50	0.54	0.76	4.6	5.9	13.3
6	5.9	15	0.50	0.54	0.76	11.3	14.5	33.0
7	4.8	15	0.50	0.54	0.76	9.2	11.8	26.9
8	1.7	15	0.50	0.54	0.76	2.0	2.6	20.5
9	1.3	15	0.50	0.54	0.76	2.5	3.3	7.4
10	1.1	15	0.50	0.54	0.76	2.2	2.8	6.4
11	1.4	15	0.50	0.54	0.76	4.4	5.7	18.8
12	1.1	15	0.50	0.54	0.76	2.1	2.8	6.3
13	0.6	15	0.50	0.54	0.76	1.1	1.5	3.3
14	0.9	15	0.50	0.54	0.76	1.7	2.2	5.0
15	1.9	15	0.50	0.54	0.76	3.7	4.7	10.7
16	0.8	15	0.50	0.54	0.76	1.2	1.5	3.4
17	1.4	15	0.50	0.54	0.76	2.5	3.1	12.0
18	0.5	15	0.50	0.54	0.76	0.9	1.2	2.7
19	2.5	15	0.50	0.54	0.76	4.7	6.1	13.9
20	3.0	15	0.50	0.54	0.76	5.9	7.5	17.0
21	2.5	15	0.50	0.54	0.76	4.2	5.4	13.8
22	1.9	15	0.50	0.54	0.76	3.7	4.7	10.7
23	2.0	15	0.50	0.54	0.76	3.9	5.0	11.3
24	1.5	15	0.50	0.54	0.76	2.9	3.7	8.4
25	1.5	15	0.50	0.54	0.76	2.9	3.7	8.4
26	9.3	15	0.50	0.54	0.76	17.8	22.9	52.1
27	2.4	15	0.50	0.54	0.76	4.7	6.0	13.7
28	0.2	15	0.50	0.54	0.76	0.4	0.5	1.1
29	2.1	15	0.50	0.54	0.76	4.0	5.2	11.8
30	1.2	15	0.50	0.54	0.76	2.4	3.0	6.9
31	0.5	15	0.50	0.54	0.76	1.0	1.3	2.9
32	2.4	15	0.50	0.54	0.76	4.5	5.8	13.2
33	1.8	15	0.50	0.54	0.76	3.4	4.4	9.9
34	2.4	15	0.50	0.54	0.76	4.7	6.0	13.7
35	0.4	15	0.50	0.54	0.76	0.9	1.1	2.5
36	0.3	15	0.50	0.54	0.76	0.6	0.7	1.7
37	12.0	15	0.50	0.54	0.76	23.0	29.5	67.2
38	1.8	15	0.50	0.54	0.76	2.9	3.7	8.5
39	1.9	15	0.50	0.54	0.76	3.6	4.7	10.6
40	1.4	15	0.50	0.54	0.76	2.7	3.5	8.0
41	1.5	15	0.50	0.54	0.76	2.9	3.7	8.4

November 18, 2003