

UTILITY PLAN
SEALPAK ADDITION
WICHITA, SEDGWICK COUNTY, KANSAS

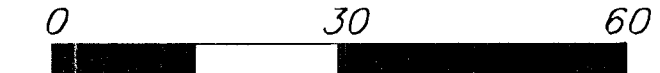

DATE OF PREPARATION: 27 JANUARY 2003
 DATE OF TOPOGRAPHY: 30 DECEMBER 2002
 CONTOUR INTERVALS = 1 FOOT

MB □ = Mail Box
 T ○ = Tree

- = #4 REBAR W/ "BAUGHMAN" CAP (FOUND)
- = #4 REBAR W/ "BAUGHMAN" CAP (SET)
- ⊙ = #4 REBAR W/ "TILSI" CAP (FOUND)
- ⊗ = 1" IRON (FOUND)
- = 1/2" IRON (FOUND)
- = "P-K" NAIL & SHINER IN STUMP (FOUND)
- ⊖ = BOLT (FOUND)
- ⊙ = RAILROAD SPIKE (FOUND)
- = #6 REBAR (FOUND)
- (M) = MEASURED
- (D) = DESCRIBED
- (P) = PLATED
- (C) = CALCULATED

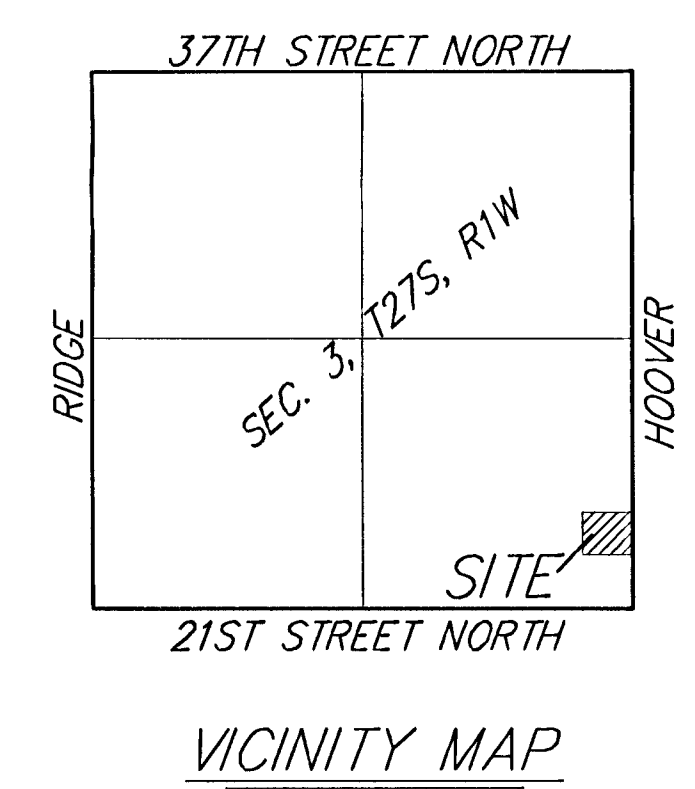

NOTE:
 A drainage plan has been developed for this subdivision and is on file with the City of Wichita, Kansas. Drainage intent shall remain as depicted or as modified with the approval of the City Engineer of the City of Wichita, Kansas. No obstructions which impede the flow of this drainage plan shall be allowed.

NOTE:
 Water and Sanitary sewer are being proposed by the Department of Water and Sewer.

MINIMUM BUILDING PAD ELEVATIONS FOR LOWEST OPENING TO THE STRUCTURES		
LOT	BLOCK	ELEVATION
		CITY DATUM
1	A	137.0

BENCHMARK:
 City Disc - 48.5' W & 28' N. of C of
 21st Street North & Hoover St.
 Elev. = 139.07 City Datum

