

PRELIMINARY PLAT  
**SOUTHERN RIDGE ADDITION**  
 WICHITA, SEDGWICK COUNTY, KANSAS



0 100 200  
 CONTOUR INTERVAL = 1 FT.  
 DATE OF TOPOGRAPHY: 1 JUNE 2002  
 DATE OF PREPARATION: 29 JULY 2002

OWNER:  
 Lump Farms, LLC  
 4 Ross L. Loop  
 1421 Linnett  
 Wichita, Kansas 67203-2981

CONTRACT PURCHASER:  
 Jay M. Russell  
 12600 W 13th St. N.  
 Wichita, Kansas 67235  
 Ph: 316-722-2417

LEGAL DESCRIPTION:  
 The NE 1/4 of Sec. 6, Twp. 29-S,  
 R-1-W of the 6th P.M., Sedgwick  
 County, Kansas; subject to road  
 rights-of-way of record.

BENCHMARK:  
 City of Wichita Benchmark Disc -  
 SW Corner of the intersection of  
 Pawnee & Maize Rd.  
 44' South of centerline  
 60' West of centerline  
 12' East of fence  
 65' SW of Sec. corner Iron  
 Elev. = 1332.52 City Datum  
 1332.52 NGVD29

Reserves "A" and "B" are hereby reserved for  
 streets, utilities, drainage, entry monuments,  
 landscaping, signage, open space.

Reserve "B" is hereby reserved for open space,  
 parking, utilities, drainage purposes, and  
 landscaping.

Reserve "C" is hereby reserved for open space,  
 landscaping, entry monuments, drainage  
 purposes, and utilities as confined to easement.

● = #4 REBAR W/ "BAUGHMAN" CAP (SET)  
 ▲ = STONE (FOUND)  
 X = #4 REBAR (FOUND)

EB □ = Electric Box  
 RW □ = Fire Hydrant  
 CM ● = Gas Meter  
 G/M ● = Gas Meter  
 G/M ● = Gas Meter  
 P ● = Power Pole  
 S ● = Sign  
 SSW ● = Sanitary Sewer Manhole  
 SSW Ped ● = Southwestern Bell Pedestal  
 W ● = Water Meter  
 W ● = Water Meter  
 W ● = Water Valve  
 W ● = Water Valve Box

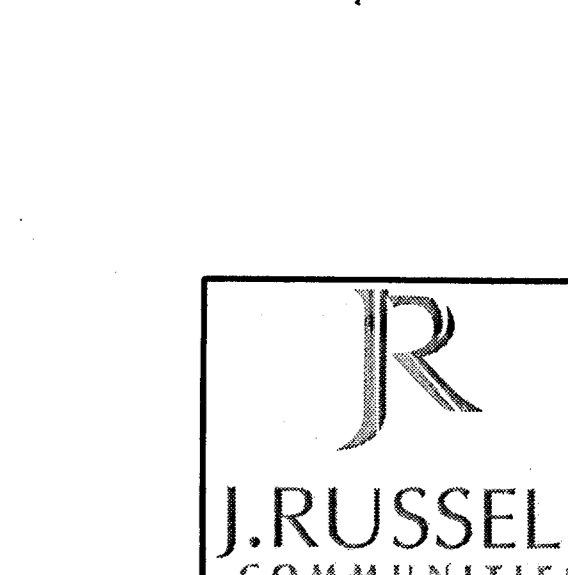
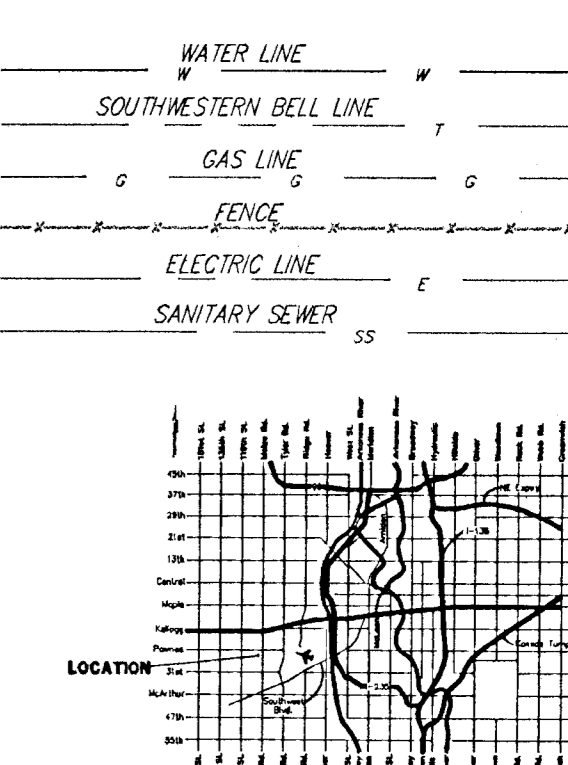

**J. RUSSELL COMMUNITIES**

29 JULY 2002

**BAUGHMAN COMPANY P. A.**  
 ENGINEERING, SURVEYING, & PLANNING  
 316-282-7201 • 316-282-7202 • WICHITA, KANSAS 67211

JACQUES LUCILLE E. REVOC. LHM TRUST  
 28 MAR 1978 B. WOOD  
 919 W 12TH #102  
 WICHITA, KS

SCHULTE, LAWRENCE A. & LAVINA M.  
 P.O. BOX 4  
 311 PIERCE  
 MAPLE HILL, KS 66507-0004