

PRELIMINARY PLAT
KOKER ADDITION
 WICHITA, SEDGWICK COUNTY, KANSAS

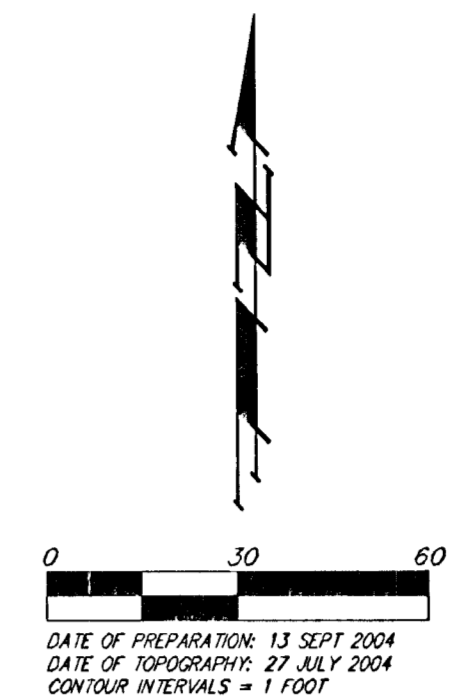

OWNER:
 CRK Development, LLC
 Clinton Koker
 9717 Par
 Wichita, KS 67212

LEGAL DESCRIPTION:
 The east 435.6 feet of the north
 245.5 feet of the south 2192.50 feet
 of the SE1/4 of Sec. 13, Twp. 27-S,
 R-2-W.

BENCHMARK:
 "□" cut top of curb eastside of
 119th adjacent to fire hydrant east
 of house #927.
 Elevation = 1342.13 NGVD29

RESERVES "A" AND "B" ARE HEREBY RESERVED FOR ENTRY
 MONUMENTS, LANDSCAPING, BERMS, OPEN SPACE, DRAINAGE
 PURPOSES, STREETS, SCREENING WALLS, AND UTILITIES AS CONTAINED
 IN EASEMENTS.

RESERVE "C" IS HEREBY RESERVED FOR MONUMENTS, OPEN SPACE,
 LANDSCAPING, BERMS, STREETS, DRAINAGE PURPOSES, AND UTILITIES.

RESERVE "D" IS HEREBY RESERVED FOR ENTRY MONUMENTS, OPEN
 SPACE, LANDSCAPING, BERMS, STREETS, DRAINAGE PURPOSES, AND
 UTILITIES.

- EM = Electric Meter
- EB = Electric Box
- TH = Fire Hydrant
- GM = Gas Meter
- HLP = High Line Pole
- MB = Mail Box
- PP = Power Pole
- SSM = Sanitary Sewer Manhole
- SSC Ped = SSC Pedestal
- T = Tree
- WM = Water Meter
- SWSM = Stormwater Sewer Manhole

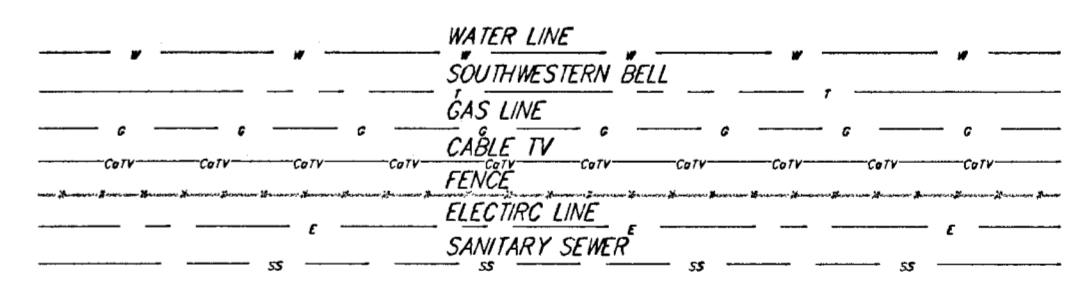

- * = #4 REBAR W/ "BAUGHMAN" CAP (FOUND)
- = #4 REBAR W/ "BAUGHMAN" CAP (SET)
- ⊙ = #6 REBAR IN THIMBLE (FOUND)
- ⊗ = 1" IRON (FOUND)
- = 1/2" IRON (FOUND)

- (M) = MEASURED
- (D) = DESCRIBED
- (P) = PLATTED
- (C) = CALCULATED
- (C-P) = CALCULATED PER PLATTED INFO.
- (C-D) = CALCULATED PER DEED INFO.

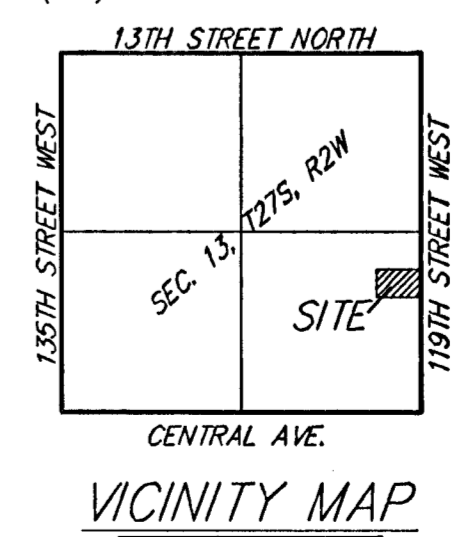

NOTE:
 ALL LOTS WITHIN KOKER ADDITION SHALL
 HAVE A 5 FOOT INTERIOR SIDEYARD SETBACK.

