

DRAINAGE PLAN FOR VOEGELI 2ND ADDITION TO WICHITA, SEDGWICK COUNTY, KANSAS

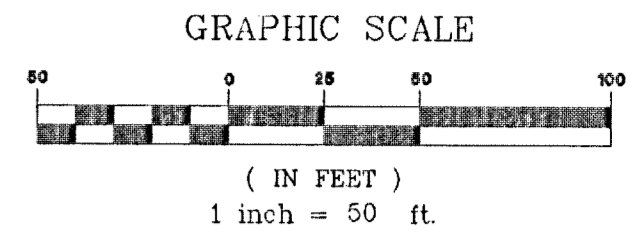

FLOOD ZONE MAP

Sec. 25, T27S, R1W

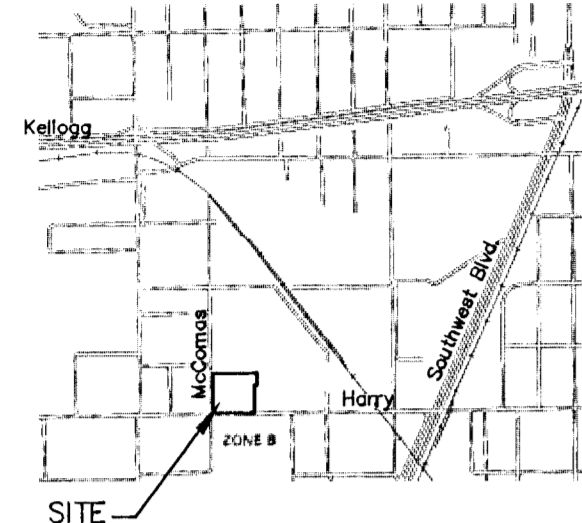

SCALE: 1" = 2,000'

FLOOD ZONE:

Subject property is in Zone B, as shown on Federal Emergency Management Agency (FEMA) Flood Insurance Rate Map (FIRM) for Sedgwick County, Kansas, Community Panel Number 200328 0025 B, effective May 15, 1986.

QUADRANGLE MAP

Sec. 25, T27S, R1W

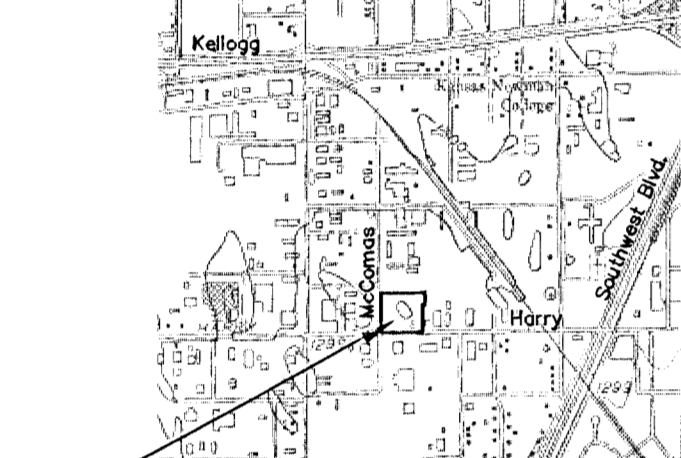

WICHITA WEST QUADRANGLE

7.5 Minute Series

SCALE: 1" = 2,000'

EXISTING DRAINAGE DATA	
Area=1.1 acres	SCS Soil Type B
Naron Fine Sandy Loom	C = 0.37
Tc = 44 min.	I 100=4.48"/hr.
Q 100=1.8 cfs	
PROPOSED DRAINAGE DATA	
Area=1.1 acres	SCS Soil Type B
Naron Fine Sandy Loom	C = 0.75
Tc = 15 min.	I 100=7.40"/hr.
Q 100=6.1 cfs	

PROP. DRAINAGE DATA		EXIST. DRAINAGE DATA	
Area=0.7 acres	SCS Soil Type B	Area=0.7 acres	SCS Soil Type B
Naron Fine Sandy Loom	C = 0.37	Naron Fine Sandy Loom	C = 0.37
Tc = 15 min.	I 100=7.40"/hr.	Tc = 37 min.	I 100=4.95"/hr.
Q 100=4.0 cfs		Q 100=1.3 cfs	

PROP. DRAINAGE DATA		EXIST. DRAINAGE DATA	
Area=1.0 acres	SCS Soil Type B	Area=1.0 acres	SCS Soil Type B
Naron Fine Sandy Loom	C = 0.85	Naron Fine Sandy Loom	C = 0.37
Tc = 15 min.	I 100=7.40"/hr.	Tc = 31 min.	I 100=5.43"/hr.
Q 100=6.3 cfs		Q 100=2.0 cfs	

PROPOSED DRAINAGE DATA	
Area=0.6 acres	SCS Soil Type B
Naron Fine Sandy Loom	C = 0.86
Tc = 15 min.	I 100=7.40"/hr.
Q 100=3.8 cfs	
EXISTING DRAINAGE DATA	
Area=0.6 acres	SCS Soil Type B
Naron Fine Sandy Loom	C = 0.37
Tc = 37 min.	I 100=4.95"/hr.
Q 100=1.1 cfs	

- ON SITE BENCH MARK
"1" CURB, SE CORNER OF CATCH BASIN ON THE N.E. CORNER OF MCCOMAS AND HARRY STREET
ELEV = 1298.46 N.G.V.D.
- LEGEND**
- M = Measured
 - D = Described
 - TC = Top of Curb
 - FL = Flow Line
 - G = Gas Main
 - UGT = Under Ground Telephone
- TELE. PED. TELEPHONE PEDESTAL
 - V.B. VALVE BOX
 - F.H. FIRE HYDRANT
 - POST POST
 - POWER POLE POWER POLE
 - DUY ANCHOR DUY ANCHOR
 - SIGN SIGN
 - SWS M.H. STORM WATER SEWER MANHOLE
 - SS M.H. SANITARY SEWER MANHOLE
 - THIMBLE CITY OF WICHITA CONTROL (FOUND)
 - RLS 950 1/2" REBAR W/RLS 950 CAP (FOUND)
 - SRB 1/2" REBAR W/SRB CAP (FOUND)
 - CON. CONCRETE NAIL (FOUND)
 - BM ON SITE BENCH MARK
- Proposed Drainage Flow Direction
 - Drainage Basin
 - Asphalt Surface(68,064 s.f. or 1.56 Acres)
 - Grass Surface(39,575 s.f. or 0.91 Acres)
 - Roof Surface(81,000 s.f. or 1.86 Acres)

Owner:
Randall E. Voegli
& Bonnie D. Voegli
3506 W. Harry
Wichita, KS 67213

GROSS AREA:
215999.96 Sq. Ft.±
4.96 Acres±

NET AREA:
180574.96 Sq. Ft.±
4.15 Acres±

MINIMUM LOT SIZE:
180574.96 Sq. Ft.±
4.15 Acres±

EXISTING ZONING: LI - Limited Industrial
CONTROL NO. 492265

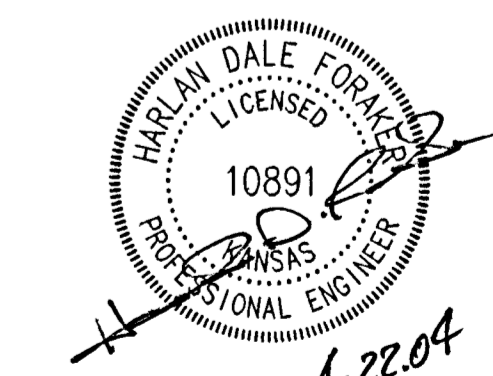

LEGAL DESCRIPTION:

That part of the SW1/4 of Sec. 25, Twp. 27S, R-1-W of the 6th P.M., Sedgwick County, Kansas, described as commencing at the S.W. Corner of said SW1/4; thence east along the South Line of said SW1/4, 750 feet for a place of beginning; thence north parallel with the West Line of said SW1/4, 460 feet; thence east, parallel with the South Line of said SW1/4, 487.5 feet; thence south, parallel with the West Line of said SW1/4, 130 feet; thence west, parallel with the South Line of said SW1/4, 25 feet; thence south, parallel with the West Line of said SW1/4, 330 feet to the South Line of said SW1/4; thence west, along the South Line of said SW1/4, 462.5 feet to the place of beginning.

Savoy Company, P.A.
Land Surveyors
335 S. Emporia, Suite 104, Wichita, KS 67202
PH (316) 265-0005
FAX (316) 265-0275
www.savoyco.com

TOTAL PROPOSED DRAINAGE DATA		TOTAL EXISTING DRAINAGE DATA		EXISTING DRAINAGE DATA		PROPOSED DRAINAGE DATA	
Area=1.1 acres	SCS Soil Type B	Area=4.2 acres	SCS Soil Type B	Area=0.5 acres	SCS Soil Type B	Area=0.5 acres	SCS Soil Type B
Naron Fine Sandy Loom	C = 0.75	Naron Fine Sandy Loom	C = 0.37	Naron Fine Sandy Loom	C = 0.37	Naron Fine Sandy Loom	C = 0.79
Tc = 15 min.	I 100=7.40"/hr.	Tc = 46 min.	I 100=4.36"/hr.	Tc = 25 min.	I 100=7.40"/hr.	Tc = 15 min.	I 100=7.40"/hr.
Q 100=6.1 cfs		Q 100=6.6 cfs		Q 100=1.1 cfs		Q 100=0.6 cfs	Q 100=1.9 cfs

DRAINAGE PLAN PREPARED BY:
CERTIFIED ENGINEERING DESIGN, P.A.

CED 810 WEST DOUGLAS, SUITE C
WICHITA, KANSAS 67203
PH: (316) 262-8808
FAX: (316) 262-1669

SHEET 1
TOTAL 1