

# VIA CHRISTI - ST. JOSEPH WEST

## AN ADDITION TO WICHITA, SEDGWICK COUNTY, KANSAS

State of Kansas) SS We, Baughman Company, P.A., Surveyors in Sedgwick County and state, do hereby certify that we have surveyed and platted "VIA CHRISTI - ST. JOSEPH WEST", an Addition to Wichita, Sedgwick County, Kansas and that the accompanying plat is a true and correct exhibit of the property surveyed, described as the NW 1/2 of the SW 1/4 of the SW 1/4 of Sec. 26, Twp. 27-S, R-1-E of the 8th P.M., Sedgwick County, Kansas, EXCEPT therefrom all of Lots 25, 27, 29, and 31, on Hillside Avenue, Magic Hill Addition to the City of Wichita in the State of Kansas, together with the W 1/2 of the vacated alley lying east of and adjacent to said Lots, and EXCEPT Hillside Avenue, Zimmerly Street, Clifton Avenue, and Grand Avenue as dedicated in said Magic Hill Addition.

Existing public easements and dedications being vacated by virtue of K.S.A. 12-512(b).

Baughman Company, P.A.

Michael G. Conroy, Surveyor

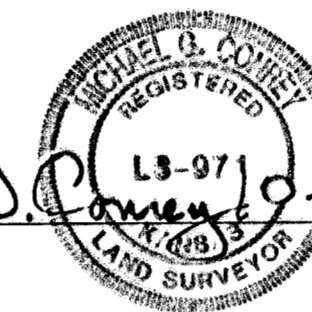

Know all men by these presents that we, the undersigned, have caused the land in the surveyors certificate to be platted into a Lot, a Block, and Streets to be known as "VIA CHRISTI - ST. JOSEPH WEST", an Addition to Wichita, Sedgwick County, Kansas. The Hillside Avenue contingent street dedication shall become effective in the event that the City of Wichita, Kansas determines a need for the right-of-way for any street related purposes. The Hillside Avenue contingent street dedication shall be a covenant running with the land and shall be binding on all heirs and subsequent owners of all parts of said property covered by said contingent street dedication. Access controls shall be as depicted on the face of the plat and are hereby granted to the City of Wichita, Kansas.

Via Christi Property Services, Inc.

R. Allan Allford, President

Via Christi Regional Medical Center, Inc., a not-for-profit corporation

Frank Creeden, C.E.O.

1" IRON (FOUND) 0.60" N. & 0.22" W. OF NE COR., LOT 1, VIA CHRISTI - ST. JOSEPH WEST

State of Kansas) SS The foregoing instrument acknowledged before me, this 29th day of October, 2004, by R. ALLAN ALLFORD, President, Via Christi Property Services, Inc., on behalf of the corporation.

Karen L. Allen, Notary Public

My App't. Exp. 10/31/08

State of Kansas) SS The foregoing instrument acknowledged before me, this 29th day of October, 2004, by FRANK CREEDEN, INTERIM CEO, Via Christi Regional Medical Center, Inc., a not-for-profit corporation, on behalf of the corporation.

Karen L. Allen, Notary Public

My App't. Exp. 10/31/08

This plat of "VIA CHRISTI - ST. JOSEPH WEST", an Addition to Wichita, Sedgwick County, Kansas has been submitted to and approved by the Wichita-Sedgwick County Metropolitan Area Planning Commission, Wichita, Kansas. Dated this 29th day of October, 2004. Wichita-Sedgwick County Metropolitan Area Planning Commission

Ronald L. Marnell, Chair  
John L. Schlegel, Secretary

This plat approved and all dedications shown hereon accepted by the City Council of the City of Wichita, Kansas, this 29th day of October, 2004.

Carlos Mayans, Mayor  
Karen Sublett, City Clerk

Reviewed in accordance with K.S.A. 58-2005 on this 29th day of October, 2004.

Tricia L. Robello, L.S. #1246, Deputy County Surveyor, Sedgwick County, Kansas

Entered on transfer record this 29th day of October, 2004.

Don Brace, County Clerk

State of Kansas) SS This is to certify that this plat has been filed for record in the office of the Register of Deeds, this 29th day of October, 2004 at \_\_\_\_\_ o'clock \_\_\_\_\_ M. and is duly recorded.

Bill Meek, Register of Deeds  
Linda Kizzire, Deputy

Baughman Company, P.A.  
315 Ellis St. Wichita, KS 67211 P 316-262-7271 F 316-262-0149  
ENGINEERING | SURVEYING | PLANNING | LANDSCAPE ARCHITECTURE  
[PLAT] V[IA] C[HRISTI] - S[T.] J[OSEPH] W[EST] D[EDICATED] W[ITH] M[AP] 100

NOTE: A DRAINAGE PLAN HAS BEEN DEVELOPED FOR THIS SUBDIVISION AND IS ON FILE WITH THE CITY OF WICHITA, KANSAS. DRAINAGE INTENT SHALL REMAIN AS DEPICTED OR AS MODIFIED WITH THE APPROVAL OF THE CITY ENGINEER OF THE CITY OF WICHITA, KANSAS. NO OBSTRUCTIONS WHICH IMPAIR THE FLOW OF THIS DRAINAGE PLAN SHALL BE ALLOWED.

- = #4 REBAR W/ "BAUGHMAN" CAP (SET)
- △ = #4 REBAR (FOUND)
- = 1" IRON (FOUND)
- = #4 REBAR W/ "TILE" CAP (FOUND)
- ⊠ = #4 REBAR W/ "BAUGHMAN" CAP (FOUND)
- ⊞ = 1/2" IRON IN THIMBLE (FOUND)
- ⊞ = 1/2" IRON (FOUND)
- ⊞ = 3/4" IRON IN THIMBLE (FOUND)
- ⊞ = 3/4" IRON (FOUND)
- ⊞ = CROSS CUT (FOUND)

- (M) = MEASURED
- (P) = PLATTED
- (C) = CALCULATED
- (D) = DESCRIBED
- (CM) = CALCULATED PER MEASURED INFO.
- (C-P) = CALCULATED PER PLATTED INFO.

