

LEGEND

- - Sign
- - Bush
- ⊕ - Power Pole And Guy Anchor
- ⊕ - Electric Box
- ⊕ - Sewer Clean Out
- ⊕ - Edge Of Trees
- ⊕ - Fence
- ⊕ - Benchmark
- ⊕ - Storm Water Manhole
- ⊕ - Sanitary Sewer Manhole
- ⊕ - Gate
- ⊕ - Wall
- ⊕ - Light Pole
- ⊕ - Fire Hydrant
- ⊕ - Water Valve
- ⊕ - Water Meter
- ⊕ - Irrigation Control Valve
- ⊕ - Gate Inlet
- ⊕ - Telephone Riser
- ⊕ - Inlet
- ⊕ - Gas Meter
- ⊕ - Storm Sewer Pipe
- ⊕ - Water Line
- ⊕ - Sanitary Sewer Line
- ⊕ - Gas Line
- ⊕ - Telephone Line
- ⊕ - Underground Electric Line
- ⊕ - Overhead Telephone
- ⊕ - Overhead Electric
- ⊕ - Underground Fiber Optic Cable
- ⊕ - 5/8" Rebar/mkec Cis #39 Set
- ⊕ - Section Corner Monument
- ⊕ - Benchmark
- ⊕ - Building Setback
- ⊕ - Utility Easement
- (D) - Deed Measurement
- (M) - Measured
- (CD) - Calculated From Deeded Measurement
- (CM) - Calculated From Measurement

NOTES

1. ZONING: Existing / Proposed: General Industrial Special Case: CU-431
2. PLAT AREA: 48.98 acres
3. SURVEY DATE: March 20th, 2003
4. EXISTING USE: Salvage Yard, Auto Sales, and Vacant Lot
5. LOT TOTAL: 3
6. RESERVE DESIGNATION AND USES: None
7. See attached documents for legal description.

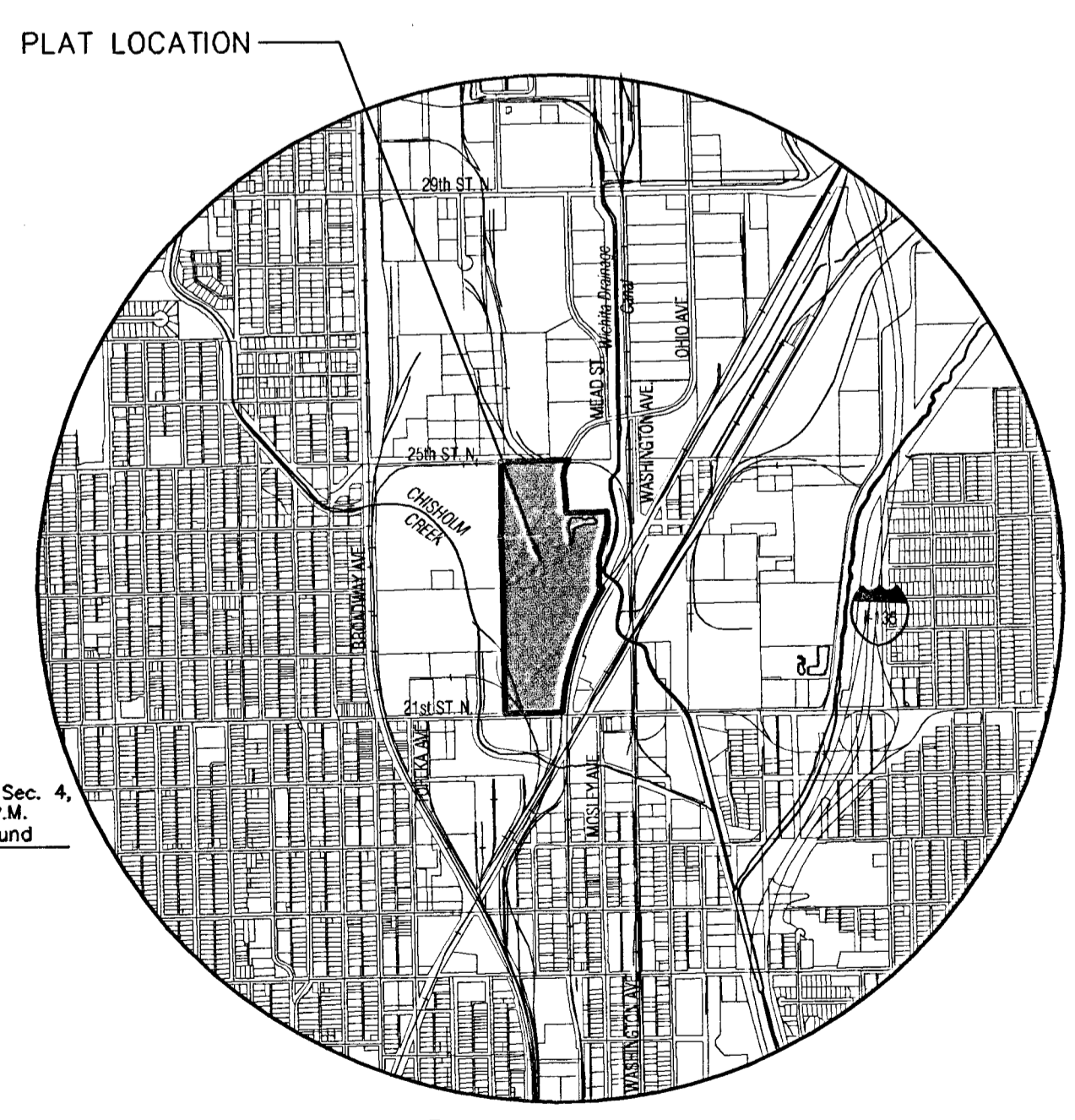

VICINITY MAP

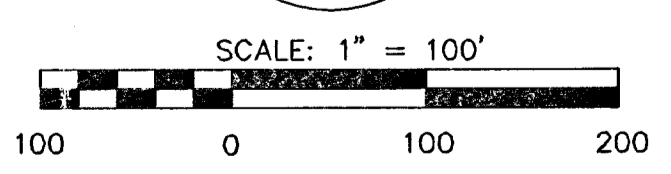

PRELIMINARY PLAT
STOCKYARD INDUSTRIAL PARK ADDITION

DATE: APRIL 14th, 2003

OWNERS/DEVELOPER: WEBB ROAD DEVELOPMENT INC. BLDG. E SUITE 100, 1223 N. ROCK RD. WICHITA, KS 67206-1269 316-636-2100



DATE: 04/14/03 11:05:38 AM GDT