

# PRELIMINARY PLAT DRAINAGE CONCEPT

## AUBURN HILLS 6TH ADDITION

### AN ADDITION TO WICHITA, KANSAS

KELLOGG (US HWY. 54)



MAPLE STREET

151ST STREET WEST

135TH STREET WEST

119TH STREET WEST

- NOTES:
1. Field Topography 1997 (By Others)
  2. Elevation = City Datum
  3. Reserve "C", "E", "F", "G", "H", "I" shall permit entry features, storage, signs, and utilities confined to easements.
  4. Reserve "J" shall permit drainage, and drainage structures, signs, irrigation, water, lighting, landscaping items, and utilities confined to easements.
  5. Reserve "K", "L" shall permit all above uses and golf courses, clubhouses, and all uses and amenities related to golf course design and operations.
  6. Drainage concept and Engineering to be provided by Baughman Co. PA.

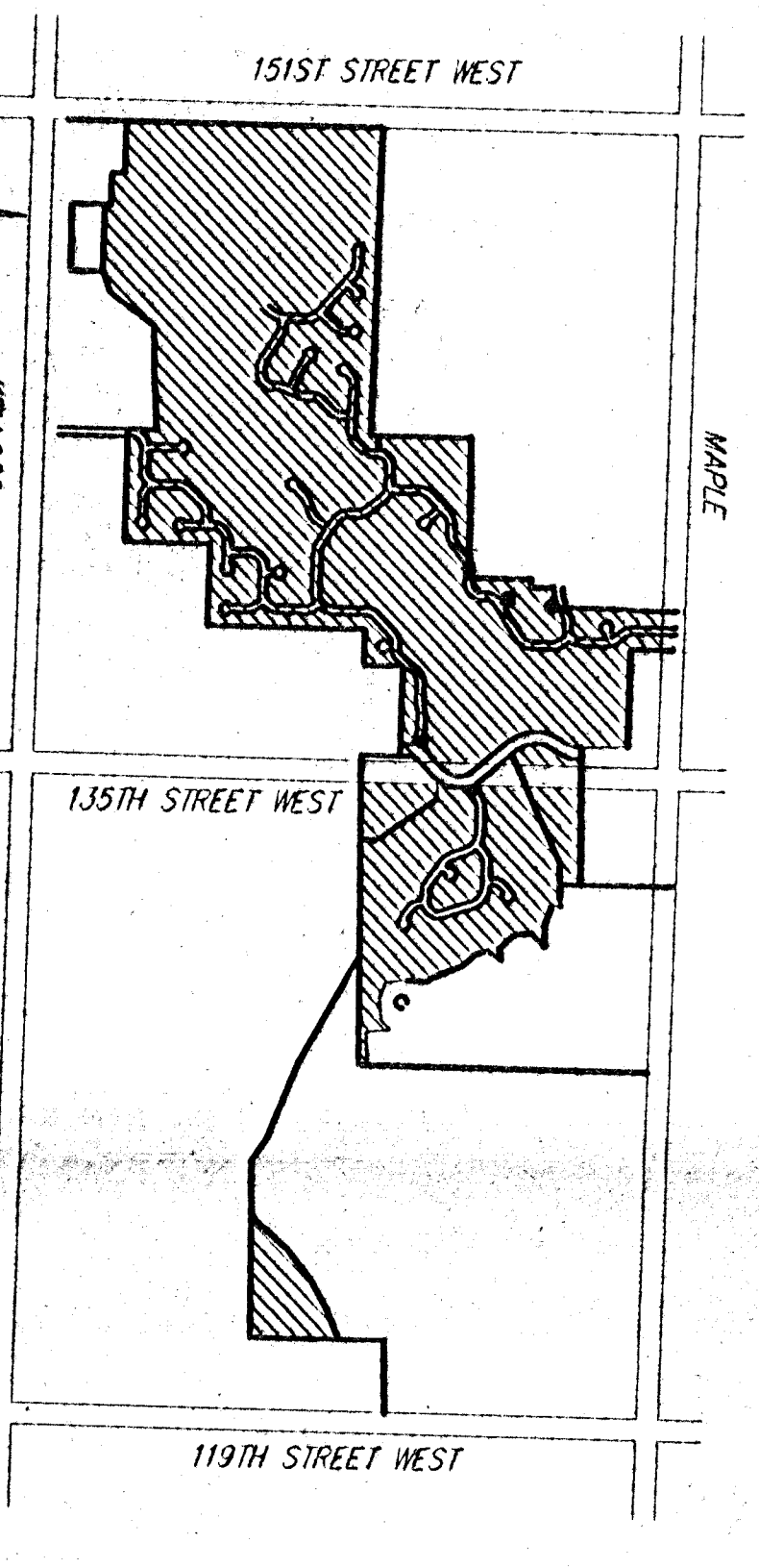

LOCATION MAP  
NO SCALE

SCALE: 1"=200'-0"

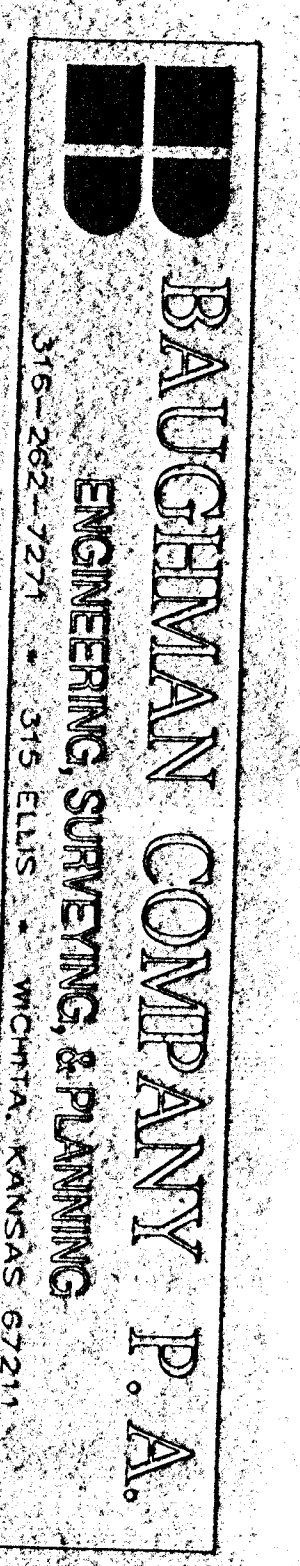
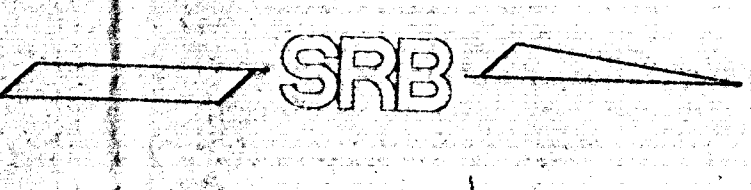

Designed and Drawn by:

**SRB**  
SAVOY, RUGGLES & BOHM, P.A.  
ENGINEERING & SURVEYING  
924 NORTH MAIN  
WICHITA, KANSAS 67203  
218-284-9008  
FAX 284-4821

WEST WICHITA DEVELOPMENT, INC.  
JAY R. RUSSELL, PRESIDENT  
1515 W. 15TH ST.  
WICHITA, KANSAS 67203  
(316) 272-2417  
24 NOV 1997