

STAFF REPORT
(Final Plat, Overall Preliminary Plat Approved 10/13/05)

CASE NUMBER: SUB 2008-83 -- EMERALD BAY ESTATES 2nd ADDITION

OWNER/APPLICANT: SNAR, LLC, Attn: Gaylan Nett, 1650 S. Meridian, Suite 7, Wichita, KS 67213

SURVEYOR/AGENT: Ruggles & Bohm, P.A., Attn: Tom Ruggles, 924 N. Main, Wichita, KS 67203

LOCATION: North of 21st St. North, West of West St. (District V)

SITE SIZE: 77.48 acres

NUMBER OF LOTS

Residential:	69
Office:	
Commercial:	
Industrial:	
Total:	69

MINIMUM LOT AREA: 11,668 square feet

CURRENT ZONING: SF-5 Single-family Residential

PROPOSED ZONING: Same

VICINITY MAP

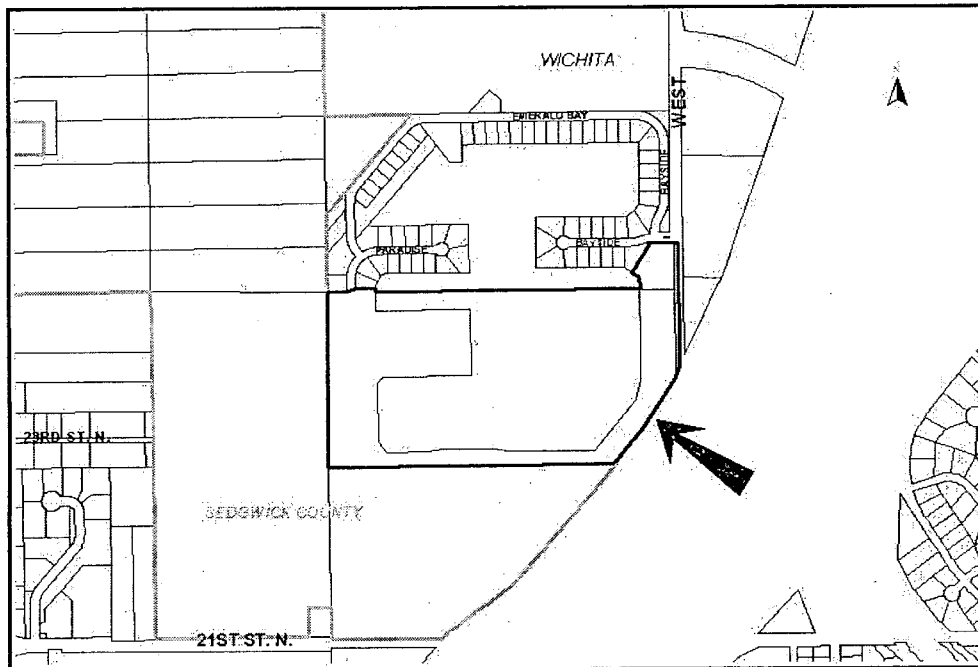

SUB 2008-83 -- Final Plat of EMERALD BAY ESTATES 2nd ADDITION
October 30, 2008 - Page 2

NOTE: This final plat is a portion of the overall preliminary plat approved for the Emerald Bay Estates Addition and represents the second phase of development. The street layout and lot configuration is consistent with the preliminary plat.

STAFF COMMENTS:

- A. Water Utilities Department has required the applicant to guarantee the extension of City water and sanitary sewer (mains and laterals) to serve the lots being platted.
- B. If improvements are guaranteed by petition(s), a notarized certificate listing the petition(s) shall be submitted to the Planning Department for recording.
- C. City Engineering needs to comment on the status of the applicant's drainage plan.
- D. Traffic Engineering has approved access controls. The plat proposes one street opening along West Street and complete access control along the remaining street frontage.
- E. The plat needs to include the entire right of way on West Street.
- F. The location of the floodway needs to be labeled in regards to West Street.
- G. The Applicant shall guarantee the paving of the proposed streets.
- H. Provisions shall be made for ownership and maintenance of the proposed reserves. The applicant shall either form a lot owners' association prior to recording the plat or shall submit a covenant stating when the association will be formed, when the reserves will be deeded to the association and who is to own and maintain the reserves prior to the association taking over those responsibilities.
- I. For those reserves being platted for drainage purposes, the required covenant that provides for ownership and maintenance of the reserves, shall grant to the appropriate governing body the authority to maintain the drainage reserves in the event the owner(s) fail to do so. The covenant shall provide for the cost of such maintenance to be charged back to the owner(s) by the governing body.
- J. This property is within a zone identified by the City Engineers' office as likely to have groundwater at some or all times within ten feet of the ground surface elevation. Building with specially engineered foundations or with the lowest floor opening above groundwater is recommended, and owners seeking building permits on this property will be similarly advised. More detailed information on recorded groundwater elevations in the vicinity of this property is available in the City Engineers' office.
- K. The Applicant is reminded that a platting binder is required with the final plat. Approval of this plat will be subject to submittal of this binder and any relevant conditions found by such a review.
- L. GIS has requested Bayside Ct be renamed Paradise Ct. Bayside adjoining Lots 33-39, Block 1 shall be renamed Paradise. Bayside adjoining the south plat line needs to be renamed 23rd St North or Clearmeadow.
- M. The plat's text shall include language that a drainage plan has been developed for the plat and that all drainage easements, rights-of-way, or reserves shall remain at established grades or as modified with the approval of the applicable City or County Engineer, and unobstructed to allow for the conveyance of stormwater.
- N. The applicant shall install or guarantee the installation of all utilities and facilities that are applicable and described in Article 8 of the MAPC Subdivision Regulations. (Water service and fire hydrants required by Article 8 for fire protection shall be as per the direction and approval of the Chief of the Fire Department.)
- O. The Register of Deeds requires all names to be printed beneath the signatures on the plat and any associated documents.
- P. To receive mail delivery without delay, and to avoid unnecessary expense, the applicant is advised of the necessity to meet with the United States Postal Service Growth Management Coordinator (Phone: 316-946-4556) prior to development of the plat so that the type of delivery, and the tentative mailbox locations can be determined.
- Q. The applicant is advised that various State and Federal requirements (specifically but not limited to the Army Corps of Engineers, Kanopolis Project Office, Rt. 1, Box 317, Valley Center, KS 67147) for the control of soil and wind erosion and the protection of wetlands may impact how this site can be developed. It is the applicant's responsibility to contact all appropriate agencies to determine any such requirements.

SUB 2008-83 -- Final Plat of EMERALD BAY ESTATES 2nd ADDITION
October 30, 2008 - Page 3

- R. The owner of the subdivision should note that any construction that results in earthwork activities that will disturb one (1) acre or more of ground cover requires a Federal/State National Pollutant Discharge Elimination System Storm Water Discharge Permit from the Kansas Department of Health and Environment in Topeka. Also, for projects located within the City of Wichita, erosion and sediment control devices must be used on ALL projects. For projects outside of the City of Wichita, but within the Wichita Metropolitan area, the owner should contact the appropriate governmental jurisdiction concerning erosion and sediment control device requirements.
- S. Perimeter closure computations shall be submitted with the final plat tracing.
- T. The representatives from the utility companies should be prepared to comment on the need for any additional utility easements to be platted on this property.
- U. A compact disc (CD), which will be used by the City and County GIS Departments, detailing the final plat in digital format in AutoCAD. If a disc is not provided, please send via e-mail to Cheryl Holloway (E-Mail address: cholloway@wichita.gov). Please include the name of the plat on the disc.