

## Haas, Carl

---

**From:** Gunzelman, Paul  
**Sent:** Monday, April 28, 2008 12:20 PM  
**To:** Armour, James; Janzen, Gary; Haas, Carl  
**Subject:** RE: 167th, Kellogg to Maple

**Sensitivity:** Private

The current traffic volume for 167<sup>th</sup> Street is 2,200 vehicles per day.

The school has advised that when the schools are completed and at capacity, the facilities will have 3,300 students and approximately 400 staff members. This is in addition to the students at the existing school.

Trip generation numbers are below:

Elementary School – generates 1.02 trips per student

Middle School – generates 1.45 trips per student

High School – generates 1.79 trips per student

Mark Borst is going to call the school and get a breakdown of the 3,300 students. He thought he had the info, but has not been able to find it. Worst case scenario (1.79 x 3,300) is an additional 5,900 vehicles per day. I will pass on the additional information when I get it.

---

**From:** Armour, James  
**Sent:** Monday, April 28, 2008 11:55 AM  
**To:** Janzen, Gary; Haas, Carl  
**Cc:** Gunzelman, Paul  
**Subject:** RE: 167th, Kellogg to Maple  
**Sensitivity:** Private

Thanks all.

---

**From:** Janzen, Gary  
**Sent:** Monday, April 28, 2008 10:28 AM  
**To:** Haas, Carl; Armour, James  
**Cc:** Gunzelman, Paul  
**Subject:** RE: 167th, Kellogg to Maple  
**Sensitivity:** Private

Thanks for getting this together, Carl.

Jim – We used Hoover & MacArthur as a good place to start here, especially for the Maple intersection. Left some non-paving bid items in as they were there, figured qty's off of the drawing Andy put together, added some pad and design/engineer costs. I think it looks pretty good.

We did not do anything detailed for full 3/4/5 lane, but based on recent bids, can give you some round numbers that will work well.

Here is the breakdown for all –

3-lane at Maple (including signal), School entrances (no signal) and improvements at Kellogg (including signal) =>

- \$550,000 + \$450,000 + \$350,000 = \$1,350,000

Full reconstruction to urban section – 3, 4 and 5 lane

- 3 lane = \$3,200,000
- 4 lane = \$3,700,000
- 5 lane = \$4,200,000

All conservative numbers, but good to use.

---

**From:** Haas, Carl  
**Sent:** Friday, April 25, 2008 4:01 PM  
**To:** Janzen, Gary  
**Cc:** Armour, James  
**Subject:** 167th, Kellogg to Maple  
**Sensitivity:** Private

Gary-

Attached is the spreadsheet for the 167<sup>th</sup> St West (between Kellogg & Maple) estimate. Thank you for your help.

<< File: Est167thSt.xlsx >>

**Carl R. Haas, PE**  
Dept. of Public Works, Engineering Division  
City of Wichita  
Phone: 316-268-4505 Fax: (316) 858-7426  
[chaas@wichita.gov](mailto:chaas@wichita.gov)

## Haas, Carl

---

**From:** Armour, James  
**Sent:** Thursday, April 24, 2008 2:09 PM  
**To:** Haas, Carl  
**Subject:** RE: 167th - Goddard schools

thanks Carl. I'll be out Friday but will use it first thing Monday.

---

**From:** Haas, Carl  
**Sent:** Thursday, April 24, 2008 1:15 PM  
**To:** Armour, James  
**Cc:** Janzen, Gary; Gunzelman, Paul  
**Subject:** RE: 167th - Goddard schools

Jim-  
I'll have it before end of day tomorrow.  
Carl

---

**From:** Armour, James  
**Sent:** Thursday, April 24, 2008 1:03 PM  
**To:** Janzen, Gary; Haas, Carl; Gunzelman, Paul  
**Subject:** RE: 167th - Goddard schools

OK, I think we'll need these ready by the first of next week. Carl, any idea on cost yet??

---

**From:** Janzen, Gary  
**Sent:** Thursday, April 24, 2008 12:53 PM  
**To:** Armour, James; Haas, Carl; Gunzelman, Paul  
**Subject:** RE: 167th - Goddard schools

Carl is working on cost estimates now. Andy drew up a display that would show the following, which I think everyone said is the most practical now (?) –

- 1.) Improvements at Kellogg, including wbound RTL, some paving to the south, and signals
- 2.) 3 lanes on all legs at Maple, plus signals
- 3.) Full 3 lanes between school entrances, basically, with NO signal planned

Focus was/is on this, will be ready soon. Full 4 and 5 lane estimates are easy to do off of recent bids for other arterial streets.

---

**From:** Armour, James  
**Sent:** Thursday, April 24, 2008 11:17 AM  
**To:** Janzen, Gary; Haas, Carl; Gunzelman, Paul  
**Subject:** 167th - Goddard schools

I need an update on this. Have we gotten cost estimates developed for 3,4 and 5 lane options? And timelines for each alternate. Paul, do we have to do a guess at the traffic volumes.? I need to be getting back with them on this. They are calling wanting to know.

## Gunzelman, Paul

---

**From:** Rob Hartman [Rob.Hartman@pec1.com]  
**Sent:** Thursday, August 07, 2008 4:41 PM  
**To:** Gunzelman, Paul  
**Cc:** Brian Boutwell  
**Subject:** Goddard School 2nd Addition  
**Attachments:** Goddard School turn lane estimate.pdf

Paul- We are doing the estimate for the left turn lane petition for this plat and want to verify that what we have estimated is what you want. We have a 12' center turn lane that is 1750' long based on the concept drawing you gave me. I am attaching our estimate. Can you check it over and see if this is what you want.

Rob Hartman  
Professional Engineering Consultants, P.A.  
303 S. Topeka  
Wichita, Kansas 67202  
Ph. 316-262-2691  
Fax 316-262-3003

**Professional Engineering  
Consultants, P.A.**  
303 S. Topeka  
Wichita, Kansas 67202  
Phone (316) 262-2691

**GODDARD SCHOOLS 2ND ADDITION  
LEFT TURN LANE PAVING**

**PEC PROJECT NO. 36-07748-**

Prepared by: BDB  
Estimate Date: 8/7/2008

**PETITION ESTIMATE - LEFT TURN LANE PAVING & INCIDENTAL DRAINAGE**

ITEM	DESCRIPTION	QUANTITY	UNIT	UNIT PRICE	COST
1	7" A.C. Pavement (5" Bit. Base)	2,500	SY	\$ 18.00	\$ 45,000.00
2	8" Reinf. Crushed Rock Base	2,500	SY	<del>\$ 9.00</del> 9.00	\$ 22,500.00
3	7" RC Valley Gutter	250	SY	\$ 40.00	\$ 10,000.00
4	✓ Asphalt Pavement Removed	1,000	SY	<del>\$ 7.00</del> 5.00	\$ 7,000.00
5	Erosion Control	1	LS	\$ 3,000.00	\$ 3,000.00
6	Temporary Project Seeding	1	AC	\$ 900.00	\$ 900.00
7	Permanent Project Seeding	1	AC	\$ 1,200.00	\$ 1,200.00
8	Earthwork	4,000	CY	\$ 2.50	\$ 10,000.00
9	✗ Signing	1	LS	\$ 1,500.00	\$ 1,500.00
10	Pavement Marking	1	LS	\$ 5,000.00	\$ 5,000.00
11	Site Clearing & Restoration	1	LS	\$ 10,000.00	\$ 10,000.00

Total Construction Estimate \$ 116,100.00  
 15% Contingency\* \$ 17,415.00  
 30% Project Costs \$40,054.50  
**Total Project Costs \$173,569.50**

\*Misc Grading & Culvert Work

Petition Amount \$175,000.00

16,000

MOBILIZATION

**Intersection of Maple & 167th St West**

	QUANTITIES		UNIT PRICE	Three Lane Totals	
<b>Lump Sum Bid Items - Paving</b>					
1	Mobilization	1	LS	16,000.00	16,000.00
2	Site Clearing & Restoration	1	LS	20,000.00	20,000.00
3	Excavation	740	cy	15.00	11,100.00
4	Compaction of Earthwork	200	cy	2.50	500.00
5	AC Pvmt Removed	940	sy	4.50	4,230.00
6	Concr & AC Drive Pvmt Removed	220	sy	4.50	990.00
7	2" Asphalt Surface (BM-2)	10,667	sy	7.00	74,666.67
8	5" Bit Base (BM-2)	4,267	sy	17.00	72,533.33
9	Cold Milling (2" Max.)	6,400	sy	2.85	18,240.00
10	7" Reinf. Crushed Rock Base	5,333	sy	15.00	80,000.00
11	2' Wide Gravel Shoulder (AS-1)	2,400	lf	2.75	6,600.00
13	Project Seeding/Erosion Mat	1	LS	4,830.00	4,830.00
<b>Lump Sum Bid Items - Traffic</b>					
19	Constr. Traffic Control	1	LS	12,000.00	12,000.00
20	Pvmt Marking & Signage	1	LS	3,275.00	3,275.00
21	Traffic Signalization	1	LS	60,000.00	60,000.00
<b>Measured Quantity Bid Items - Paving</b>					
22	5" AC Drive Hookup	83	sy	15.00	1,245.00
23	8" Reinf Concr Drive Hookup	1,000	sf	6.50	6,500.00
<b>Measured Quantity Bid Items - Erosion Control</b>					
24	Hay Bale Ditch Check	6	ea	50.00	300.00
25	Silt Fence	100	lf	1.00	100.00
Item Totals				393,110.00	
20% Contingency				78,622.00	
20% Design & Engrg				78,622.00	
Intersection Totals				550,354.00	

**New School Entrance Widening**

	QUANTITIES		UNIT PRICE	Three Lane Totals	
<b>Lump Sum Bid Items - Paving</b>					
1	Mobilization	1	LS	16,000.00	16,000.00
2	Site Clearing & Restoration	1	LS	20,000.00	20,000.00
3	Excavation	740	cy	15.00	11,100.00
4	Compaction of Earthwork (Type B) (MR-90)	200	cy	2.50	500.00
5	AC Pvmt Removed	940	sy	4.50	4,230.00
6	Concr & AC Drive Pvmt Removed	220	sy	4.50	990.00
7	2" Asphalt Surface (BM-2)	7,733	sy	7.00	54,131.00
8	5" Bit Base (BM-2)	3,093	sy	17.00	52,581.00
9	Cold Milling (2" Max.)	4,640	sy	2.85	13,224.00
10	7" Reinf. Crushed Rock Base	3,867	sy	15.00	58,005.00

11	2' Wide Gravel Shoulder (AS-1)	1,740	lf	2.75	4,785.00
13	Project Seeding/Erosion Mat	1	LS	4,830.00	4,830.00
<b>Lump Sum Bid Items - Traffic</b>					
19	Constr. Traffic Control	1	LS	12,000.00	12,000.00
20	Pvmt Marking & Signage	1	LS	3,275.00	3,275.00
21	Traffic Signalization	1	LS	60,000.00	60,000.00
<b>Measured Quantity Bid Items - Paving</b>					
22	5" AC Drive Hookup	83	sy	15.00	1,245.00
23	8" Reinf Concr Drive Hookup	1,000	sf	6.50	6,500.00
<b>Measured Quantity Bid Items - Erosion Control</b>					
24	Hay Bale Ditch Check	6	ea	50.00	300.00
25	Silt Fence	100	lf	1.00	100.00
Item Totals					323,796.00
20% Contingency					64,759.20
20% Design & Engrg					64,759.20
Entrance Total					453,314.40

*2,637,961.00*

**Intersection of Kellogg & 167th St**

		QUANTITIES		UNIT PRICE	Three Lane Totals
<b>Lump Sum Bid Items - Paving</b>					
1					
2	Paving	1	LS	100,000.00	100,000.00
3					
<b>Lump Sum Bid Items - Traffic</b>					
19					
21	Traffic Signalization	1	LS	150,000.00	150,000.00
21					
Item Totals					250,000.00
20% Contingency					50,000.00
20% Design & Engrg					50,000.00
Kellogg Total					350,000.00

**Project Total**

**1,353,668.40**

**STAFF REPORT**  
**(One-Step Final Plat)**

**CASE NUMBER:** SUB 2008-56 – GODDARD SCHOOL 2<sup>ND</sup> ADDITION

**OWNER/APPLICANT:** USD 265 Goddard Public Schools, 201 S. Main, Goddard, KS 67052

**SURVEYOR/AGENT:** Professional Engineering Consultants, P.A., 303 S. Topeka, Wichita, KS 67202

**LOCATION:** North side of Kellogg, East side of 167<sup>th</sup> St. West (District V)

**SITE SIZE:** 133 acres

**NUMBER OF LOTS**

Residential:	1
Office:	
Commercial:	
Industrial:	
Total:	1

**MINIMUM LOT AREA:** 133 acres

**CURRENT ZONING:** SF-5 Single-family Residential

**PROPOSED ZONING:** Same

**VICINITY MAP**

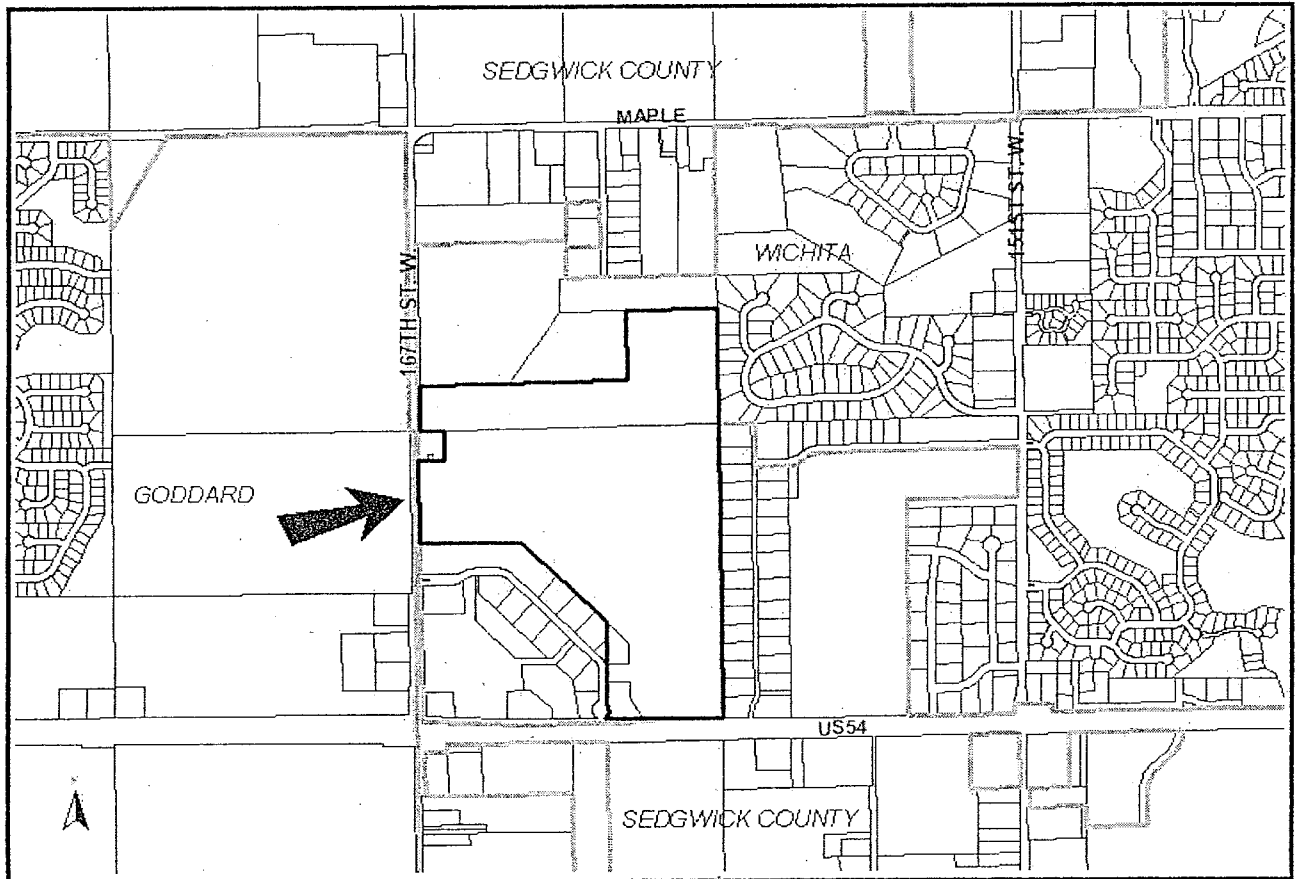

SUB 2008-56 – One-Step Final Plat of GODDARD SCHOOL 2<sup>ND</sup> ADDITION  
July 31, 2008 - Page 2

NOTE: This is an unplatted site located within the City.

STAFF COMMENTS:

- A. The applicant shall guarantee the extension of City water and sanitary sewer (mains and laterals) to serve the lots being platted.
- B. If improvements are guaranteed by petition(s), a notarized certificate listing the petition(s) shall be submitted to the Planning Department for recording.
- C. City Engineering needs to comment on the status of the applicant's drainage plan.
- D. County Fire Department and Traffic Engineering have requested right and left turn lanes.
- E. The plat proposes two openings along 167<sup>th</sup> St. West. Traffic Engineering has approved the access controls, however the complete access control along Kellogg should be extended along the entire south line of the plat. Access controls shall be referenced in the plat's text.
- F. As depicted on the site plan, a cross-lot access agreement with the property to the north shall be provided.
- G. The applicant shall submit a copy of the instrument, which establishes the pipeline easements on the property, which verifies that the easements shown are sufficient and that utilities may be located adjacent to and within the easements. Any relocation, lowering or encasement of the pipeline, required by this development, will not be at the expense of the appropriate governing body.
- H. The recording information for all pipeline easements shall be indicated on the face of the plat.
- I. The plat's text shall include language that a drainage plan has been developed for the plat and that all drainage easements, rights-of-way, or reserves shall remain at established grades or as modified with the approval of the applicable City or County Engineer, and unobstructed to allow for the conveyance of stormwater.
- J. The applicant shall install or guarantee the installation of all utilities and facilities that are applicable and described in Article 8 of the MAPC Subdivision Regulations. (Water service and fire hydrants required by Article 8 for fire protection shall be as per the direction and approval of the Chief of the Fire Department.)
- K. The Register of Deeds requires all names to be printed beneath the signatures on the plat and any associated documents.
- L. To receive mail delivery without delay, and to avoid unnecessary expense, the applicant is advised of the necessity to meet with the United States Postal Service Growth Management Coordinator (Phone: 316-946-4556) prior to development of the plat so that the type of delivery, and the tentative mailbox locations can be determined.
- M. The applicant is advised that various State and Federal requirements (specifically but not limited to the Army Corps of Engineers, Kanopolis Project Office, Rt. 1, Box 317, Valley Center, KS 67147) for the control of soil and wind erosion and the protection of wetlands may impact how this site can be developed. It is the applicant's responsibility to contact all appropriate agencies to determine any such requirements.
- N. The owner of the subdivision should note that any construction that results in earthwork activities that will disturb one (1) acre or more of ground cover requires a Federal/State National Pollutant Discharge Elimination System Storm Water Discharge Permit from the Kansas Department of Health and Environment in Topeka. Also, for projects located within the City of Wichita, erosion and sediment control devices must be used on ALL projects. For projects outside of the City of Wichita, but within the Wichita Metropolitan area, the owner should contact the appropriate governmental jurisdiction concerning erosion and sediment control device requirements.
- O. Perimeter closure computations shall be submitted with the final plat tracing.
- P. The representatives from the utility companies should be prepared to comment on the need for any additional utility easements to be platted on this property.
- Q. A compact disc (CD), which will be used by the City and County GIS Departments, detailing the final plat in digital format in AutoCAD. If a disc is not provided, please send via e-mail to Cheryl Holloway (E-Mail address: [cholloway@wichita.gov](mailto:cholloway@wichita.gov)). Please include the name of the plat on the disc.