

FINAL TRACING RECORD

LEDGESTONE ADDITION

Wichita, Sedgwick County, Kansas

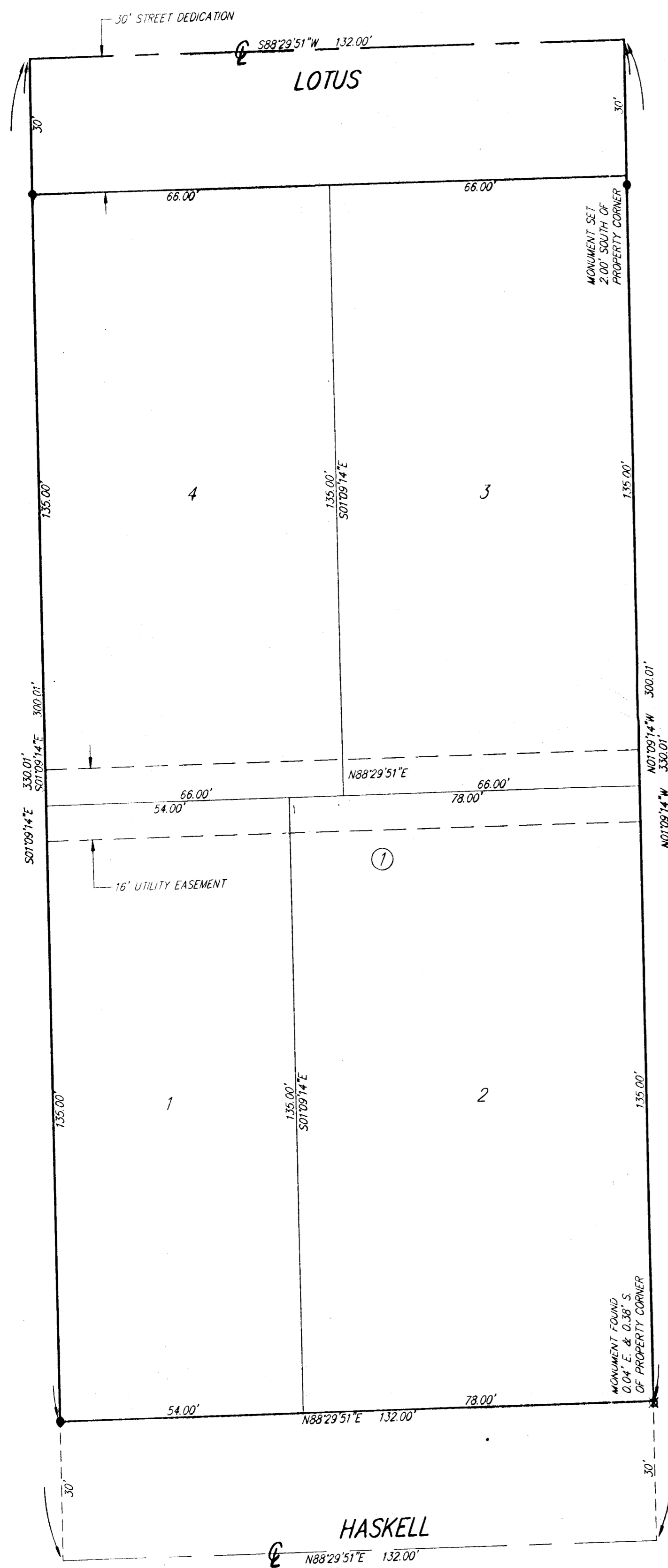

1" = 20'

M = Measured
 C = Calculated
 D = Described

SURVEY MARKER LEGEND

- 1/2" IRON PIPE IN THIMBLE (FOUND - ORIGIN UNKNOWN)
- ⊗ 1/2" IRON PIPE (FOUND - ORIGIN UNKNOWN)
- ∇ CHISELED V NOTCH (FOUND - ORIGIN UNKNOWN)
- 1/2" REBAR W/ RUGGLES & BOHM CAP (SET)

BENCH MARK: CHISELED SQUARE ON TOP OF CURB AT THE WEST CURB RETURN AT LYDIA
 * RITA. ELEVATION = 1289.62 (NGVD29)

ON-SITE BENCH MARK: CHISELED SQUARE ON TOP OF CURB AT THE NORTHEAST CORNER OF LOT 1, BLOCK B, ROBERTS-BRENNER-KLEIN ADDITION, WICHITA, SEDGWICK COUNTY, KANSAS
 ELEVATION = 1288.68 (NGVD29)

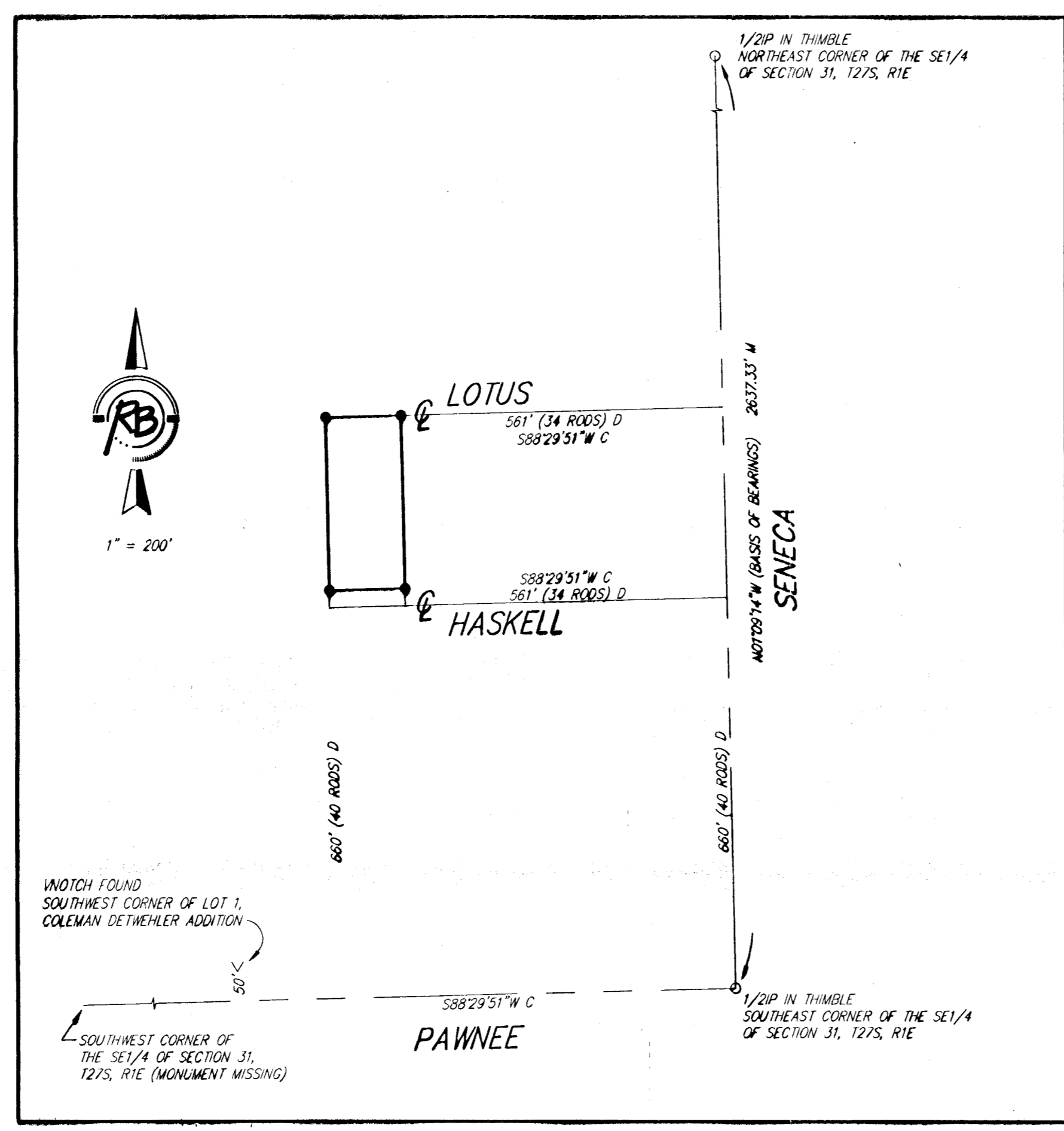

1" = 200'

State of Kansas) SS
Sedgwick County)

We, Ruggles & Bohm, P.A., Land Surveyors in aforesaid county and state, do hereby certify that, under the supervision of the undersigned, we have surveyed and platted "LEDGESTONE ADDITION", Wichita, Sedgwick County, Kansas, and that the accompanying plat is a true and correct exhibit of the property surveyed, described as follows:

A tract beginning 40 rods North and 34 rods West of the Southeast Corner of the Southeast Quarter of Section 31, Township 27 South, Range 1 East of the 6th P.M., Sedgwick County, Kansas; thence North 20 rods; thence West 8 rods; thence South 20 rods; thence East 8 rods to the point of beginning; except the South 30 feet thereof for road purposes.

All public easements and dedications are hereby vacated by virtue of K.S.A. 12-512(b).

Ruggles & Bohm, P.A.



Thomas C. Ruggles 11-26-08
 Land Surveyor
 Thomas C. Ruggles

Know all men by these presents that we, the undersigned, have caused the land described in the surveyor's certificate to be platted into Lots, a Block and a Street, to be known as "LEDGESTONE ADDITION", Wichita, Sedgwick County, Kansas. The street is hereby dedicated to and for the use of the public. Utility Easements are hereby granted for the construction and maintenance of all public utilities. A drainage plan has been developed for this plat; the property shall remain at established grades, or as modified with the approval of the City Engineer, and unobstructed to allow for the conveyance of storm water.

Ledgestone Homes, Inc., a Kansas limited liability company

Mark Murphy
 Mark Murphy, President

State of Kansas) SS
Sedgwick County)

The foregoing instrument acknowledged before me, this 5th day of January, 2009, by Mark Murphy, President, on behalf of Ledgestone Homes, Inc., a Kansas limited liability company.



Kristina L. Berg
 Notary Public

My appointment expires 9-25-2010

We the undersigned, holders of a mortgage on a portion of the above described property, do hereby consent to this plat of "LEDGESTONE ADDITION" Wichita, Sedgwick County, Kansas.

Legacy Bank, N.A.

Brian Hudson
 Brian Hudson, Vice President

State of Kansas) SS
Sedgwick County)

The foregoing instrument acknowledged before me this 6th day of January, 2009, by Brian Hudson, Vice President of Legacy Bank, N.A., on Behalf of the Bank.

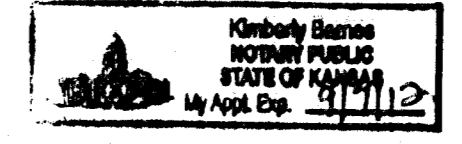

Kimberly Barnd
 Notary Public

My appointment expires 9/7/12

This plat of "LEDGESTONE ADDITION", Wichita, Sedgwick County, Kansas, has been submitted to and approved by the Wichita-Sedgwick County Metropolitan Area Planning Commission, Wichita, Kansas.

Dated this _____ day of _____, 200__
 Wichita-Sedgwick County Metropolitan Area Planning Commission

 Darrell Downing, Chair

 John L. Schlegel, Secretary

This plat approved and all dedications shown hereon accepted by the City Council of the City of Wichita, Kansas, this _____ day of _____, 200__.

At the Direction of the City Council
 _____ Mayor
 _____ City Clerk
 Karen Sublett

Reviewed in accordance with K.S.A. 58-2005 on this 2nd day of November, 2008.

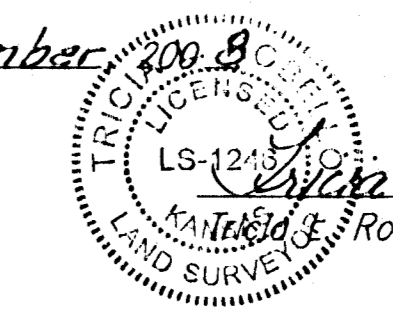

Kristina L. Robello
 Deputy County Surveyor
 Kristina L. Robello, LS #1246

Entered on transfer record this _____ day of _____, 200__.
 _____ County Clerk
 Kelly B. Arnold

State of Kansas) SS
Sedgwick County)

This is to certify that this plat has been filed for record in the office of the Register of Deeds, this _____ day of _____, 200__, at _____ o'clock _____ M, and is duly recorded.

 Bill Meek, Register of Deeds
 _____ Deputy
 Tonya Buckingham

DWG FILE: SURVEY BASE
 PROJECT NO. 3321P
 NOVEMBER 25, 2008

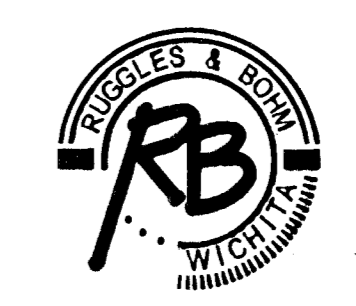

Ruggles & Bohm, P.A.
 Engineering, Surveying, Land Planning

924 North Main
 Wichita, Kansas 67203
 www.rbkansas.com
 (316) 264-8008
 (316) 264-4621 fax
 E-mail: info@rbkansas.com