

USD 259 5TH ADDITION WICHITA, SEDGWICK COUNTY, KANSAS

MURPHY ACRES LIP
SUITE 300
230 N. WILSON
WICHITA, KS 67202-1216
ZONED "SF-20"

MURPHY ACRES
SUITE 300
230 N. WILSON
WICHITA, KS 67202-1216
ZONED "SF-20"

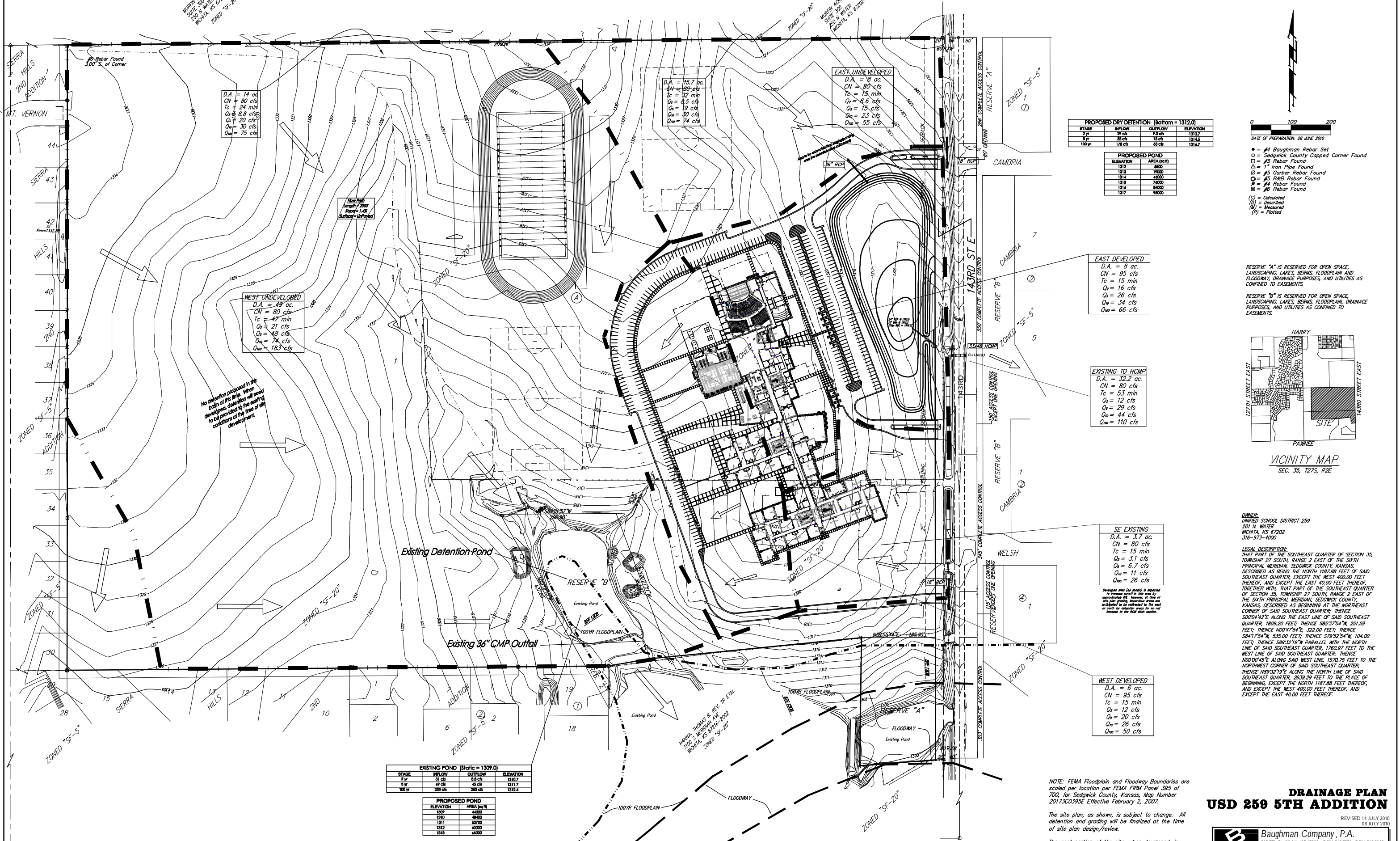

PROPOSED DRY DETENTION (Bottom = 1312.0)

STAGE	INFLOW	OUTFLOW	ELEVATION
2 yr	29 cfs	9.3 cfs	1313.7
5 yr	55 cfs	15 cfs	1314.6
100 yr	178 cfs	68 cfs	1314.7

PROPOSED POND

ELEVATION	AREA (sq ft)
1312	680
1313	1900
1314	4500
1315	7450
1316	9400
1317	9600

EAST DEVELOPED

D.A. = 8 ac
CN = 95 cfs
Tc = 15 min
Qs = 16 cfs
Qd = 26 cfs
Qw = 34 cfs
Qm = 66 cfs

EXISTING TO HCMF

D.A. = 32.2 ac
CN = 80 cfs
Tc = 53 min
Qs = 12 cfs
Qd = 29 cfs
Qw = 44 cfs
Qm = 110 cfs

SE EXISTING

D.A. = 3.7 ac
CN = 80 cfs
Tc = 15 min
Qs = 3.1 cfs
Qd = 6.7 cfs
Qw = 11 cfs
Qm = 26 cfs

WEST DEVELOPED

D.A. = 6 ac
CN = 95 cfs
Tc = 15 min
Qs = 12 cfs
Qd = 20 cfs
Qw = 26 cfs
Qm = 50 cfs

EXISTING POND (Static = 1309.0)

STAGE	INFLOW	OUTFLOW	ELEVATION
2 yr	31 cfs	8.8 cfs	1310.7
5 yr	49 cfs	14 cfs	1311.7
100 yr	283 cfs	283 cfs	1312.4

PROPOSED POND

ELEVATION	AREA (sq ft)
1309	4600
1310	4900
1311	5200
1312	6000
1313	4500

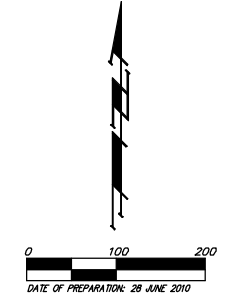

- = #4 Baughman Rebar Set
 - = Sedgwick County Capped Corner Found
 - = #5 Rebar Found
 - △ = 1" Iron Pipe Found
 - ◇ = #5 Galvanized Rebar Found
 - ⊙ = #5 R&B Rebar Found
 - ⊗ = #4 Rebar Found
 - ⊘ = #6 Rebar Found
- (C) = Calculated
(D) = Described
(M) = Measured
(P) = Plotted

RESERVE "A" IS RESERVED FOR OPEN SPACE, LANDSCAPING, LAKES, BERMS, FLOODPLAIN AND FLOODWAY, DRAINAGE PURPOSES, AND UTILITIES AS CONFINED TO EASEMENTS.

RESERVE "B" IS RESERVED FOR OPEN SPACE, LANDSCAPING, LAKES, BERMS, FLOODPLAIN, DRAINAGE PURPOSES, AND UTILITIES AS CONFINED TO EASEMENTS.

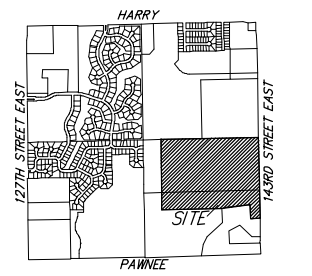

VICINITY MAP
SEC. 35, T27S, R2E

OWNER:
UNIFIED SCHOOL DISTRICT 259
201 N. WATER
WICHITA, KS 67202
316-973-4000

LEGAL DESCRIPTION:
THAT PART OF THE SOUTHEAST QUARTER OF SECTION 35, TOWNSHIP 27 SOUTH, RANGE 2 EAST OF THE SIXTH PRINCIPAL MERIDIAN, SEDGWICK COUNTY, KANSAS, DESCRIBED AS BEING THE NORTH 187.88 FEET OF SAID SOUTHEAST QUARTER, EXCEPT THE WEST 400.00 FEET THEREOF, AND EXCEPT THE EAST 40.00 FEET THEREOF, TOGETHER WITH THAT PART OF THE SOUTHEAST QUARTER OF SECTION 35, TOWNSHIP 27 SOUTH, RANGE 2 EAST OF THE SIXTH PRINCIPAL MERIDIAN, SEDGWICK COUNTY, KANSAS, DESCRIBED AS BEGINNING AT THE NORTHEAST CORNER OF SAID SOUTHEAST QUARTER; THENCE S00°04'42"E ALONG THE EAST LINE OF SAID SOUTHEAST QUARTER, 1829.20 FEET; THENCE S85°17'54"W, 251.59 FEET; THENCE N00°47'54"E, 322.00 FEET; THENCE S84°17'54"W, 538.00 FEET; THENCE S79°52'54"W, 104.00 FEET; THENCE S89°32'19"W PARALLEL WITH THE NORTH LINE OF SAID SOUTHEAST QUARTER, 1760.97 FEET TO THE WEST LINE OF SAID SOUTHEAST QUARTER; THENCE N00°00'45"E ALONG SAID WEST LINE, 1570.75 FEET TO THE NORTHEAST CORNER OF SAID SOUTHEAST QUARTER; THENCE N89°32'19"E ALONG THE NORTH LINE OF SAID SOUTHEAST QUARTER, 2639.29 FEET TO THE PLACE OF BEGINNING, EXCEPT THE NORTH 187.88 FEET THEREOF, AND EXCEPT THE WEST 400.00 FEET THEREOF, AND EXCEPT THE EAST 40.00 FEET THEREOF.

NOTE: FEMA Floodplain and Floodway Boundaries are scaled per location per FEMA FIRM Panel 395 of 700, for Sedgwick County, Kansas, Map Number 20173CD395E Effective February 2, 2007.

The site plan, as shown, is subject to change. All detention and grading will be finalized at the time of site plan design/review.

The west portion of the site, when developed, is expected to handle detention at that time.

DRAINAGE PLAN USD 259 5TH ADDITION

REVISED 14 JULY 2010
08 JULY 2010

Baughman Company, P.A.
315 Ellis St. Wichita, KS 67211 P 316-262-7271 F 316-262-0149

Baughman ENGINEERING | SURVEYING | PLANNING | LANDSCAPE ARCHITECTURE

E:\PROJECTS\USD2594THADDITION\USD2594TH.PDWG\RCR

PAWNEE