

**LEGAL DESCRIPTION**

A tract of land lying in the West portion of Lot 5, Block 1, Legacy Park Wilson Estates Addition, to Wichita, Sedgwick County, Kansas; said tract of land being more particularly described as follows:  
 BEGINNING at the Southwest most corner of said Lot 5, thence along the Westerly line of said Lot 5 for the next 5 courses on a platted basis of bearings N32°35'10"W, 45.00 feet to a point on a curve to the right; thence along the said curve and said Westerly line 210.37 feet, said curve having a central angle of 31°46'03", a radius of 379.43 feet, and a long chord distance of 207.69 feet, bearing N16°42'08"W; thence N00°49'07"W, 279.24 feet to a point on a curve to the right; thence along the said curve 192.88 feet, said curve having a central angle of 48°31'53", a radius of 227.71 feet, and a long chord distance of 187.16 feet, bearing N23°26'50"E; thence N47°42'45"E, 160.40 feet to the Northwest corner of said Lot 5; thence along the North line of said Lot 5, N89°05'19"E, 104.81 feet; thence S00°12'19"W, 177.41 feet; thence S11°23'09"E, 196.10 feet; thence S15°30'03"W, 61.05 feet; thence S18°59'13"E, 88.43 feet; thence S29°51'11"E, 100.14 feet; thence S57°24'50"W, 368.38 feet to the POINT OF BEGINNING.

Said tract CONTAINS: 214,700 square feet or 4.93 acres of land, more or less.

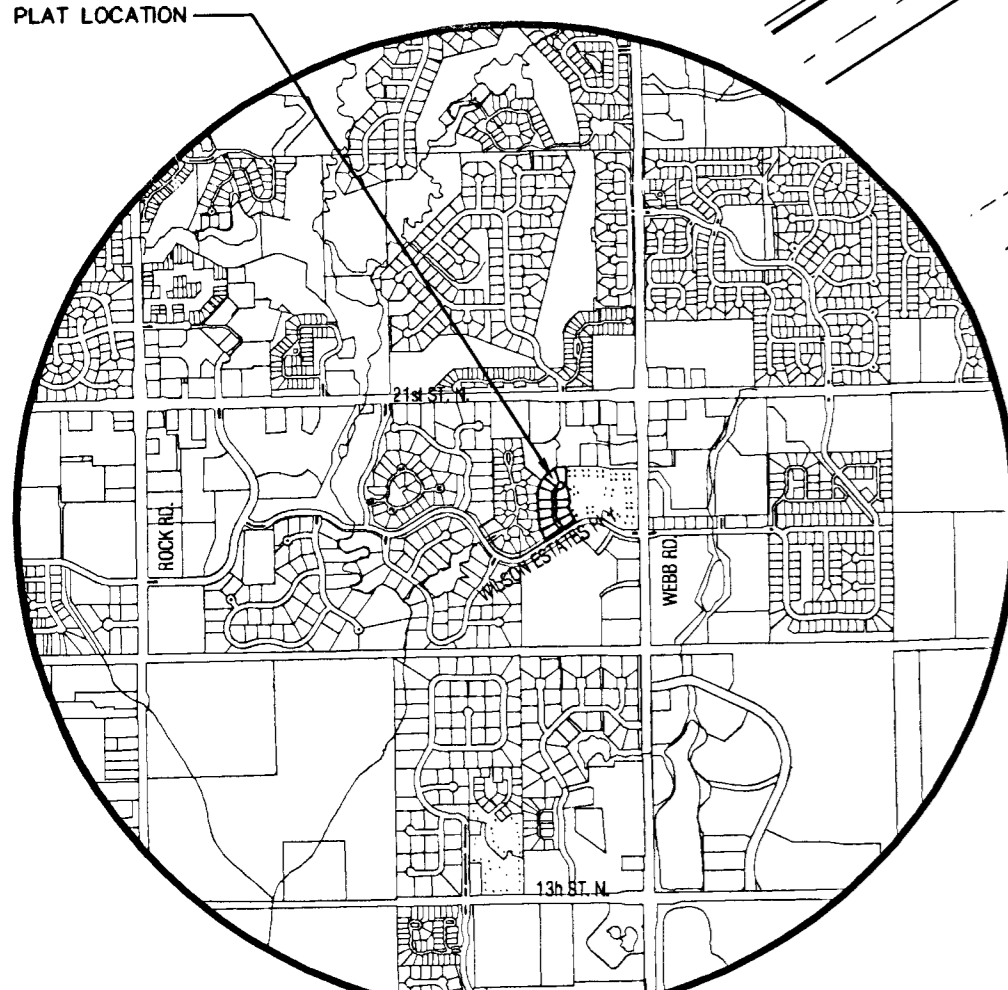

**VICINITY MAP**

**PRELIMINARY PLAT**  
**LEGACY PARK WILSON ESTATES 3RD ADDITION**

OWNER / DEVELOPER: C.V.C. Wichita Associates, L.L.C. c/o Ron Samples 7300 W. 110th St. Ste. 990 Overland Park, KS 66210 (913)-451-1300 **Date: January 23rd, 2006**

**MKEC**  
 ENGINEERING  
 CONSULTANTS, INC.  
 411 N. WEBB ROAD  
 WICHITA, KS. 67208  
 316-684-9600

**NOTES**

1. ZONING: CUP DP-201
2. PUBLIC UTILITIES: Shall be extended to site by petition
3. LEGAL DESCRIPTION: See hereon
4. EXISTING USE: Vacant Land
5. PLAT AREA: 4.93 AC
6. SURVEY DATE: April 2003 (by MKEC)
7. MINIMUM PADS: As shown on the Final Drainage Plan
8. LOT TOTAL (12)
9. RESERVES: "A", "B", and "C" are platted for sidewalks, landscaping, irrigation, open space, monuments, and water features.
10. Certain existing utilities and private pavement in conflict with the layout shall be removed and or relocated. The existing water line shall remain in its current placement.

**LEGEND**

- △ - Sec. Corner
- SN - SIGN
- G - GATE
- T - TREES
- - EDGE OF TREES
- P - POLE
- F - FENCE
- SS - STORM SEWER PIPE
- W - WATER LINE
- SS - SANITARY SEWER LINE
- G - GAS LINE
- UT - TELEPHONE LINE
- oe - OVERHEAD ELECTRIC
- ⊙ - End. Prop. Corner
- GM - GAS METER
- SSM - SANITARY SEWER MANHOLE
- PP - POWER POLE/GUY ANCHOR
- EB - ELECTRIC BOX
- FD - FIRE HYDRANT
- WV - WATER VALVE
- WM - WATER METER
- TR - TELEPHONE RISER

**BENCH MARKS**

- BM#4 - "C" Cut Top of RCB End Section at SE Cor. of Lot 23, Blk. 1, Brighton Courts Addition. Elev.= 197.07
- BM#5 - "C" Cut Top of Curb on the N. side of Wilson Estates Parkway at SE. Cor. of Brighton Courts Parkway Addition. Elev.= 197.07

