

STAFF REPORT
(One-Step Final Plat)

CASE NUMBER: SUB 2010-31 -- STRUNK ESTATES ADDITION

OWNER/APPLICANT: Frances M. Simon, 3153 Shelton, Wichita, KS 67204; (Contact purchasers) Diana and Jeff Strunk, 1946 N. 135th St. West, Wichita, KS 67235

SURVEYOR/AGENT: Baughman Company, P.A., 315 Ellis, Wichita, KS 67211

LOCATION: West of 231st St. West, South side of 53rd St. North (County District III)

SITE SIZE: 10 acres

NUMBER OF LOTS

Residential:	2
Office:	
Commercial:	
Industrial:	
Total:	2

MINIMUM LOT AREA: 4.5 acres

CURRENT ZONING: RR Rural Residential

PROPOSED ZONING: Same

VICINITY MAP

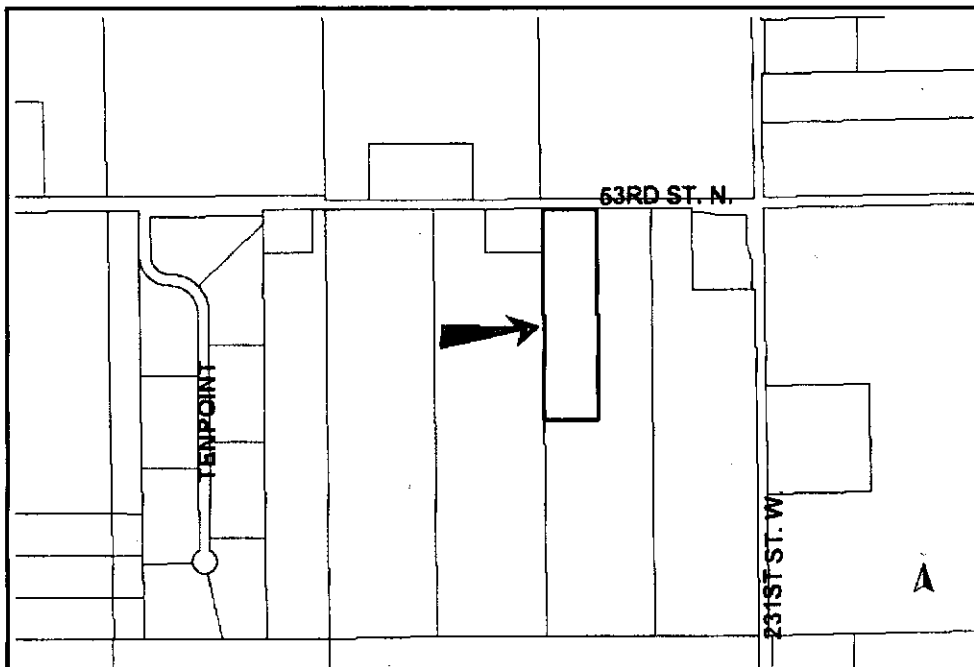

SUB 2010-31 -- One-Step Final Plat of STRUNK ESTATES ADDITION
June 10, 2010 - Page 2

NOTE: This site is located in the County in an area designated as "rural" by the Wichita-Sedgwick County Comprehensive Plan. It is located in the Andale Area of Influence.

The Subdivision Committee may recommend a modification of the design criteria in Article 7 of the Subdivision Regulations only if it finds that the strict application of the design criteria will create an unwarranted hardship; the proposed modification is in harmony with the intended purpose of the subdivision regulations and the public safety and welfare will be protected.

STAFF COMMENTS:

- A. Since neither sanitary sewer nor municipal water is available to serve this property, the applicant shall contact County Code Enforcement to find out what tests may be necessary and what standards are to be met for approval of on-site sewerage and water wells. A memorandum shall be obtained specifying approval.
- B. In conformance with the Urban Fringe Development Standards, for individual domestic wells that are proposed, a Safe Yield Analysis must be provided to Sedgwick County Code Enforcement to assure the availability of an adequate, safe supply of water that does not impair existing water rights. Easements shall be dedicated for potential future extension of public water and sewer.
- C. If improvements are guaranteed by petition(s), a notarized certificate listing the petition(s) shall be submitted to the Planning Department for recording.
- D. County Engineering needs a drainage plan.
- E. County Engineering recommends a utility easement on the east side of the plat.
- F. The plat denotes one opening along 53rd St. North. County Engineering recommends the applicant match the access break width with the width of the ingress/egress easement.
- G. Sedgwick County Fire Department advises that the plat should comply with the requirements of the Sedgwick County Service Drive Code.
- H. In accordance with the Kansas Wetland Mapping Conventions under the Memorandum of Understanding between the United States Department of Agriculture - Natural Resources Conservation Service; United States Environmental Protection Agency; United States Army Corps of Engineer (USACE); and United States Fish and Wildlife Service, this site has been identified as one with potential wetland hydrology. The USACE should be contacted (316-322-8247) to have a wetland determination completed.
- I. The joint access opening shall be established by separate instrument. Initial construction responsibilities and future maintenance of the driveway within the easement should also be addressed by the text of the instrument.
- J. The Applicant is reminded that a platting binder is required with the final plat. Approval of this plat will be subject to submittal of this binder and any relevant conditions found by such a review.
- K. The plat's text shall include language that a drainage plan has been developed for the plat and that all drainage easements, rights-of-way, or reserves shall remain at established grades or as modified with the approval of the applicable City or County Engineer, and unobstructed to allow for the conveyance of stormwater.
- L. The applicant shall install or guarantee the installation of all utilities and facilities that are applicable and described in Article 8 of the MAPC Subdivision Regulations. (Water service and fire hydrants required by Article 8 for fire protection shall be as per the direction and approval of the Chief of the Fire Department.)
- M. The Register of Deeds requires all names to be printed beneath the signatures on the plat and any associated documents.
- N. To receive mail delivery without delay, and to avoid unnecessary expense, the applicant is advised of the necessity to meet with the United States Postal Service Growth Management Coordinator (Phone: 316-946-4556) prior to development of the plat so that the type of delivery, and the tentative mailbox locations can be determined.
- O. The applicant is advised that various State and Federal requirements (specifically but not limited to the Army Corps of Engineers, Kanopolis Project Office, Rt. 1, Box 317, Valley Center, KS 67147) for the control of soil and wind erosion and the protection of wetlands may impact how this site can be developed. It is the applicant's responsibility to contact all appropriate agencies to determine any such requirements.

SUB 2010-31 -- One-Step Final Plat of STRUNK ESTATES ADDITION
June 10, 2010 - Page 3

- P. The owner of the subdivision should note that any construction that results in earthwork activities that will disturb one (1) acre or more of ground cover requires a Federal/State National Pollutant Discharge Elimination System Storm Water Discharge Permit from the Kansas Department of Health and Environment in Topeka. Also, for projects located within the City of Wichita, erosion and sediment control devices must be used on ALL projects. For projects outside of the City of Wichita, but within the Wichita Metropolitan area, the owner should contact the appropriate governmental jurisdiction concerning erosion and sediment control device requirements.
- Q. Perimeter closure computations shall be submitted with the final plat tracing.
- R. The representatives from the utility companies should be prepared to comment on the need for any additional utility easements to be platted on this property.
- S. A compact disc (CD) should be provided, which will be used by the City and County GIS Departments, detailing the final plat in digital format in AutoCAD. If a disc is not provided, please send the information via e-mail to Cheryl Holloway (E-Mail address: cholloway@wichita.gov). Please include the name of the plat on the disc.

CLOSURE-STRUNK ESTATES

CLOSURE-STRUNK ESTATES

Point of Beginning
 PT 01 Easting: 5000.0000'
 Northing: 10000.0000'

Side 1: Line
 Direction: N89° 46' 31.00"E
 Angle: [-090.2247 (d)]
 Deflection angle: [089.7753 (d)]
 Distance: 329.990'

PT 02 Easting: 5329.9875'
 Northing: 10001.2943'

Side 2: Line
 Direction: S00° 31' 48.00"E
 Angle: [-090.3053 (d)]
 Deflection angle: [089.6947 (d)]
 Distance: 659.960'

PT 03 Easting: 5336.0922'
 Northing: 9341.3625'

Side 3: Line
 Direction: S00° 32' 05.00"E
 Angle: [179.9953 (d)]
 Deflection angle: [-000.0047 (d)]
 Distance: 660.020'

PT 04 Easting: 5342.2518'
 Northing: 8681.3712'

Side 4: Line
 Direction: S89° 46' 53.00"W
 Angle: [-089.6839 (d)]
 Deflection angle: [090.3161 (d)]
 Distance: 329.990'

PT 05 Easting: 5012.2642'
 Northing: 8680.1122'

Side 5: Line
 Direction: N00° 32' 02.00"W
 Angle: [-090.3153 (d)]
 Deflection angle: [089.6847 (d)]
 Distance: 659.990'

PT 06 Easting: 5006.1144'
 Northing: 9340.0735'

Side 6: Line
 Direction: N00° 31' 51.00"W
 Angle: [-179.9969 (d)]
 Deflection angle: [000.0031 (d)]
 Distance: 659.950'

PT 01 Easting: 5000.0002'
 Northing: 9999.9952'

Closure Summary:
 Precision, 1 part in: 686434.431'
 Error distance: 0.005'
 Error direction: S02° 49' 28.02"E
 Area: 435561.52 Sq. Ft.
 Square area: 435561.525
 Perimeter: 3299.900'