

**STAFF REPORT
(One-Step Final Plat)**

CASE NUMBER: SUB 2008-40 – TANNER ADDITION

OWNER/APPLICANT: Estate of Lela Virginia Tanner, Dale L. Tanner, Executor, 8815 E. Hurst, Wichita, KS 67210

SURVEYOR/AGENT: Savoy Company, Attn: Mark Savoy, 433 S. Hydraulic, Wichita, KS 67211

LOCATION: North side of Harry Street, West of Greenwich (District II)

SITE SIZE: 1.66 acres

NUMBER OF LOTS

Residential:	
Office:	
Commercial:	1
Industrial:	
Total:	1

MINIMUM LOT AREA: 1.32 acres

CURRENT ZONING: SF-5 Single-family Residential

PROPOSED ZONING: NR Neighborhood Retail

VICINITY MAP

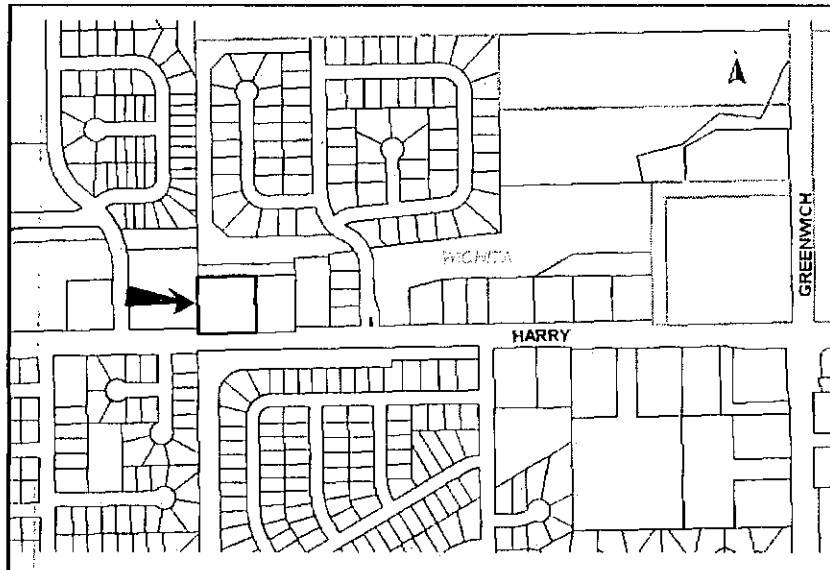

NOTE: This is an unplatted site located within the City. The site has been approved for a zone change (ZON 2008-15) from SF-5 Single-family Residential to NR, Neighborhood Retail subject to a Protective Overlay addressing permitted uses, density, and building height.

STAFF COMMENTS:

- A. Wichita Water Utilities Department has required the extension of sewer. Water is available, but in-lieu-of-assessment fees are needed for connections.
- B. If improvements are guaranteed by petition(s), a notarized certificate listing the petition(s) shall be submitted to the Planning Department for recording.
- C. City Engineering needs to comment on the status of the applicant's drainage plan.
- D. The plat proposes two openings along Harry. Traffic Engineering has approved one opening. Complete access control is needed along the west 170 feet.
- E. A Protective Overlay Certificate shall be submitted to MAPD prior to City Council consideration, identifying the approved Protective Overlay and its special conditions for development on this property.
- F. The platting binder indicates a party holding a mortgage on the site. This party's name must be included as a signatory on the plat, or else documentation provided indicating that such mortgage has been released.
- G. The plat's text shall include language that a drainage plan has been developed for the plat and that all drainage easements, rights-of-way, or reserves shall remain at established grades or as modified with the approval of the applicable City or County Engineer, and unobstructed to allow for the conveyance of stormwater.
- H. The applicant shall install or guarantee the installation of all utilities and facilities that are applicable and described in Article 8 of the MAPC Subdivision Regulations. (Water service and fire hydrants required by Article 8 for fire protection shall be as per the direction and approval of the Chief of the Fire Department.)
- I. The Register of Deeds requires all names to be printed beneath the signatures on the plat and any associated documents.
- J. To receive mail delivery without delay, and to avoid unnecessary expense, the applicant is advised of the necessity to meet with the United States Postal Service Growth Management Coordinator (Phone: 316-946-4556) prior to development of the plat so that the type of delivery, and the tentative mailbox locations can be determined.
- K. The applicant is advised that various State and Federal requirements (specifically but not limited to the Army Corps of Engineers, Kanopolis Project Office, Rt. 1, Box 317, Valley Center, KS 67147) for the control of soil and wind erosion and the protection of wetlands may impact how this site can be developed. It is the applicant's responsibility to contact all appropriate agencies to determine any such requirements.
- L. The owner of the subdivision should note that any construction that results in earthwork activities that will disturb one (1) acre or more of ground cover requires a Federal/State National Pollutant Discharge Elimination System Storm Water Discharge Permit from the Kansas Department of Health and Environment in Topeka. Also, for projects located within the City of Wichita, erosion and sediment control devices must be used on ALL projects. For projects outside of the City of Wichita, but within the Wichita Metropolitan area, the owner should contact the appropriate governmental jurisdiction concerning erosion and sediment control device requirements.
- M. Perimeter closure computations shall be submitted with the final plat tracing.
- N. The representatives from the utility companies should be prepared to comment on the need for any additional utility easements to be platted on this property.
- O. A compact disc (CD), which will be used by the City and County GIS Departments, detailing the final plat in digital format in AutoCAD. If a disc is not provided, please send via e-mail to Cheryl Holloway (E-Mail address: cholloway@wichita.gov). Please include the name of the plat on the disc.