

**BENCHMARKS**  
 BM #1: CITY OF MICHITA BENCHMARK  
 DISC 485' W & 28' N. OF E 21ST  
 STREET NORTH AND HOOPER STREET.  
 ELEV. = 1328.47 NGVD29  
 BM #2: RAIL ROAD SPIKE IN POWER  
 POLE 20' N. OF E 21ST STREET  
 NORTH ALONG THE WEST LINE OF  
 THE PLAT.  
 ELEV. = 1327.25 NGVD29

Sta 1+21.2, Line 3  
 Construct Std. Type 1A  
 Inlet (10"x4")  
 Top Elev. = 1328.10

Sta 2+10.1, End Line 3  
 Construct Standard  
 Manhole (5' Dia.)  
 1 - 24" RCP Stub (N)  
 Rfm Elev. = 1328.40

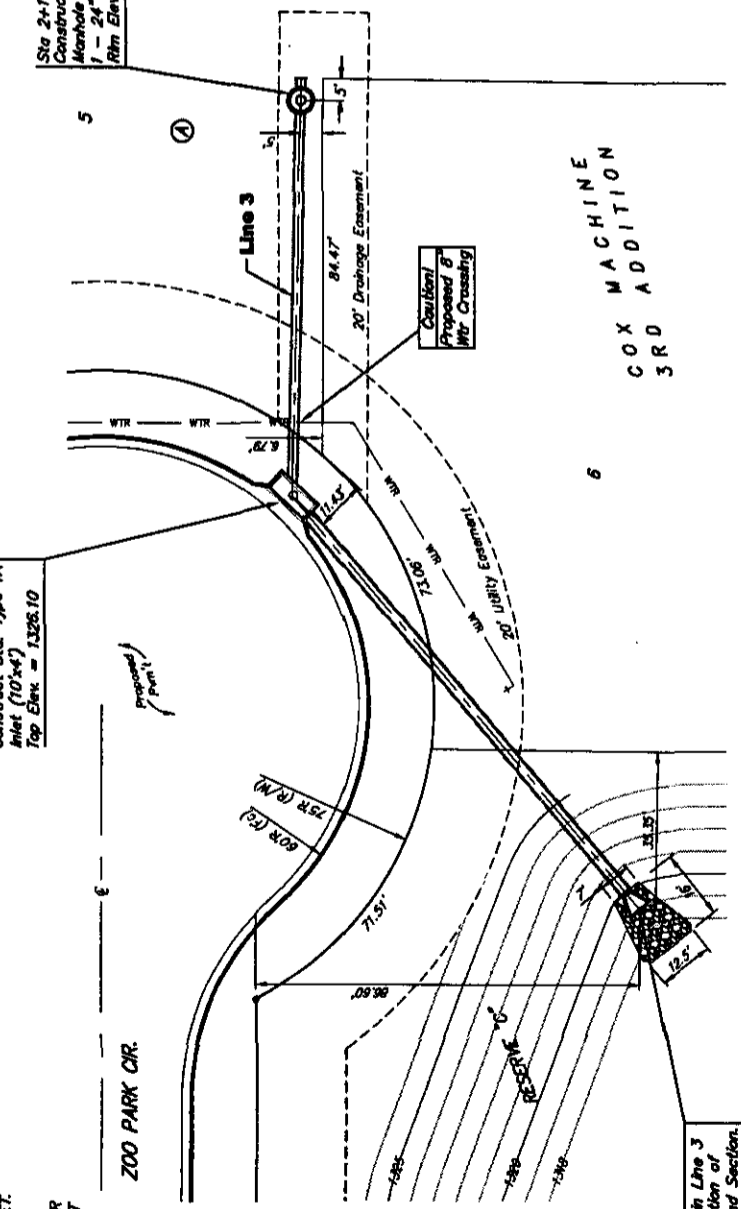
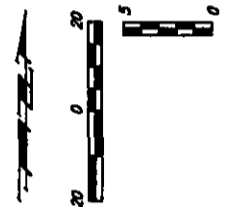

Sta 0+00, Begin Line 3  
 Begin Construction of  
 30" RCP w/ End Section  
 Restrain End Section to  
 First Joint of pipe  
 Install 17 S.Y.  
 Light-Stone Rip-rap

COX  
 MACHINE  
 3RD  
 ADDITION

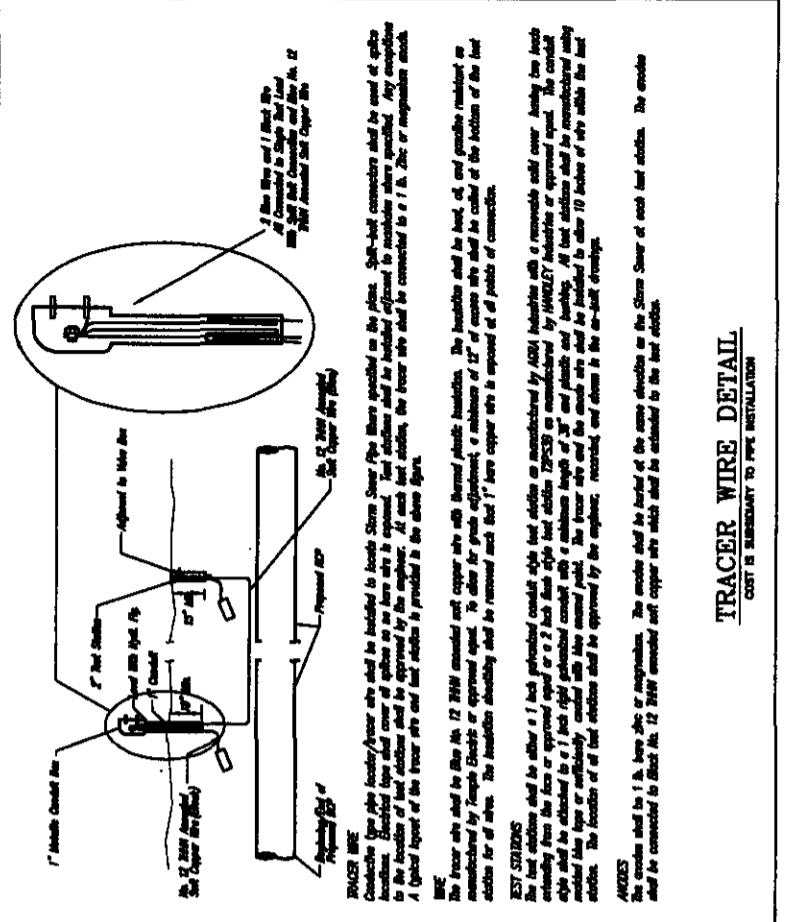

**TRACER WIRE DETAIL**  
 COIT IS NECESSARY TO PIPE INSTALLATION

**TRACER WIRE**  
 The tracer wire shall be installed to locate Storm Sewer Pipe when specified on the plans. Spot-weld connectors shall be used at all pipe locations. Electrical tape shall cover all wires as no bare wire is exposed. Lead sections shall be installed adjacent to manholes where specified. Any connection to the location of lead sections shall be approved by the engineer. At each lead section, the tracer wire shall be connected to a 1/8" dia. zinc or magnesium anode. A special report of the tracer wire lead section is provided in the above figure.

**NOTE**  
 The tracer wire shall be No. 12 BHN annealed soft copper wire with thermal plastic insulation. The insulation shall be lead, oil, and granular material as recommended by Temple Electric or approved equal. To allow for grade adjustment, a minimum of 12" of excess wire shall be coiled at the bottom of the lead section for all sites. The insulation sheathing shall be removed and the 12" bare copper wire is exposed at all points of connection.

**TEST SPECIFICATIONS**  
 The tracer wire shall be either 1/8 inch galvanized steel pipe with a removable end cover having two lead sections attached to the end of the pipe or 1/8 inch galvanized steel pipe with a removable end cover having two lead sections attached to the end of the pipe. The tracer wire shall be installed in a trench 18 inches or more wide with the lead sections. The location of lead sections shall be approved by the engineer, recorded, and shown in the as-built drawings.

**ACCESS**  
 The conduct shall be 1/8 inch dia. or equivalent. The conduct shall be tested at the same elevation as the Storm Sewer at each lead section. The conduct shall be connected to Sheet No. 12 20'x20' annealed soft copper wire which shall be attached to the lead section.

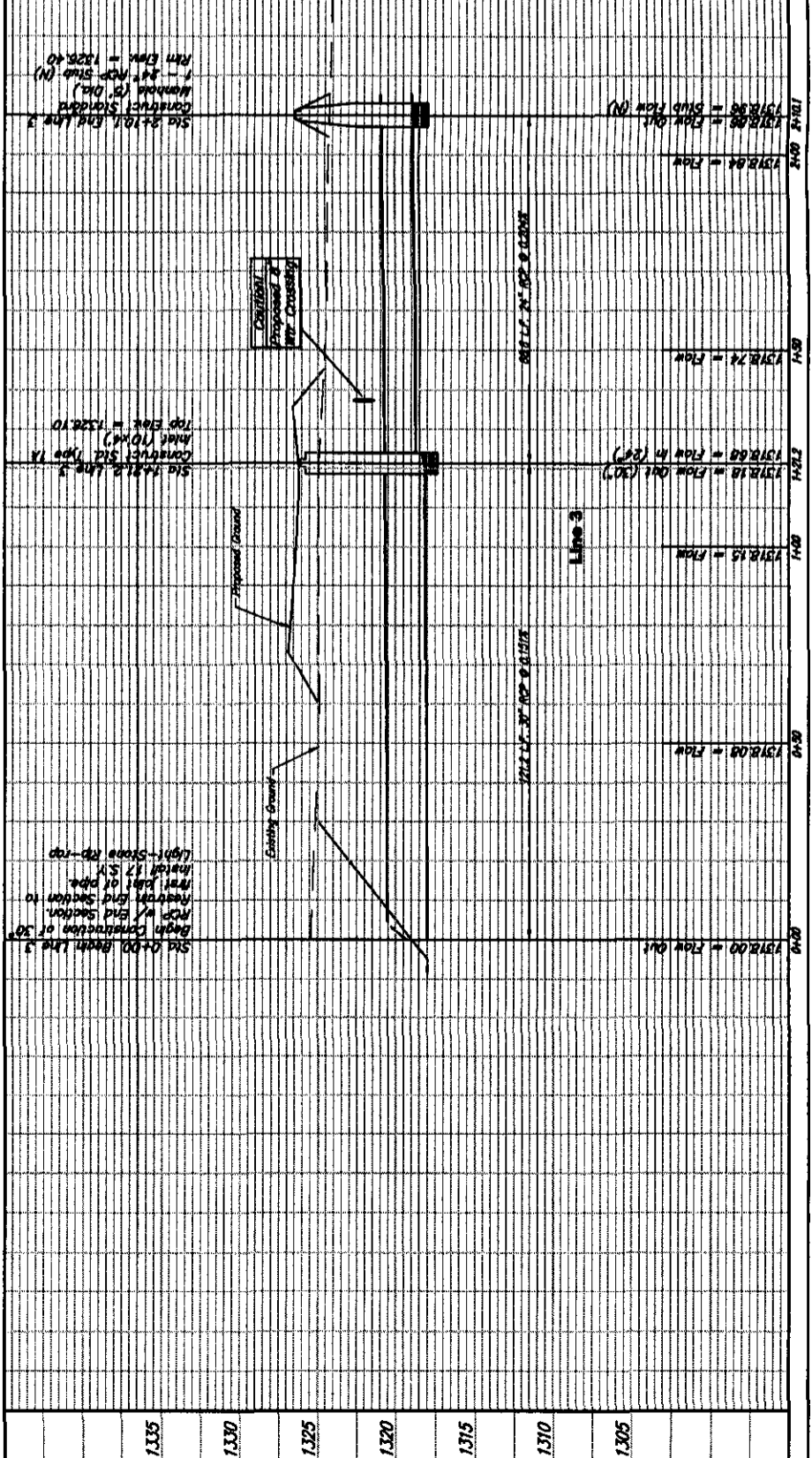

**Braughman**  
 City Machine 3rd Addition  
 Street Parking Improvements

PROJECT NUMBER: 472-2462  
 DRAWN BY: [Name]  
 CHECKED BY: [Name]  
 APPROVED BY: [Name]  
 DATE: 04-15-08

**Line 3**  
 10 OF 32