

DRAINAGE PLAN THE WOODS ADDITION WICHITA, SEDGWICK COUNTY, KANSAS

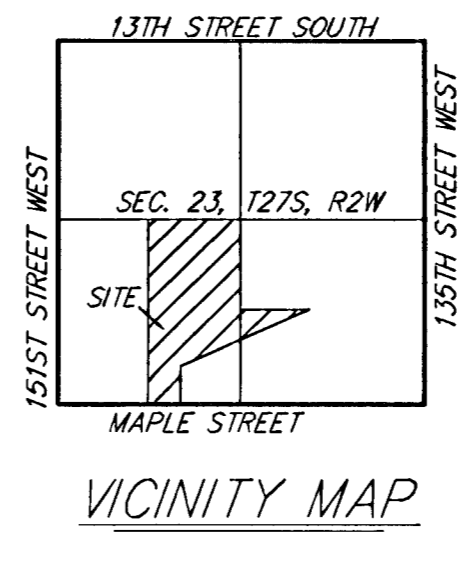
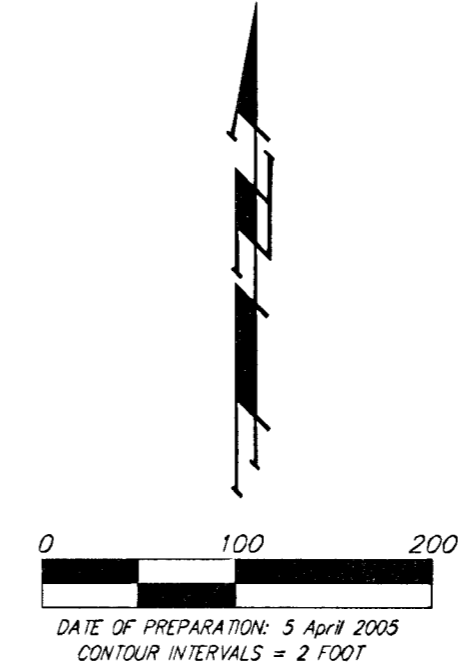
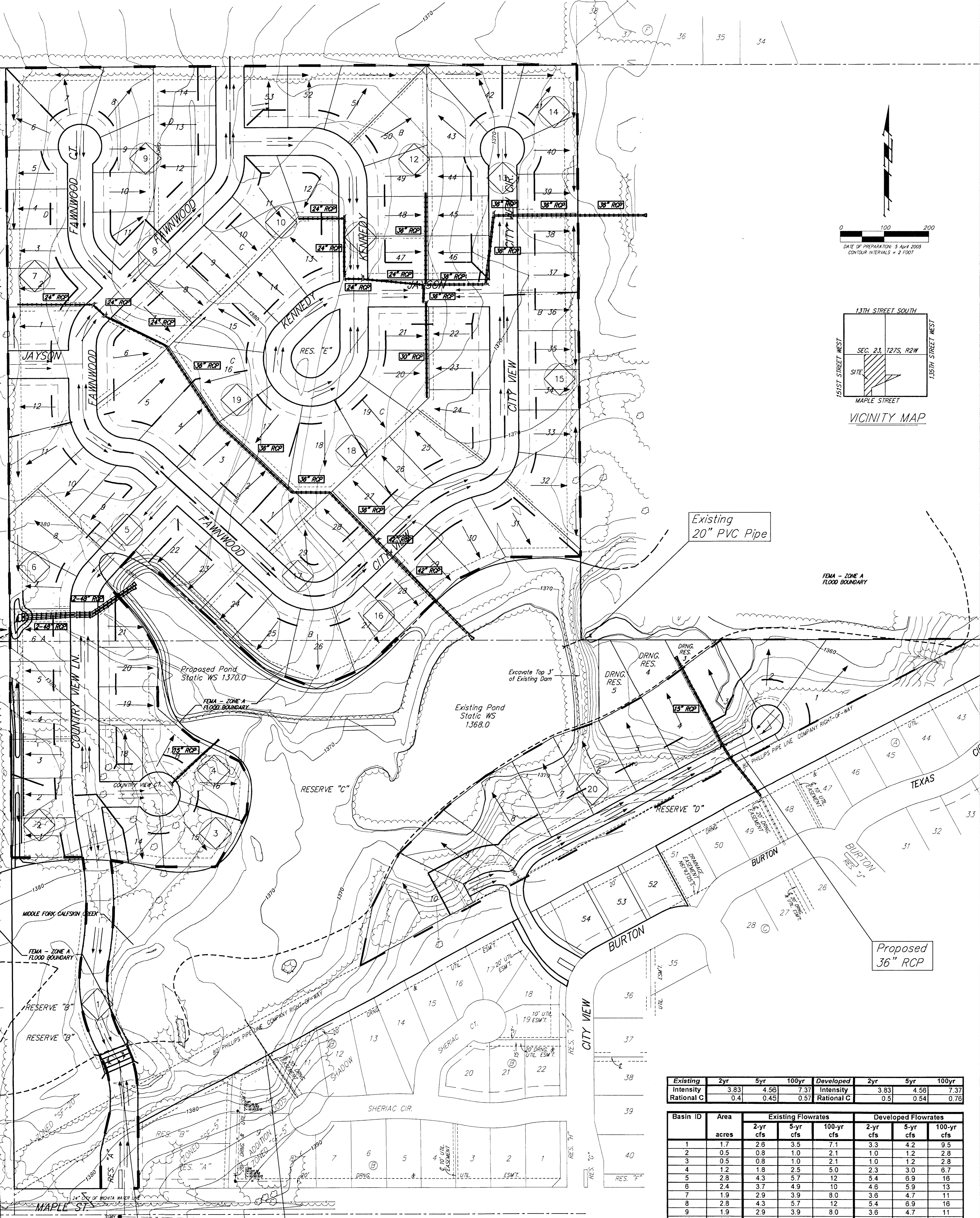

Existing
20" PVC Pipe

FEMA - ZONE A
FLOOD BOUNDARY

Proposed Pond
Static WS 1370.0

Excavate Top 3'
of Existing Dam

Existing Pond
Static WS 1368.0

Proposed
36" RCP

Offsite Flow
 $Q_{100} = 174$ cfs
DA = 78 acres
CN = 65
 $T_c = 44$ min

4-10x4 RCBC

Existing
15" RCP

Existing Intensity	2yr	5yr	100yr	Developed Intensity	2yr	5yr	100yr
Rational C	0.4	0.45	0.57	Rational C	0.5	0.54	0.76

Basin ID	Area acres	Existing Flowrates			Developed Flowrates		
		2-yr cfs	5-yr cfs	100-yr cfs	2-yr cfs	5-yr cfs	100-yr cfs
1	1.7	2.6	3.5	7.1	3.3	4.2	9.5
2	0.5	0.8	1.0	2.1	1.0	1.2	2.8
3	0.5	0.8	1.0	2.1	1.0	1.2	2.8
4	1.2	1.8	2.5	5.0	2.9	3.0	6.7
5	2.8	4.3	5.7	12	5.4	6.9	16
6	2.4	3.7	4.9	10	4.6	5.9	13
7	1.9	2.9	3.9	8.0	3.8	4.7	11
8	2.8	4.3	5.7	12	5.4	6.9	16
9	1.9	2.9	3.9	8.0	3.8	4.7	11
10	0.7	1.1	1.4	2.9	1.3	1.7	3.9
11	1.8	2.5	3.3	8.7	3.1	3.9	9.0
12	1.3	2.0	2.7	5.5	2.5	3.2	7.3
13	2.3	3.5	4.7	9.7	4.4	5.7	13
14	2.0	3.1	4.1	8.4	3.8	4.9	11
15	2.8	4.3	5.7	12	5.4	6.9	16
16	1.4	2.1	2.9	5.9	2.7	3.4	7.8
17	1.8	2.8	3.7	7.6	3.4	4.4	10
18	4.4	6.7	9	18	8.4	11	25
19	1.4	2.1	2.9	5.9	2.7	3.4	7.8
20	3.5	5.4	7.2	15	6.7	8.6	20
21	1.3	2.0	2.7	5.5	2.5	3.2	7.3
22	1.3	2.0	2.7	5.5	2.5	3.2	7.3
23	1.4	2.1	2.9	5.9	2.7	3.4	7.8
24	0.7	1.1	1.4	2.9	1.3	1.7	3.9
25	4.4	6.7	9	18	8.4	11	25
26	2.5	3.8	5.1	11	4.8	6.2	14

NOTE: FEMA Zone A Boundary scaled per FEMA FIRM Map Panel 200321 0200 A. Base Flood Elevations (BFE) were determined using HEC-RAS. Three applications for permit have been filed with the Kansas Department of Water Resources.