

Lot 9

LD HIGH
5.6'N & 0.7'W
of Prop. Iron

1/2" REBAR
W/SAVOY CAP 2.0'
EAST OF TRUE CORNER

N88°52'32"E 317'D&M
N88°52'32"E 284.99'M

Fence
3.0'N & 1.6'W
of Prop. Iron

30' Pipeline Esmt.
Arkansas Louisiana Gas Co.
Book 566, Page 261

Lot 10

Fence
5.5'N & 0.6'W
of Prop. Iron

Lot 11

N00°00'31"W 275.03'M
N00°E 275.01'D

Fence
0.7'E of
Prop. Line

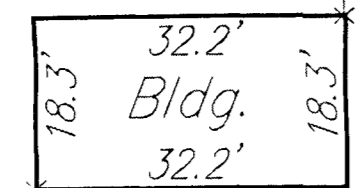

176.75 FINISH GRADE

First Floor
Elev. 177.00

26.8'

Garage Flr.
Elev. 177.0
FF 177.4

First Floor
Elev. 177.4

2811

EXISTING
HOUSE

28.8'

Walkout Bsmt.
Flr. Elev. 173.0

View Out
Elev. 176.7

Lot 12

Fence
0.2'W of
Prop. Line

S88°52'18"W 286.95'M

S88°52'32"W 317'D
S88°52'19"W 316.96'M

Fence
0.2'E & 2.7'S
of Prop. Iron

Fence
1.6'N of
Prop. Line

Tyler Road

S00°W 275.01'D&M

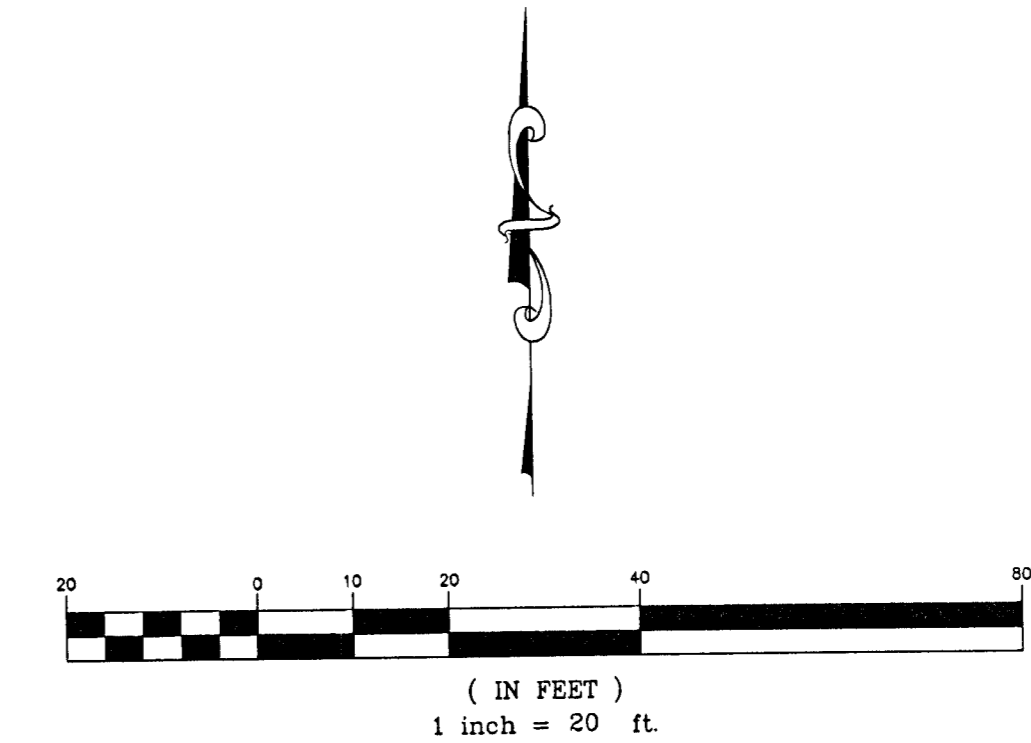

Trans-Net Addition
Site Plan
Wichita, Kansas



516 S. Market,
Wichita, KS 67202

316/284-0242

PROJECT NUMBER			
KEM NO. 08135	FILE Site	DATE 9/2008	SHEET 1
DESIGN KM	DRAWN NS	REVISED	OF 1