

FINAL PLAT
COUNTRY HOLLOW ADDITION
 AN ADDITION TO WICHITA, SEDGWICK COUNTY, KANSAS

We, MKEC Engineering Consultants, Inc., a Registered Corporate Land Surveyor in Kansas, do hereby certify that we have been in responsible charge of surveying and platting of "COUNTRY HOLLOW ADDITION" an addition to Wichita, Sedgwick County, Kansas, into Lots, Blocks, Reserves, and Streets, the same being accurately set forth in the accompanying plat and described herein:

A tract of land lying in the Northwest Quarter, Section 26, Township 27 South, Range 2 East, of the 6th Principal Meridian, Wichita, Sedgwick County, Kansas; said tract being more particularly described as follows:

BEGINNING at a point on the South line of said Northwest Quarter lying 30 feet East of the Southwest corner of said Quarter, thence parallel with and 30 feet east the West line of said Quarter on a Kansas South Zone Grid bearing of N00°44'22"W, 1358.02 feet; thence N89°15'49"E, 905.02 feet; thence N00°44'11"W, 744.43 feet; thence N88°43'30"E, 216.72 feet to the Southerly line of a tract described within Condemnation Case No. 91-C-879; thence along said Southerly line for the next four courses: S46°01'54"E, 282.80 feet; thence N88°58'04"E, 359.96 feet; thence N44°35'03"E, 657.59 feet; thence N67°26'30"E, 504.13 feet to the East line of said Quarter; thence along said East line S00°33'23"E, 2533.07 feet to the Southeast corner of said Quarter; thence along the South line of said Quarter, S88°45'21"W, 2610.34 feet to the POINT OF BEGINNING.

All reserves, streets, utility easements, building setbacks, access control; together with any and all other public dedications within the above described property are hereby vacated and replatted by virtue of K.S.A. 12-512(b).

I hereby certify that the details of this plat are correct to the best of my knowledge and belief this 12th day of October, 2005.

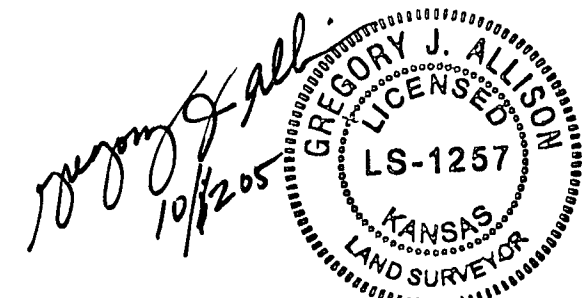

Gregory J. Allison, PE, LS #1257
 MKEC Engineering Consultants, Inc.
 411 North Webb Road
 Wichita, Kansas 67206

Know all men by these presents that we the undersigned property owners of the land above set forth in the Registered Land Surveyor's Certificate, have caused the same to be surveyed and platted into Lots, Blocks, Reserves, and Streets the same to be known as "COUNTRY HOLLOW ADDITION," an addition to Wichita, Sedgwick County, Kansas.

Easements for the construction and maintenance of public utilities and drainage, as indicated on the accompanying plat are hereby granted to the public.

The streets are hereby dedicated to and for the use of the public.

All abutters right to access to or from US-54 over and across the North line of "COUNTRY HOLLOW ADDITION," are hereby granted to the appropriate governing body, and all abutters right to access to or from 127th Street over and across the West line of "COUNTRY HOLLOW ADDITION," are hereby granted to the appropriate governing body, as indicated hereon.

A drainage plan has been developed for this plat and all drainage easements, right-of-way, or reserves shall remain at established grades or as modified with the approval of the applicable City or County Engineer, and unobstructed to allow for the conveyance of storm water.

Lots 6-25 inclusive and 37, Block 1; Lots 1-20 inclusive, Block 3; Lots 6-25 inclusive, Block 4; Lots 1 and 2, Block 5, are required to adhere to the minimum pad elevation as shown on the "Minimum Pad Elevations" table.

Reserves "A", "B", "C", "D", "E", "F", and "G" are platted for utilities in designated areas, landscaping, irrigation, open space, monuments, and water features. Additionally, Reserves "C", "D", "E", "F", and "G" are platted for drainage, and ponds. Reserve "E" is also platted for a tot-lot, pool, pool-house and associated uses. The Reserves shall be owned and maintained by the Lot Owner Association, provided however, that the undersigned or homeowner's association as the undersigned successors in interest may, at its discretion deed parcels of said Reserves to an owner(s) of an adjoining lot subject to the obligation to maintain such deeded parcel in compliance with the provisions hereof and in compliance with the maintenance covenants of any applicable restrictive covenants or regulations.

The 5' Wall Easement along West line of addition, as shown, hereby platted for the construction and maintenance of a private wall. Utilities may cross the wall easement.

RITCHIE DEVELOPMENT CORPORATION

Kevin Mullen, President
 Kevin Mullen, President

STATE OF KANSAS, SEDGWICK COUNTY) ss:

This instrument was acknowledged before me on this 13th day of October, 2005, Kevin Mullen, President, Ritchie Development Corporation.

IN WITNESS WHEREOF, I have hereunto set my hand and affixed my official seal, the day and year last above written.



Cynthia A. Womack, Notary Public
 Cynthia A. Womack, Notary Public
 My Term Expires: 2-7-2009

We INTRUST Bank, N.A. holders of a mortgage on the above described property, do hereby consent to the plat of "COUNTRY HOLLOW ADDITION."

INTRUST Bank, N.A.

Gary D. Schmitt, Executive Vice President
 Gary D. Schmitt, Executive Vice President

This instrument was acknowledged before me on this 17th day of November, 2005, by Gary D. Schmitt, Executive Vice President, INTRUST Bank, N.A.

IN WITNESS WHEREOF, I have hereunto set my hand and affixed my official seal, the day and year last above written.

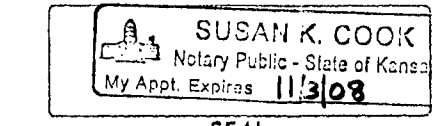

Susan K. Cook, Notary Public
 Susan K. Cook, Notary Public
 My Term Expires: 11/3/08

STATE OF KANSAS, SEDGWICK COUNTY) ss:

This plat of "COUNTRY HOLLOW ADDITION" has been submitted to and approved by the Wichita-Sedgwick County Metropolitan Area Planning Commission, Wichita, Kansas.

Dated this 4th day of August, 2005.

WICHITA-SEDGWICK COUNTY METROPOLITAN AREA PLANNING COMMISSION

Morris K. Dunlap, Chair
 Morris K. Dunlap, Chair
 Attest: *John L. Schlegel*, Secretary
 John L. Schlegel, Secretary

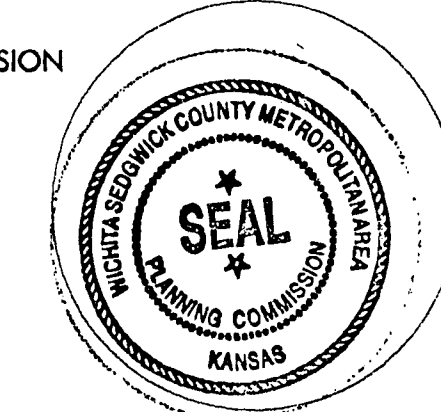

This plat of "COUNTRY HOLLOW ADDITION" has been submitted to and approved by the City Council of the City of Wichita, Sedgwick County, Kansas. The easements, rights-of-way and other public dedications are accepted by the City Council of the City of Wichita. Dated this 8 day of November, 2005.

At the direction of the City Council.

Carlos Mayans, Mayor
 Carlos Mayans, Mayor

Attest: *Patricia Ellis Dupuy*, City Clerk
 Patricia Ellis Dupuy, City Clerk

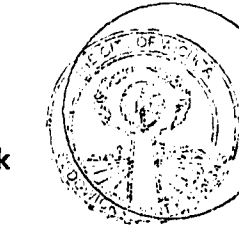

STATE OF KANSAS, SEDGWICK COUNTY) ss:

Entered on transfer record this ___ day of _____, 2005.

_____, County Clerk
 Don Brace, County Clerk

This is to certify that this instrument was filed for record in the Register of Deeds office this ___ day of _____, 2005, at _____ o'clock M, and is duly recorded.

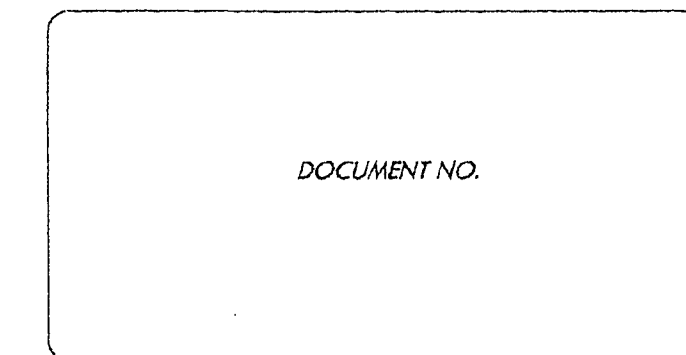

_____, Register of Deeds
 Bill Meek, Register of Deeds

Attest: _____, Deputy
 Tonya E. Buckingham, Deputy

Reviewed in accordance with K.S.A. 58-2005 on this 19th day of October, 2005.

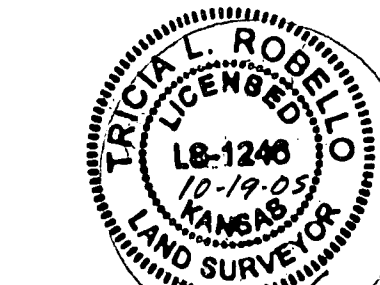

Tricia L. Robello, Deputy County Surveyor
 Tricia L. Robello, LS #1246
 Deputy County Surveyor
 Sedgwick County, Kansas

