

DRAINAGE PLAN

THE WOODS RESERVE

WICHITA, SEDGWICK COUNTY, KANSAS

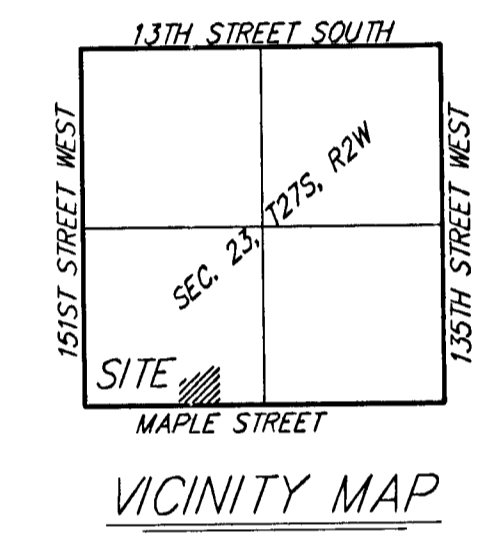
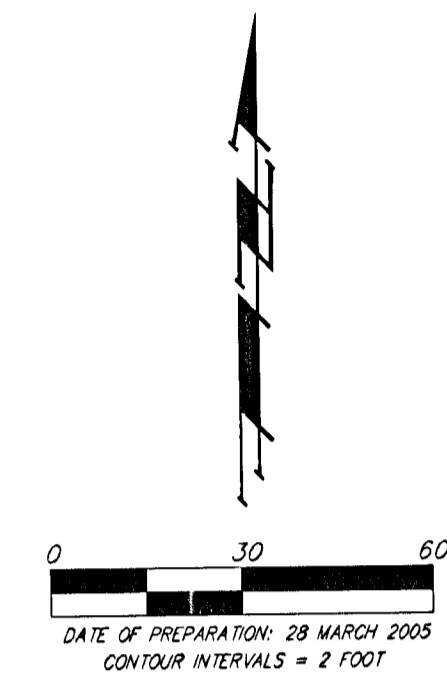
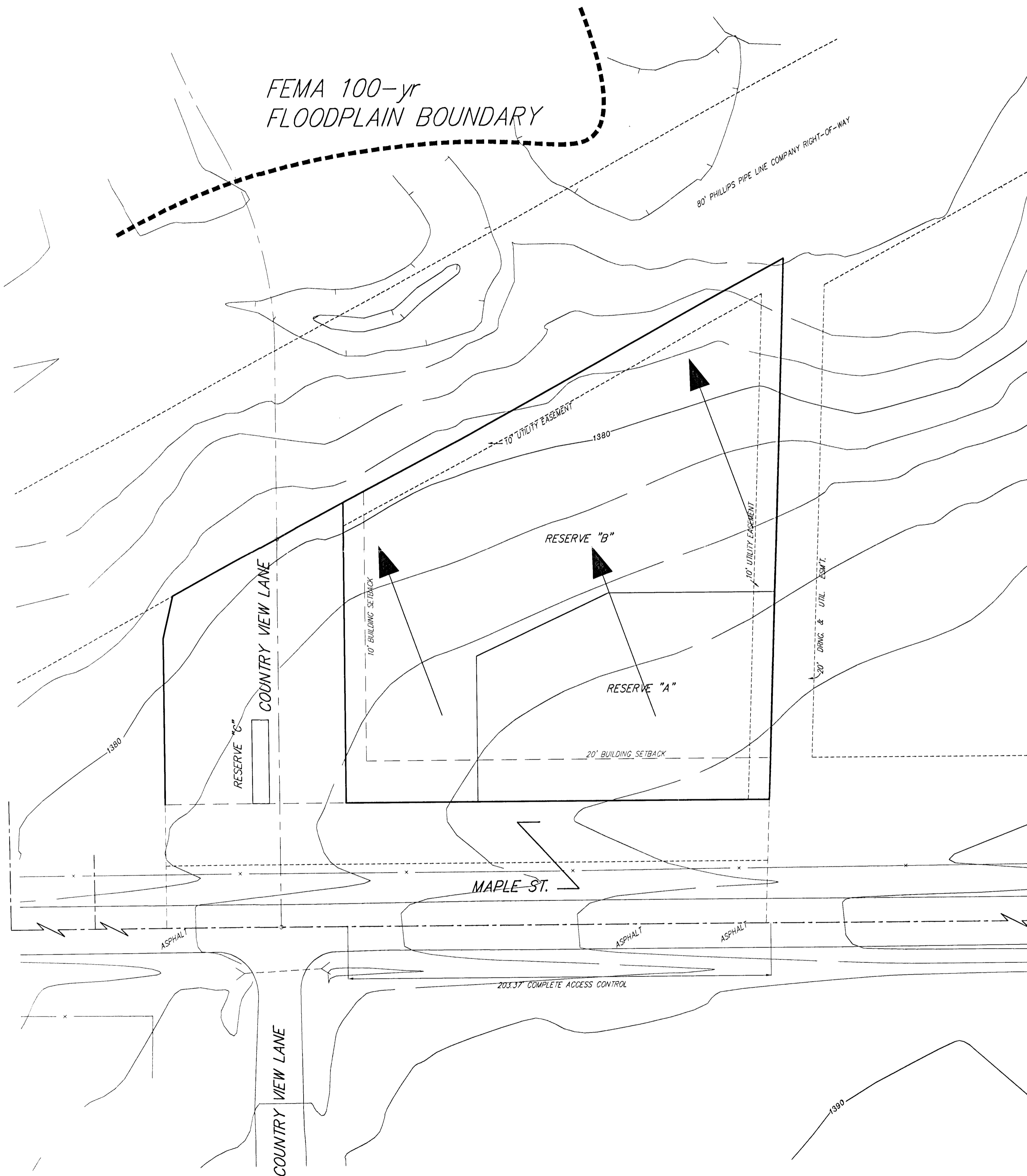

Existing	Developed
D.A. = 1.0 acres	
"C" = 0.45	"C" = 0.75
Q ₂ = 1.7 cfs	Q ₂ = 2.9 cfs
Q ₅ = 2.0 cfs	Q ₅ = 3.4 cfs
Q ₁₀ = 2.3 cfs	Q ₁₀ = 4.0 cfs
Q ₁₀₀ = 3.3 cfs	Q ₁₀₀ = 5.5 cfs

NOTE: FEMA Floodplain Boundary scaled per FEMA FIRM Map Panel 200321 200A

28 MARCH 2005

Baughman Company, P.A.
 315 Ella St. Wichita, KS 67211 P 316-262-7271 F 316-262-0149
 ENGINEERING | SURVEYING | PLANNING | LANDSCAPE ARCHITECTURE

F:\PROJECTS\Projects\Shadow Woods Reserve\Draw\woodsreserve.drain.dwg