

SBC has Poured a Concrete Cap Over the West Ex. SBC Duct Run from Sta. 0+795 to Sta. 0+855. The Contractor shall Use Caution When Excavating in the Area of the Duct Run.

NOTE:
Existing Manhole to be Walled & Overlaid as Marked on Plans.

REMOVAL LEGEND:

 Existing Sidewalk, Driveway, Parking (Asphalt & Concrete) Pavement to be Removed

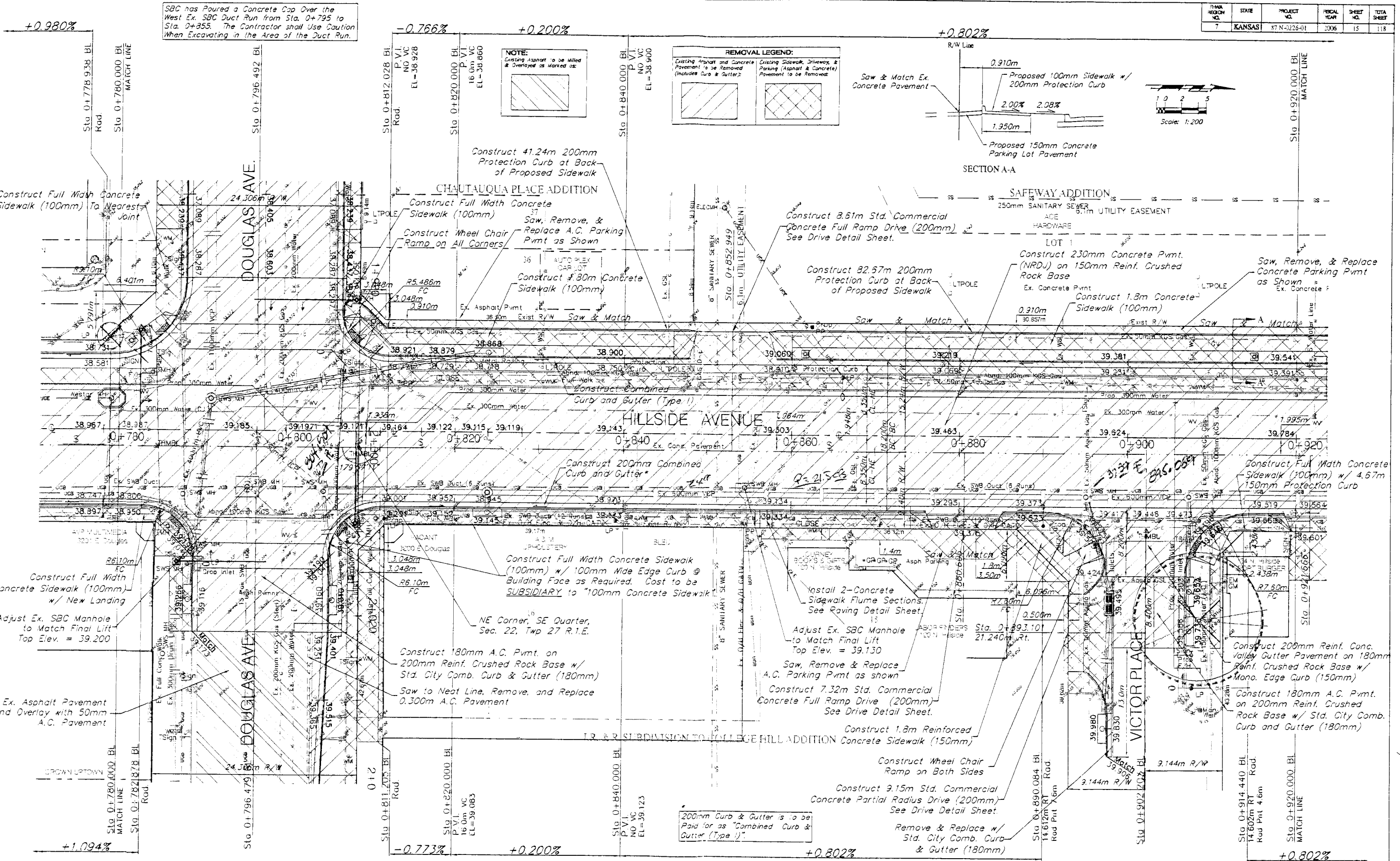
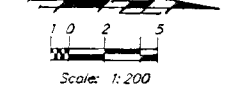
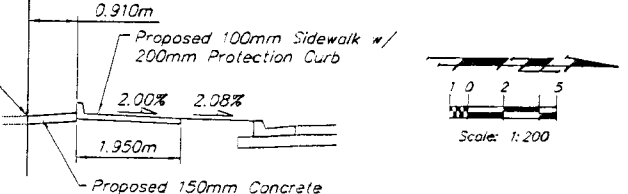

BENCHMARK
 BM #4 - Top of Curb of SW Parking Lot
 NW Corner of Hillside & Douglas
 Sta. 0+307.532, 3.048m LL
 Elev. = 38.030 SI Units (124.77 City Datum)

BENCHMARK
 BM #5 - Top of Brick NW Corner of Brick Planter
 NE Corner Blg. #102 SE Corner of
 Hillside & 1st Sta. 0+388.819, 22.132m Rt.
 Elev. = 40.885 SI Units (133.48 City Datum)

NOTE:
Trees/Drives to be removed as marked on plans.

KEY
 METRIC

PROJECT NUMBER	SHEET NAME	ENGINEERING DIRECTORY
472-33862	PAVING	F: Hillside Land Use
DATE	SCALE	DATE
11/18	Noted	11-19-2007

HILLSIDE AVENUE PAVING
 Sta. 0+780.000 to Sta. 0+920.000

BAUGHMAN COMPANY, P.A.
 ENGINEERING, SURVEYING, & PLANNING
 318-282-7271 • 315-211-6116 • P.O. BOX 474, KANSAS CITY, MO 64101

Boundary of Subdivision. Curbs