

BENCHMARK  
 BM #6 - NW Corner of Walk North of Fire Sta. #5  
 SW Corner of Hillside & 2nd  
 Sta. 1+204.388, 19.744m Lt.  
 Elev. = 40.706 SI Units (133.55 City Datum)

FEMA REGION NO.	STATE	PROJECT NO.	FISCAL YEAR	SHEET NO.	TOTAL SHEETS
7	KANSAS	87 N.4025-01	2006	17	118

+0.200%

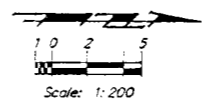
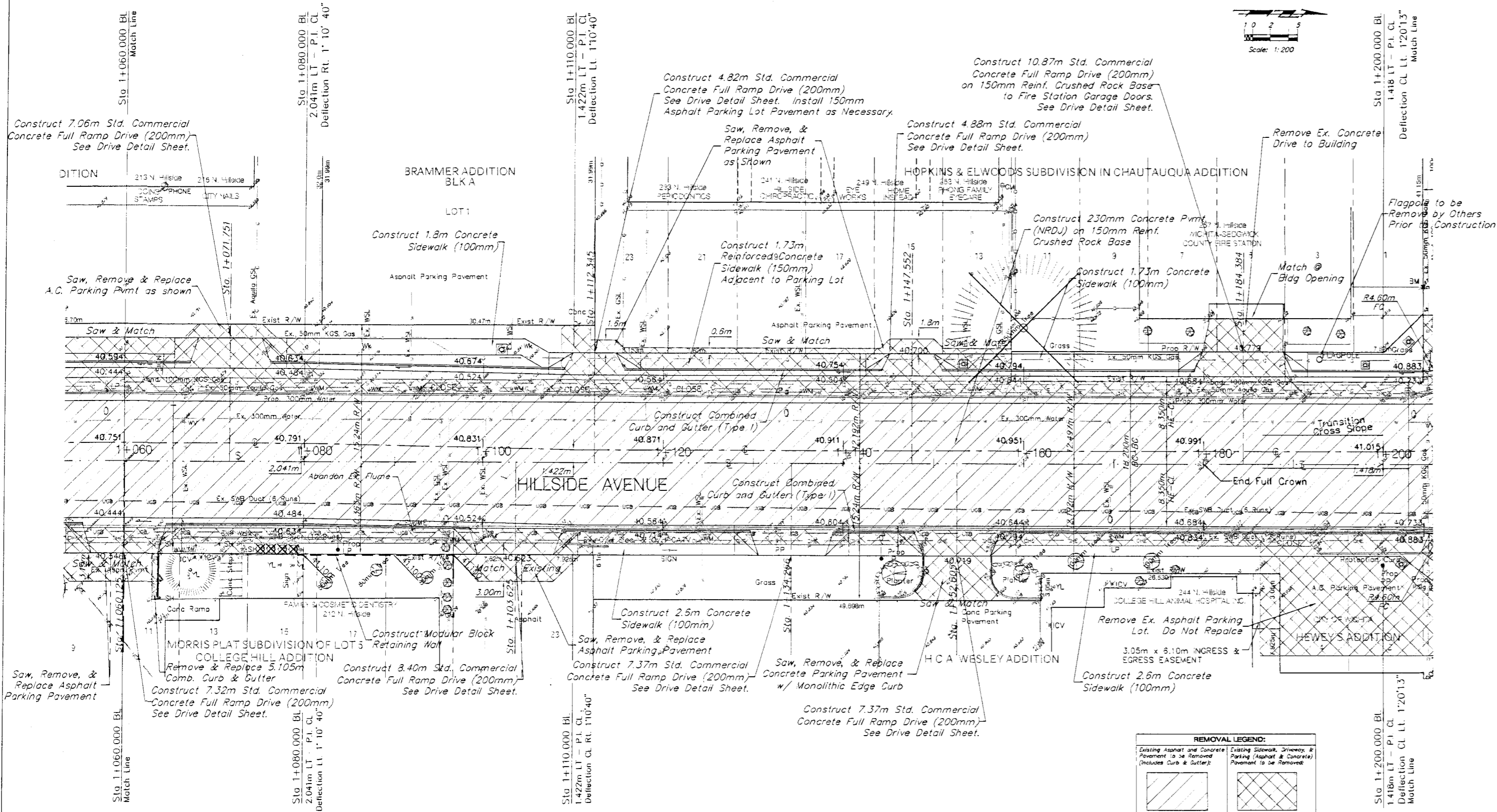

**REMOVAL LEGEND:**

	Existing Asphalt and Concrete Pavement to be Removed (includes Curb & Gutter)
	Existing Sidewalk, Driveway & Parking (Asphalt & Concrete) Pavement to be Removed

**NOTE:**  
 Trees/Structs to be removed are marked thus:



PROJECT NUMBER 472-83882	SHEET NAME PAV07	ENGINEER/DIRECTOR F. Hillside/Landis
DESIGN A.T.D.	DRAWN Santiv	APPROVED J.F.B.
DATE May 2006	SCALE Noted	DATE/ISSUE 01-03-2007

CAPITAL IMPROVEMENT PROJECT  
**HILLSIDE AVENUE PAVING**  
 Sta. 1+060.000 to Sta. 1+200.000

**BAUGHMAN COMPANY, P.A.**  
 ENGINEERING, SURVEYING, & PLANNING  
 318-282-7211 • 315 ELLIS • WICHITA, KANSAS 67211

SHEET  
 17  
 OF  
 118

+0.200%