

STAFF REPORT
(Final Plat, Preliminary Plat Approved 9/15/11)

CASE NUMBER: SUB 2011-00038 – ANGEL FIRE 2ND ADDITION

OWNER/APPLICANT: Caywood, LLC, Attn: Matt Eck, P.O. Box 75337, Wichita, KS 67275

SURVEYOR/AGENT: Baughman Company, P.A., Attn: Kris Rose, 315 Ellis, Wichita, KS 67211

LOCATION: North of 47th Street South, East of West Street (District IV)

SITE SIZE: 11.46 acres

NUMBER OF LOTS

Residential:	42
Office:	
Commercial:	
Industrial:	
Total:	42

MINIMUM LOT AREA: 9,600 square feet

CURRENT ZONING: TF-3 Two-family Residential

PROPOSED ZONING: Same

VICINITY MAP

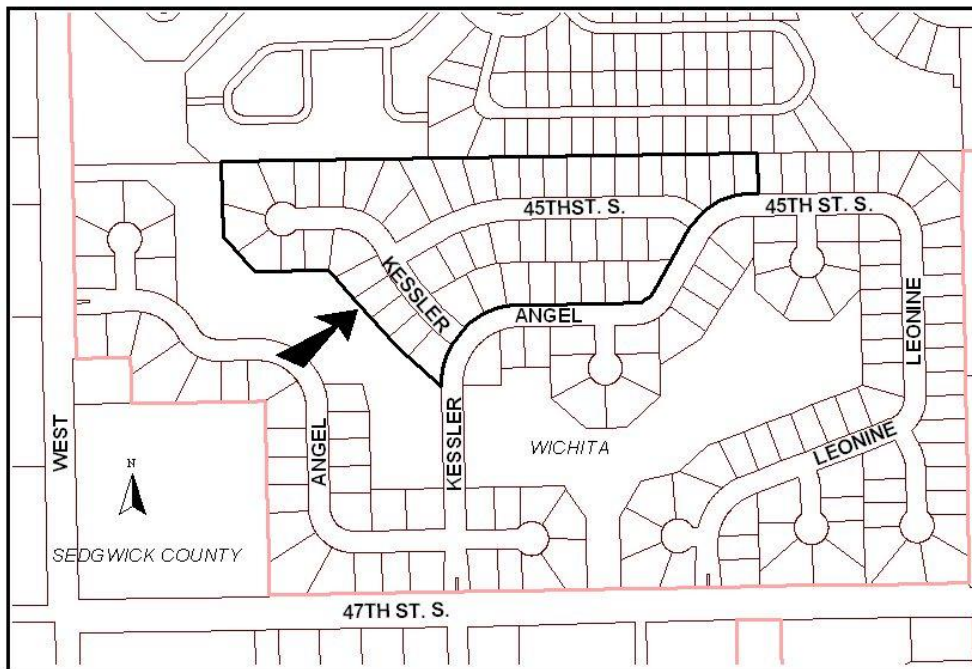

SUB 2011-00038 – Final Plat of ANGEL FIRE 2ND ADDITION
October 13, 2011 - Page 2

NOTE: This is a replat of a portion of the Angel Fire Addition involving enlarged lot widths resulting in seven fewer lots. The street layout has not changed.

The Subdivision Committee may recommend a modification of the design criteria in Article 7 of the Subdivision Regulations only if it finds that the strict application of the design criteria will create an unwarranted hardship, the proposed modification is in harmony with the intended purpose of the Subdivision Regulations and the public safety and welfare will be protected.

STAFF COMMENTS:

- A. City of Wichita Public Works and Utilities Department advises that the applicant will need to extend water (transmission and distribution) and sewer (main and lateral) to serve all lots being platted.
- B. If improvements are guaranteed by petition(s), a notarized certificate listing the petition(s) shall be submitted to the Planning Department for recording.
- C. City Stormwater Management requests a verification memo that the existing detention facility meets current City water quality requirements. A revised master grading plan is needed that is sealed by a licensed Professional Engineer.
- D. There should be no city elevations on the plat.
- E. Since this is a replat of a previous Addition involved with the ownership and maintenance of reserves for that Addition, but not being replatted by this Addition, a restrictive covenant shall be provided which provides for this Addition to continue to share in the ownership and maintenance responsibilities of any such previously platted reserves.
- F. This property is within a zone identified by the City Engineer's office as likely to have groundwater at some or all times within 10 feet of the ground surface elevation. Building with specially engineered foundations or with the lowest floor opening above groundwater is recommended, and owners seeking building permits on this property will be similarly advised. More detailed information on recorded groundwater elevations in the vicinity of this property is available in the City Engineers' office.
- G. The Applicant is reminded that a platting binder is required with the final plat. Approval of this plat will be subject to submittal of this binder and any relevant conditions found by such a review.
- H. The plat's text shall include language that a drainage plan has been developed for the plat and that all drainage easements, rights-of-way, or reserves shall remain at established grades or as modified with the approval of the applicable City or County Engineer, and unobstructed to allow for the conveyance of stormwater.
- I. The applicant shall install or guarantee the installation of all utilities and facilities that are applicable and described in Article 8 of the MAPC Subdivision Regulations. (Water service and fire hydrants required by Article 8 for fire protection shall be as per the direction and approval of the Chief of the Fire Department.)
- J. The Register of Deeds requires all names to be printed beneath the signatures on the plat and any associated documents.
- K. Prior to development of the plat, the applicant is advised to meet with the United States Postal Service Growth Management Coordinator (Phone: 316-946-4556) in order to receive mail delivery without delay, avoid unnecessary expense and determine the type of delivery and the tentative mailbox locations.
- L. The applicant is advised that various State and Federal requirements (specifically but not limited to the Army Corps of Engineers, Kanopolis Project Office, Rt. 1, Box 317, Valley Center, KS 67147) for the control of soil and wind erosion and the protection of wetlands may impact how this site can be developed. It is the applicant's responsibility to contact all appropriate agencies to determine any such requirements.
- M. The owner of the subdivision should note that any construction that results in earthwork activities that will disturb one (1) acre or more of ground cover requires a Federal/State National Pollutant Discharge Elimination System Stormwater Discharge Permit from the Kansas Department of Health and Environment in Topeka. Also, for projects located within the City of Wichita, erosion and sediment control devices must be used on ALL projects. For projects outside of the City of Wichita, but within the Wichita Metropolitan area, the owner should contact the appropriate governmental jurisdiction concerning erosion and sediment control device requirements.
- N. Perimeter closure computations shall be submitted with the final plat tracing.

SUB 2011-00038 – Final Plat of ANGEL FIRE 2ND ADDITION
October 13, 2011 - Page 3

- O. A compact disc (CD) should be provided, which will be used by the City and County GIS Departments, detailing the final plat in digital format in AutoCAD. If a disc is not provided, please send the information via e-mail to Cheryl Holloway (e-mail address: cholloway@wichita.gov). Please include the name of the plat on the disc.