

STAFF REPORT
(Final Plat, Preliminary Plat Approved 9/29/11)

CASE NUMBER: SUB 2011-00041 – LAMPTON BROTHERS 2ND ADDITION

OWNER/APPLICANT: Lampton Brothers Investments, Inc., Attn: Doug Lampton, 601 North Washington, Wichita, KS 67214

SURVEYOR/AGENT: Ruggles and Bohm, P.A., Attn: Will Clevenger, 924 North Main, Wichita, KS 67203

LOCATION: North side of Central, East of Broadway (District VI)

SITE SIZE: 7.29 acres

NUMBER OF LOTS

Residential:	
Office:	
Commercial:	
Industrial:	1
Total:	1

MINIMUM LOT AREA: 7.29 acres

CURRENT ZONING: LI, Limited Industrial

PROPOSED ZONING: Same

VICINITY MAP

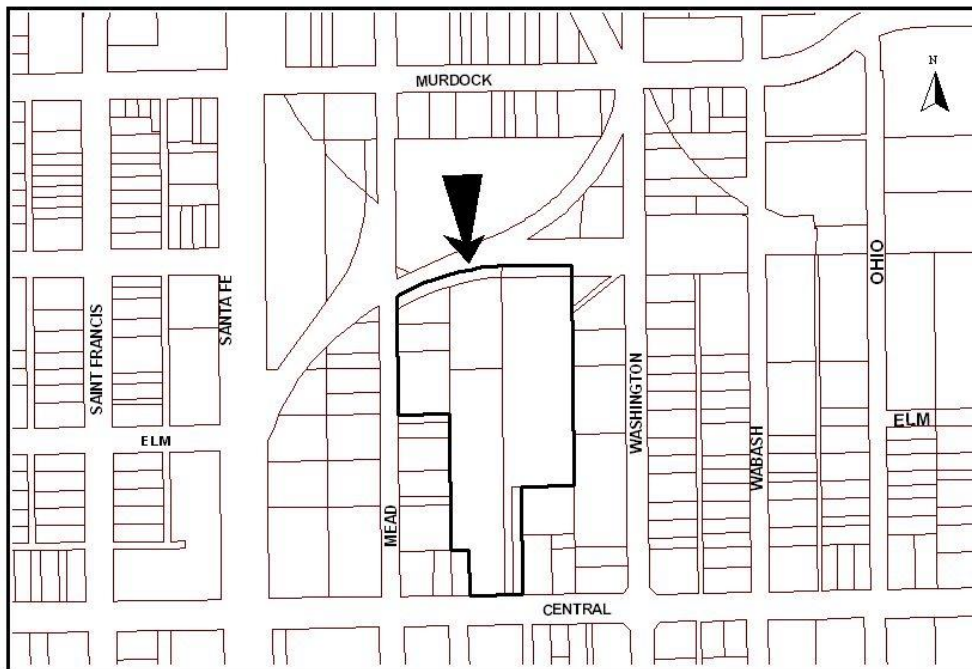

NOTE: This is a replat of the Lampton Brothers Addition and portions of the Throckmorton's Addition and Hiltons Addition.

STAFF COMMENTS:

- A. City of Wichita Public Works and Utilities Department advises that water and sewer services are available to serve the site. A restrictive covenant is needed that ties together Lot 5 of the Hilton Addition with this plat for water services.
- B. If improvements are guaranteed by petition(s), a notarized certificate listing the petition(s) shall be submitted to the Planning Department for recording.
- C. City Stormwater Management has approved the drainage plan subject to the stage-discharge graph being updated, the report being stamped and sealed, and submittal as a pdf file.
- D. Traffic Engineering has approved access controls. The plat proposes one opening along Central.
- E. The year "2012" needs to replace "2011" within the signature blocks.
- F. The platting binder indicates a party holding a mortgage on the site. This party's name must be included as a signatory on the plat, or else documentation provided indicating that such mortgage has been released.
- G. The plat's text shall include language that a drainage plan has been developed for the plat and that all drainage easements, rights-of-way, or reserves shall remain at established grades or as modified with the approval of the applicable City or County Engineer, and unobstructed to allow for the conveyance of stormwater.
- H. The applicant shall install or guarantee the installation of all utilities and facilities that are applicable and described in Article 8 of the MAPC Subdivision Regulations. (Water service and fire hydrants required by Article 8 for fire protection shall be as per the direction and approval of the Chief of the Fire Department.)
- I. The Register of Deeds requires all names to be printed beneath the signatures on the plat and any associated documents.
- J. Prior to development of the plat, the applicant is advised to meet with the United States Postal Service Growth Management Coordinator (Phone: 316-946-4556) in order to receive mail delivery without delay, avoid unnecessary expense and determine the type of delivery and the tentative mailbox locations.
- K. The applicant is advised that various State and Federal requirements (specifically but not limited to the Army Corps of Engineers, Kanopolis Project Office, Rt. 1, Box 317, Valley Center, KS 67147) for the control of soil and wind erosion and the protection of wetlands may impact how this site can be developed. It is the applicant's responsibility to contact all appropriate agencies to determine any such requirements.
- L. The owner of the subdivision should note that any construction that results in earthwork activities that will disturb one (1) acre or more of ground cover requires a Federal/State National Pollutant Discharge Elimination System Stormwater Discharge Permit from the Kansas Department of Health and Environment in Topeka. Also, for projects located within the City of Wichita, erosion and sediment control devices must be used on ALL projects. For projects outside of the City of Wichita, but within the Wichita Metropolitan area, the owner should contact the appropriate governmental jurisdiction concerning erosion and sediment control device requirements.
- M. Perimeter closure computations shall be submitted with the final plat tracing.
- N. A compact disc (CD) should be provided, which will be used by the City and County GIS Departments, detailing the final plat in digital format in AutoCAD. Please include the name of the plat on the disc. If a disc is not provided, please send the information via e-mail to Neil Strahl (e-mail address: nstrahl@wichita.gov).