

THIS DOCUMENT IS THE PROPERTY OF SPIRIT AEROSYSTEMS, INC. ITS ACCEPTANCE CONSTITUTES AN AGREEMENT THAT IT SHALL BE TREATED AS CONFIDENTIAL MATERIAL. THAT IT SHALL BE RETURNED UPON REQUEST, AND THAT THE CONTENTS THEREOF SHALL NOT BE DISCLOSED, REPRODUCED, OR COPIED EXCEPT BY WRITTEN PERMISSION OF SPIRIT AEROSYSTEMS, INC.
 K:\PROJECTS\2011\1101060200_Spirit_Wichita_Southwest_CCA_Expansion - CFF\5-Civil\CAD\Sheets\Final_Release\112.DWG

**CONSTRUCTION STAGING AREA
 GRADING NOTES:**

1. PRIOR TO FINAL ACCEPTANCE OF THE PROJECT BY OWNER, CONSTRUCTION STAGING AREA SHALL BE GRADED SUCH THAT POSITIVE DRAINAGE TO BACK OF CURBS IS ACHIEVED. FINAL GRADES IN STAGING AREA SHALL BE 1.0% (MIN.).
2. SPOT ELEVATIONS SHOWN IN CONSTRUCTION STAGING AREA ARE TO TOP OF 6" (MIN.) TOPSOIL LAYER.
3. ONCE FINAL GRADE IS SATISFACTORY TO THE OWNER THE FINAL STAGING AREA SHALL BE PERMANENTLY SEEDED, PER REQUIREMENTS LANDSCAPE PLAN.

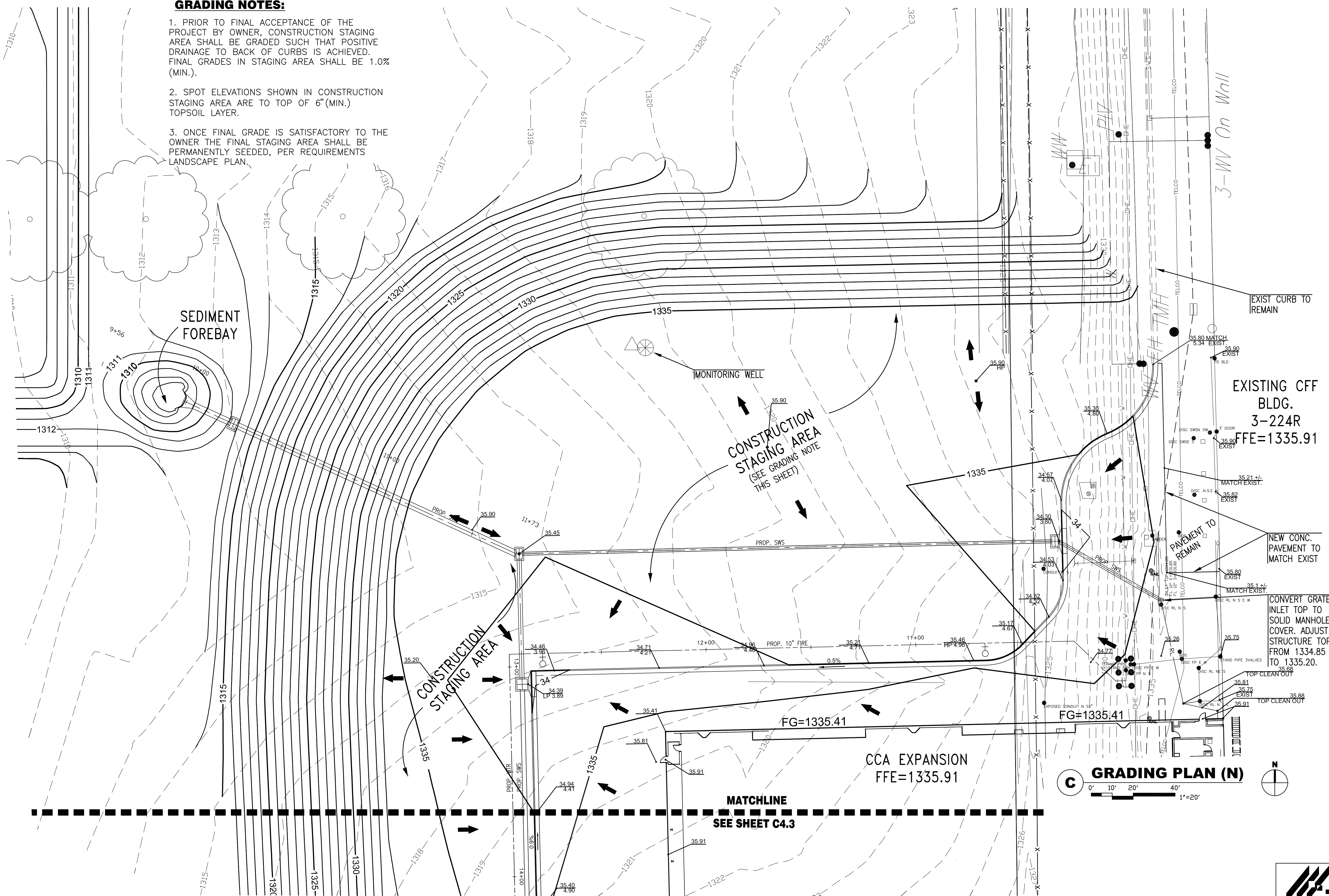

C GRADING PLAN (N)
 0' 10' 20' 40'
 1"=20'

APPROVED	BY	DATE	DESCRIPTION
		09/19/11	ISSUED FOR CONSTRUCTION
FIRE PROTECTION REVIEW	APPROVED	DATE	
ACCEPTABILITY OF THE SPECIFICATIONS APPROVED	NAME	DEPT.	DATE
SOUTHWEST CCA EXPANSION TO CFF			
Project No: 1615203		WICHITA	
Sheet Name: GRADING PLAN (N)		Date: 09/19/2011	
Sheet: C4.2		Drawn By: SFE	
Drawing No: 31G-112-271		Linda Wade (316)-316-0917	