

THIS DOCUMENT IS THE PROPERTY OF SPIRIT AEROSYSTEMS, INC. ITS ACCEPTANCE CONSTITUTES AN AGREEMENT THAT IT SHALL BE TREATED AS CONFIDENTIAL MATERIAL. THAT IT SHALL BE RETURNED UPON REQUEST, AND THAT THE CONTENTS THEREOF SHALL NOT BE DISCLOSED, REPRODUCED, OR COPIED EXCEPT BY WRITTEN PERMISSION OF SPIRIT AEROSYSTEMS, INC.
 K:\PROJECTS\2011\1101060200_Spirit_Wichita_Southwest_CCA_Expansion - CFF\5-Civil\CAD\Sheets\Final_Release\123.DWG

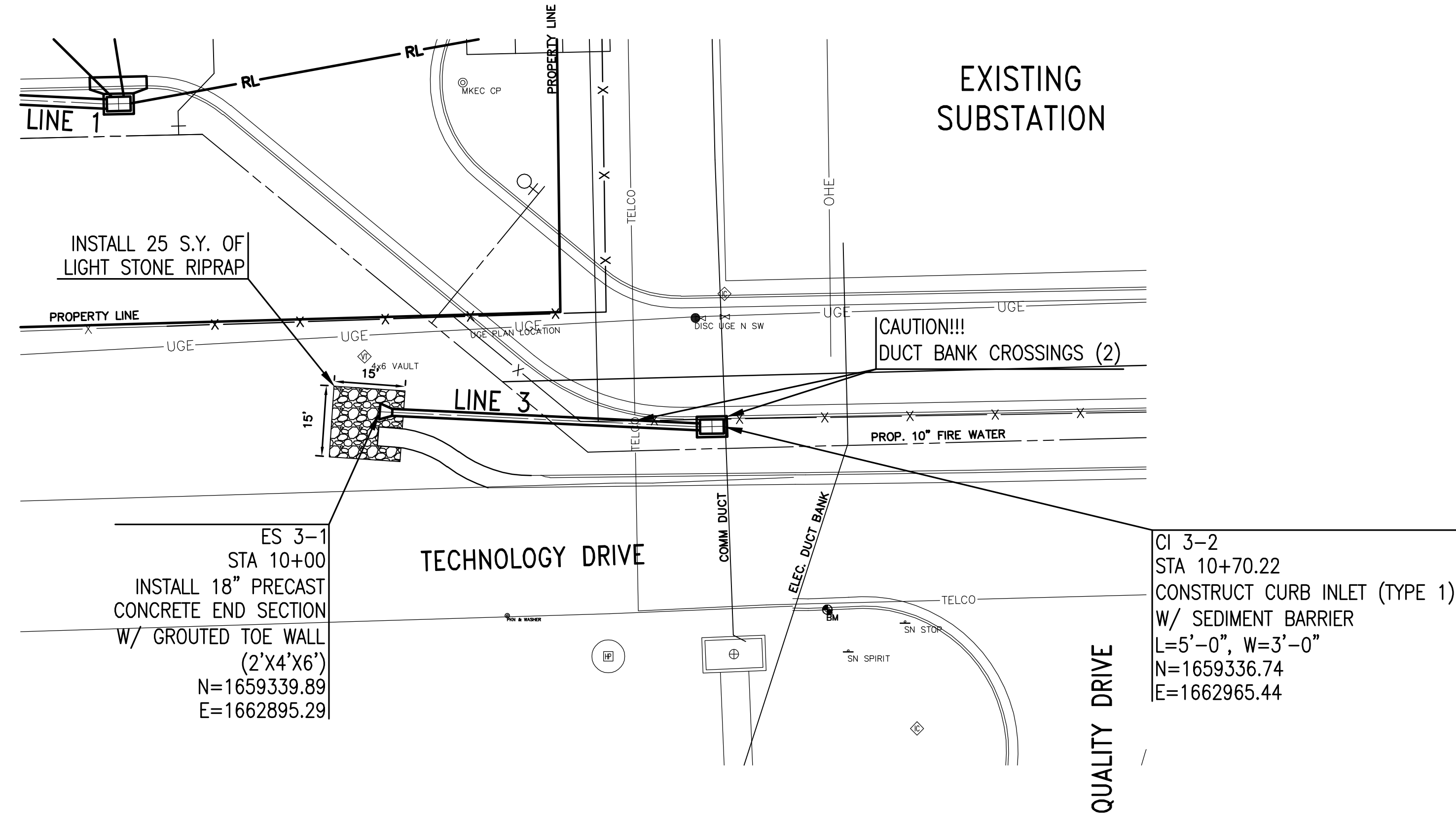

CONTRACTOR TO VERIFY DEPTH AND LOCATION OF ALL EXISTING UTILITIES PRIOR TO CONSTRUCTION.

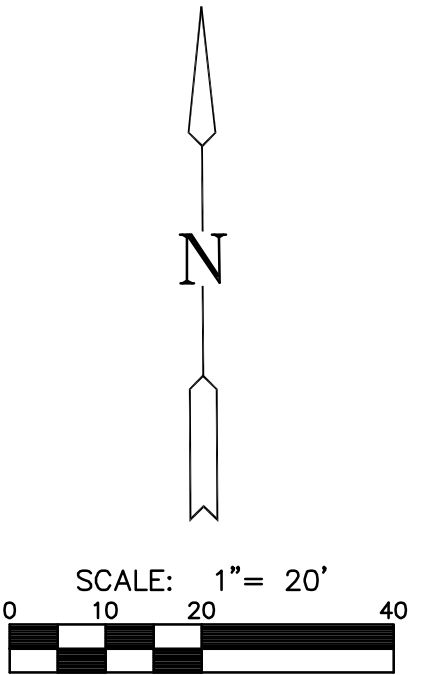

PLAN LINE 3
PROFILE LINE 3

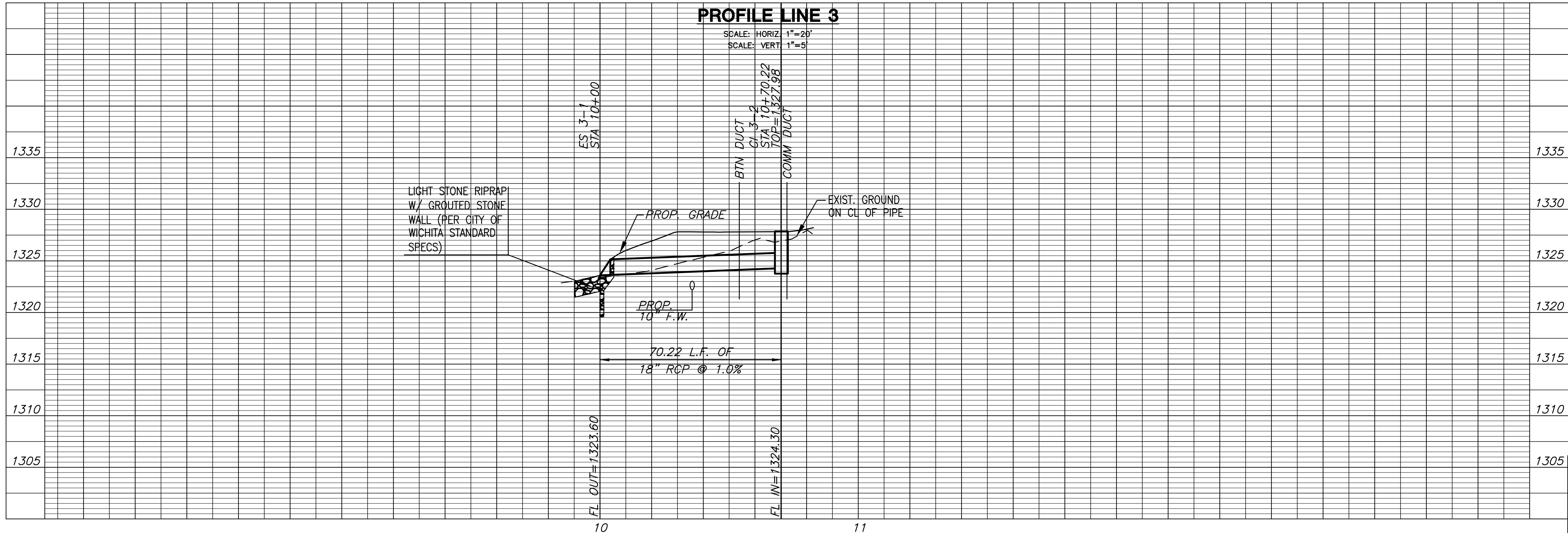

	APPROVED				
	BY				
	DATE	09/19/11	ISSUED FOR CONSTRUCTION		
△	FIRE PROTECTION REVIEW		APPROVED	NOT REQUIRED	DATE
	ACCEPTABILITY OF CONSTRUCTION SPECIFICATIONS APPROVED				
	NAME	DEPT.	DATE		
SOUTHWEST CCA EXPANSION TO CFF					
Project No: 1615203 Sheet Name: STORM WATER SEWER PLAN & PROFILE Sheet: C5.3 Drawing No: 31G-123-271					
BLDG. 3-224R/01 Facilities Engineering Design: MAB Date: 09/19/2011					
WICHITA Design By: SFE					
LINDA WADE (316)-316-0917					

