

- LEGEND**
- Bar & Baughman cap found
 - ⊙ Bar & Baughman cap found
 - ⊗ 3/4" iron pipe found
 - Bar & Garber cap found
 - △ not used
 - ✱ 1/2" bar found
 - Stone found
 - (M) Measured dimension
 - (R) Record or Deed dimension

Note:
 This plat is subject to the Provisions of Riverside Airport Planned Unit Development, PUD-35 on file with the Metropolitan Area Planning Dept.,
 The bearings shown on this plat are grid bearings based on the Kansas State Plane Coordinate System, NAD83, Kansas South Zone.

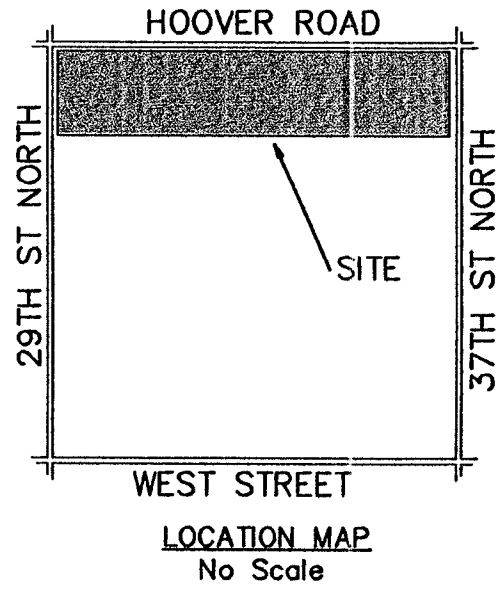

**FINAL PLAT OF
 RIVERSIDE AIRPORT ADDITION
 TO WICHITA, SEDGWICK COUNTY, KANSAS**

DATE OF PREPARATION 03/04/2011

STATE OF KANSAS)
COUNTY OF SEDGWICK) ss

I, William P. Fox, being a duly licensed Land Surveyor in said County and State, do hereby certify that I have been in responsible charge of surveying and platting "RIVERSIDE AIRPORT ADDITION" to Wichita, Sedgwick County, Kansas, being described as follows:

A Tract of land in the West Half of Section 35, Township 26 South, Range 1 West of the Sixth Principal Meridian, Sedgwick County, Kansas, Described as follows:

Commencing at the Southwest Corner of the Southwest Quarter of said Section; Thence along the West line of said section on an assumed bearing of N01°13'12"W for a distance of 75 feet; Thence N89°04'23"E for a distance of 75 feet for a Point of Beginning, said point being 75 feet North and 75 feet East of the Southwest Corner of the Southwest Quarter of said Section; Thence N01°13'12"W for a distance of 275 feet; Thence S89°04'23"W for a distance of 25 feet to a point, said point being 50 feet East and 350 feet North of the Southwest Corner of the Southwest Quarter of said Section; Thence N01°13'12"W for a distance of 2,288.80 feet to a point 50 feet East of the Northwest Corner of the Southwest Quarter; Thence N01°14'46"W for a distance of 2,289.36 feet to a point, said point being 50 feet East and 350 feet South of the Northwest Corner of the Southwest Quarter of said Section; Thence N88°45'14"E for a distance of 25 feet to a point, said point being 75 feet East and 350 feet South of the Northwest Corner of the Southwest Quarter of said Section; Thence N01°14'46"W for a distance of 275 feet to a point, said point being 75 feet West and 75 feet South of the Northwest Corner of the Southwest Quarter of said Section; Thence N88°50'38"E for a distance of 275 feet; Thence N01°09'22"W for a distance of 25 feet to a point, said point being 350 feet East and 50 feet South of the Northwest Corner of the Southwest Quarter of said Section; Thence N88°50'38"E for a distance of 323.75 feet to a point on the West line of the West 20 Acres of the East 120 Acres of said Northwest Quarter; Thence S01°08'29"E for a distance of 1,138.99 feet; Thence N89°04'18"E for a distance of 329.82 feet; Thence S01°08'29"E for a distance of 1,453.03 feet; Thence N89°04'51"E for a distance of 1,645.53 feet to the Southeast Corner of said Northwest Quarter; Thence S01°10'01"E for a distance of 2,588.43 feet to a point, said point being 50 feet North of the Southeast corner of the Southwest Quarter of said Section; Thence S89°04'23"W for a distance of 2,292.21 feet; Thence N01°13'12"W for a distance of 25 feet to a point, said point being 75 feet North and 350 feet East of the Southwest Corner of the Southwest Quarter of said Section; Thence S89°04'23"W for a distance of 275 feet to the Point of Beginning. Existing public easements are hereby vacated to conform to this plat by virtue of K.S.A. 12-512(b). The accompanying plat is a true and correct exhibit of property surveyed.
Dated this ___ day of March, 2011.

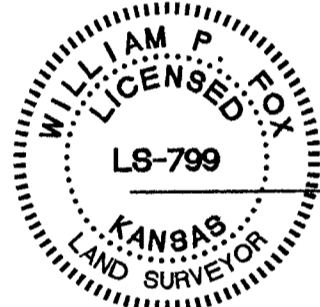

William P. Fox, L.S. 799
Fox and Associates, Inc.

KNOW ALL MEN BY THESE PRESENTS:

That we, the undersigned, have caused the land described in the Surveyor's Certificate to be platted into a Lot and a Block. Easements are hereby granted as indicated for the construction and maintenance of drainage & utilities. A drainage plan has been developed for this addition. All drainage easements shall remain at established grades or as modified with the approval of the applicable City or County Engineer, and remain unobstructed to allow for the conveyance of stormwater. All abutters' rights of access to or from 37th Street North, Hoover Road and 29th Street North as indicated on the plat map are hereby granted to the appropriate governing body.

Fly High, Inc

Print:
Title:

State of Kansas) ss
Sedgwick County)

BE IT REMEMBERED that on this ___ day of ___, 2011, before me, the undersigned, a notary public in and for the County and state aforesaid came _____ Southfork Investment, LLC, to me personally known to be the same persons who executed this instrument and such persons duly acknowledged the execution of the same.

IN WITNESS WHEREOF, I have hereunto set my hand and affixed my official seal the day and year first above written.

My appointment expires: _____

Notary Public _____

Print _____

State of Kansas) ss
Sedgwick County)

This replat of "RIVERSIDE AIRPORT ADDITION", Wichita, Sedgwick County, Kansas has been submitted to and approved by the Wichita/Sedgwick County Metropolitan Area Planning Commission, Wichita, Kansas.

Dated this ___ day of ___, 2011.
Wichita/Sedgwick County Metropolitan Area Planning Commission.

_____, Chair
Debra Miller-Stevens

_____, Secretary
John L. Schlegel

State of Kansas) ss
City of Wichita)

This plat approved and all dedications shown hereon accepted by the City Council of the City of Wichita, Kansas, this ___ day of ___, 2011. At the Direction of the City Council.

_____, Mayor
Carl Brewer

_____, City Clerk
Karen Sublett

Entered on transfer record this ___ day of ___, 2011.

_____, County Clerk
Kelly B. Arnold

State of Kansas) ss
Sedgwick County)

This is to certify that this instrument was filed for record in the Register of Deeds office at ___ o'clock ___, .m., on the ___ day of ___, 2011, and is duly recorded.

_____, Register of Deeds
Bill Meek

_____, Deputy
Tanya Buckingham

State of Kansas) ss
Sedgwick County)

Reviewed in accordance with K.S.A. 58-2005 on this ___ day of ___, 2011.

Tricia L. Robello, L.S. # 1246
Deputy County Surveyor
Sedgwick County, Kansas

FINAL PLAT OF RIVERSIDE AIRPORT ADDITION TO WICHITA, SEDGWICK COUNTY, KANSAS

DATE OF PREPARATION 03/04/2011



POE & ASSOCIATES, INC.
CONSULTING ENGINEERS
3940 E. Central, Suite 200 Wichita, KS 67208-4242
Phone 316/685-4114 FAX 316/685-4444