

BENCHMARK

- BM#1 - "X" cut on East end of North headwall of RCB, 31' East and 11' North of the Center of Section 27, Township 27 South, Range 2 East. Elev.=1346.58 NGVD
- BM#2 - T-post on Southwest corner of Reserve A, 5' Southwest of the Northeast corner of Reserve A. Elev.=1340.415 NGVD 153.015 City Datum
- BM#3 - T-post on Southwest corner of Glenmoor and Lincoln, 5' Southwest of the Northeast corner of Reserve B. Elev.=1338.37 NGVD 150.97 City Datum
- BM#4 - T-post 5' North of the Southwest corner of Lot 13, Block 4. Elev.=1329.635 NGVD 142.235 City Datum
- BM#5 - T-post 5' North corner of Lot 11, Elev.=1340.255 152.855 City Datum
- BM#6 - T-post 5' West corner of Lot 4, Elev.=1339.135 N 151.735 City Datum
- BM#7 - T-post 5' East Northwest corner Block 2, Elev.=1342.695 N 155.295 City Datum
- BM#8 - T-post 5' North Southwest corner Block 2, Elev.=1338.12 NG 150.72 City Datum
- BM#9 - Railroad spike in 24" tree on North 127th Street East 30' East of the 127th Street East North line of Zim Elev.=1329.72 NG 142.32 City Datum

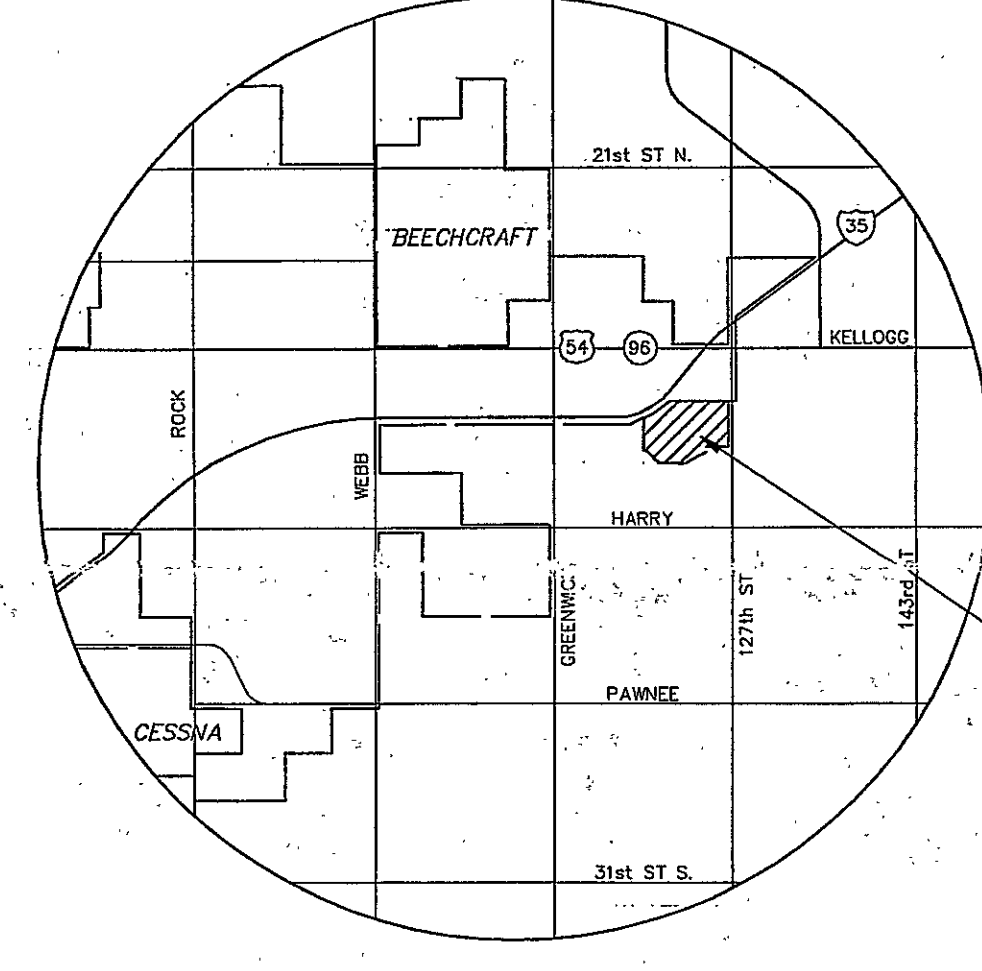

VICINITY MAP

WOODLAND LAKES ESTATES THIRD ADDITION			
LOT	BLOCK	ELEVATION (CITY DATUM)	ELEVATION (USGS)
1	1	1342.5	155.1
2	1	1343.0	155.6
3	1	1343.0	155.6
4	1	1343.0	155.6
5	3	1333.5	146.1
6	3	1333.0	145.6
7	3	1332.3	144.9
8	3	1331.5	144.1
9	3	1331.0	143.6
10	3	1330.5	143.1
11	3	1330.0	142.6
12	3	1329.5	142.1
13	3	1329.0	141.6
14	3	1328.5	141.1
15	3	1328.0	140.6
16	3	1327.5	140.1
17	3	1327.0	139.6
18	3	1326.5	139.1
19	3	1326.0	138.6
20	3	1325.5	138.1
21	3	1325.0	137.6
22	3	1324.5	137.1
23	3	1324.0	136.6
24	3	1323.5	136.1
25	3	1323.0	135.6
26	3	1322.5	135.1
27	3	1322.0	134.6
28	3	1321.5	134.1
29	3	1321.0	133.6
30	3	1320.5	133.1
31	3	1320.0	132.6
32	3	1319.5	132.1
33	3	1319.0	131.6
34	3	1318.5	131.1
35	3	1318.0	130.6
36	3	1317.5	130.1
37	3	1317.0	129.6

WOODLAND LAKES ESTATES FOURTH ADDITION			
LOT	BLOCK	ELEVATION (CITY DATUM)	ELEVATION (USGS)
25	1	1330.5	153.0
26	1	1330.0	152.5
27	1	1329.5	152.0
28	1	1329.0	151.5
29	1	1328.5	151.0
30	1	1328.0	150.5
31	1	1327.5	150.0
32	1	1327.0	149.5
33	1	1326.5	149.0
34	1	1326.0	148.5
35	1	1325.5	148.0
36	1	1325.0	147.5
37	1	1324.5	147.0

LEGEND

- CONIFEROUS TREE & DIAMETER
- DECIDUOUS TREE & DIAMETER
- BUSH
- EDGE OF TREES
- FENCE
- SANITARY SEWER MANHOLE
- GAS METER
- POLE
- GATE
- WALL
- LP LIGHT POLE
- FIRE HYDRANT
- WATER VALVE
- WATER METER
- POWER POLE AND GUY ANCHOR
- TERRACED VIEWOUT
- TERRACED WALKOUT
- PARTIAL VIEWOUT
- LOT MAY REQUIRE THICKER FOOTING AND/OR ENGINEERED FILL UNDER BASEMENT FLOOR
- PROP. HOUSE ELEV.
- EXIST. PLOT HOUSE ELEV.
- WOODLAND LAKES 3RD
- WOODLAND LAKES 4TH
- TELEPHONE RING
- INLET
- STORM SEWER
- WATER LINE
- SANITARY SEWER
- GAS LINE
- TELEPHONE LP
- UNDERGROUND OVERHEAD TEL
- OVERHEAD ELE
- UNDERGROUND
- HIGH PRESSUR
- SECTION CORN
- PROPERTY CORN
- BENCHMARK
- WALKOUT
- VIEWOUT
- NO VIEWOUT

APPROVED DRAINAGE PLAN

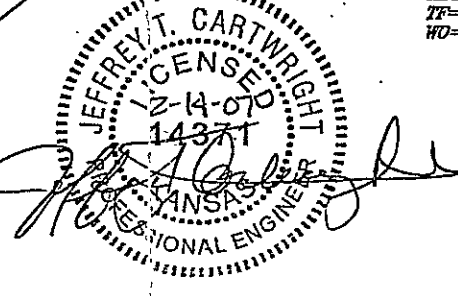

GRADING

WOODLAND LAKES ESTATES THIRD & FOURTH ADDITIONS

DEVELOPER: LEEWOOD CONSTRUCTION 3500 N ROCK RD BLDG 2200 STE 204 WICHITA, KS 67226

DATE: JULY 2004, NOVEMBER 2004, FEB. 2006 (FINAL PHASE)