

DRAINAGE PLAN

WESTWAY 2ND ADDITION

WICHITA, SEDGWICK COUNTY, KANSAS



EXISTING = DEVELOPED

Developed Intensity	2yr	10yr	100yr
3.8	5.19	7.36	
Rational C	0.95	0.95	0.95

Basin ID	Area acres	Developed Flowrates		
		2-yr cfs	10-yr cfs	100-yr cfs
1	0.7	2.5	3.5	4.9
2	0.7	2.5	3.5	4.9
3	0.8	2.7	3.7	5.2
4	1.0	3.6	4.9	7.0
5	2.1	7.6	10	15
6	3.0	11	15	21
7	0.6	2.2	3.0	4.3
8	7.5	27	37	52
9	0.3	1.1	1.5	2.1
10	2.3	8.3	11	16
11	0.4	1.3	1.7	2.4
12	0.8	2.9	3.9	5.6
13	2.3	8.3	11	16
14	2.3	8.3	11	16
15	1.6	5.8	7.9	11
TOTAL	26.3	95	130	184

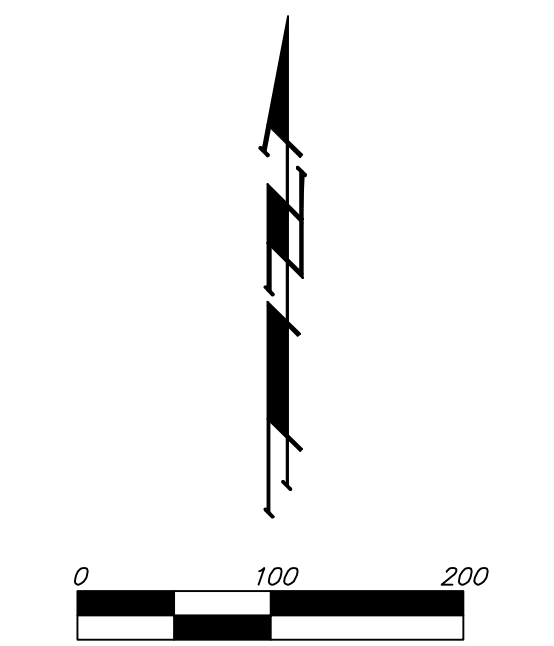

- △ = 3/4" Iron Pipe Found
- = #4 Baughman Rebar Set
- ⊠ = PK Nail Set
- ⊠ = PK Nail W/ Baughman Cap Set
- = 1/2" Iron Pipe Found
- = 1/2" Iron Pipe in Thimble Found
- ⊘ = 1/2" PEC Iron Pipe Found

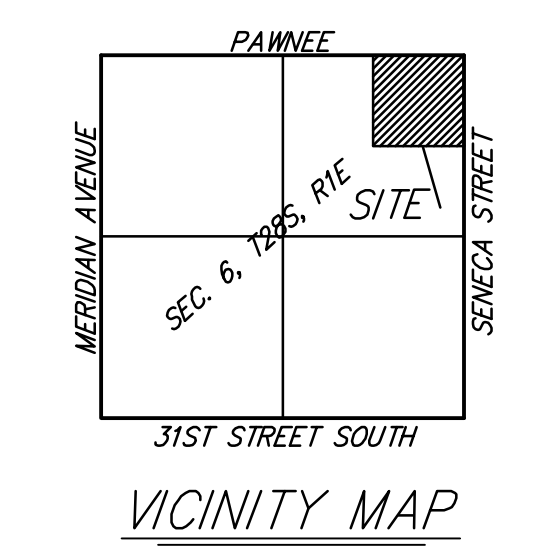

BENCHMARK:
 SQUARE CUT NE CORNER OF SOUTHWESTERN BELL PEDISTAL
 NW CORNER CRAWFORD & SENECA
 ELEV = 1288.20 (NGVS 29)

WATER QUALITY

The current site is fully developed and is primarily impervious surface. In the event of redevelopment, the site will need to meet Section 16.32 of the City of Wichita Code.

With a redeveloped site, the water quality requirements can be reduced per Code 16.32.091.

CHANNEL PROTECTION

Channel protection is not required on site due to the site being already developed and all runoff is conveyed by an existing storm water sewer.

- CO = Cleanout
- DI = Drop Inlet
- EB = Electric Box
- EM = Electric Meter
- EMH = Electric Manhole
- FM = Fire Hydrant
- FM = Underground Fiber Optic Line Marker
- FP = Fire Protection
- GM = Gas Meter
- GU = Guard Post(Ballard)
- Guy = Guy Anchor
- GV = Gas Valve
- ICV = Irrigation Control Valve - Valve Box
- LP = Light Pole
- MB = Mail Box
- PP = Power Pole
- Sign = Sign
- SSMH = Sanitary Sewer Manhole
- SMBVT = Southwestern Bell Vault
- SMB Ped = Southwestern Bell Pedestal
- TB = Traffic Box
- Well = Cased Well
- WM = Water Meter
- WV = Water Valve
- XFMR = Transformer

NOTE: Site currently located in FEMA Zone X per FEMA FIRM Panel 365 of 700, for Sedgwick County, Kansas. Map number 20173CO365E, Effective February 2, 2007.

Existing Conditions = Developed Conditions

DRAINAGE PLAN

WESTWAY 2ND ADDITION