

1300 E Lewis
Wichita KS 67211
316.247.8233
316.247.8566 fax
krehbielarchitecture.co



DATE: 11.05.2013
DATE
10/31/2013

PAULSEN FINANCIAL GROUP
WEBB ROAD
WICHITA, KANSAS

PROJECT NO.
12032
SHEET TITLE
GRADING PLAN

SHEET NO.
C2.0

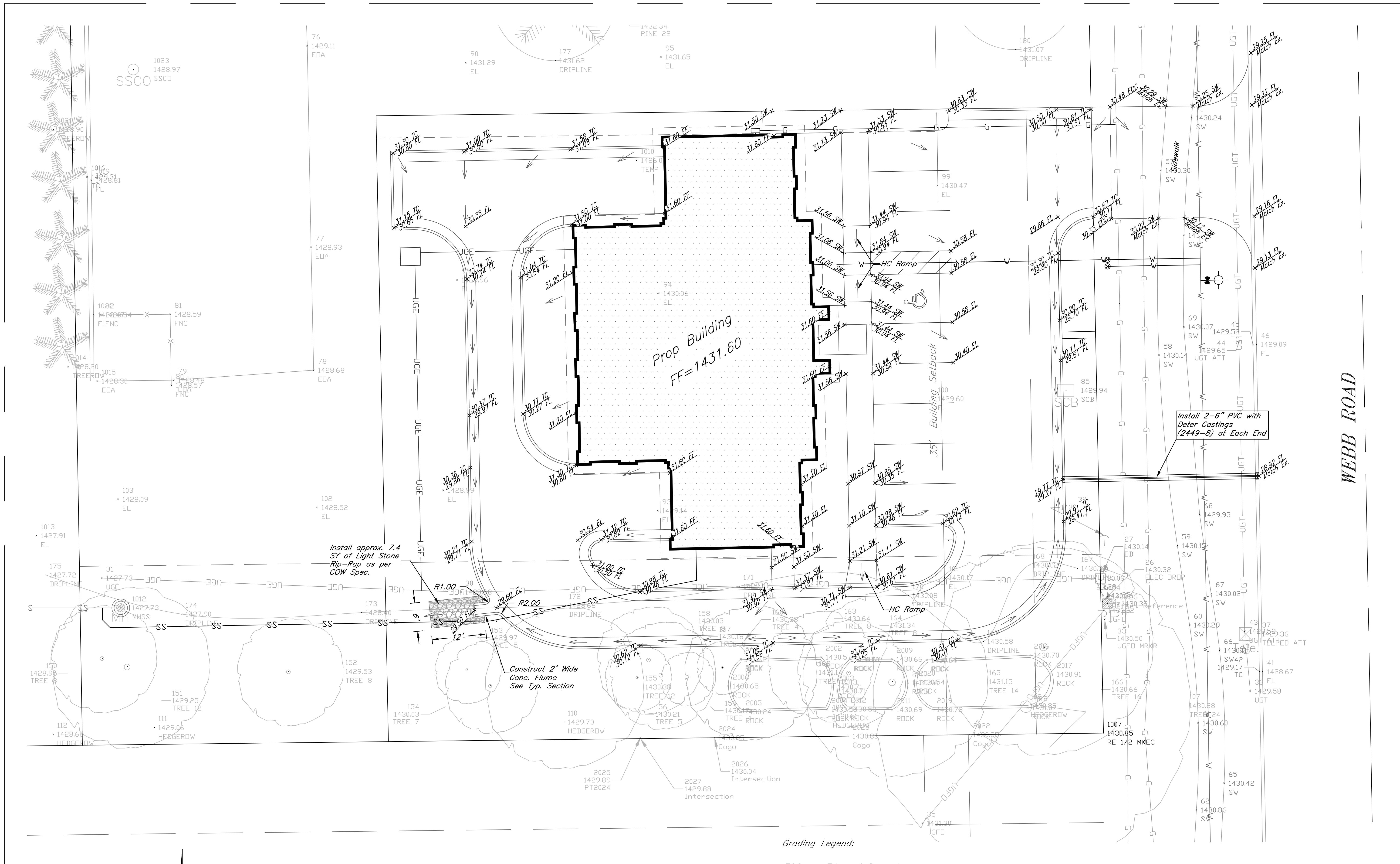

Install approx. 7.4 SY of Light Stone Rip-Rap as per COW Spec.

Construct 2' Wide Conc. Flume See Typ. Section

Install 2-6" PVC with Deter Castings (2449-8) at Each End

Grading Legend:

- EOC = Edge of Concrete
- EL = Elevation
- FL = Flow Line
- FF = Finish Floor
- SW = Sidewalk
- TC = Top of Curb
- Ex. = Existing
- = Flow Arrows
- = Channel/Valley Flowline

Impervious Area Calculations:

Existing Impervious Area = 0.0 sq ft
Proposed Building Area = 4039.0 sq ft
Proposed Parking, Sidewalk and Other Impervious Area = 9746.0 sq ft
Total Impervious Area (Post Development) = 13785.0 sq ft
Net Increase in Impervious Area = 13785.0 sq ft

Benchmark

City of Wichita Disc approximately 9' west of siren pole and 3' north of curb on the northwest corner of 34th Street and Webb Road.
Elevation=1432.09 NAVD88

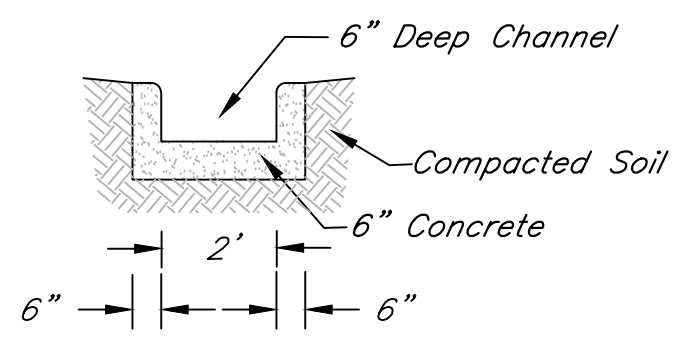

Typ. Flume Section (not to scale)

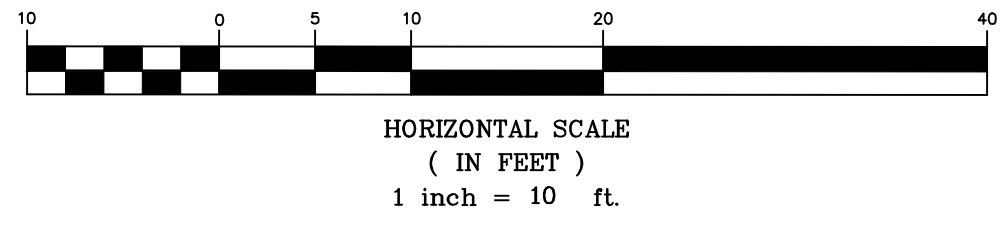

HORIZONTAL SCALE (IN FEET)
1 inch = 10 ft.

| | |
|--|------------------|
| | KEM NO. 12077 |
| | DESIGN GP |
| | DRAWN GP |

117 E. Lewis, Wichita, KS 67202 (316)264-0242