

DATE OF PREPARATION: 4 FEBRUARY 2014
 DATE OF TOPOGRAPHY: 31 JANUARY 2014
 CONTOUR INTERVALS = 1 FOOT

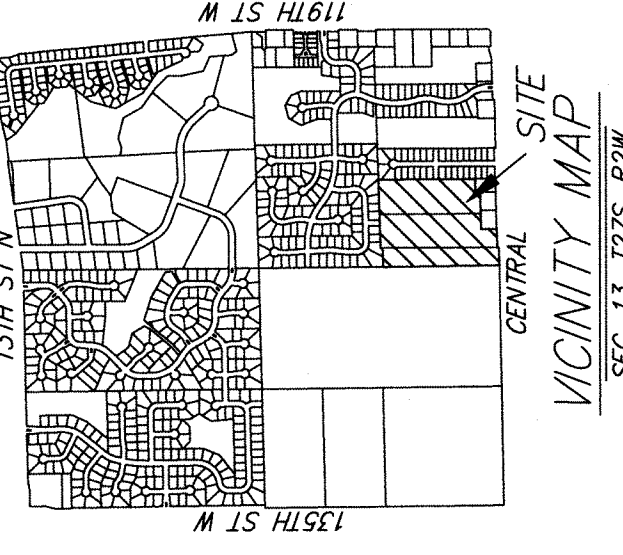

- NOTES:**
1. PROPOSED TOP OF FOUNDATION ELEVATIONS ARE SHOWN ON PLANS. CONTRACTOR TO SET FINISHED FLOOR AND GARAGE FLOOR ELEVATIONS. ALL STREET ELEVATIONS SHOWN ON PLANS ARE FOR TOP OF CURB (FULL-HEIGHT).
 2. THIS GRADING PLAN IS DESIGNED WITH SLAB FOUNDATIONS. ELEVATIONS SHOWN AS XX.X T.F. DEPICT SLAB FOUNDATION STRUCTURES.
 3. ALL LOTS SHALL MEET MINIMUM PAD REQUIREMENT AS SHOWN ON THE RECORDED PLAT.
 4. LOT DIMENSIONS HAVE BEEN OBTAINED ON THIS PLAN. REFER TO THE RECORDED PLAT FOR FINAL DIMENSION, EASEMENT, & BUILDING SETBACK INFORMATION.
 5. A DRAINAGE PLAN HAS BEEN DEVELOPED FOR THIS DEVELOPMENT. ONLY THE CITY OF WICHITA, KANSAS, OR AS MODIFIED WITH THE APPROVAL OF THE CITY ENGINEER OF THE CITY OF WICHITA, KANSAS, NO OBSTRUCTIONS WHICH IMPEDE THE FLOW OF THIS DRAINAGE PLAN SHALL BE ALLOWED.
 6. ALL ELEVATIONS ARE SHOWN IN NAVD 88 DATUM.
 7. ALL LOTS WITHING CASTLEGATE SHALL HAVE A 5 FOOT INTERIOR SIDEYARD SETBACK.

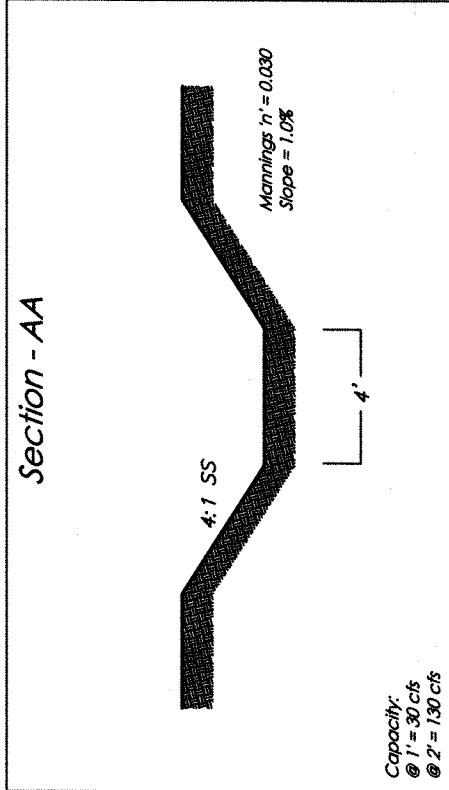

TYPICAL DETAIL - PROPOSED CHANNEL
 NO SCALE

- Legend**
- Sanitary Sewer
 - Storm Water Sewer
 - Water Line
 - Utility Pedestals
 - Existing Contour
 - Existing Fence
 - Iron

REVISIONS
 NO. DESCRIPTION
 NO. DESCRIPTION
 NO. DESCRIPTION

SHEET **1** OF **1**

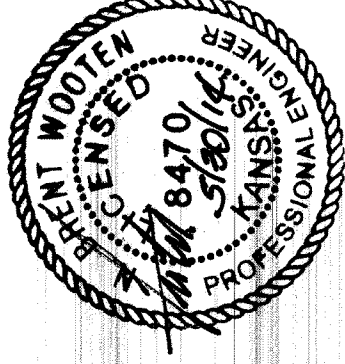

CASTLEGATE ADDITION
MASTER GRADING PLAN

Baughman
 Baughman Company, P.A.
 315 Elm St., Wichita, KS 67211 P: 316.267.2771 F: 316.267.0119
 1000 North Lincoln, Wichita, KS 67202 P: 316.267.2771 F: 316.267.0119
 1000 North Lincoln, Wichita, KS 67202 P: 316.267.2771 F: 316.267.0119

MINIMUM BUILDING PAD ELEVATIONS FOR LOWEST OPENING TO THE STRUCTURES	LOT	BLOCK	ELEVATION
	1-24	C	1340.0
			1410.088