

Served 01-10-2008 9:40:10 AM by BJS
 Plot Scale 1:60 11-19-2014 4:44:37 PM by JOSH SULLARD
 CA 2006 06611 003 06611-003-C-4-CORNER-AS BUILT

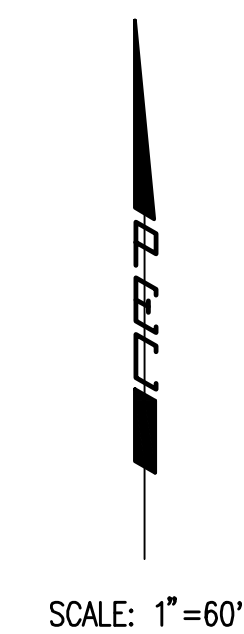
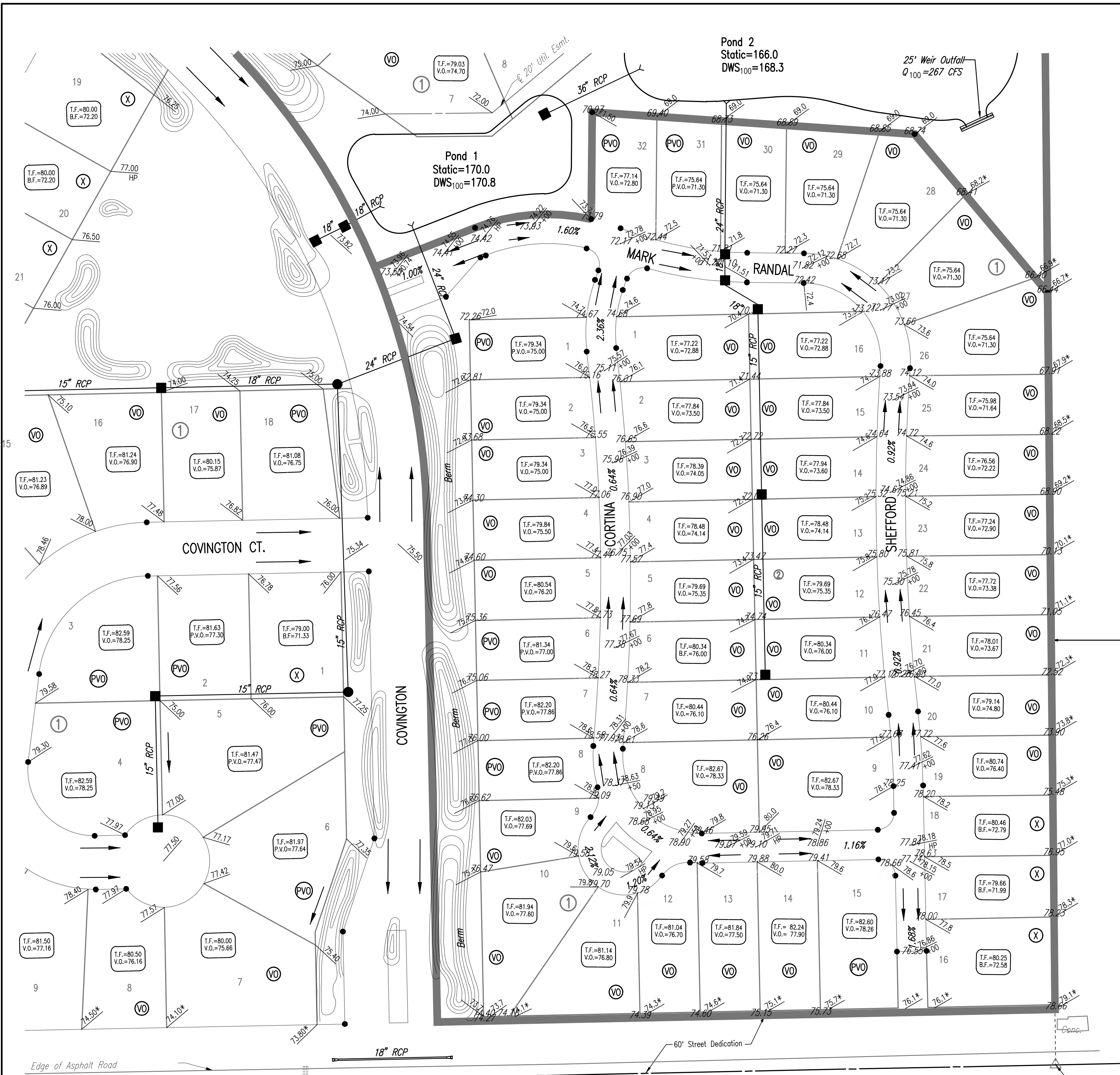

SCALE: 1"=60'

LEGEND

- SPOT ELEVATION
- HIGH POINT ELEVATION
- MATCH EXISTING ELEVATION
- STORM SEWER AND INLET
- STORM SEWER AND MANHOLE
- VIEW-OUT BASEMENT
- WALK-OUT BASEMENT
- STANDARD BASEMENT
- POSSIBLE WALK-OUT BASEMENT
- POSSIBLE VIEW-OUT

ADD 100 TO ELEVATIONS FOR CITY DATUM.

FONTANA

MINIMUM OPENINGS	ELEVATION (N.G.V.D.)	City Datum
BLOCK 1		
LOTS 31, 47-68	1361.80	174.40
BLOCK 3		
LOTS 15-41, 55	1359.10	171.70

FONTANA 2ND

MINIMUM OPENINGS	ELEVATION (N.G.V.D.)	City Datum
BLOCK 1		
LOTS 7-8	1361.20	173.80
LOTS 10-11	1358.70	171.30
LOTS 12-21	1358.90	171.50
LOTS 32-36	1359.10	171.70
BLOCK 2		
LOTS 1-8	1359.10	171.70

FONTANA 3RD

FONTANA 3RD

MINIMUM OPENINGS	ELEVATION (N.G.V.D.)	City Datum
BLOCK 1		
LOTS 26-31	1358.70	171.30
LOTS 32	1361.20	173.80

REVISED 11-18-14 (LOT 18, BLOCK 1)
 REVISED 11-07-06
 REVISED 08-09-06
 REVISED 02-09-06
 REVISED 11-01-05

SECTION LINE = C 29TH STREET NORTH

S 1/4 Cor. Sec. 31, T26S, R1W
 Found Stone & 3/4" IP on
 West side

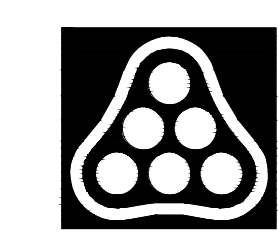

No.	Revision	By	Date
FONTANA 3RD ADDITION			
FOUR CORNER PLAN			
JAMES L. ARMOUR, P.E. - CITY ENGINEER CITY OF WICHITA PROJECT NO. 472-84091 Professional Engineering Consultants, P.A. 303 S. TOPEKA • WICHITA, KANSAS 67202 316-262-2691 • FAX 316-262-3003			
Designed by	BDB, BMM	Job No.	35-06611-003
Drawn by	BJS, TAT, BMM	Date	