

FINAL PLAT

ESTANCIA ADDITION

AN ADDITION TO WICHITA, SEDGWICK COUNTY, KANSAS

NE cor. SW ¼, Sec. 27,
T26S, R1W, 6th P.M.
Fnd. Limestone 1.5' deep
with diot in center

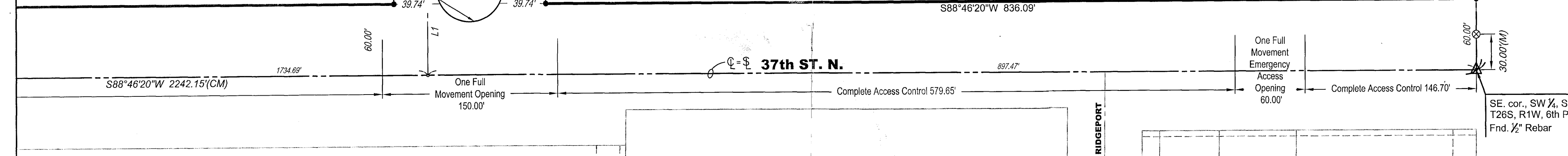
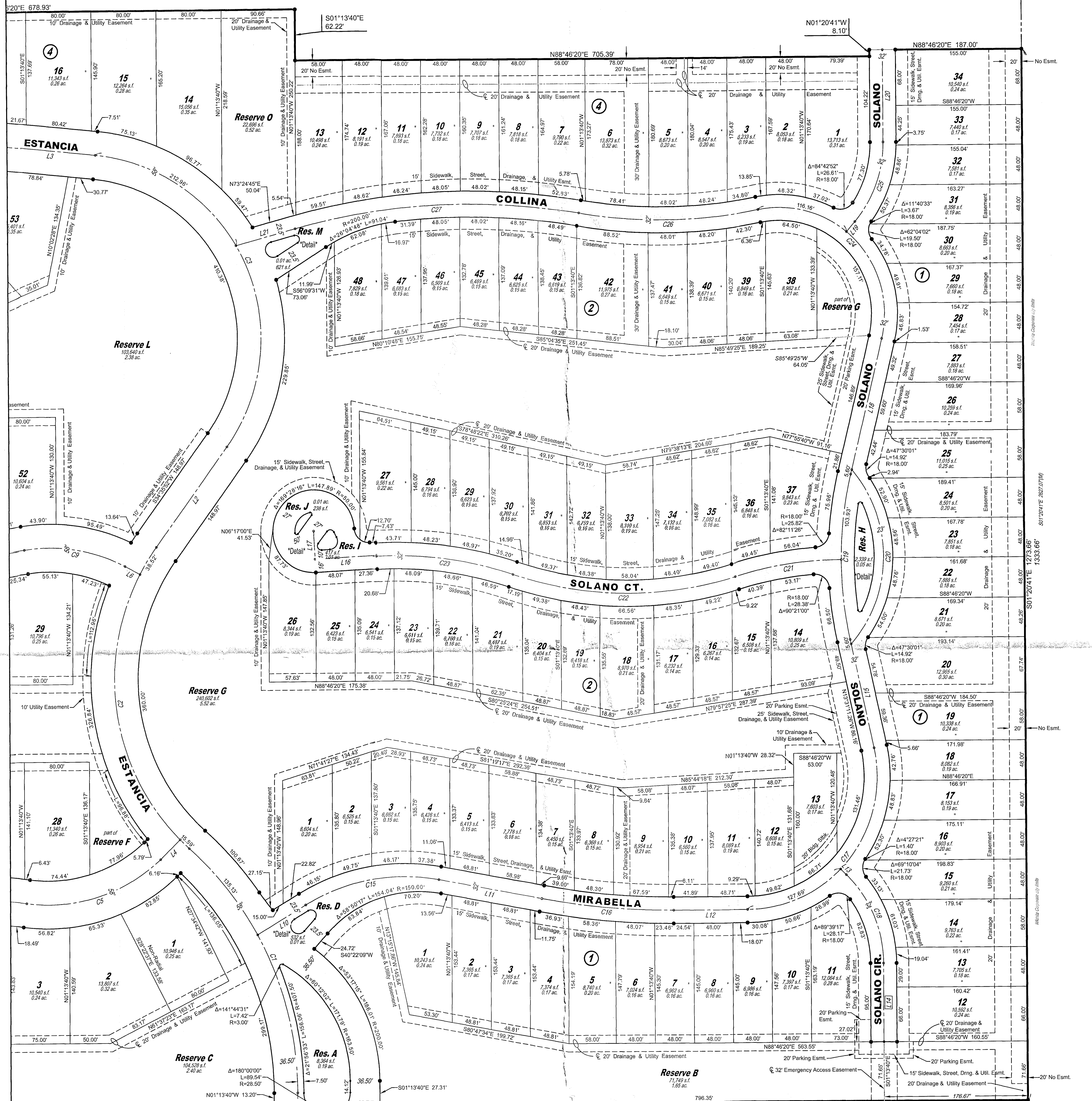

LEGEND

- Date of Survey: April 29, 2015
- △ = Section corner monument found
 - = Found 3/4" rebar w/ MKEC CLS 39 id. cap
 - ⊙ = Set 3/4" rebar w/ MKEC CLS 39 id. cap
 - (M) = Measured
 - (CM) = Calculated from measured
 - (D) = Described
 - ⊕ = Benchmark
 - U.E. = Utility Easement
 - D.E. = Drainage Easement

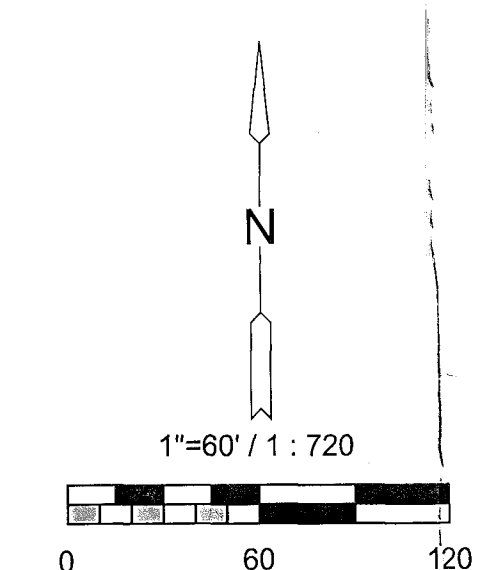

MINIMUM PAD ELEVATIONS (LOWEST SURFACE)	
LOTS	BLOCK ELEVATION NAVD 88
1-48	1334.1
5, 6, 13, 14	1334.1

BENCHMARK

BM#2
 Square cut top of curb on west side of median island and 10 feet north of the south end of said median lying south of K-96 and Ridge Rd. (being 338 feet S. of the NW corner SW ¼, Sec. 27, T26S, R1W, 6th P.M.)
 Elev. = 1335.80 NAVD88

Basis of Bearing: Kansas coordinate system of 1983 south zone grid bearing of N88°46'20"E on the south of the SW ¼, Sec. 27, T26S, R1W, 6th P.M.
 This plat is surveyed and platted on NAD83 using Kansas state plane south zone coordinates, modified to the surface, having a combined adjustment scale factor of 1.000120014401728

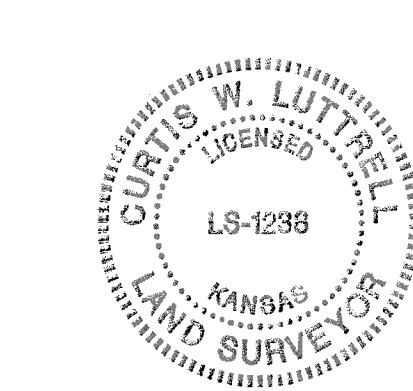

FINAL PLAT
ESTANCIA ADDITION
 AN ADDITION TO WICHITA, SEDGWICK COUNTY, KANSAS

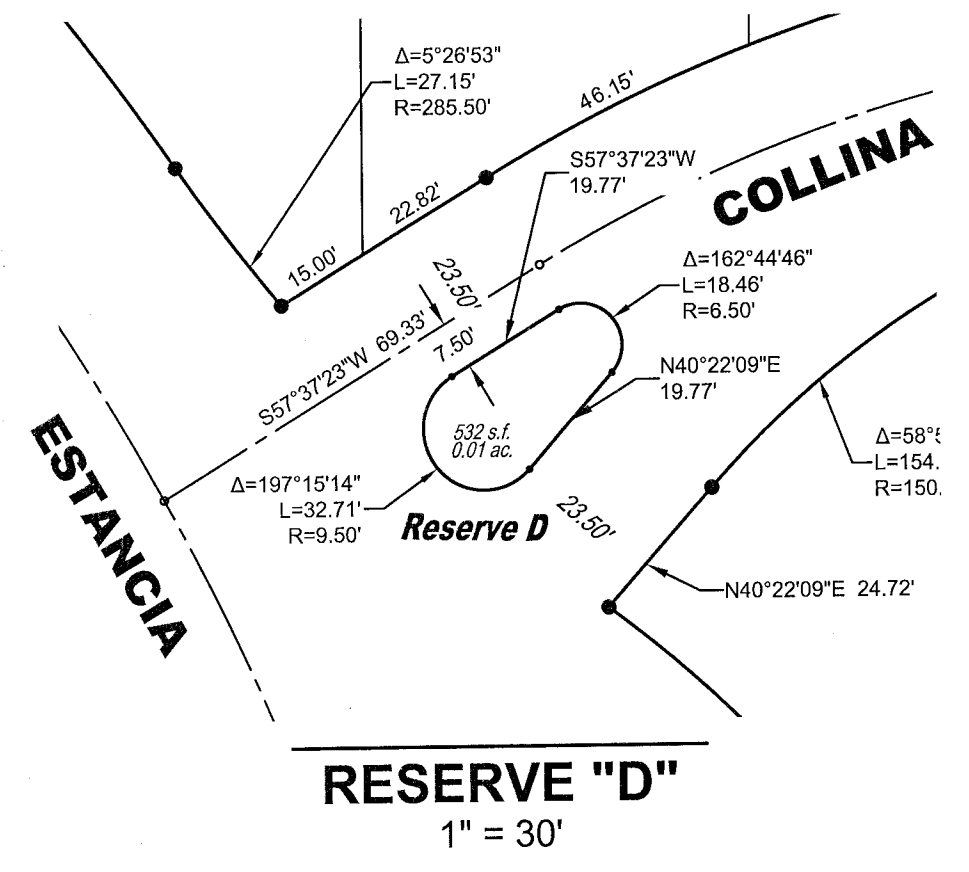

RESERVE "D"
1" = 30'

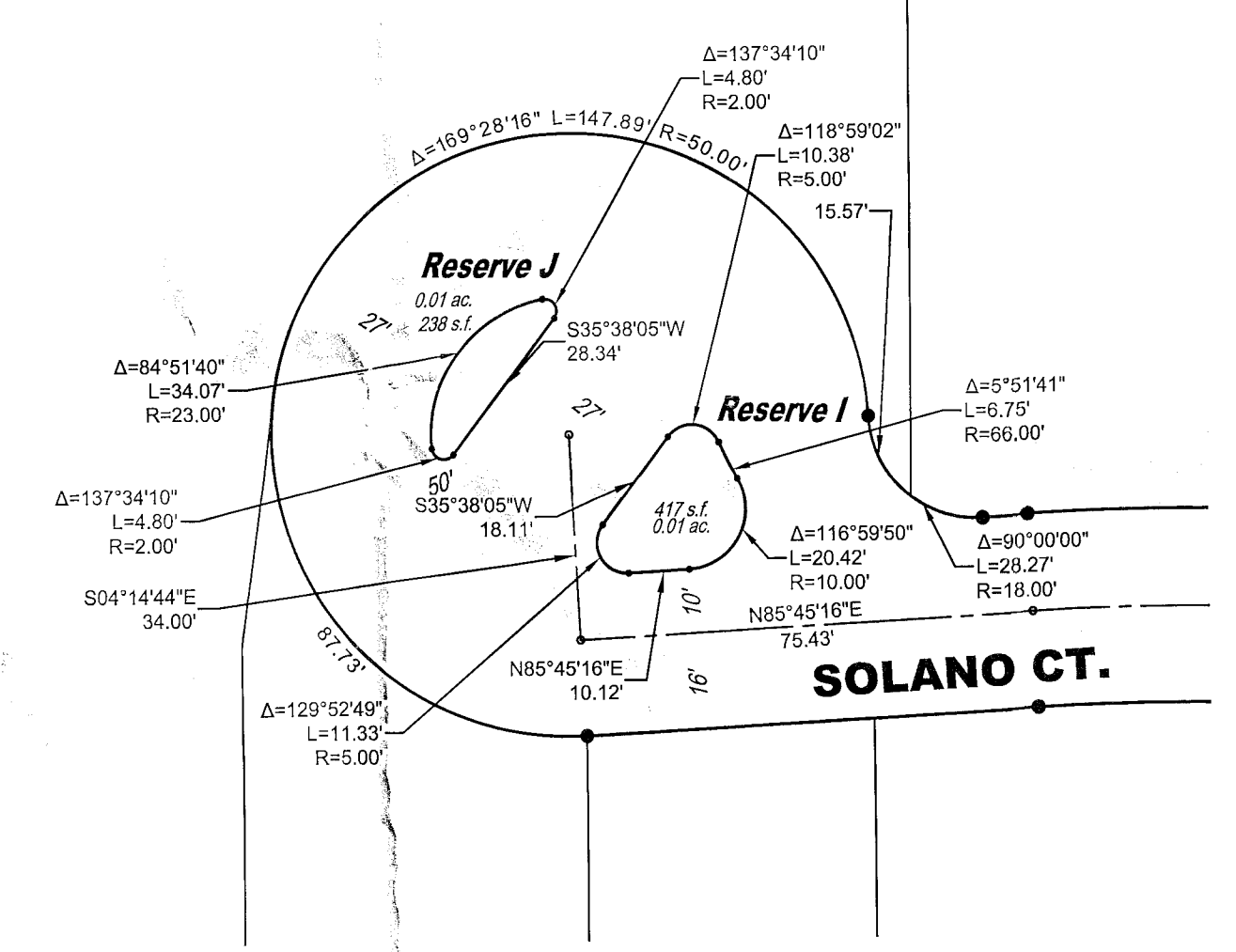

RESERVE "I" & "J"
1" = 30'

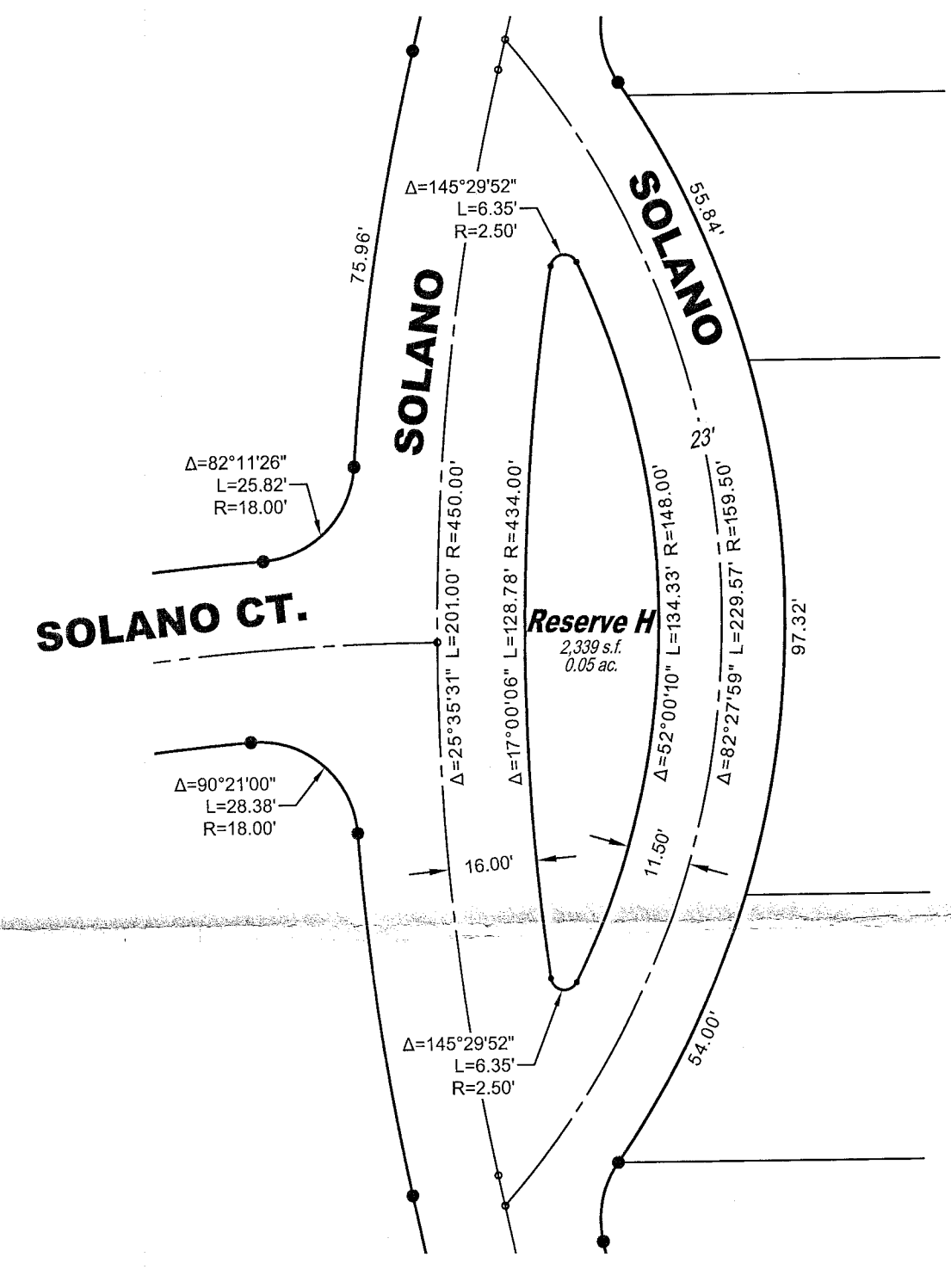

RESERVE "H"
1" = 30'

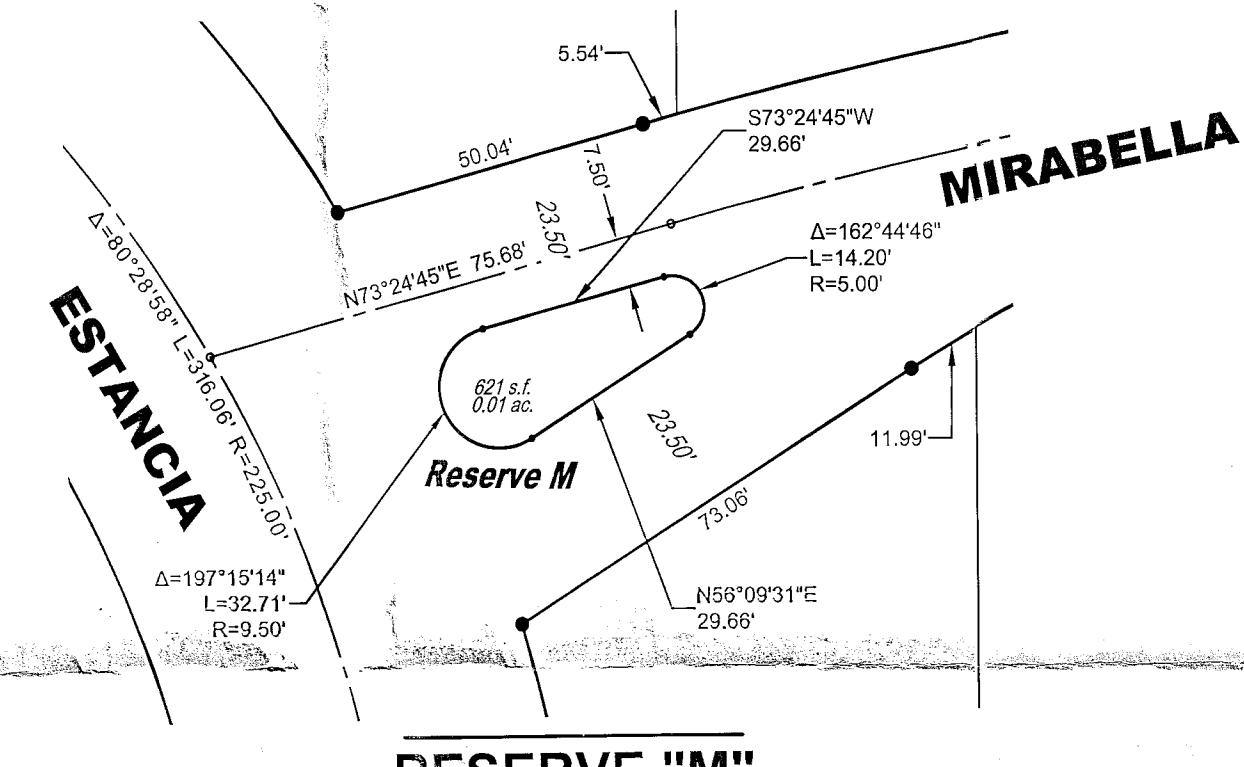

RESERVE "M"
1" = 30'

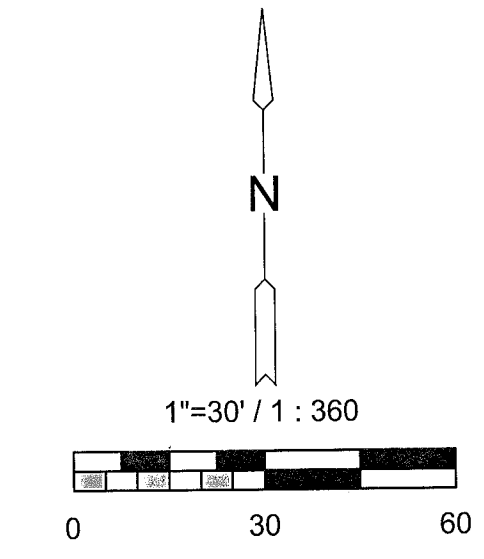

LEGEND
 Date of Survey: April 29, 2015
 • = Set 5/8" rebar w/ MKEC CLS 39 id. cap

CENTERLINE CURVE TABLE					
Curve #	Length	Radius	Delta	Chord Direction	Chord Length
C1	335.28'	400.00'	048°04'22"	S25°14'20"E	325.53'
C2	402.44'	275.00'	083°50'53"	N07°19'35"W	367.48'
C3	471.10'	225.00'	119°57'57"	S25°23'07"E	389.64'
C4	249.58'	180.00'	079°26'39"	S45°38'46"E	230.06'
C5	178.69'	200.00'	051°11'23"	S71°08'34"W	172.80'
C6	272.29'	1000.00'	015°36'03"	S88°56'14"W	271.45'
C7	301.65'	1000.00'	017°16'59"	S89°46'42"W	300.51'
C8	248.77'	1000.00'	014°15'12"	N88°42'24"W	248.13'
C9	127.76'	200.00'	036°36'06"	S81°43'41"E	125.60'
C10	243.64'	600.00'	023°15'59"	S88°23'45"E	241.97'
C11	377.47'	900.00'	024°01'50"	S88°46'40"E	374.71'
C12	184.35'	600.00'	017°36'16"	N88°00'33"E	183.63'
C13	297.78'	300.00'	056°52'17"	N70°02'17"E	285.70'
C14	209.44'	1000.00'	011°59'58"	S87°31'35"E	209.05'

CENTERLINE CURVE TABLE					
Curve #	Length	Radius	Delta	Chord Direction	Chord Length
C15	169.83'	234.00'	041°35'53"	S78°24'54"W	166.13'
C16	163.91'	900.00'	010°26'05"	N86°00'37"W	163.68'
C17	285.65'	180.00'	102°17'32"	S37°37'35"W	249.20'
C18	119.71'	150.00'	045°43'36"	N24°05'28"W	116.56'
C19	201.00'	450.00'	025°35'51"	S00°43'26"E	199.33'
C20	229.57'	159.50'	082°27'59"	N00°43'26"W	210.26'
C21	132.45'	450.00'	016°51'49"	N80°23'11"E	131.97'
C22	278.45'	450.00'	035°27'12"	N89°40'53"E	274.03'
C23	170.07'	450.00'	021°39'13"	S83°25'08"E	169.06'
C24	259.96'	130.00'	114°34'23"	N45°12'51"W	218.76'
C25	104.82'	150.00'	040°02'22"	N18°40'30"E	102.70'
C26	221.14'	600.00'	021°07'01"	N88°03'28"E	219.89'
C27	351.91'	800.00'	025°12'14"	S86°00'52"W	349.08'

CENTERLINE TABLE		
Line #	Length	Direction
L1	73.20'	S01°13'40"E
L2	148.97'	S34°35'52"W
L3	109.61'	S85°22'05"E
L4	33.81'	S43°59'52"W
L5	10.23'	S84°10'00"W
L6	20.72'	S63°25'38"E
L8	49.09'	N41°36'08"E
L9	256.01'	N86°28'26"E
L10	69.33'	S57°37'23"W
L11	128.50'	N80°47'34"W
L12	90.61'	S88°46'20"W

CENTERLINE TABLE		
Line #	Length	Direction
L13	9.89'	N46°57'16"W
L15	135.67'	S13°31'11"E
L16	75.43'	N85°45'16"E
L17	34.00'	S04°14'44"E
L18	168.75'	S12°04'20"W
L19	16.14'	N38°41'41"E
L20	112.28'	N01°20'41"W
L21	75.68'	N73°24'45"E

